

as viewed from component side General Tolerance: ±0.05

Solder Area  
 Component Outline

**Recommended PCB Layout**

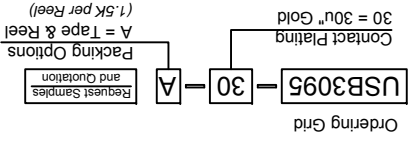
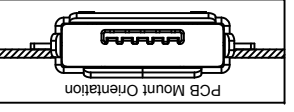
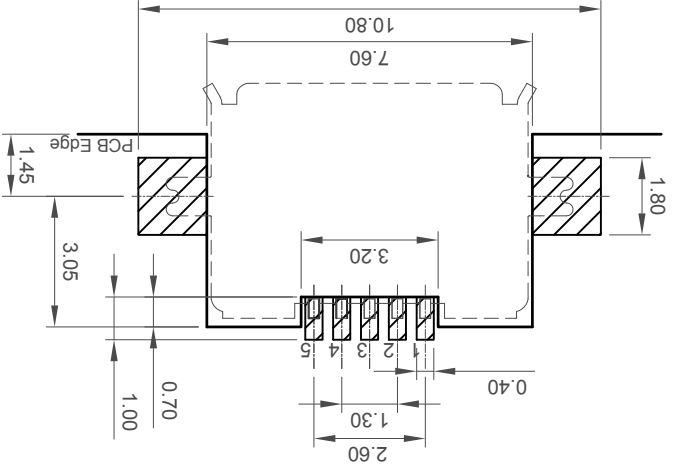

Part Number USB3095		Product Description µ USB Receptacle, Type AB, Mid Mount SMT, R/A, Bottom Mount, 1.00mm Offset, without Peg	
Drawing Date 4th April 2011		By AJO	
Revision E1		Date 09/12/14	
Detail Update		Tolerances (except as noted) X.XX ± 0.3 X.XX ± 0.20 X.XXX ± 0.10	
Packing Length		Metric (mm) X.X" ± 2" X.X" ± 1" X.XXX" ± 0.5"	
Units:		3rd Angle Projection	
ROHS COMPLIANT 2011		DMS-BIDE	
© This drawing is confidential and copyright of Global Connector Technology, Ltd (GCT). This drawing must not be copied or disclosed without written consent. E & OE		Not to Scale	
Drawn By SA		Scale SA	
Sheet No. 1/2		www.gct.co	

**Specifications 规格**

Material 物料  
 Plastic Housing 塑胶外壳: LCP, UL94V-0, Black, LCP, UL94V-0  
 Contact Terminal 接触端子: Copper Alloy  
 Metallic Shell 金属外壳: Stainless Steel SUS 304 T = 0.25mm

**Plating 电镀**  
 Underplating 底层电镀: 50µ" Nickel  
 Contact Area 接触面积: 30µ" Gold plating  
 Solder Tails 焊接末端: Gold Flash  
 Metallic Shell 金属外壳: Matte Tin

**Electrical 电气**  
 Voltage Rating 电压额定值: 100 V AC  
 Current Rating 电流额定值: 1.0A AC/DC  
 Operating Temperature 工作温度: -30°C to +85°C  
 Contact Resistance 接触电阻值: 30 mΩ max.  
 Insulating Resistance 绝缘电阻值: 1000 MΩ min.  
 Dielectric Withstand Voltage 耐电压: 500V AC/minute

**Mechanical & Environmental 机械 & 环境**  
 Mating Force 插入力: 35N max.  
 Unmating Force 拔出力: 10N min.  
 Durability 耐久性: 10,000 Cycles

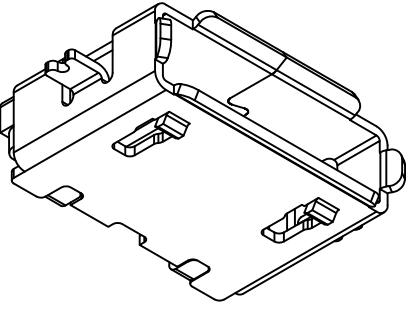

Designed to comply with physical, electrical and environmental requirements of Micro USB Standard (USB2.0), A/B types support USB On-The-Go (OTG) interface.



Global Connector Technology  
www.gct.co

Part Number		USB3095	
Drawing Date		4th April 2011	
Product Description		µ USB Receptacle, Type AB, Mid Mount SMT, R/A, Bottom Mount, 1.00mm Offset, without Peg	
By	AJO	Tolerances (except as noted)	Length Metric (mm)
Detail	Packing Update	Units:	Metric (mm)
Revision	E1	3rd Angle Projection	
Date	09/12/14	ROHS COMPLIANT 2011	
Date		09/12/14	

Not to Scale  
Scale SA  
Drawn By SA  
Sheet No. 2/2

Global Connector Technology  
www.gct.co

**GCT**

This drawing is confidential and copyright of Global Connector Technology, Ltd (GCT). This drawing must not be copied or disclosed without written consent. E & OE

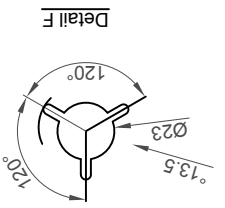
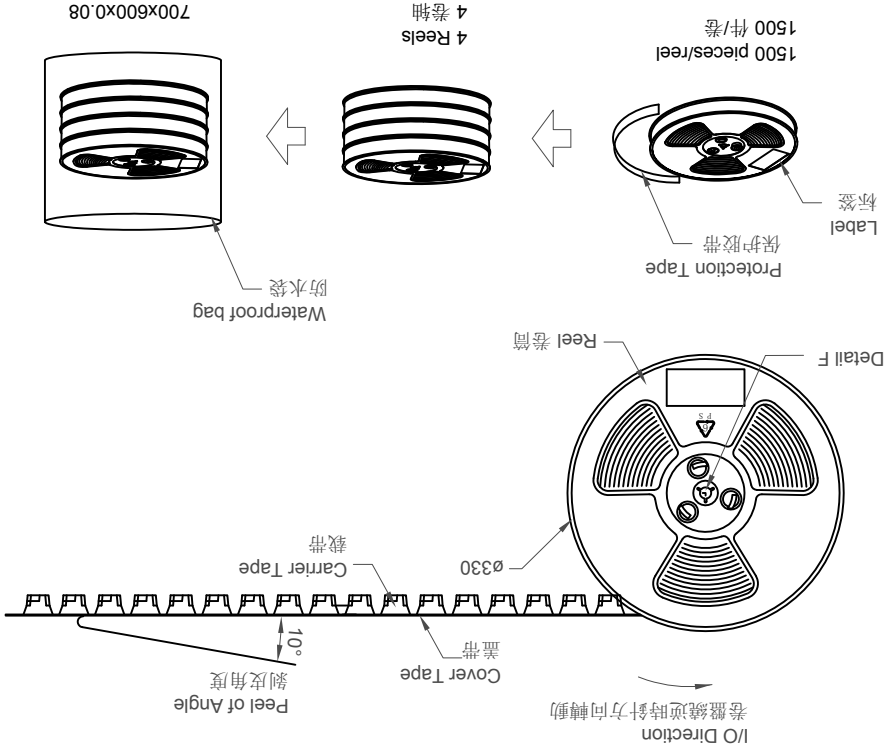
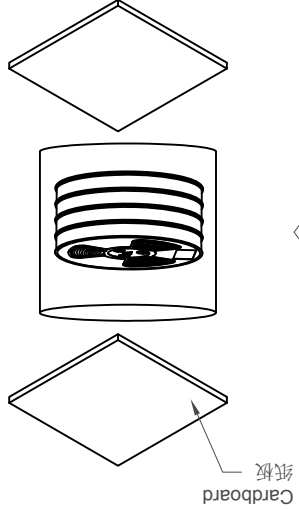
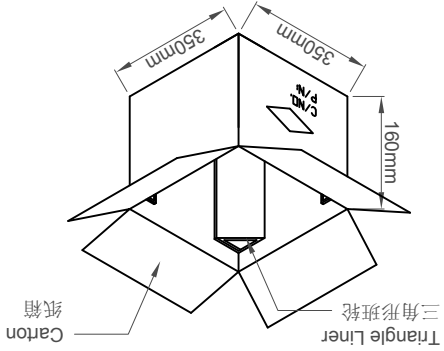

- Notes注意:
1. Peeling off force of top tape: 0.1-1.3N
  2. Part Conforms to EIA-481-C Standards 产品符合EIA-481-C标准
  3. All dimensions in millimeters 所有尺寸均是毫米
  4. 10 sprocket hole pitch cumulative tolerance±0.2mm

Products P/N	PCS/Reel	Reels/Carton	PCS/Carton
USB3095	1500	4	6000

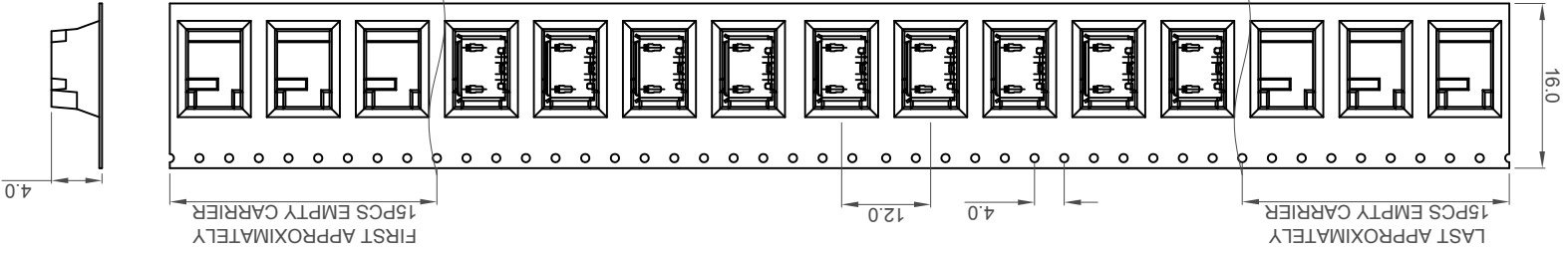

## X-ON Electronics

Largest Supplier of Electrical and Electronic Components

*Click to view similar products for [get manufacturer:](#)*

Other Similar products are found below :

[BG302-03-A-L-G](#) [BD021-09A-A1-0350-0200-0550-LD](#) [BG095-10-A-N-D](#) [SIM7200-6-0-18-00-A](#) [BG165-04-A-A-N-H](#) [BC070-06-A-1-L-D](#)  
[BG120-10-A-0-N-D](#) [SIM7050-8-0-00-A](#) [BF020-03-A-B-0600-0300-N-G](#) [DCJ250-15-A-K1-C](#) [BG030-06-A-0450-0300-N-G](#) [DCJ065-05-A-](#)  
[K1-A](#) [USB4085-GF-A](#) [BC085-08-A-0390-L-D](#) [BC034-10-A-V-0150-L-D](#) [BG300-06-A-L-A](#) [BG301-02-A-0540-L-B](#) [BG095-07-A-N-D](#)  
[BG040-06-A-0450-0300-N-G](#) [BG030-04-A-0450-0300-N-G](#) [BG303-04-A-0300-L-G](#) [DCJ235-05-A-K1-K](#) [BG301-05-A-0540-L-B](#) [BC050-](#)  
[06A-K0-0200-0160-0480-LG](#) [MEM2075-00-140-01-A](#) [USB4055-30-A](#) [BG055-04A-1-0450-0530-0350-L-G](#) [BC050-10A-K0-0200-0160-](#)  
[0480-LD](#) [BC070-20-A-1-L-D](#) [BD020-10-A-J-0350-0300-L-G](#) [MEM2067-02-180-00-A](#) [USB3105-30-A](#) [BG120-04-A-0-N-D](#) [BC085-06-A-](#)  
[0390-L-D](#) [BC050-08A-K0-0200-0160-0480-LG](#) [BC050-14A-K0-0200-0160-0480-LD](#) [DCJ250-10-A-K1-K](#) [BG302-05-A-L-G](#) [USB4065-30-A](#)  
[USB1035-GF-P-0-B-B](#) [BF085-02-A-0240-N-G](#) [BG050-10A-0-0450-0737-0350-L-D](#) [BG302-04-A-L-G](#) [BG055-03A-1-0650-0530-0350-L-G](#)  
[BC075-08-A-L-D](#) [BC032-06-A-2-0200-0200-L-D](#) [BF020-02-A-B-0400-0300-N-G](#) [BD020-03-A-J-0350-0300-L-G](#) [BC050-12A-K0-0200-](#)  
[0160-0480-LD](#) [USB3160-30-0170-1-C](#)