

THIS DRAWING IS UNPUBLISHED. RELEASED FOR PUBLICATION
 © COPYRIGHT BY TYCO ELECTRONICS CORPORATION. ALL RIGHTS RESERVED.

LOC	DIST	REVISIONS					
J	-	P	LTR	DESCRIPTION	DATE	DWN	APVD
		0		RELEASED FJ00-2828-01	30 MAY. '02	A.O	M.S

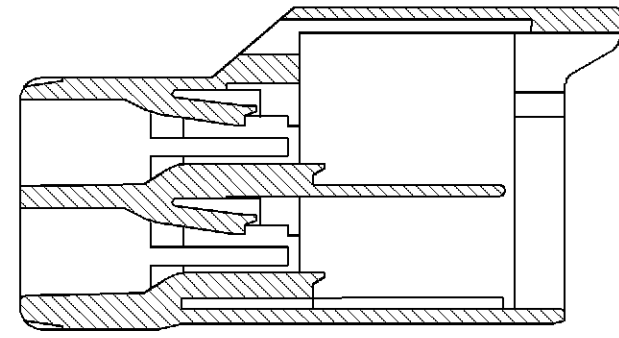
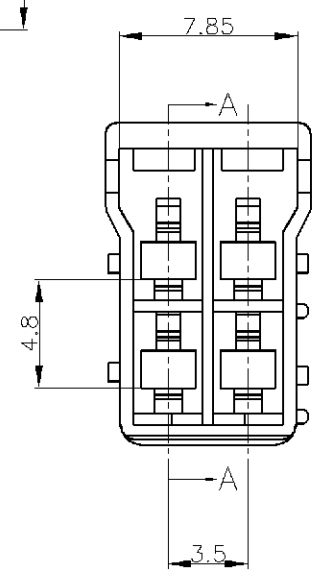
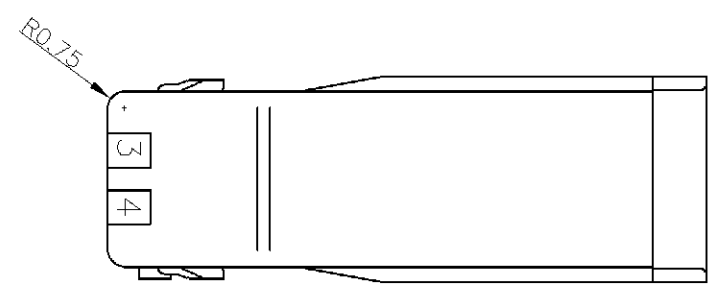
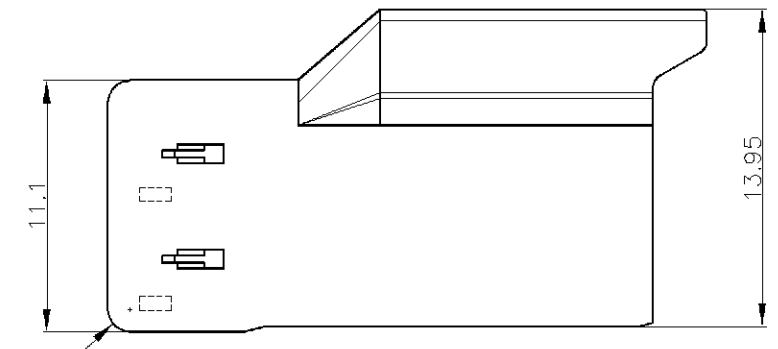
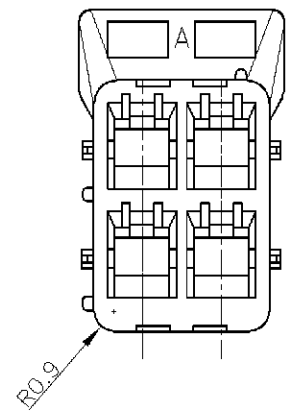
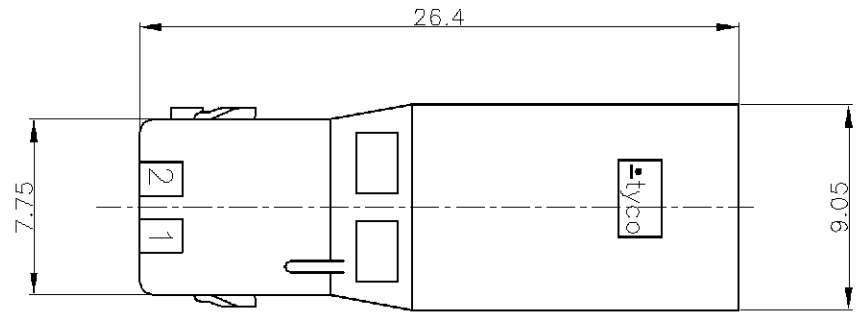

断面A-A
SECT. A-A

KEYING TYPE

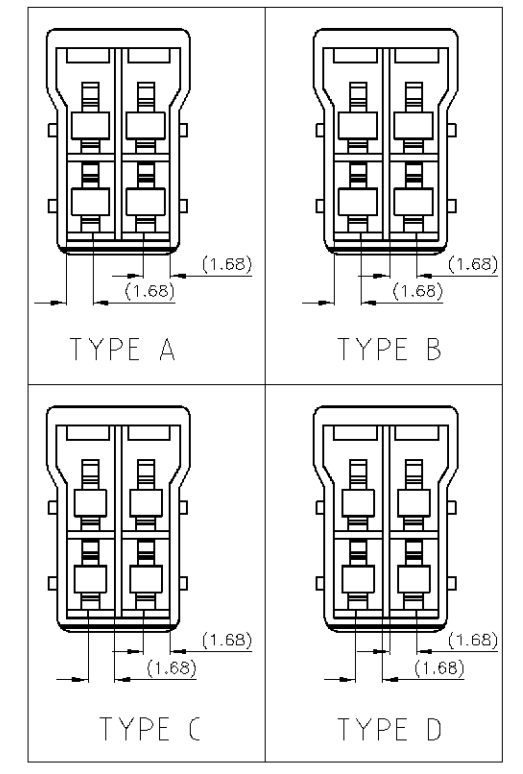

- 注) 1.一般公差:±0.25
 △材料:66ナイロン ガラス無(UL94V-0)
 △かん合相手製品型番
 プラグハウジング: TABLE参照のこと
 タブコンタクト: 1565080-1,1612335-1
 4. 適応プレート型番: 1565089-1

3-1565083-4	D	YELLOW	3-1565087-4
2-1565083-3	C	BLUE	2-1565087-3
1-1565083-2	B	RED	1-1565087-2
1565083-1	A	NATURAL	1565087-1
△MATING HSG P/N	KEYING TYPE	COLOR	P/N

- NOTES)
 1.GENERAL TOLERANCE:±0.25
 △MATERIAL:66 NYLON NON-GLASS FILLED (UL94V-0)
 △MATING CONN. P/N
 PLUG HOUSING:SEE TABLE
 TAB CONTACT ;1565080-1,1612335-1
 4. APPLICABLE PLATE P/N :1565089-1

THIS DRAWING IS A CONTROLLED DOCUMENT.		DWN A.OISHI 30 MAY. '02	tyco Tyco Electronics AMP K.K.	
DIMENSIONS: 単位: 耗 MM		CHK M.SHINDO 30 MAY. '02	Electronics Kawasaki, Japan	
TOLERANCES UNLESS OTHERWISE SPECIFIED: 一般公差		APVD M.SHINDO 30 MAY. '02	NAME 名称 GRACE INERTIA CONNECTOR 3.5	
0 PLC ±- 1 PLC ±- 2 PLC ±- 3 PLC ±- 4 PLC ±- ANGLES ±-		PRODUCT SPEC 製品規格 108-5810	4POS CAP HOUSING (2ROW)	
MATERIAL 材料 SEE NOTE		FINISH 仕上 -	APPLICATION SPEC 取付適用規格 114-5306	
		WEIGHT -	グレイス・イナーシャ・コネクタ 3.5 4極 キャップハウジング	
		CUSTOMER DRAWING	SIZE A3	CAGE CODE 00779
			DRAWING NO 番号 C-1565087	RESTRICTED TO -
			SCALE 尺度 -	SHEET 1 OF 1
				REV 0

X-ON Electronics

Largest Supplier of Electrical and Electronic Components

Click to view similar products for [Headers & Wire Housings](#) category:

Click to view products by [TE Connectivity](#) manufacturer:

Other Similar products are found below :

[95000-104TRLF](#) [10135584-644402LF](#) [DF62W-EP2022PCA](#) [95000-106TRLF](#) [DF62W-2022SCA](#) [DF62W-EP2022PC](#) [2203348](#) [DF62W-2022SC](#) [1084018](#) [1029039](#) [1084017](#) [802-10-012-10-002000](#) [1112640](#) [1112639](#) [891-007-9SS-BST1T](#) [000-34000](#) [0008550134](#) [0009482033](#) [0009507031](#) [57102-F02-18ULF](#) [57102-S06-03LF](#) [57202-S52-04LF](#) [PCN6-15S-2.5E](#) [0039019024](#) [58102-G61-06LF](#) [582553-1](#) [0009485154](#) [0009508121](#) [0022285053](#) [0050291907](#) [018731A](#) [LY20-4P-DT1-P1E-BR](#) [02.125.8002.8](#) [60101931](#) [60598-1 \(Cut Strip\)](#) [M1625-3R/100](#) [61062-3](#) [61082-181009](#) [CSU011177004](#) [636-1427](#) [638009-1](#) [641938-9](#) [641991-4](#) [644168-1](#) [644827-2](#) [647662-1](#) [65039-019ELF](#) [65692-001LF](#) [65781-018](#) [65781-047](#)