

I dati tecnici possono essere modificati senza preavviso - The technical data can be changed without notice
 Les données techniques peuvent être modifiées sans aucun préavis - Abweichungen von den aufgeführten technischen Daten sind möglich

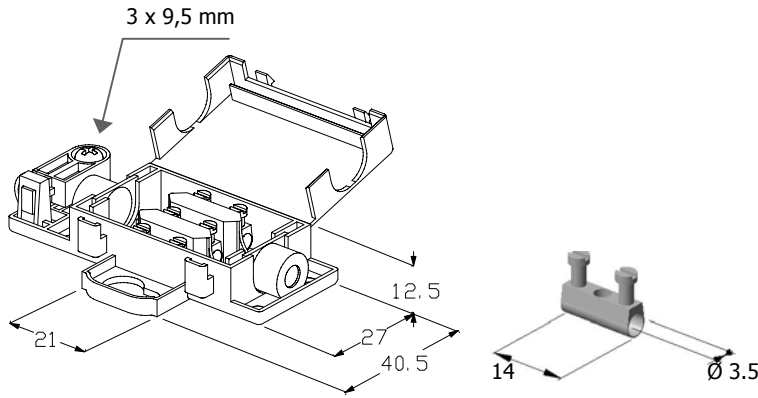

TH110
PATENTED

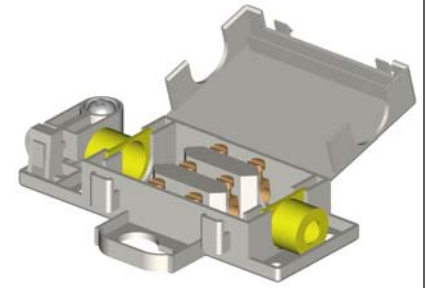

Elevato grado di protezione
2 o 3 poli con viti imperdibili
Versione con lamella salvacavo

High protection rate
2 or 3 poles, captive screws
Wire protection version

Haut degré de protection
2 ou 3 pôles, vis imperdables
Version avec lamelle de protection

Hohes Schutzgrad
2- oder 3-polig mit Stiftschrauben
Version mit Kabelsicherungslamelle

Codice - Part number - Code - Artikel Nr.

T H B . 1 1 0 . X X X

Dati tecnici - Technical data (*)
Données techniques - Technische Daten

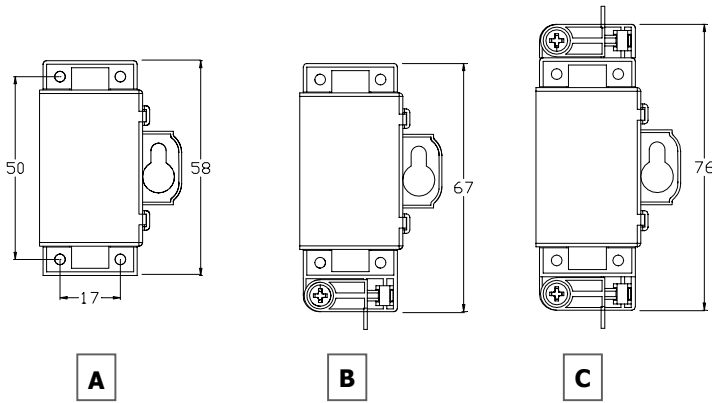

Versioni - Versions - Versions - Übertragung

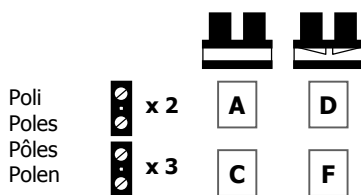

Parti metalliche - Metal parts - Parts métalliques - Metallteile

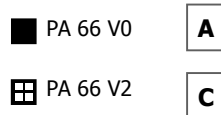

Materia plastica - Plastic material - Matériel plastique - Plastik Stoff

Confezioni - Packaging
Emballage - Verpackung

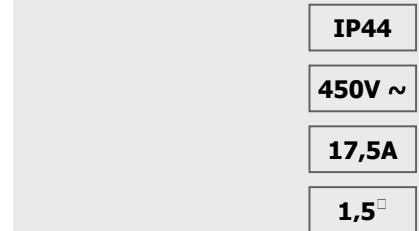
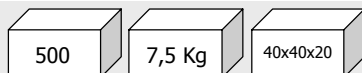

Ottone nichelato
Nickled brass
Laiton nichelé
Vernickeltem Messing



Acciaio zincato passivato
Zinc passivated steel
Acier zinqué passivé
Zinkpassivierte Stahl



PA66 UL94 V0 GWT 960°C
Nero - Black
Noir - Schwartz



PA66 UL94 V2 GWT 850°C
Naturale - Natural
Naturel - Ungefärbt



(*) IEC 998-1 ⇒ EN 60998-1 ⇒ CEI 23.20
IEC 998-2-1 ⇒ EN 60998-2-1 ⇒ CEI 23.21

Rev. 61201

X-ON Electronics

Largest Supplier of Electrical and Electronic Components

Click to view similar products for [hylec manufacturer](#):

Other Similar products are found below :

[LN167001](#) [50.625 PA/3X7](#) [50.620 PA/R](#) [DESTB-1003](#) [THB.406.A1G](#) [THB.387.A4A.R](#) [K150-1032-00](#) [GHG9601955R0004](#) [K151-1032-00](#)
[HYKS-07612PP](#) [THB.382.A1A-KIT](#) [THB.390.A1AKIT](#) [THK.404.X2A00-F](#) [50.216 ES](#) [50.616M/EMVDL-F](#) [50.625 ES](#) [PA244SKIT](#)
[THB.387.A3A](#) [THB.405.A2A](#) [50.220 M-F](#) [HY435/12 FV](#) [THB110A6B-F](#) [50.216 M-F](#) [THB.387.B5A](#) [5625////1121](#) [THB.380.3ASSY](#)
[THB.405.A2G](#) [THA.209.A1A](#) [DESTB-1002](#) [THB.384.A1A](#) [K257-1012-00](#) [6000302CC](#) [TTK25BK-SD-F](#) [TTK20GY-SD-F](#) [DESTB-0403](#)
[THB.384.B1A](#) [50.625 PA/RSW](#) [HY508/3 V/3F](#) [5665/221](#) [THB.387.D4A](#) [THB.387.B4A](#) [THR.405.S5A](#) [THB.381.M2A](#) [THB.387.A5A](#)
[THB.387.C5A](#) [THB.387.D3A](#) [50.625 M/EMVDL-F](#) [THK.200.3T](#) [THB.381.A2A](#) [K160-1040-00](#)