

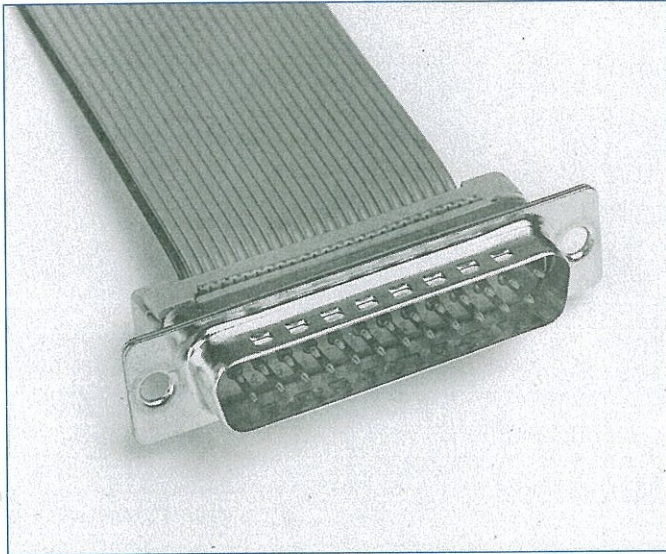

Superfast IDC D

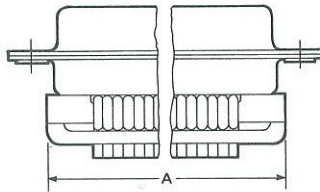

- High speed mass termination
- Low profile
- Steel shell for maximum strength
- Strain relief included
- Standard RS 232 interface
- UL 94V-0 rated insulators & strain relief
- Bright tin finish & grounding indents for EMI/RFI shielding
- Compatible with all other D Subminiatures
- Backshell & jack screws available.

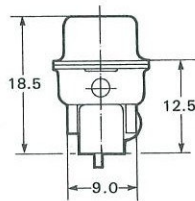

Number of Contacts	A
9	20.2
15	28.6
25	42.3
37	58.8

Technical Data

Termination Options	Insulation Displacement	Current rating	1A
Number of Contacts	9 15 25 37	Proof Voltage	1.05 Kv d.c. or a.c. peak
Maximum Insertion & Extraction Force	30 50 83 123N	Working Voltage	350V d.c. or a.c. peak
Performance Levels	2 or 3	Contact Resistance	$5 \times 10^{-3m} \Omega$ max
Wire Accommodation	26-28 AWG	Insulation Resistance	$\geq 1 \times 10^9 \Omega$
Plug Contact Material	Copper Alloy	Temperature Range	-55°C to +85°C Limited by PVC insulation on ribbon cable
Socket Contact Material	Copper Alloy	Insulator Materials	GF Polyester. UL 94V-0 Rated
		Shell Materials	Steel – Zinc plated or bright tin finish with grounding indents on plugs



Series Prefix

Mounting Type

Contact Arrangement

Contact Type

Shell Finish

Performance Level

Series Prefix	FC
Shell Size	E, A, B, C
Mounting Type	B - 4-40 rivnut for rear panel mounting F - Float mount bushes P - M3 rivnut for rear panel mounting No designation - Ø 3.05 mm mounting hole (90° PCB mount)
Contact Arrangement	9, 15, 25 or 37
Contact Type	P or S
Shell Finish	T - Bright tin TI - Bright tin with grounding indents (plugs only) No designation - Zinc plating with yellow chromate passivation
Performance Level	1 - DIN Class 1 No designation - Performance Level 2

*Unless expressly stated. Otherwise, backplate will be supplied assembled

Superfast IDC – Plug Best Sellers

Number of Contacts	Performance Level	Through Hole		Rear Panel Mount		Hoods
		Zinc Chromate Plated Shell	Tin Indent Plated Shell	4-40 Rivnut Tin indent Shell	M3 Rivnut Tin indent Shell	
9	1	FC-9P1	FC-9PT11	FCB-9PT11	FCP-9PT11	FC-9H
	2	FC-9P	FC-9PT1	FCB-9PT1	FCP-9PT1	
15	1	FC-15P1	FC-15PT11	FCB-15PT11	FCP-15PT11	FC-15H
	2	FC-15P	FC-15PT1	FCB-15PT1	FCP-15PT1	
25	1	FC-25P1	FC-25PT11	FCB-25PT11	FCP-25PT11	FC-25H
	2	FC-25P	FC-25PT1	FCB-25PT1	FCP-25PT1	
37	1	FC-37P1	FC-37PT11	FCB-37PT11	FCP-37PT11	FC-37H
	2	FC-37P	FC-37PT1	FCB-37PT1	FCP-37PT1	

Superfast IDC – Socket

Number of Contacts	Performance Level	Through Hole		Rear Panel Mount		Hoods
		Zinc Chromate Plated Shell	Tin Indent Plated Shell	4-40 Rivnut Tin indent Shell	M3 Rivnut Tin indent Shell	
9	1	FC-9S1	FC-9ST1	FCB-9ST1	FCP-9ST1	FC-9H
	2	FC-9S	FC-9ST	FCB-9ST	FCP-9ST	
15	1	FC-15S1	FC-15ST1	FCB-15ST1	FCP-15ST1	FC-15H
	2	FC-15S	FC-15ST	FCB-15ST	FCP-15ST	
25	1	FC-25S1	FC-25ST1	FCB-25ST1	FCP-25ST1	FC-25H
	2	FC-25S	FC-25ST	FCB-25ST	FCP-25S	
37	1	FC-37S1	FC-37ST1	FCB-37ST1	FCP-37ST1	FC-37H
	2	FC-37S	FC-37ST	FCB-37ST	FCP-37ST	

X-ON Electronics

Largest Supplier of Electrical and Electronic Components

Click to view similar products for [bel fuse manufacturer](#):

Other Similar products are found below :

[P2404DB](#) [FC100V20A-G](#) [CP-AD502](#) [5SF 200-R](#) [010-0055](#) [M24308/1-12F](#) [M24308/2-336Z](#) [M24308/2-343Z](#) [M24308/3-21F](#) [70-1080](#) [73-6311-10](#) [73-6670-7](#) [PL1WC-026](#) [PL375C-201](#) [PL75-45BR](#) [PS-15201](#) [PS-15206](#) [PSAC-17312](#) [PSK3616-7](#) [QM48T40033-PDB0](#) [127-0692-001](#) [127-2701-602](#) [ADBJ20-E1-BJ79](#) [ADPL75-E1-UBJ20](#) [ADT-2540-7M-SMM-02](#) [DCB-3510-FF-SMA-02](#) [DCDM100CS](#) [DCDM-15S6E5-36.0K](#) [DCHM15SCBRPN-HT1](#) [RFI21-13](#) [RFI75-8-D3](#) [DDM50SA156](#) [131-3693-116](#) [DEME9S](#) [DEMM9SM](#) [DFC10U48D12](#) [140-0000-954](#) [141-3901-802](#) [142-0233-001](#) [AM2003-9](#) [142-0298-001](#) [14-5642](#) [146-0701-301](#) [MS24264R10T20PY](#) [MS24264R10T2PY-LC](#) [MS24264R10T5PY-LC](#) [MS24264R10T5SY-LC](#) [MS24264R14B15SN-LC](#) [MS24264R14T15SN](#) [MS24264R18B14SY-LC](#)