

Data Sheet

PR065xxHBBN

Page 1/5

P/N

311761xx

xx=number of poles

2013/12/05

Illustration

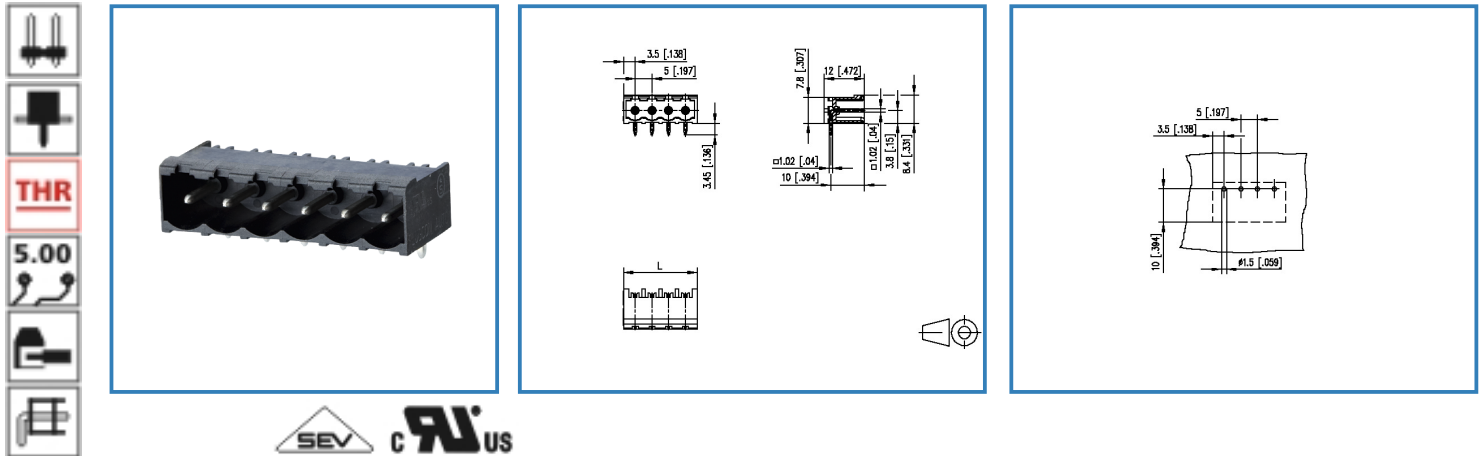

see enlarged drawing at the end of the document

Product specification

- pin header, THR solderable
- centerline 5.00 mm, direction of connection 90°
- closed ends
- color black
- Tape & Reel packaging
- codeable
- Connection data

cRUUS V / A 300 / 15

SEV 13.5 A / 320 V / 4 kV / 3 / IEC 61984

Data Sheet

PR065xxHBBN

Page 2/5

P/N

311761xx

xx=number of poles

2013/12/05

Technical Data

General Data

| | | | |
|---------------------------|---------|--------|-------|
| Solder pin length | 3.45 mm | | |
| min. number of poles | 2 | | |
| max. number of poles | 12 | | |
| Insulating material class | CTI 600 | | |
| clearance/creepage dist. | 4 mm | | |
| protection category | IP 00 | | |
| Overvoltage category | III | III | II |
| Pollution degree | 3 | 2 | 2 |
| Rated voltage | 320 V | 800 V | 800 V |
| Rated test voltage | 4 kV | 4.0 kV | 4 kV |

Connection data

| | |
|---|----------|
|  V / A | 300 / 15 |
|---|----------|

| | |
|--|---------------------------------------|
|  | 13.5 A / 320 V / 4 kV / 3 / IEC 61984 |
|--|---------------------------------------|

Material

| | |
|----------------------|---------|
| insulating material | PA66/6T |
| flammability class | V0 |
| contact pin material | CuMg |
| contact pin surface | Cu + Sn |

Climatic properties

| | |
|-------------------------|--------|
| upper limit temperature | 105 °C |
| lower limit temperature | -40 °C |

General

| | |
|---------------|---|
| solderability | For THR products acc. to IPC/JEDEC J-STD-020D-MSL 1 For THT products max. 260 °C / 10 s |
| Tolerance | ISO 2768 -mH |

Data Sheet

PR065xxHBBN

Page 3/5

P/N

311761xx

xx=number of poles

2013/12/05

Matching Part to

| P/N | Product name |
|-------------|---------------------|
| 313131 | RP035xxHBLC Typ 313 |
| 313141 | RP035xxHBLD Typ 314 |
| 313491 | RP015xxVBLC Typ 349 |
| 313501 | RP015xxSBLC Typ 350 |
| ASP045 | SP045xxVBNC ASP045 |
| SP065XXVBNC | SP065xxVBNC |
| SP065XXVBPC | SP065xxVBPC |

Accessories

| P/N | Product name |
|--------------------------|---------------------|
| 700024-01-9 | 700024 |
| 700523-0157 (on request) | Geh_Kappe_swg_Block |
| 700523-0257 (on request) | Geh_Kappe_swg_Block |

Data Sheet

PR065xxHBBN

Page 4/5

P/N

311761xx

xx=number of poles

2013/12/05

Illustration

Drawing

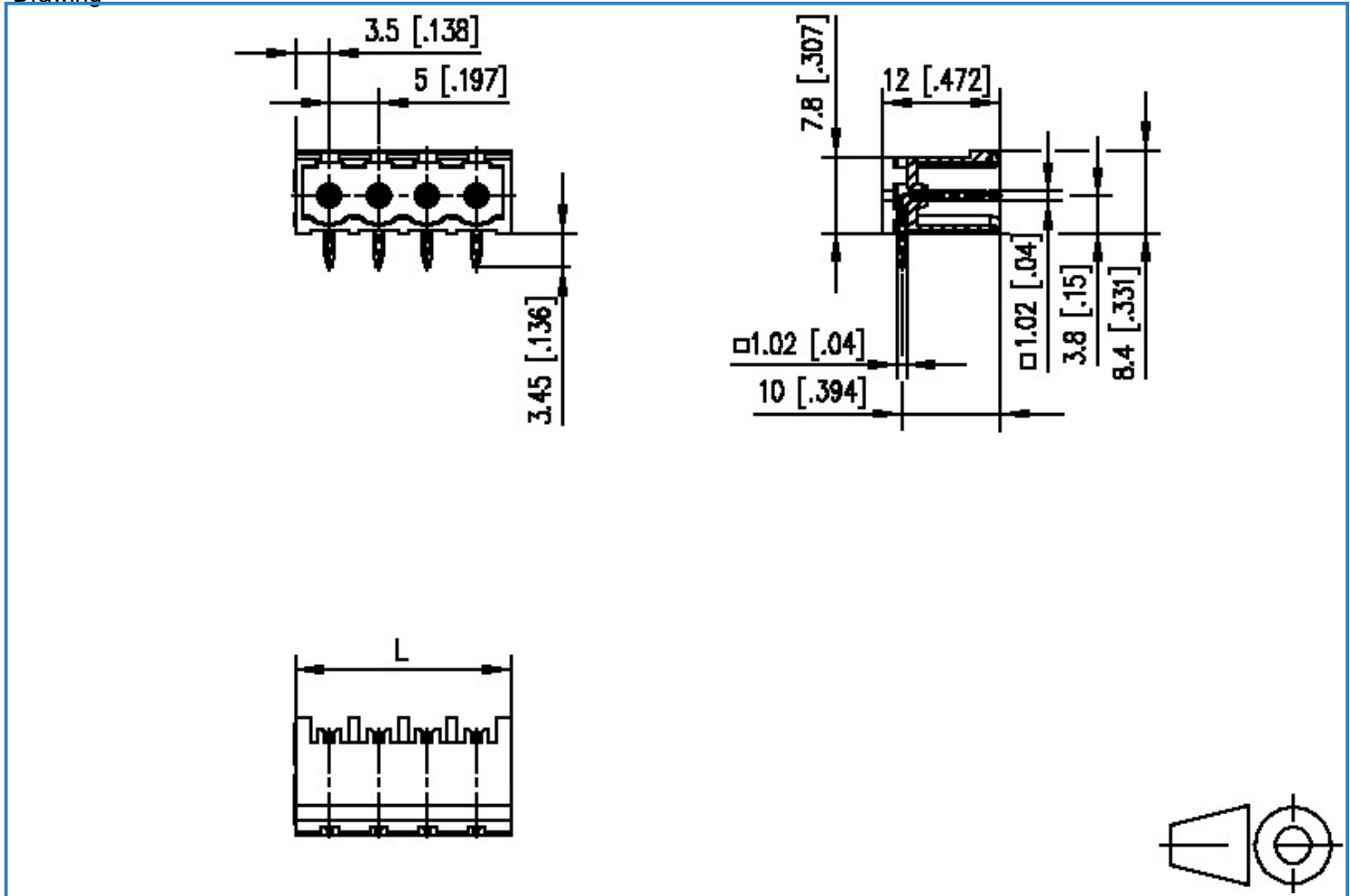

$L = (\text{pole size} - 1) \times \text{centerline} + 7.0 [0.276]$



Data Sheet

PR065xxHBBN

Page 5/5

P/N

311761xx

xx=number of poles

2013/12/05

PCB Layout

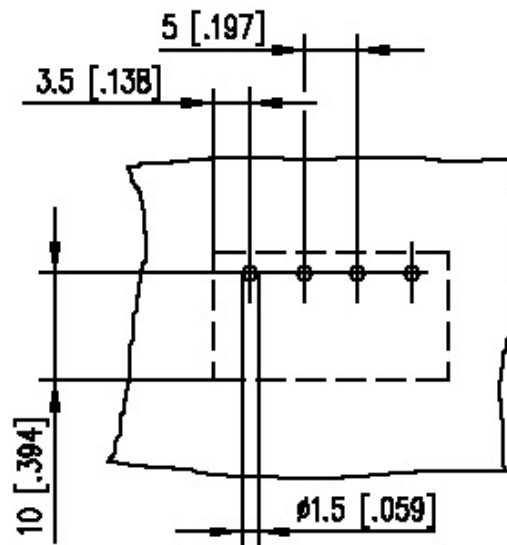

X-ON Electronics

Largest Supplier of Electrical and Electronic Components

Click to view similar products for [FFC & FPC Connectors](#) category:

Click to view products by [Metz](#) manufacturer:

Other Similar products are found below :

[HFW11R-1STE1H1LF](#) [FH29B-100S-0.2SHW\(99\)](#) [FA5S008HP1](#) [FH29B-120S-0.2SHW\(99\)](#) [FH29B-80S-0.2SHW\(99\)](#) [FHS-16](#) [FPH-2022G](#)
[52610-1075](#) [52610-1275](#) [52610-1934](#) [XF3M\(1\)-1415-1B-R100](#) [501864-3091-TR225](#) [0525594033](#) [086210010340800](#) [086222026001800](#)
[52271-2869-CUT-TAPE](#) [62674-201121DLF](#) [62684-36210E9ALF](#) [52610-1675](#) [52746-1671-TR250](#) [10051922-2810EHLF](#) [6-520415-9](#)
[BD021-09A-A1-0350-0200-0550-LD](#) [SFV6R-1STE9HLF](#) [XF3M-2915-1B-R100](#) [1658549-1](#) [62674-221121ALF](#) [46214008010800](#)
[046298003000883](#) [151660622](#) [842-816-2630-035](#) [AYF530665TA](#) [AYF351525](#) [046296011930846+](#) [AYF352325A](#) [046254020000800+](#)
[FH19C-13S-0.5SH\(99\)](#) [FH39J-51S-0.3SHW\(99\)](#) [AYF355125A](#) [AYF530365TA](#) [FH29B-44S-0.2SHW\(99\)](#) [SFW5R-2STAE9LF](#) [AYF351125A](#)
[AYF350725A](#) [62684-502100AHLF](#) [FH39-61S-0.3SHW\(99\)](#) [AYF414035A](#) [10064555-172520HLF](#) [AYF212335A](#) [504754-2500](#)