

EM32-1900

Round Hole Mounting Thermometer

ORDERING INFORMATION

Standard Meter	EM32-1900
Thermistor Probe	NTC-1900

FEATURES

- 12.5mm / 0.5" LCD digit height
- Uses an external probe supplied (cable length approx. 1m / 3 ft)
- °C and °F measurement
- Temperature measurement range of probe -40°C (-40°F) to +105°C (+221°F)
- Solderless setup
- Requires 32.5mm (1.28") diameter cut-out
- IP67 / NEMA 4X protected



The EM32-1900 is an easy to mount LCD digital thermometer. The module uses an NTC temperature sensor to ensure high accuracy over a wide temperature range. The module uses an external sensor with a maximum temperature range of -40°C (-40°F) to +105°C (221°F). This product is designed so no soldering is required. The module features a round metal bezel, requiring a 32.5mm (1.28") diameter cut-out. It is secured with the nut provided. Protection from the front to IP 67 / NEMA 4X standards is achieved by placing the rubber seal between the module and panel during assembly.

Specifications	Minimum	Typical	Maximum	Unit
Measurement range	-40 (-40)		+105 (+221)	°C (°F)
Resolution		1 (1)		°C (°F)
Accuracy*		1 (2)		°C (°F)
Sample rate		3		Samples / sec
Operating temperature range	-10 (+14)		+50 (+122)	°C (°F)
Supply voltage	4		28	V d.c.
Supply current		1	10	mA

* Using external NT sensor with 10kΩ @ 25°C and a 24 to 85°C Beta value of 3977. The module may require recalibration. To ensure maximum accuracy, recalibrate periodically. Calibrate the module at the top end of the measurement range.

** Do not apply more than 28V, as this may damage the meter.

EM32-1900

Round Hole Mounting Thermometer

DIMENSIONS

All dimensions in mm (inches)

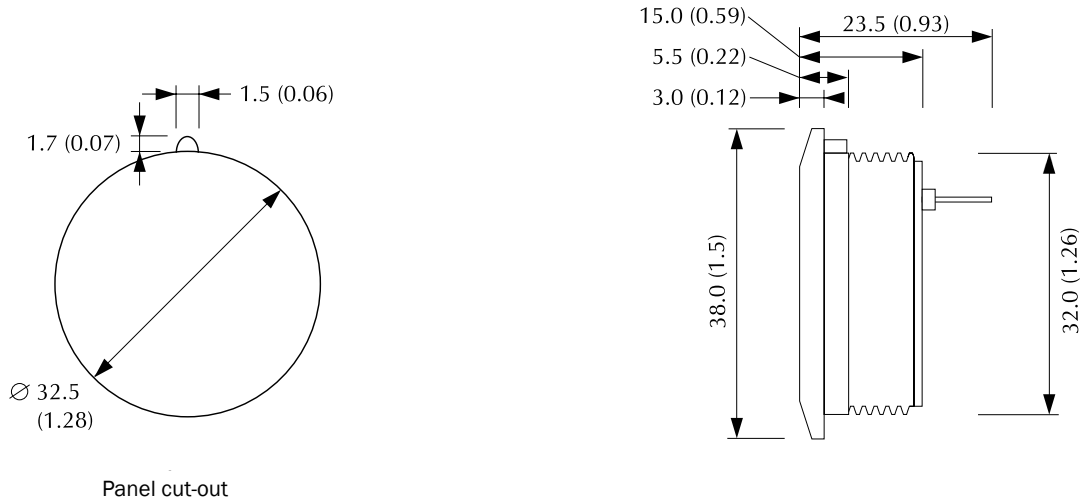

PIN FUNCTIONS

- 0V Negative supply voltage to the module
- V+ Positive supply voltage to the module, between 4V d.c. and 28V d.c.
- NTC Connection for external 10kΩ NTC sensor

JUMPER LINKS

- J1 Temperature scale selector. When fitted, the module displays °C (default). When removed, the module displays °F

SAFETY

As the NTC temperature sensor is a passive device, no voltages should be applied to the input terminals of the EM32-1900. The user must ensure that the incorporation of the meter into the user's equipment conforms to the relevant sections of BS EN 61010 (Safety Requirements for Electrical equipment for Measuring, Control and Laboratory Use).

Module House,
Whiteparish,
Wiltshire SP5 2SJ,
UK
T +44 (1794) 884567
F +44 (1794) 884616
E sales@lascar.co.uk

4258 West 12th Street,
Erie,
PA 16505,
USA
T +1 (814) 835 0621
F +1 (814) 838 8141
E us-sales@lascarelectronics.com

8th Floor, China Aerospace Centre
143 Hoi Bun Road
Kwun Tong, Kowloon
HONG KONG
T +852 2389 6502
F +852 2389 6535
E saleshk@lascar.com.hk



www.lascarelectronics.com



X-ON Electronics

Largest Supplier of Electrical and Electronic Components

Click to view similar products for [lascar](#) manufacturer:

Other Similar products are found below :

[EL-USB-1-PRO](#) [EL-USB-5](#) [EL-USB-4](#) [SP400-BLUE](#) [SGD21-B](#) [EL-WIFI-TP+-PROBE-G](#) [EL-CC-1-001 PK10](#) [EL-MOTE-WALL-BRACKET](#) [EL-MOTE-T-PLUS](#) [SGD24-M-IP](#) [EL-GFX-1](#) [EM32-1B-LED](#) [EMV1200](#) [DPM3AS-BL](#) [EL-GFX-DTC](#) [EL-USB-RT](#) [EL-WIFI-ALERT](#) [DTM 995B](#) [DPM125-BL](#) [DPM942-FPSI](#) [EL-CC-2-001 PK10](#) [EL-CC-2-005 PK10](#) [S70-TP](#) [EL-SIE-1](#) [EL-SIE-1+](#) [EL-SIE-2+](#) [EL-SIE-6+](#) [SGD24-M-IP420](#) [WIRELESS ALERT TP](#) [EL-SGD43-ATP](#) [EL-GFX-2](#) [EL-WIFI-TP](#) [DPM 950S-EB-W](#) [EM32-1B](#) [SGD 24-M-420](#) [EL-CC-2-002 PK10](#) [S43-RS485](#) [EL-USB-CO](#) [EMT1900](#) [EL-ENVIROPAD-TC](#) [SGD 43-A DK+](#) [EL-USB-2-LCD+](#) [EL-WIFI-21CFR-TP+](#) [EL-GFX-DTP+](#) [EL-USB-ACT](#) [EL-CC-2-004 PK10](#) [EL-USB-5+](#) [EL-USB-TP-LCD-PROBE-G](#) [EL-CC-1-003 PK10](#) [SGD 24-M-IP420](#)