

# Subminiature Toggle Switches



## Specifications:

Contact rating:	max. 48 V AC/DC, 0,4 VA / max. 50 mA min. 20 mV AC/DC, 1 $\mu$ A
Contact resistance:	< 50 m $\Omega$
Insulation resistance:	> 500 M $\Omega$ at 250 V DC
Dielectric strength:	500 V, 50 Hz for the duration of 1 minute
Temperature range:	- 20° to + 80° C
Mechanical life:	minimum 60 000 operations
Contacts:	phosphor bronze gold-plated over nickel barrier
Terminals:	PC terminals, crimped phosphor bronze gold-plated over nickel barrier
Material:	case: PBT, meets UL 94 V-0, washable metal parts: nickel-plated brass
Mounting:	on pc-board
Soldering conditions:	auto-soldering – max.: 5 sec $\pm$ 1 sec., 260° C $\pm$ 5° C

## Accessories:

Plastic caps	Order number
black	C 3105
green	C 3106
grey	C 3107
yellow	C 3108
red	C 3109
white	C 3110

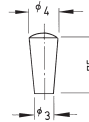

Supporting bracket for

ATE 1.

ATE 2.

Order number

AZ 0001

AZ 0005

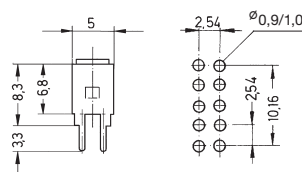
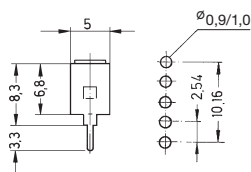



# Subminiature Toggle Switches

## Models:

Switching functions:  
Switching functions F/H/R/T:

the closed contacts are opposite to the lever position;  
when looking at the brand name on the right hand side

washable

### SPDT

ATE 1 D	on	-	on
ATE 1 E	on	off	on
ATE 1 F	mom	-	on
ATE 1 G	mom	off	mom
ATE 1 H	mom	off	on

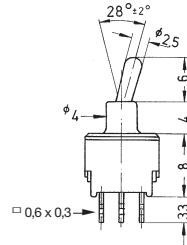
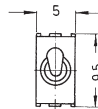
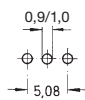

### DPDT

ATE 2 D	on	-	on
ATE 2 E	on	off	on
ATE 2 F	mom	-	on
ATE 2 G	mom	off	mom
ATE 2 H	mom	off	on

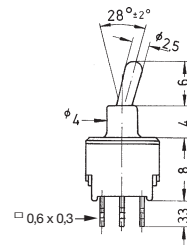
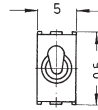
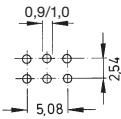

### DPDT

ATE 2 N	on	-	on
ATE 2 P*	on	off	on
ATE 2 R*	mom	-	on
ATE 2 S*	mom	off	mom
ATE 2 T*	mom	off	on

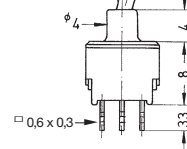
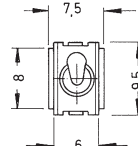
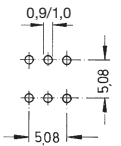

### SPDT

ATE 1 D - RA	on	-	on
ATE 1 E - RA	on	off	on
ATE 1 F - RA	mom	-	on
ATE 1 G - RA	mom	off	mom
ATE 1 H - RA	mom	off	on

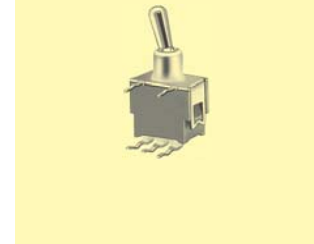
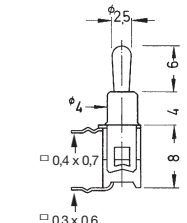
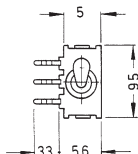
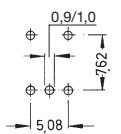

### DPDT

ATE 2 D - RA	on	-	on
ATE 2 E - RA	on	off	on
ATE 2 F - RA	mom	-	on
ATE 2 G - RA	mom	off	mom
ATE 2 H - RA	mom	off	on

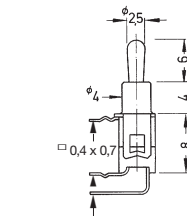
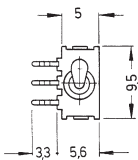
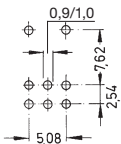

Special versions see page 26.

\* Non-stock item; minimum quantity and delivery time on request.

# Subminiature Toggle Switches waterproof



Specifications: see page 24

**Models:** Switching functions the closed contacts are opposite to the lever position;  
Switching functions F/H: when looking at the brand name on the right hand side.

## SPDT

ATE 1 D – VM	on	-	on
ATE 1 E – VM	on	off	on
ATE 1 F – VM*	mom	-	on
ATE 1 G – VM*	mom	off	mom
ATE 1 H – VM*	mom	off	on

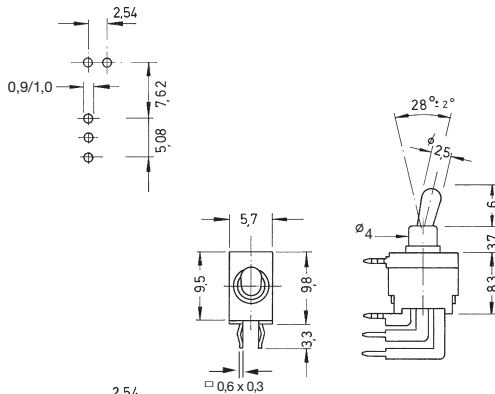

## DPDT

ATE 2 D – VM	on	-	on
ATE 2 E – VM	on	off	on
ATE 2 F – VM*	mom	-	on
ATE 2 G – VM*	mom	off	mom
ATE 2 H – VM*	mom	off	on

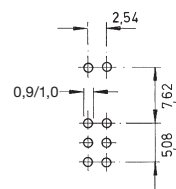

washable

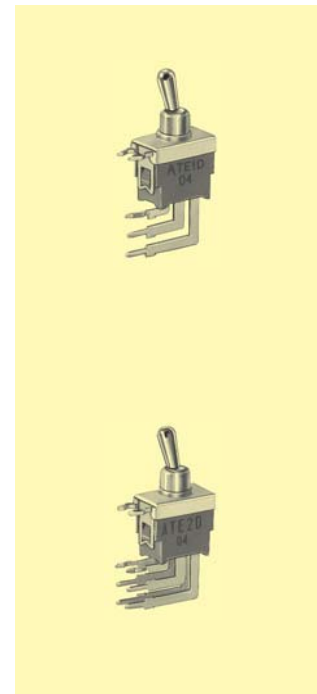

Accessories: see page 24.

## Special versions\*:

long flat lever

Additional to type number: F  
Example of order: ATEF 2D – RA

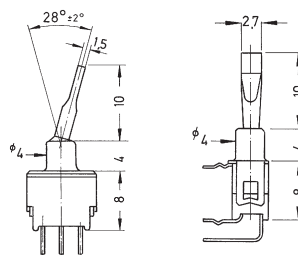

Spacing 5,08 mm

Additional to type number: – 1  
Example of order: ATE 2E – RA-1

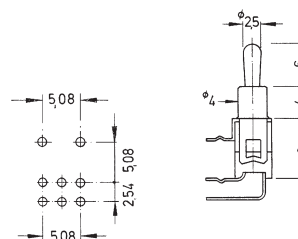

\* Non-stock item; minimum quantity and delivery time on request

## X-ON Electronics

Largest Supplier of Electrical and Electronic Components

*Click to view similar products for [Toggle Switches](#) category:*

*Click to view products by [Knitter-Switch](#) manufacturer:*

Other Similar products are found below :

[A19HV](#) [8A1-C-222](#) [60012L](#) [6006L](#) [6663](#) [7101MD9V30GE](#) [7101SPDV30BE](#) [7103SDV30BE](#) [7105D](#) [7108P3YAV2BE](#) [71YY50282](#)  
[7201MD9AVBE](#) [7301K38](#) [7306K36](#) [7310K36](#) [7314K36](#) [7506K4](#) [7592K6](#) [7691K14](#) [7700K1](#) [8396K108](#) [8824K14](#) [8828K13](#) [G3VX](#) [PS83-](#)  
[121G](#) [A101MD9AB04](#) [A101SD9AB04](#) [A101SDCQ04](#) [A103SD9AQ04](#) [A107TZB04](#) [A123P32YZQ](#) [A123S1YZG](#) [A127S1YCQ](#) [1-1825192-](#)  
[0](#) [A131S1YZQ](#) [A201SCWZB04](#) [A207SYCB04](#) [A208J61ZQ0004](#) [A221K12KAG](#) [A221S1YZQ](#) [A221T1TCQ](#) [A232K12KZQ](#) [A232M1YCQ](#)  
[A323S1CWZQ](#) [A423S1YZQ](#) [12149A-3V](#) [12156AX408](#) [12147AGKX679](#) [12149AD2G0383VX408](#) [12246X778](#)