



ENCLOSING ELECTRONICS ONE BOX AT A TIME

ENCLOSURES & ASSEMBLY SERVICES

BOX ENCLOSURES, INC

28835 N. HERKY DRIVE, #114,  
LAKE BLUFF, IL 60044

TEL: 847-932-4700

WWW.BOXENCLOSURES.COM

FAX: 847-932-4701

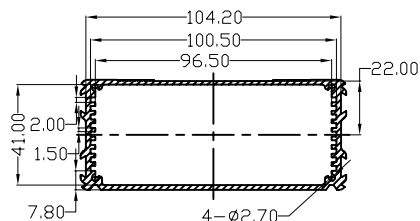
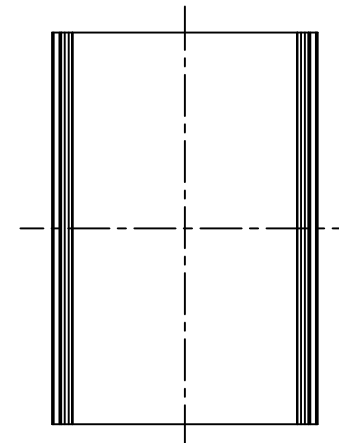
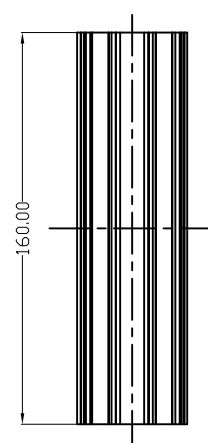
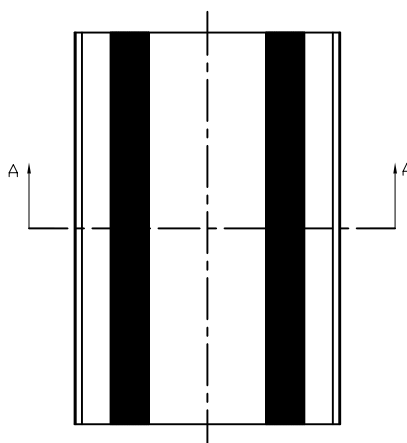
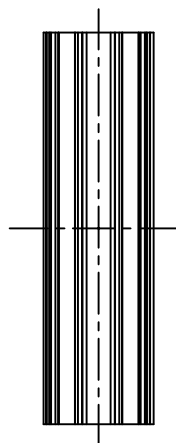
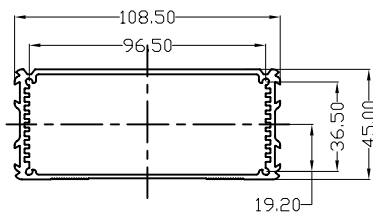
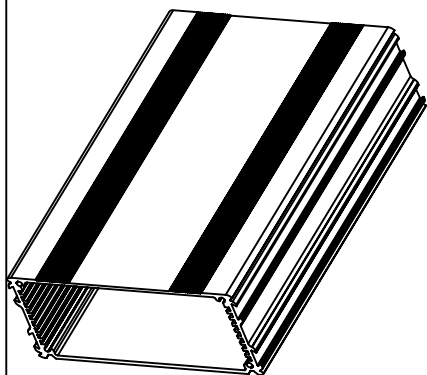

SECTION A-A

<p>ENCLOSING ELECTRONICS ONE BOX AT A TIME</p> <p>ENCLOSURES &amp; ASSEMBLY SERVICES</p>		Revision:	
		Model:	
Title: BEX-1603		Dwg. No.:	Part No.:
Material:	<p>TOLERANCE</p> <p>all dimension in mm</p> <p>unless otherwise specified</p> <p>x ±0.20</p> <p>.x ±0.10</p> <p>.xx ±0.05</p> <p>ANGLE ±0.5°</p>	Color:	Drn. Date Jim JR 11-27-2004
Finish:		Qty:	Chk. Date
ONLY FOR Proj.		A4 Sheet 1 of 1	App. Date

THIS DRAWING IS THE PROPERTY OF AND MAY EMBODY PROPRIETARY INFORMATION OWNED BY X-Box Enclosures. IT IS PROVIDED UNDER A CONFIDENTIAL RELATIONSHIP FOR A SPECIFIC PURPOSE. THE RECIPIENT AGREES TO USE IT FOR SUCH PURPOSE AND RETURN IT TO X-Box Enclosure UPON REQUEST.

## **X-ON Electronics**

Largest Supplier of Electrical and Electronic Components

*Click to view similar products for [box enclosures manufacturer](#):*

Other Similar products are found below :

[101-42-NO-R-BO](#) [B2-080SI](#) [40-RBT-BL](#) [B2-160SI](#) [40-12-NO-F-BL](#) [40-RBT-BLK](#) [40-12-9V-R-BO](#) [55-RBT-BL](#) [B4-220BK](#) [SK1](#) [40-12-9V-F-BO](#) [90-RBT-BL](#) [101-42-4A-R-BL](#) [SK4](#) [SBH-9V-BK](#) [100-42-NO-F-BL](#) [40-RBT-YEL](#) [21G-BK](#) [55-12-9V-R-BL](#) [SBH-4AA-BK](#) [55-12-2A-R-BL](#) [ASK71](#) [B1-120BL](#) [B3-080RD](#) [EC2-BK](#) [WTS127S](#) [ASK70](#) [100-42-9V-F-BL](#) [55-RBD-DBL](#) [ASK74](#) [MBS107](#) [B4-080BK](#) [101-42-9V-R-BL](#) [ASK72](#) [B3-220BK](#) [B1-080SI](#) [B3-080BL](#) [B4-160BL](#) [B2-080BL](#) [101-42-4A-R-BO](#) [B2-160BK](#) [90-RBT-DBL](#) [B4-160BK](#) [MBM107](#) [PBS107](#) [SBH-29V-BK](#) [PBS109](#) [MBM109](#) [PBM107](#) [PBL109](#)