

Cable sockets and plugs with molded-on lead

Product features

- connection of
 - inductive or capacitive proximity switches
 - photoelectric barriers
 - pressure-operated switches etc.

Variations

- cable sockets and plugs without LED (housing black, cable black)
- cable sockets with LED (housing transparent, cable black)

Basic data

- protection class IP 68 (IEC 60529)
- high flexible lead
- conductor color identification complies with European standards (EN 50044)

Further information

see technical data in the catalog
Circular connectors for automation technique
DS 280 490-450.

For tailor-made systems,
see page 6

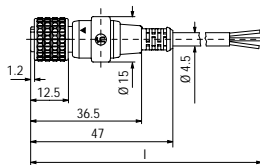
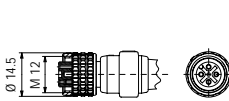

ELKA-KV...

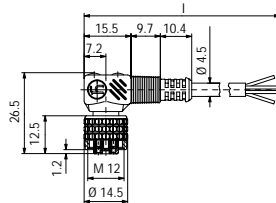
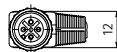

ELWIKA-KV...

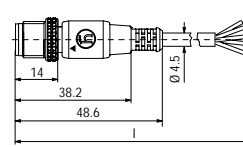
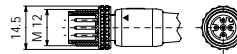

ELST-KV...

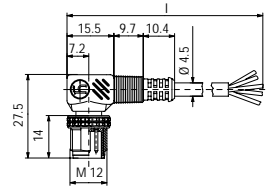
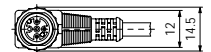

ELWIST-KV...

Componentries (cable sockets with LED)

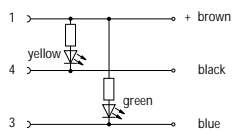

NS/C

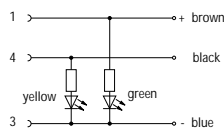

PS/A

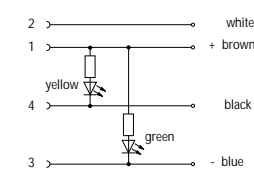

NS/G

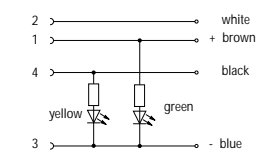

PS/F

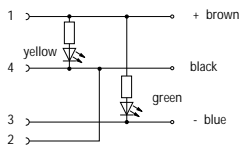

NS/M

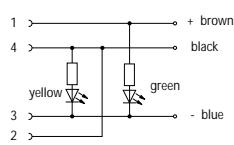

PS/K

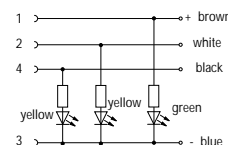

PS/P

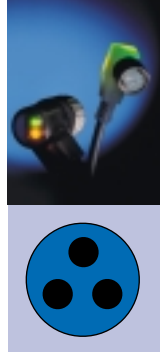

Cable sockets and plugs with molded-on lead

poles	cable material	length	socket		plug		operating voltage	componentry (cable sockets with LED)				
			straight ELKA-KV	angled ELWIK-AKV	straight ELST-KV	angled ELWIST-KV						
3	4312	PUR	2m	933 330-021	933 316-021	933 337-021	933 340-021	UC 250 V (≈)				
			5m	933 330-022	933 316-022	933 337-022	933 340-022					
		PVC	2m	933 237-041	933 226-041	933 241-041	933 244-041					
			5m	933 237-042	933 226-042	933 241-042	933 244-042					
		4312 NS/C	PUR	2m	933 327-021	933 318-021					DC 10...30 V (=)	NPN normally open LED green/LED yellow
				5m	933 327-022	933 318-022						
	PVC	2m	933 275-041	933 228-041								
		5m	933 275-042	933 228-042								
	4312 PS/A	PUR	2m	933 326-021	933 317-021			DC 10...30 V (=)	PNP normally open LED green/LED yellow			
			5m	933 326-022	933 317-022							
	PVC	2m	933 240-041	933 227-041								
		5m	933 240-042	933 227-042								
4	4412	PUR	2m	933 331-021	933 319-021	933 338-021	933 341-021	UC 250 V (≈)				
			5m	933 331-022	933 319-022	933 338-022	933 341-022					
		PVC	2m	933 238-041	933 235-041	933 242-041	933 245-041					
			5m	933 238-042	933 235-042	933 242-042	933 245-042					
		4412 NS/G	PUR	2m	933 328-021	933 321-021					DC 10...30 V (=)	NPN normally open/closed (antivalent) LED green/LED yellow
				5m	933 328-022	933 321-022						
	PVC	2m	933 276-041	933 231 041								
		5m	933 276-042	933 231-042								
	4412 PS/F	PUR	2m	933 329-021	933 320-021			DC 10...30 V (=)	PNP normally open/closed (antivalent) LED green/LED yellow			
			5m	933 329-022	933 320-022							
	PVC	2m	933 277-041	933 230-041								
		5m	933 277-042	933 230-042								
	4412 NS/M	PUR	2m		933 323-021			DC 10...30 V (=)	NPN normally open/closed (pole 2 + 4 bridged) LED green/LED yellow			
			5m		933 323-022							
			2m		933 233-041							
	PVC	2m			933 233-042							
		5m										
	4412 PS/K	PUR	2m		933 322-021			DC 10...30 V (=)	PNP normally open/closed (pole 2 + 4 bridged) LED green/2x LED yellow			
			5m		933 322-022							
			2m		933 232-041							
	PVC	2m			933 232-042							
		5m										
	4412 PS/P	PUR	2m		933 324-021			DC 10...30 V (=)	PNP normally open/closed (antivalent) LED green/LED yellow			
			5m		933 324-022							
2m				933 234-041								
PVC	2m			933 234-042								
	5m											
5	5512	PUR	2m	933 332-021	933 325-021	933 339-021	933 342-021	UC 50 V (≈)				
			5m	933 332-022	933 325-022	933 339-022	933 342-022					
		PVC	2m	933 239-041	933 236-041	933 243-041	933 246-041					
	5m		933 329-042	933 236-042	933 243-042	933 246-042						

Example for placing orders: 933 326-021 ELKA-KV 4312 PS/A PUR 034 2m

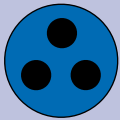

Cable sockets and plugs for self-assembly

Product features

- connection of
 - inductive or capacitive proximity switches
 - photoelectric barriers
 - pressure-operated switches etc.

Variations

- cable sockets and plugs without LED (housing black, PG7 and PG9)
- cable sockets and connectors, LED insertable (accessories), (housing transparent/topas, PG7)
- cable sockets and connectors with plastic coupling nut/thread (housing black, PG7)

Basic data

- protection class IP 67 (IEC 60529)
- strain relief by means of clamping cage
- type of termination screw

Further information

see technical data in the catalog
Circular connectors for automation technique DS 280 490-450.
For tailor-made systems, see page 6

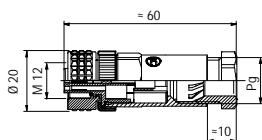

ELKA...PG...

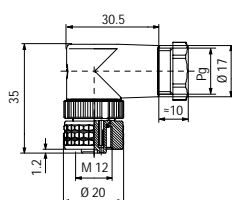

ELWIKA...PG...

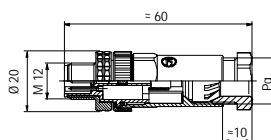

ELST...PG...

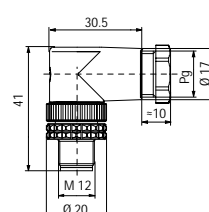

ELWIST...PG...

Cable accommodation: PG7: \varnothing 4...6 mm (0,160...0,235 inches)
PG9: \varnothing 6...8 mm (0,24...0,315 inches)

Plastic-coupling nut/thread: standard with type 4012 K PG 7; for all other types on demand.

poles	socket		plug		operating voltage	comments	
	straight ELKA	angled ELWIKA	straight ELST	angled ELWIST			
4	4012 PG 7	933 139-100	933 172-100	933 098-100	UC 250 V (\approx) ¹⁾	housing transparent, accessories LED insert ²⁾ plastic-coupling nut/thread	
	4012 PG 7 TO	933 210-199	933 173-199				
	4012 K PG 7	933 725-100	933 726-100	933 727-100			933 728-100
	4012 PG 9	933 169-100	933 174-100	933 162-100			933 166-100
5	5012 PG 7	933 170-100	933 175-100	933 163-100	UC 50 V (\approx)		
	5012 PG 9	933 171-100	933 176-100	933 164-100		933 168-100	

¹⁾ operating voltage without LED insert, type ELKA 4012 PG 7 TO and ELWIKA 4012 PG 7 TO

²⁾ LED insert PNP/normally open 933 405-001 E 2 LED PNP (DC 10...30 V)
LED insert NPN/normally open 933 404-001 E 2 LED NPN (DC 10...30 V)

Example for placing orders: 933 139-100 ELKA 4012 PG7



Appliance sockets and connectors for self-assembly with wire ends

Product features

Installation of controls and switch gear in housing (instead of standard PG screw couplings)

Variations

Appliance sockets and connectors for self-assembly with wire ends.

Basic data

- protection class IP 67 (IEC 60529)
- conductor color identification complies with European standards (EN 50044)

Further information

see technical data in the catalog Circular connectors for automation technique DS 280 490-450.

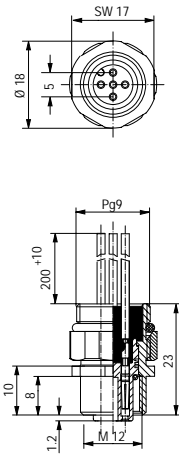

ELKE...PG 9

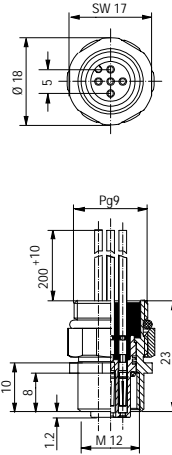

ELKE...PG 9 P

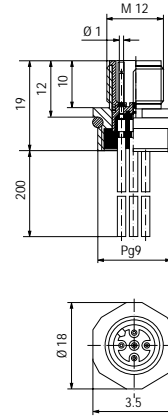

ELST...PG 9

poles		socket ELKE		plug ELST		operating voltage	comments
		contacts tin-plated	contacts gold-plated	contacts tin-plated	contacts gold-plated		
4	412 PG 9	933 039-100		933 916-206	933 216-106	UC 250 V (≈)	
	412 PG 9 P		933 044-100			UC 250 V (≈)	coding with adjusting nut, re-positionable
5	512 PG 9		933 040-100		932 878-100	UC 50 V (≈)	
	512 PG 9 P		933 045-100			UC 50 V (≈)	coding with adjusting nut, re-positionable

accessories: fastening nut with PG 9 thread 733 877-001 ELST M PG 9

Example for placing orders: 933 039-100 ELKE 412 PG9

Appliance sockets and connectors for front panel mounting

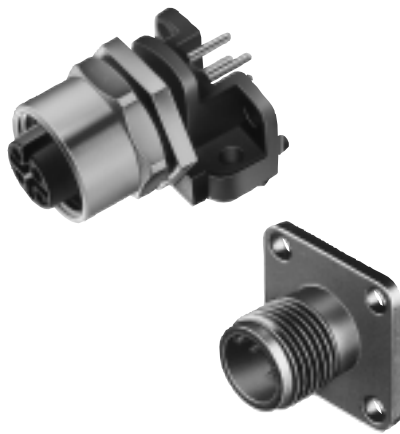

Product features

usage in housings of control systems, switch cabinets, sensors and actuators (combined front panel and circuit board installation especially for industrial mounting)

Variations

- cable sockets for combined front panel and circuit board installation
- cable plug for flange mounting

Basic data

- protection class IP 68 (IEC 60529)
- type of termination solder

Further information

see technical data in the catalog
Circular connectors for automation technique DS 280 490-450.

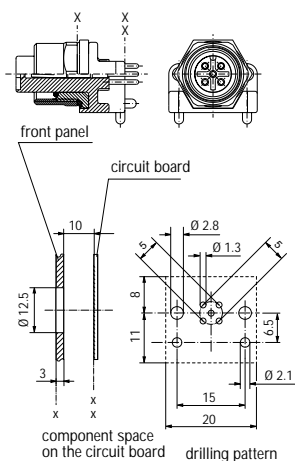

ELKE... FM

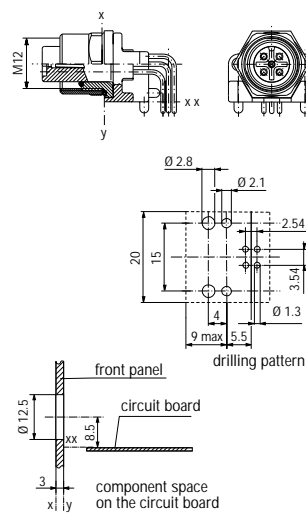

ELKE... FM H

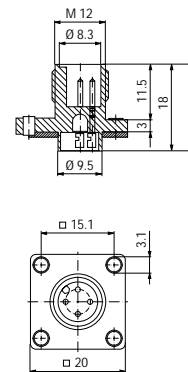

ELST 412 FA

poles	socket ELKE		plug ELST		operating voltage	comments
	contacts tin-plated	contacts gold-plated	contacts tin-plated	contacts gold-plated		
4	412 FM 412 FM H	933 279-100 933 395-100			UC 150 V (≈)	
	412 FA		932 328-206		UC 150 V (≈)	with flat gasket (only ELST 412 FA)
5	512 FM 512 FM H	933 551-100 933 821-100			UC 50 V (≈)	

Example for placing orders: 933 279-100 ELKE 412 FM

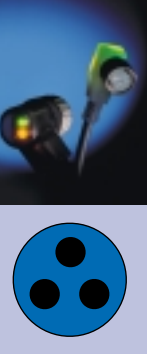

Appliance connectors for press-in fit

Product features

mounting in sensor tubes (press-in mounting) of proximity switches, photoelectric barriers etc.

Variations

- appliance connectors without thread
- appliance connectors with thread
- appliance connectors with thread and LED

Basic data

- protection class IP 68 (IEC 60529) (ELST 400/12 093 and ELST 400 L/12 093: IP 67)
- type of connection solder

Further information

see technical data in the catalog
Circular connectors for automation technique
DS 280 490-450.

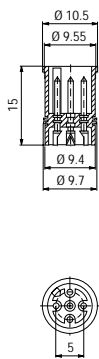

ELST 400/12 093
(without vent hole)

ELST L 400/12 093

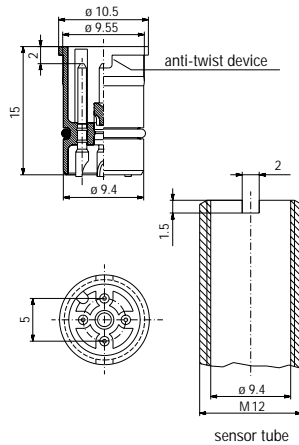

ELST 400 RD/12
(without anti-twist device)

ELST 400 RD/12 V

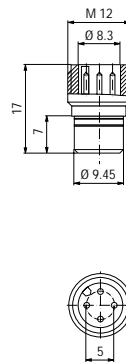

ELST 412

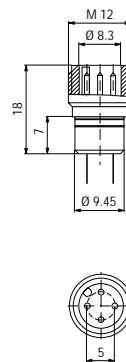

ELST 412 LED

poles		plug ELST		operating voltage	comments
		contacts tin-plated	contacts gold-plated		
4	400/12 093	932 440-206	932 440-106	UC 150 V (≈)	without vent hole
	400 L/12 093	932 416-206	932 416-106		with vent hole
	400 RD/12	932 559-406	932 559-306		with sealable vent hole
	400 RD/12 V	933 442-406	933 442-306		with sealable vent hole and anti-twist device
	412	932 902-206	932 902-106		without vent hole
	412 LED red	932 256-212	932 256-112	UC 50 V	without vent hole, LED max. 10 mA
	412 LED yellow	933 363-212	933 363-112	(≈)	without vent hole, LED max. 10 mA

Example for placing orders: 932 440-206 ELST 400/12 093

X-ON Electronics

Largest Supplier of Electrical and Electronic Components

Click to view similar products for [hirschmann](#) manufacturer:

Other Similar products are found below :

[931298001 GSP 211 PG11](#) [934828001 BRSCIS 4D/9](#) [930011200 MAB 6](#) [932326100 CA 6 GS](#) [G 30 KW 3 M](#) [831530400 CA 00 SD 1](#)
[934077105](#) [934066788](#) [934061103](#) [934059104](#) [930046100](#) [975090703](#) [943301-001](#) [934061704](#) [STAK2](#) [PRUEF1SW](#) [SPIDER-PL-20-](#)
[05T1999999TZ9HHHH](#) [BAT867-RUSW99AU999AT199L999ZHX](#) [930136106](#) [930317804](#) [934066105](#) [934076103](#) [934086104](#) [934086188](#)
[973929000](#) [934157101](#) [934077106](#) [934064104](#) [932794001](#) [973601101](#) [GECKO 4TX](#) [972309101](#) [934100707](#) [975455709](#) [975455701](#)
[973528101](#) [931297006](#) [MESAP 43650](#) [932140100](#) [STAK 3 N SCHWARZ](#) [932507005](#) [XZC 0704](#) [975694707](#) [MLSWG100/2.5RT](#) [BAT867-](#)
[RUSW99CU999AT199L999ZHX](#) [934081100](#) [934089101](#) [934090100](#) [973929001](#) [975017701](#) [975106101](#) [934157100](#)