

Color-Keyed®

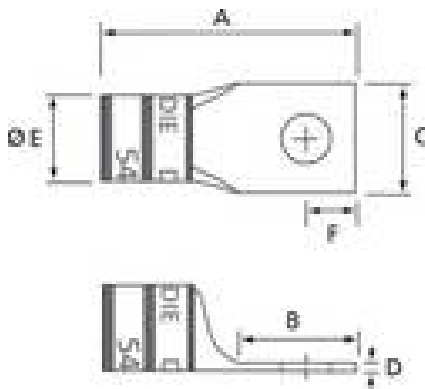

T&B Catalog Number:
UPC Number:
Description:

54145-TB
 78621054145
 Copper One-Hole Lug - Straight Standard Barrel - max 35KV, #2 AWG Wire, 1/2" Bolt Size, Tin Plated with Inspection Hole, Brown 33
Status: Active



WEB_USE

-T&B Product Line 007

General

-Material Copper
 -Finish Tin Plated
 -Wire Size #2 AWG
 -Number of Studs 1
 -Stud Size 1/2
 -Tongue Angle Straight
 -Barrel Length Standard
 -Barrel Shape Standard
 -Tongue Width Standard
 -Peep Hole Y
 -Marking Standard
 -Hole Shape Round
 -Die Color Brown
 -Die Code 33

Dimension Information

-B (inches) 1.08
 -E (inches) 0.41
 -F (inches) 0.5

Tooling

-Connector & Tooling Chart Available on Website

Packaging

-T&B Inner Pack 25
 -Package in Units 250
 -T&B Sold in UOM Each
 -T&B Weight Per UOM 3.58 lbs. per 100

Application Support

-T&B Instruction Sheets ta00675-tb2
 -Overview Available on Website
 -Connector & Tooling Chart Available on Website

Notes

- Dimensions given for reference only. Dimensions may vary up to +/- .030.

Certifications

-RoHS Compliance Yes

Certifications



File Nbr:
 E9809

For further technical assistance, please contact us...

Thomas & Betts - USA
8155 T&B Blvd.
Memphis, TN 38125
www.tnb.com

T&B Technical Support
MS 3B-50
8155 T&B Blvd.
Memphis, TN 38125

Hours: 7AM - 6PM CDT
Monday-Friday
Phone: (888) 862-3289
Fax: (901) 252-1321
Email: techsupport@tnb.com

X-ON Electronics

Largest Supplier of Electrical and Electronic Components

Click to view similar products for [abb](#) manufacturer:

Other Similar products are found below :

[TV10-516R](#) [017667013](#) [RF727](#) [2CMA100178R1000](#) [5SDD 92Z0401](#) [ESV14-BS](#) [EZS-21-250](#) [F204AC-40/0.03](#) [F362-25/0.03](#)

[GJL1211001R0011](#) [GJL1211201R8000](#) [GJL1211501R8000](#) [GJL1213001R0017](#) [GJL1213001R0101](#) [GJL1311001R0101](#) [GJL1311001R8010](#)

[GJL1311201R0001](#) [GJL1313001R0011](#) [GJL1313001R0101](#) [GJL1317201R0001](#) [AF09-30-01-11](#) [AF460-30-11-68](#) [1455](#) [EF45-30](#) [ERG297](#)

[HSC2-20](#) [1SAM201904R1001](#) [1SAM350000R1003](#) [1SAZ721201R1009](#) [1SAZ721201R1014](#) [1SAZ721201R1025](#) [1SFA611101R1002](#)

[1SFA611130R1103](#) [1SFA611131R1101](#) [1SFA611143R1101](#) [1SFA611202R1108](#) [1SFA611203R1108](#) [1SFA611215R1001](#)

[1SFA611216R1108](#) [1SFA611285R1002](#) [1SFA611702R6006](#) [1SFA616162R1025](#) [1SFA619100R3015](#) [1SVR730020R0200](#) [IPC4111](#)

[OS30FACC12](#) [OS60GJ03](#) [OVR1N160277PS](#) [OXC1L48](#) [254](#)