

Standard Barrel Copper Lug T&B Catalog Number:

54105

UPC Number:

78621054105

Status:

Active

Description:

Copper One-Hole Lug - Straight Standard Barrel - max 35KV, #6 AWG Wire, 1/4" Bolt Size, Tin Plated with Inspection Hole, Blue 24

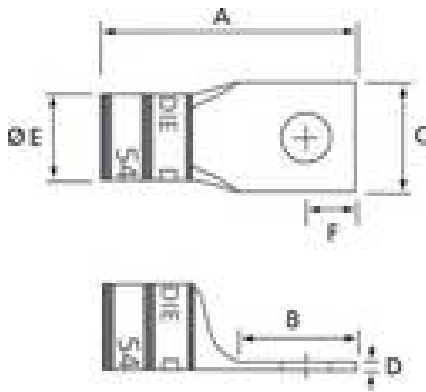

General

Material	Copper
Finish	Tin Plated
Wire Size	#6 AWG
Number of Studs	1
Stud Size	1/4
Tongue Angle	Straight
Barrel Length	Standard
Barrel Shape	Standard
Tongue Width	Standard
Peep Hole	Y
Marking	Standard
Hole Shape	Round
Die Color	Blue
Die Code	24

Dimension Information

A (inches)	1.23
B (inches)	0.53
C (inches)	0.44
D (inches)	0.07
E (inches)	0.31
F (inches)	7/32

Specifications

Voltage Rating	600V to 35KV
----------------	--------------

Tooling

Connector & Tooling Chart	Available on Website
---------------------------	----------------------

Packaging

T&B Inner Pack	50
Package in Units	500
T&B Sold in UOM	Each
T&B Weight Per UOM	1.32 lbs. per 100

Application Support

T&B Instruction Sheets	ta00675-tb2
Overview	Available on Website

Notes

Dimensions given for reference only. Dimensions may vary up to +/- .030.

Certifications

RoHS Compliance	Yes
-----------------	-----

Certifications



File Nbr:
E9809

For further technical assistance, please contact us...

Thomas & Betts - USA
8155 T&B Blvd.
Memphis, TN 38125
www.tnb.com

T&B Technical Support
MS 3B-50
8155 T&B Blvd.
Memphis, TN 38125

Hours: 7AM - 6PM CDT
Monday-Friday
Phone: (888) 862-3289
Fax: (901) 252-1321
Email: techsupport@tnb.com

X-ON Electronics

Largest Supplier of Electrical and Electronic Components

Click to view similar products for [abb manufacturer](#):

Other Similar products are found below :

[TV10-516R](#) [017667013](#) [RF727](#) [2CMA100178R1000](#) [5SDD 92Z0401](#) [ESV14-BS](#) [EZS-21-250](#) [F204AC-40/0.03](#) [F362-25/0.03](#)

[GJL1211001R0011](#) [GJL1211201R8000](#) [GJL1211501R8000](#) [GJL1213001R0017](#) [GJL1213001R0101](#) [GJL1311001R0101](#) [GJL1311001R8010](#)

[GJL1311201R0001](#) [GJL1313001R0011](#) [GJL1313001R0101](#) [GJL1317201R0001](#) [AF09-30-01-11](#) [AF460-30-11-68](#) [1455](#) [EF45-30](#) [ERG297](#)

[HSC2-20](#) [1SAM201904R1001](#) [1SAM350000R1003](#) [1SAZ721201R1009](#) [1SAZ721201R1014](#) [1SAZ721201R1025](#) [1SFA611101R1002](#)

[1SFA611130R1103](#) [1SFA611131R1101](#) [1SFA611143R1101](#) [1SFA611202R1108](#) [1SFA611203R1108](#) [1SFA611215R1001](#)

[1SFA611216R1108](#) [1SFA611285R1002](#) [1SFA611702R6006](#) [1SFA616162R1025](#) [1SFA619100R3015](#) [1SVR730020R0200](#) [IPC4111](#)

[OS30FACC12](#) [OS60GJ03](#) [OVR1N160277PS](#) [OXC1L48](#) [254](#)