

A durable three pin panel plug, with solder lug / spade terminals. Can be mounted above the panel on any thickness of material or below the panel for up to 2,0mm thick material. Suitable for use measuring instruments, SMPS, ITE and OA.

For panel cut-out, use punch number 974-0010 (pull through) or 906-0050 (punch and die).

Weight approximately 10g.

Approvals UL, CSA and TUV.

**MATERIAL HOUSING** : Nylon 66, black  
UL 94 V0

**CONTACTS** : Brass, nickel plate

**ELECTRICAL**  
Voltage Rating : 250 Vac  
Current Rating : 10 Amps  
Insulation Resistance : 1000 MΩ @500 Vac  
Withstanding Voltage : 2000 Vac for 1 minute between line to gnd.  
Temperature Range : -20°C to +80°C

**Dimensions**

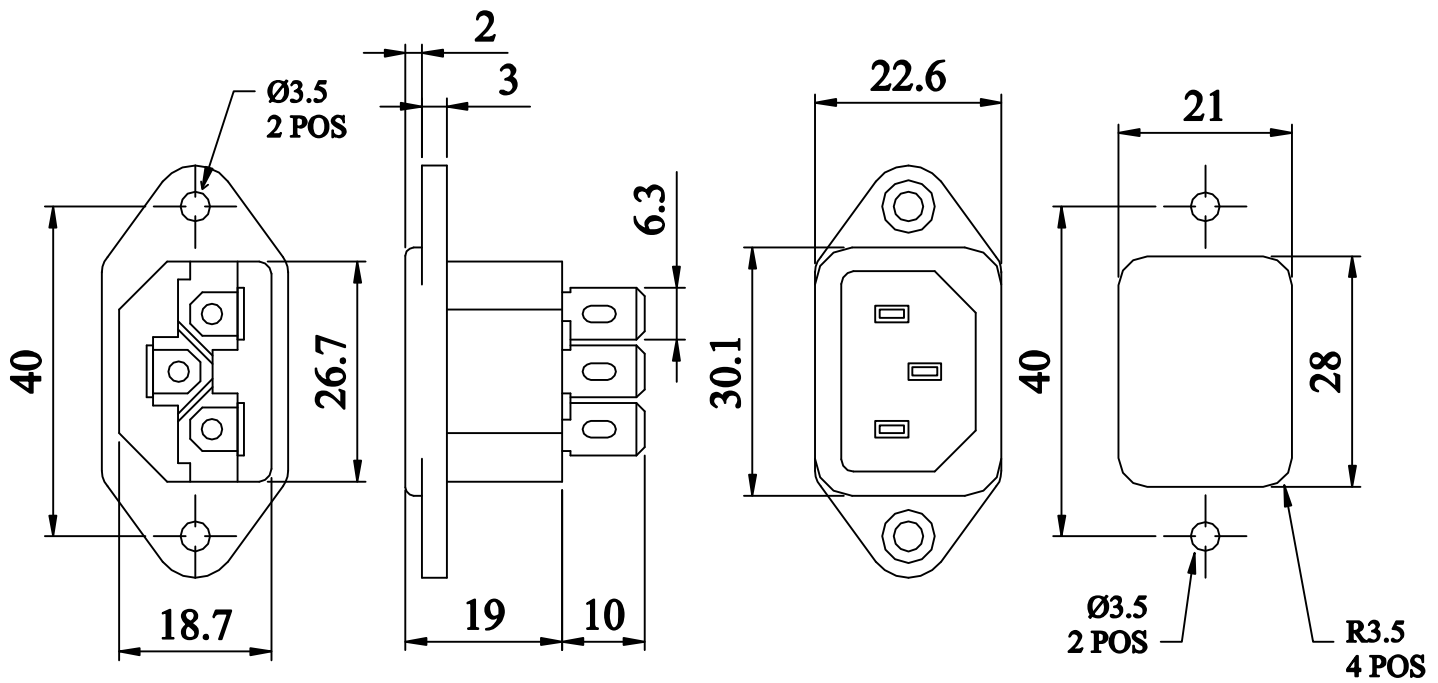

CONVERTED FROM PS0900 ISS1 (02.01.98) IN JAN 2003

DrqNo 520-0010		TITLE MAINS CONNECTOR - PANEL PLUG			ALL DIMENSIONS IN MM ANGLES IN DECIMAL DEGREES	
<b>DEM</b>	ISSUE 2	GENERAL SPECIFICATION FOR 520-0010		CUSTOMER FILTER REF		
		Aprvd Date 19.02.08	Aprvd By MC	Drwn by BS	Scale: NTS	Sheet 1 / 1

## X-ON Electronics

Largest Supplier of Electrical and Electronic Components

*Click to view similar products for [deltron](#) manufacturer:*

Other Similar products are found below :

[610-0700](#) [610-0800](#) [611-0400](#) [650-0300](#) [651-0300](#) [651-0800](#) [342-0000](#) [W127G](#) [066541F](#) [066542D](#) [630-0600](#) [W205C](#) [W106C](#) [611-0700](#)  
[717-0400](#) [456-0020](#) [460-0070](#) [479-0020-5](#) [486-121209-66](#) [480-C010](#) [490-170805E-68](#) [459-0080](#) [459-0140](#) [590-0700](#) [MDU14S](#) [4MP2616](#)  
[461-0050](#) [487-221208E-68](#) [571-0400-01](#) [480-C040](#) [462-0020E](#) [4DR3522](#) [487-261612E-66](#) [486-261609-68](#) [466-0050](#) [356-0200](#) [702-0500](#)  
[711-0500](#) [552-0600](#) [WHT](#) [487-261609E-66](#) [487-221209E-68](#) [462-0040A](#) [456-0030](#) [461-0070E](#) [490-040503A-68](#) [486-S68-2616](#) [800-0400](#)  
[4ELM6](#) [483-0100](#) [483-0030](#)