

# ADAPTERS, BETWEEN-SERIES

SMA / GPO™ or SMP, DC - 18 GHz

## SPECIFICATIONS:

Models: 5190xx, 5191xx, 5192x, 5193x

**RoHS**  
Compliant

<b>Electrical:</b>	
Frequency Range	DC - 18.0 GHz
VSWR	1.20:1 Max.
Impedance	50 Ohms
Operating Temp Range	-65°C to +125°C
<b>Mechanical:</b>	
SMA Connectors	Passivated Stainless Steel
Mates with MIL-STD-348	
GPO™ /SMP Connectors	Gold Plated Beryllium Copper
(GPO Connectors Mate with SMP Connectors IAW MIL-STD-348)	
Conductors	Gold Plated Beryllium Copper
GPO is a trademark of Corning Gilbert Inc.	



Model Number: **5190XX**  
GPO™/SMP Male to SMA Male

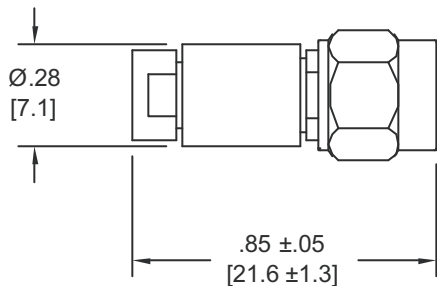

Model Number: **5191XX**  
GPO™/SMP Male to SMA Female

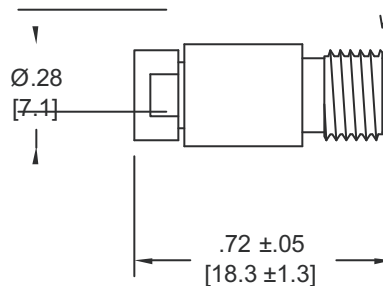

Model Number: **5192X**  
GPO™/SMP Female to SMA Male

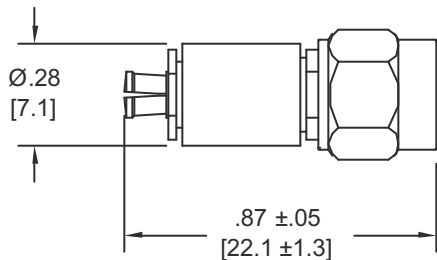

Model Number: **5193X**  
GPO™/SMP Female to SMA Female

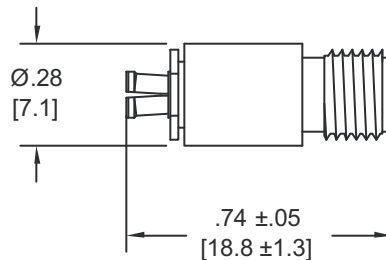

## HOW TO ORDER:

Model Number: **519XYZ**

Base Number  
As Shown Above

Connector Type  
G = GPO™ Connectors  
P = SMP Connectors

Connector Style  
= Full Detent Male Interface  
Force to Engage: 15.0 Lbs. Max.  
L = Limited Detent Male Interface  
Force to Engage: 5.0 Lbs. Max.

## Ordering Examples:

Model Number: **5190G**  
GPO™ Male/SMA Male  
GPO™ Male has Full Detent Interface

Model Number: **5191PL**  
SMP Male/SMA Female  
SMP Male has Limited Detent Interface

Model Number: **5193P**  
SMP Female/SMA Female

Note: Dimensions in Brackets are Expressed in Millimeters and are for Reference Only.

5190: REV D



Aeroflex / Inmet, Inc. • 300 Dino Drive, Ann Arbor, MI 48103 • U.S.A.  
888-244-6638 or 734-426-5553 • FAX: 734-426-5557  
www.aeroflex.com/inmet • inmet@aeroflex.com

## X-ON Electronics

Largest Supplier of Electrical and Electronic Components

*Click to view similar products for [RF Connectors / Coaxial Connectors](#) category:*

*Click to view products by [Aeroflex](#) manufacturer:*

Other Similar products are found below :

[R125315120](#) [8915-1511-000](#) [89674-0827](#) [5916-1103-603](#) [0106-001-000](#) [6-0001-3](#) [6001-7071-019](#) [6002-7051-003](#) [6002-7551-202](#) [6059674-1](#) [619550-1](#) [630059-000](#) [M39012/25-0021](#) [M39012/79-3008](#) [M39030/3-01N](#) [M39030/3-03N](#) [M3933/25-29N](#) [M3933/25-36N](#) [6500-7071-046](#) [6501-1071-002](#) [M83723/72W24576](#) [M83723/72W2457N](#) [6769](#) [CX050L2AQ](#) [7002-1541-010](#) [7002-1572-002](#) [7003-1572-002](#) [7004-1512-000](#) [7009-1511-004](#) [7010-1511-000](#) [7029-1511-060](#) [7101-1541-010](#) [7101-1571-002](#) [7105-1521-002](#) [7145-1521-002](#) [7209-1511-011](#) [7210-1511-012](#) [7210-1511-015](#) [7210-1511-019](#) [7210-1511-040](#) [7225-1512-050](#) [7242-1511-000](#) [73137-5015](#) [73251-0111](#) [73251-0672](#) [73276-1501](#) [73366-0013](#) [73404-2300](#) [73413-6080](#) [734151610](#)