

The supplier acknowledges that, with the acceptance of the drawing, he is in a position to manufacture the illustrated part in accordance with the drawing in reproducible form and series production. Through the selected manufacturing processes no impairments will arise in the material and structure which could subsequently lead to an impairment of the component. Verbal agreements over and above that are not valid. Deviations from this rule must be written and must be signed by the purchaser.

This drawing may not be copied, reproduced or made available to third parties in any way whatsoever without or prior written approval.

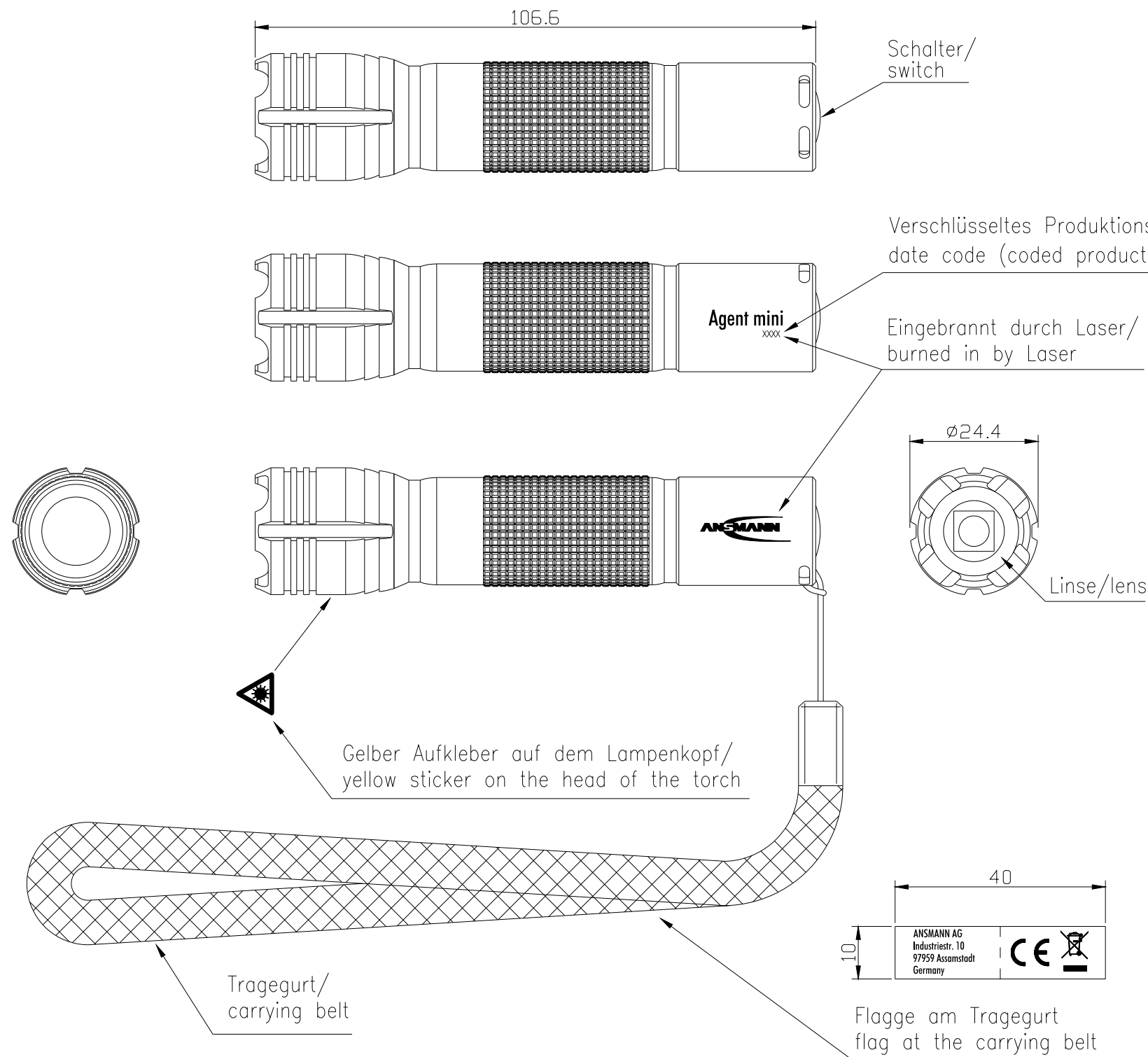

- Technische Daten Lampe/
technical data lamp
- Leuchtmittel/
illuminant : 1.0W CREE LED
 - Lebensdauer/
Life-time : ca./approx. 50.000h
 - Zellenzahl/
number of cells : 1x AA Mignon 1.5V Batterien/batteries
(Alkaline; LR6/MN1500/AM3)
 - Schalterfunktion/
switch function : Schalt- und Tastfunktion/
Switch and push-button function
 - Leuchtweite (ANSI FL1)/
beam range (ANSI FL1) : 80m
 - Sichtweite/
visual range : 150m
 - Leuchtdauer/
operating time : 3h
 - Helligkeit/
brightness : 50 Lumen
3000 Lux
 - Schutzart/
protection : IP67
 - Gehäuse/
housing : Aluminiumgehäuse, schwarz
aluminiumhousing, black
 - Gewicht/
weight : 75.5g inkl. Batterie und Clip/
75.5g incl. battery and clip
 - Approbationen/
approvals : CE
 - Lieferumfang/
shipment : -2x AA Mignon 1.5V Batterien/batteries
(Alkaline; LR6/MN1500/AM3)
-Tragegurt/
lanyard
-Gürtelclip
belt clip

Bügel/clip

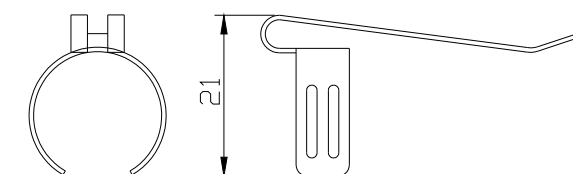
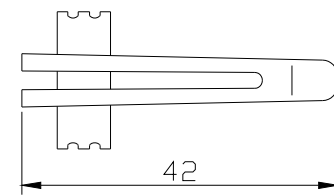

Schalt- und Tastfunktion
Schaltfunktion: An/Aus
Tastfunktion: Kurzzeitiges Anschalten
(solange getastet wird; nur im ausgeschalteten Zustand)

Switch and push-button function
Switch function: On/Off
Push-button function: momentary turning on
(as long as being pushed; only when turned off)

Verwendungsbereich/Application range für Anfrage/for inquiry AN201167Amini				Zul. Abweichung/ Allowable deviation	Oberfläche/ Surface	Maßstab/Scale (DIN A3): 1:1	Gewicht/Weight
						Werkstoff/Work material, Modell-Nr.	
				2012	Datum/Date	Name	
				Erstellt/ Drawn by	01.08	KA	
V2	technical data updated	16.09.14	SIT	Zeichnungsname/Drawing name Agent mini – neues Design/ Agent mini – new Design			
V2	date code changed and address added	21.01.14	CF				
V1	technical data updated	28.08.13	CB				
V0	dimensions updated	18.09.12	DC				
V0	Length & technical data updated	09.08.12	DC				
V0	---	01.08.12	KA	Zeichnungsnummer/Drawing number Artikelnummer/Part number		1600-0033	
Version		Änderung/Change	Datum/Date			Name	Ursprung/Origin Proj. 063/22/12
				Ersatz für/Replaced by		Ersatz durch/Replacement through:	



X-ON Electronics

Largest Supplier of Electrical and Electronic Components

Click to view similar products for [ansmann](#) manufacturer:

Other Similar products are found below :

[5020012](#) [1000-0003](#) [5013233](#) [5030992](#) [1520-0004](#) [1501-0004-1](#) [1001-0020-UK](#) [2312-3003](#) [1250-0013](#) [1600-0199](#) [5030902](#) [1900-0019](#)
[1001-0014-UK](#) [5035362](#) [5013243](#) [5707173](#) [1600-0137](#) [5035391](#) [5000023](#) [5311113 / APS 1000](#) [1600-0138](#) [1250-0014](#) [BCA120-350](#) [1600-0145](#) [5015293](#) [5030982](#) [2311-3003](#) [5030802](#) [10950964/01](#) [5030912](#) [5016243](#) [5035222](#) [2310-3001](#) [5030641](#) [5001183](#) [1600-0154](#) [5035352](#)
[5035342](#) [ACS310](#) [5035202](#) [5015332](#) [5035201](#) [5015303](#) [2311-3002](#)