

EPIC® H-B 6 Housings

Housing style H-B. The industry standard.



H-B 6 TG

Suitable inserts:

- EPIC® H-BE 6 Screw termination see page 443
- EPIC® H-DD 24 see page 440
- EPIC® H-EE 10 see page 449
- EPIC® MCR 6 see page 462
- EPIC® H-BE 6 Crimp termination see page 443
- EPIC® H-BE 6 Cage clamp see page 443

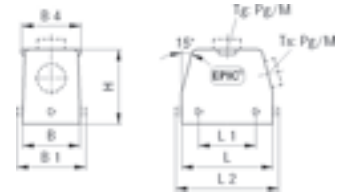

H-B 6 TGH

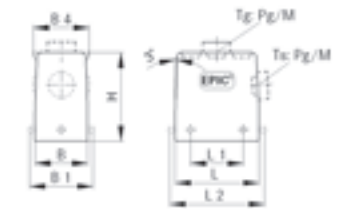

H-B 6 TS

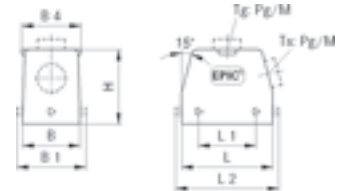

Part number	Part	PG	M	ZW	L	I2	B	B4	H
H-B housing: Hood (straight cable entry, bolts for single lever)									
10011000	H-B 6 TG 13,5	13,5		yes	60	74,8	43	45	52
10021000	H-B 6 TG 16	16		yes	60	74,8	43	45	52
19011000	H-B 6 TG M20		20		60	74,8	43	45	52
19021000	H-B 6 TG M25		25		60	74,8	43	45	52
H-B housing: Hood (straight cable entry, bolts for single lever, high version)									
70020200	H-B 6 TGH 21	21		yes	60	74,8	43	45	72
70020400	H-B 6 TGH 29	29		yes	60	74,8	43	45	72
79020200	H-B 6 TGH M25		25		60	74,8	43	45	72
79020400	H-B 6 TGH M32		32		60	74,8	43	45	72
H-B housing: Hood (side cable entry, bolts for single lever)									
10012000	H-B 6 TS 13,5	13,5		yes	60	74,8	43		52
10022000	H-B 6 TS 16	16		yes	60	74,8	43		52
19012000	H-B 6 TS M20		20	yes	60	74,8	43		52
19022000	H-B 6 TS M25		25	yes	60	74,8	43		52

EPIC® H-B 6 Housings

Housing style H-B. The industry standard.



H-B 6 TSH

Suitable inserts:

- EPIC® H-BE 6 Screw termination see page 443
- EPIC® H-DD 24 see page 440
- EPIC® H-EE 10 see page 449
- EPIC® MCR 6 see page 462
- EPIC® H-BE 6 Crimp termination see page 443
- EPIC® H-BE 6 Cage clamp see page 443



H-B 6 AG-LB



H-B 6 AD-LB

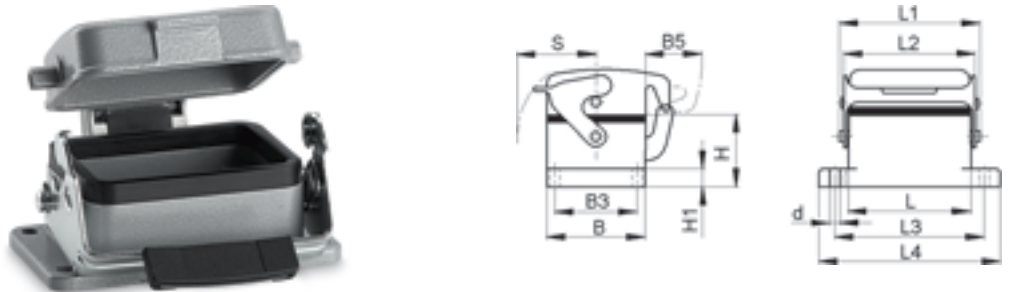

Part number	Part	PG	M	ZW	L	L1	I2	L3	L4	B	B3	B4	B5	H	H1	s	d
H-B housing: Hood (side cable entry, bolts for single lever, high version)																	
70022200	H-B 6 TSH 21	21		yes	60		74,8			43		45		72			
70022400	H-B 6 TSH 29	29		yes	60		74,8			43		45		72			
79022200	H-B 6 TSH M25		25		60		74,8			43		45		72			
79022400	H-B 6 TSH M32		32		60		74,8			43		45		72			
H-B housing: Panel mount base (single lever)																	
10003000	H-B 6 AG-LB				60	74,8	70	70	80	43	32		25	27,8	4	44	4,3
H-B housing: Panel mount base (cover, single lever)																	
10004000	H-B 6 AD-LB				60	74,8	70	70	80	43	32		25	27,8	4	44	4,3

The standard inserts with screw termination, crimp termination and cage clamp termination



H-BE 6 screw termination

The characteristic qualities of the proven EPIC® H-BE series are their suitability for applications with high voltages and current as well as their high reliability.

Ranges of application:
From machine building to control cabinet manufacturing, Light & Sound, polymer engineering

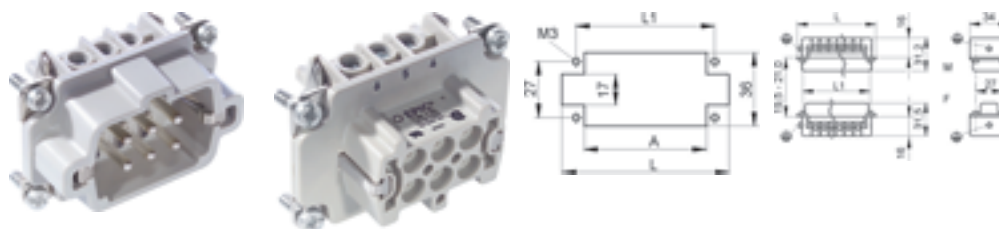

Suitable housing:

EPIC® H-B 6 Housings see page 485

H-BE 6 crimp termination

Suitable housing:

EPIC® H-B 6 Housings see page 485

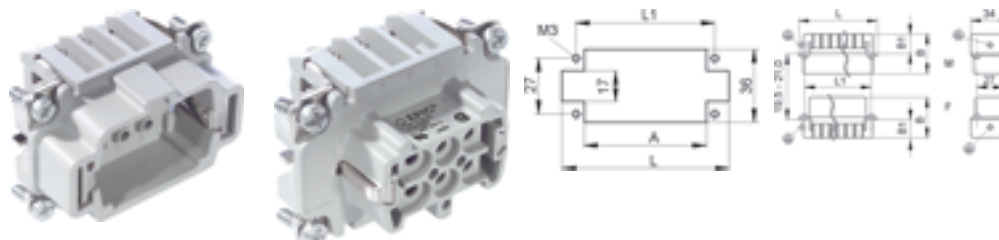

Suitable contacts:

EPIC® H-BE 2,5 machined contacts see page 466

H-BE 6 cage clamp

Suitable housing:

EPIC® H-B 6 Housings see page 485

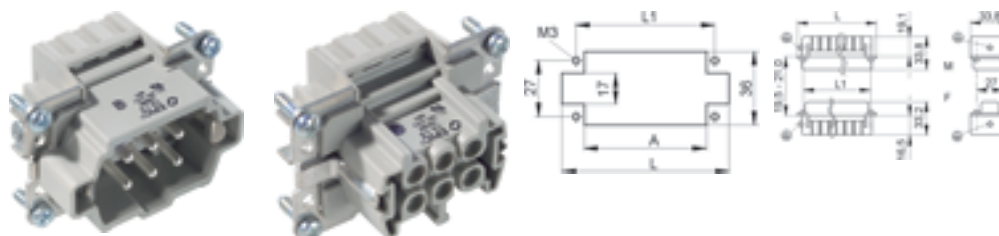

Technical Data

Rated voltage
IEC: 500 V
UL: 600 V
CSA: 600 V

Rated impulse Voltage
6 kV

Rated current
IEC: 16 A
UL: 16 A
CSA: 16 A

Pollution degree
3

Contact resistance
EPIC® H-BE 6 Screw termination
< 2 mOhm
EPIC® H-BE 6 Crimp termination
< 2 mOhm
EPIC® H-BE 6 Cage clamp
1.5 - 4 mOhm

Contacts
EPIC® H-BE 6 Screw termination
Copper alloy, hard silver plated
EPIC® H-BE 6 Crimp termination
Copper alloy, hard silver / gold plated
EPIC® H-BE 6 Cage clamp
Copper alloy, hard silver plated

Numbers of contacts
6 + PE

Termination methods
EPIC® H-BE 6 Screw termination
Screw termination: 0.5 - 2.5 mm²
EPIC® H-BE 6 Crimp termination
Crimp termination: 0.5 - 4.0 mm²
EPIC® H-BE 6 Cage clamp
Cage clamp termination: 0.5 - 2.5 mm²

Cycle of mechanical operation
100

Range of temperature
-40°C - +100°C, temporary up to +125°C

Part number	Part	Version	Type	Wire protection	Contacts	L	L1	A	B	B1
H-BE 6 screw termination										
10190000	H-BE 6 SS	male		yes	1 - 6	51	44	39		
10191000	H-BE 6 BS	female		yes	1 - 6	51	44	39		
10190100	H-BE 6 SS	male		-	1 - 6	51	44	39		
10191100	H-BE 6 BS	female		-	1 - 6	51	44	39		
H-BE 6 crimp termination										
10180000	H-BE 6 SCM	male	machined		1 - 6	51	44	39	33	18
10181000	H-BE 6 BCM	female	machined		1 - 6	51	44	39	34	18
H-BE 6 cage clamp termination										
10400000	H-BE 6 SF	male			1 - 6	49,8	44	39		
10401000	H-BE 6 BF	female			1 - 6	49,8	44	39		

VDE approval is not valid for applications using the cage clamp termination

5.1 EPIC® CERTOSA M & PG

Kabelverschraubungen PG / Cable glands PG thread / Presse-étoupes pas PG

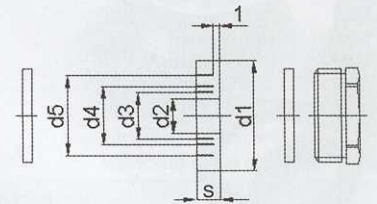

EPIC® SP

Art.Nr. part No. N° art.	PG	d1	d2	Kabel Ø cable Ø câble Ø	d3	Kabel Ø cable Ø câble Ø	d4	Kabel Ø cable Ø câble Ø	d5	Kabel Ø cable Ø câble Ø	s	SW mm opening of the spanner ouverture de clef	VPE packing unit conditionner
12957100	11	16,5	7,5	6,5-8,5	10	9-11	12,5	11,5-12			6	19	10
12957200	13,5	18,3	7,5	6,5-8,5	10	9-11	12,5	11,5-13,5			6	21	10
12957300	16	20,4	7,5	6,5-8,5	10	9-11	12,5	11,5-13,5	15	14,9-16	7	23	10
12957400	21	25,9	10	9-11	13	12-14	16	15-17	19	18-20	8	30	10

Material / material / matière: Polystyrol

Schutzart / protection class / degré de protection: IP 54 (DIN 46320)

Temperaturbereich / temperature range / gamme de température: -20 °C bis +55 °C

5

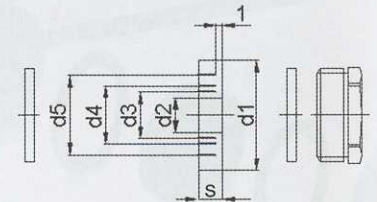

EPIC® SM

Art.Nr. part No. N° art.	PG	d1	d2	Kabel Ø cable Ø câble Ø	d3	Kabel Ø cable Ø câble Ø	d4	Kabel Ø cable Ø câble Ø	d5	Kabel Ø cable Ø câble Ø	s	SW mm opening of the spanner ouverture de clef	VPE packing unit conditionner
12954100	9	13,3	5	4-6	7,5	6,5-8,5	10	9-10			5,5	15	25
12954200	11	16,5	7,5	6,5-8,5	10	9-11	12,5	11,5-12			6	18	5
12954300	13,5	18,3	7,5	6,5-8,5	10	9-11	12,5	11,5-13,5			6	20	5
12954400	16	20,4	7,5	6,5-8,5	10	9-11	12,5	11,5-13,5	15	14-16	7	22	5
12954500	21	25,9	10	9-11	13	12-14	16	15-17	19	18-20	8	28	5
12954600	29	34,7	18	17-19	21	20-22	24	23-25	27	26-28	9,5	37	5
12954700	36	44,7	24	23-25	27	26-28	30	29-31	33	32-34	12	47	5
12954800	42	51,7	30	29-31	33	32-34	36	35-37	39	38-40	14	54	5

Material / material / matière: Metall, Messing vernickelt / metal, brass, nickel plated / métallique, laiton nickelage

Schutzart / protection class / degré de protection: IP 54 (DIN 46320)

Temperaturbereich / temperature range / gamme de température: -40 °C bis +80 °C

X-ON Electronics

Largest Supplier of Electrical and Electronic Components

Click to view similar products for [epic manufacturer](#):

Other Similar products are found below :

[44420040 + 73002716](#) [19426500](#) [72004000 + 73018000](#) [13.1623](#) [HBE24-FK-SE-PM-M20](#) [11161000](#) [11.1610](#) [10.4225](#) [9198+00022030](#)
[72004000 + 73002756](#) [72000010](#) [10.5310](#) [10.4264+10.4310](#) [72040010](#) [HA4-FK-TE-SM-M-M20](#) [10.4310](#) [8883+00022030](#)
[10.1270+10.1970+12.9545](#) [10.4220+10.4320](#) [10.4265+10.4235+10.4200+10.4210](#) [10121000+10196000+12954500](#) [10.0720](#) [44420037 +](#)
[73002752](#) [10102000](#) [10.4264](#) [72004000 + 73002716](#) [8990+00022030](#) [44420037 + 73018000](#) [10.1210+10.1960+12.9545](#) [10.4881](#) [10431000](#)
[10.1920](#) [10.0220+10.0030+10.1900+10.1910+12.9544](#) [44420037 + 73028500](#) [10.4861](#) [10.4265+10.4295+10.4200+10.4210](#) [13.1622](#)
[44420037 + 73002716](#) [10.1900](#)