

Miniature Pushbutton Switches

Specifications:

Contact rating:	250 V AC, 1 A / 125 V AC, 3 A 24 V DC, 2 A
Contact resistance:	< 30 mΩ
Insulation resistance:	> 500 MΩ at 500 V DC
Dielectric strength:	1000 V, 50 Hz for the duration of 1 minute
Operating temperature:	- 45° to + 110° C
Mechanical life:	minimum 30 000 operations
Contacts:	coin silver, also available gold-plated, version G (see page 4)
Terminals:	solder tags
Material:	phenolformaldehyde MSP 103 B black, MSP 103 C brown
Mounting:	bushing M 6 x 0,75
Soldering conditions:	hand-soldering – max.: 20 W, 3 sec, 350° C

3

Models:

Switching functions

S P D T

MSP 103 B
MSP 103 C

on – (mom)
off – mom

Button colour: orange

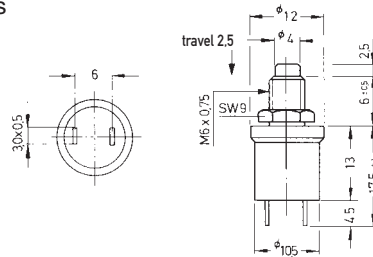

S P D T

MSP 103 BK
MSP 103 CK

on – (mom)
off – mom

Buttons see page 36

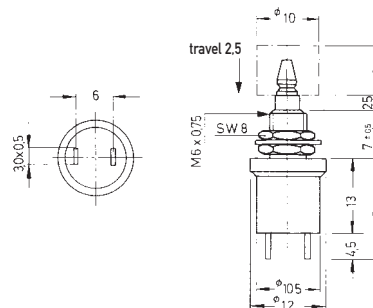

Unless otherwise specified, switches are delivered with button KM 405 (black).

Miniature Pushbutton Switches

Specifications:

Contact rating:	250 V AC, 0,3 A / 125 V AC, 0,6 A 30 V DC, 1 A
Contact resistance:	< 50 mΩ
Insulation resistance:	> 1000 MΩ at 500 V DC
Dielectric strength:	1000 V, 50 Hz for the duration of 1 minute
Operating temperature:	- 30° to + 65° C
Mechanical life:	minimum 250 000 operations
Contacts:	silver
Terminals:	solder tags or PC terminals
Material:	case: DAP, button: PA
Mounting:	bushing Ø 6,35 mm – 40 UNS, key 8 mm or on pc-board
Soldering conditions:	hand-soldering – max.: 5 sec, 300° C auto-soldering – max.: 5 sec, 260° C

3

Models:

Switching functions

SPDT

MSP 113 F

mom - on

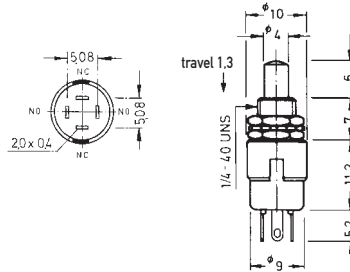

SPDT

MSP 113 F - PC

mom - on

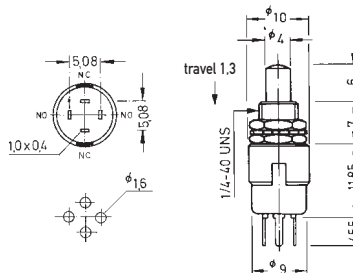

Circuit diagram:



Accessories:

Buttons (height 7,5 mm)	Ø	
black	10 mm	KM 485
red	10 mm	KM 489



Miniature Pushbutton Switches

Specifications:

Contact rating:	250 V AC, 0,5 A / 120 V AC, 1 A 28 V DC, 1 A
Contact resistance:	< 40 mΩ
Insulation resistance:	> 100 MΩ at 500 V DC
Dielectric strength:	500 V, 50 Hz for the duration of 1 minute
Temperature range:	- 30° to + 85° C
Mechanical life:	minimum 250 000 operations
Contacts:	phosphor bronze, silver-plated
Terminals:	PC terminals, phosphor bronze silver-plated
Material:	case: copper alloy, nickel-plated / nylon-66 button: POM
Mounting:	single-hole mounting, 1/4" – 40 UNS – 2A THD or on pc-board
Soldering conditions:	auto-soldering – 3 sec ± 0,5 sec, 250° C

3

Models:

Switching functions

S P D T

MSP 101 A

on - off

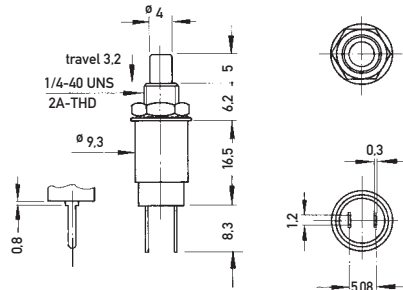

S P D T

MSP 101 A - RA

on - off

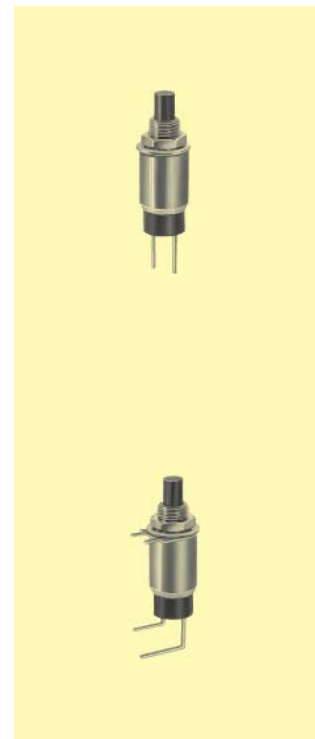
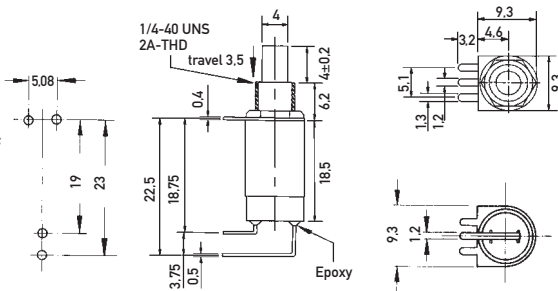

X-ON Electronics

Largest Supplier of Electrical and Electronic Components

Click to view similar products for [knitter-switch](#) manufacturer:

Other Similar products are found below :

[MTG106F](#) [YME IP 12L-U](#) [YME IP 01 B](#) [YME IP 16 N](#) [MTG 406 N](#) [MTG 406 P](#) [DBS2104](#) [MTA106E](#) [YME IP 12 D](#) [YME IP 01 A](#) [YME IP 12 H](#) [YME IP 12L](#) [YME IP 16 I](#) [LP 2 S NG](#) [MTE 306 E](#) [MTG206PA](#) [MTE 106 E](#) [MTG 106 H](#) [MTL 206 PA](#) [DPWL 1 CG D2D-RG](#) [MTE 206 S](#) [MTE 406 N](#) [DRS 13016](#) [ATE1E](#) [ATE 1 E RA](#) [DPWL 1 CG D1A-RG](#) [MTA 206 T](#) [MTA 406 S](#) [MTA206S](#) [DPWL 1 CG D1A-GR](#) [DPWL 1 CG D2D-GR](#) [LD 32 S](#) [FT 1 E](#) [DPW1AG-B](#) [DPW 1 AG-O](#) [MRS12V-19](#) [ATE 2 H](#) [DPW 1 BG D1P-R](#) [DPW 1 BG D2P-G](#) [DPW 1 BG D2P-R](#) [DPW 1 BG S-R](#) [MPLS12F-W](#) [ATE1G](#) [MSP103C](#) [MSS3122N-R](#) [MTE106H](#) [MTE 206 PA](#) [MTG206S](#) [LD 34 S](#) [LD60S](#)