

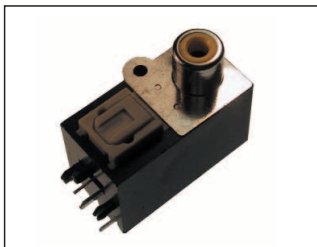

OTJ-5/ORJ-5 Single Optical Transmitter and Receiver Jack. Right angle PCB mount with self tapping hole for panel mounting. Hinged shutter.

**OTJ-5 (FC684205T)
ORJ-5 (FC684205R)**

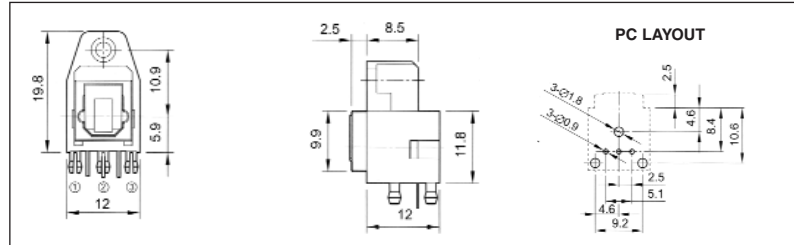

OTJ-6/ORJ-6 Dual SPDIF RCA and Optical Transmitter and Receiver Jack. Right angle PCB mount with self tapping hole for panel mounting. Hinged shutter. Several different colored inserts available.

**OTJ-6 (FC684206T)
ORJ-6 (FC684206R)**

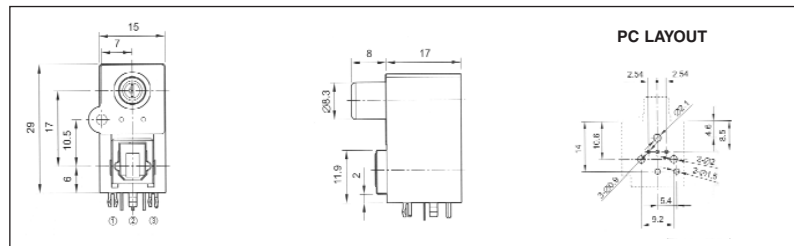

OTJ-8/ORJ-8 Optical Transmitter and Receiver Jack. Right angle PCB mount. Hinged shutter.

**OTJ-8 (FC684208T)
ORJ-8 (FC684208R)**

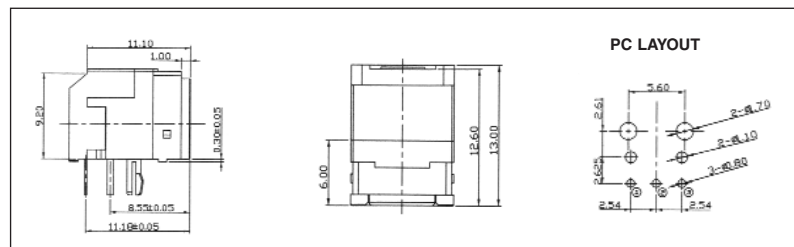

Electrical Specifications:

Supply Voltage: -0.5 to 7.0V Maximum.

Input Voltage: -0.5 to +0.5V Maximum.

Operating Temperature: -20 deg. C to +70 deg. C Maximum.

Storage Temperature: -30 deg. C to +80 deg. C Maximum.

Soldering Temperature: 260 deg. C Maximum.

Mechanical Specifications:

Insertion Force: 5.9N Minimum, 39.2N Maximum.

Withdrawal Force: 5.9N Minimum, 39.2N Maximum.

Materials:

Body: PBT +30G, ABS 94-V-0 (depends on model)

Shutter: Nylon PA66

Please refer to the individual technical data sheets available for each model for the recommended operating conditions, characteristics, PC layouts and technical information. We also manufacture molded optical lead assemblies for use with our optical jacks. Please contact our sales office for more details.

X-ON Electronics

Largest Supplier of Electrical and Electronic Components

Click to view similar products for [cliff](#) manufacturer:

Other Similar products are found below :

[CL-SFE/1 FILTERS](#) [CIH206011](#) [FM686813](#) [CP30152](#) [CP30211](#) [CP303011X](#) [CP30173](#) [CP30176](#) [CP30178](#) [CP30179](#) [CP30180](#) [CP30500C](#)
[FC6141](#) [CP30202M3](#) [CP30201](#) [FCR1295](#) [FCR2065](#) [CL19192RB](#) [CP30208NX](#) [FCR7360B](#) [FM686816](#) [CIH29950](#) [CP30225SM](#) [CL681561](#)
[CP30170](#) [CP30174](#) [CIH684216](#) [FCR2062](#) [FW6190](#) [CP30182](#) [CP30184](#) [CP30202M](#) [CIH3021](#) [CP30208NMB](#) [CP30230X](#) [FM686806](#)
[CL1396](#) [CL1110](#) [CP30181](#) [CP30183](#) [CP30202M3B](#) [CIH3007](#) [CL2075S](#) [BS300LLL](#) [FCR79910RB](#) [CIH30240B](#) [CL2076S](#) [CL2160B](#) [TP/6](#)
[CS](#) [DC8](#) [CP303090X](#)