

FCS-01

Flow Switch

FCS Series

3/8" BSP Male threaded fittings
Suitable for hot and cold potable water
Reed Switch Reliability File E125629
Meets UL 94-HB flammability rating
Food grade material



✓RoHS

The FCS-01

From our range of flow switches sensors which offer design engineers reed switch reliability. The design allows for sensing in line flow of liquid or air.

dimensions

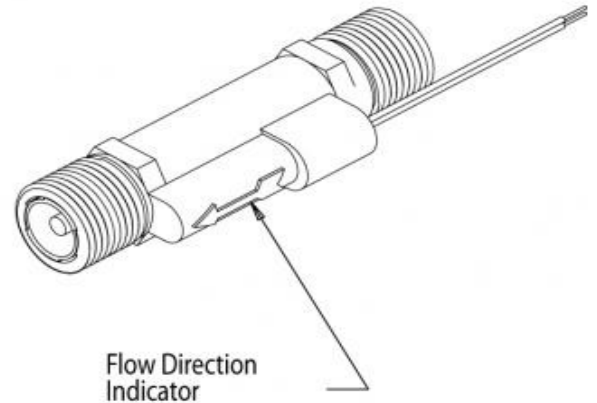
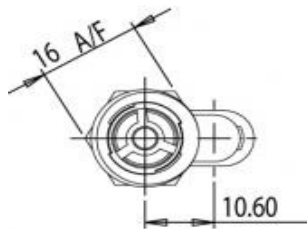

FEATURES

- Rugged high grade Noryl
- Minimum pressure drop
- Operates from a small head of water
- Mount in any axis
- Suitable for water and air flow switching

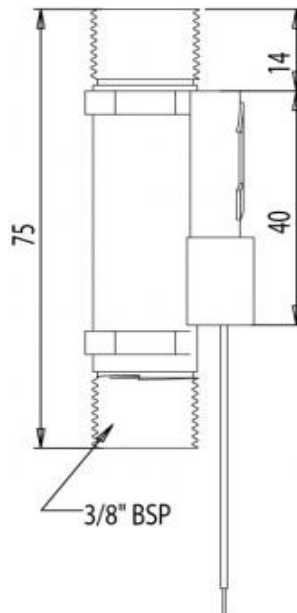

APPLICATIONS

- Leak detection
- Flow sensing
- Mains water control
- Cooling systems
- Circulation pump protection

performance specifications

Material, Design and Operation

Mounting	Any Axis
Housing Material	Noryl
Housing Colour	Black
Fitting	In Line
Contact Form	A
Contact Material	Ruthenium
Maximum Switching Volts (VAC)	250
Maximum Switching Volts (VDC)	200
Maximum Switching Current (Amp)	1
Maximum Power (Watt)	40
Connection Type	Stripped Cables
Cable Type	22AWG, 16/0.2mm PVC insulated
Cable Length	2 x 0.5M single insulated
Cable Colour	Black/Black
Operate Flow Rate (L/min)	0.6 +/- 0.5
Operate Temperature Range	-30°C to +85°C
Medium/Liquid	Water
Sealing Component	Not provided
Mounting Shock	50g for 11mS duration
Operate Mode	N/O, close with Flow
IP Rating	IP65

The information in this sheet has been carefully reviewed and is believed to be accurate; however, no responsibility is assumed for inaccuracies. Furthermore, this information does not convey to the purchaser of such devices any license under the patent rights to the manufacturer. Measurement Specialties, Inc. reserves the right to make changes without further notice to any product herein. Measurement Specialties, Inc. makes no warranty, representation or guarantee regarding the suitability of its product for any particular purpose, nor does Measurement Specialties, Inc. assume any liability arising out of the application or use of any product or circuit and specifically disclaims any and all liability, including without limitation consequential or incidental damages. Typical parameters can and do vary in different applications. All operating parameters must be validated for each customer application by customer's technical experts. Measurement Specialties, Inc. does not convey any license under its patent rights nor the rights of others.

ordering info

The FCS-01 is from our FCS Series of Flow Switches.

The Series is available in alternatives with a number of standard options including:

- Housing materials
- Installation axis
- Connection threads
- Operate flow rates
- Cable types
- Cable lengths

Please see the FCS Series part number tree.

X-ON Electronics

Largest Supplier of Electrical and Electronic Components

Click to view similar products for [Flow Sensors](#) category:

Click to view products by [Measurement Specialties](#) manufacturer:

Other Similar products are found below :

[VSR-3](#) [SS-12225](#) [AWM43300VH](#) [AWM730P1](#) [HAFBLF0400C5AX3](#) [FS1010-C01](#) [UF25B100](#) [FS15LF](#) [FS22A](#) [FS1012-1100-NG](#) [FS1012-1020-NG](#) [FS2012-1100-NG](#) [SFM3000-200C](#) [G-MAFCO-005](#) [SFM3000-200](#) [FPP800KIT1](#) [TDC-GP21](#) [T&R](#) [HAFBLF0100C4AX5](#) [HAFBLF0400C4AX3](#) [HAFBLF0050C4AX3](#) [SFM4100](#) [Air](#) [156268](#) [70824](#) [129660](#) [155421](#) [155481](#) [173931-C](#) [173250](#) [87480](#) [ATS-FM-22](#) [ATS-FM-34](#) [ATS-FM-44](#) [ATS-FM-66](#) [ATS-FM-M](#) [81501025](#) [81525101](#) [81526001](#) [81529003](#) [81529004](#) [81529005](#) [81529006](#) [81529007](#) [81529008](#) [81529010](#) [81529025](#) [81529901](#) [FS15A](#) [FS-90/1](#) [HAFBSS0200C2AX5](#) [AWM1200V](#)