

# Terminal strips Morsetti a Striscia

## TS1

## TS2



Electrical ratings/Caratteristiche nominali Elettriche			
Voltage/Current/Cross section / Tensione/Corrente/Sezione	380V~ /25A /2.5mm <sup>2</sup>	600V~ /47A /6mm <sup>2</sup>	
VDE/VDE (IEC 60998-1, IEC 60998-2-1)	400V~ /24A /2.5mm <sup>2</sup>	660V~ /41A /6mm <sup>2</sup>	
Insulation stripping length/Spellatura carvo	5mm	9mm	
Ordering Data/Dati di Ordinazione			
Can be joined end to end/Possono essere connessi fine con fine	Type/Tipo	Cat. No.Nr. Cat	Qty.Q.tà
	TS1 1/2 (2'li)	420 020i	100
	TS1 1/12 (12'li)	420 120i	75
	Type/Tipo	Cat. No.Nr. Cat	Qty.Q.tà
	TS2 2/2 (2'li)	421 020i	100
	TS2 2/10 (10li)	421 100i	30
Group Marking/Gruppo di Siglatura			
	GM6	496 270i	25

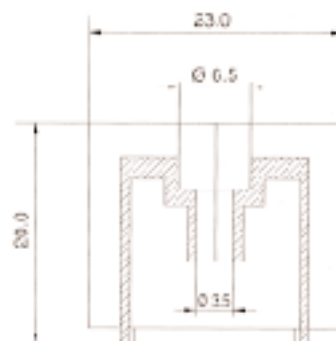
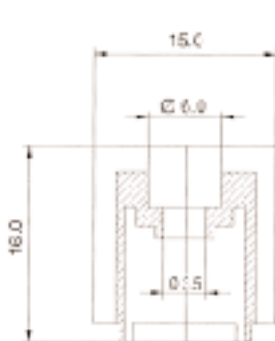

# Busbars Barre

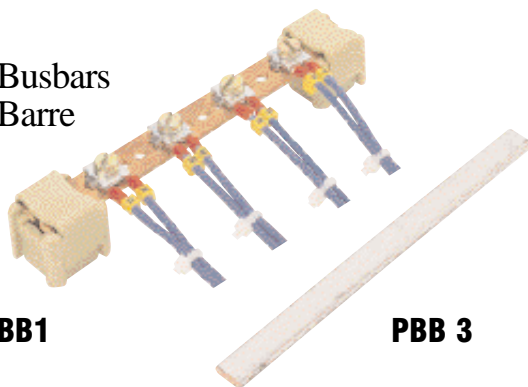

## BB1

## PBB 3

Type/Tipo	Cat.No/Nr/Cat	Current/Corrente	Material/Materiale	Dim/Dimen (mm)	Qty/Q.tà
BB1	525 100i	80 A	E-Cu	15 x 2	1m
BB1/2	525 101i	80 A	E-Cu	15 x 2	50cm
BB2	525 200i	140 A	E-Cu	15 x 3	1m
BB2/2	525 201i	140 A	E-Cu	15 x 3	50cm
BB3	525 300i	80 A	E-Cu	10 x 3	1m
PBB 3	525 350i	80 A	Tin plated E-Cu/Laminatura E-Cu	10 x 3	1m

Single strand screw connection/Cavo singolo connessione a vite 0.5.....2.5mm<sup>2</sup>  
Insulation stripping length/Lunghezza spelatura: 9mm

# Busbar Support Block Blocchetto di Supporto Barra

## BSB1

Type/Tipo	BSB1
Cat.No/Nr/Cat	528 110i
Dim/Dimen (mm)	15 x 2, 15 x 3, 12 x 2 10 x 3, 6 x 6
Material/Materiale	PA 6.6
Qty/Q.tà	50

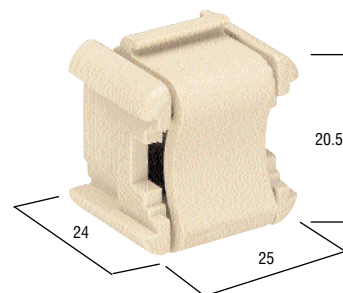

## Clamping yokes Morsetti a Staffa

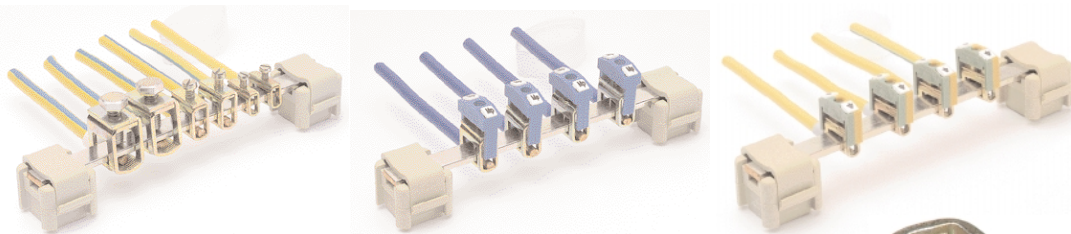

The clamping yokes can be slid onto the 10x3 busbar up to 50mm<sup>2</sup> and the entire wiring matched to the installation.

Il morsetto a staffa per barre può scorrere su una barra 10x3 fino a 50 mm<sup>2</sup> e l'intero cablaggio accoppiato all' impianto.

### CC4

525 361i



### CC10

525 362i

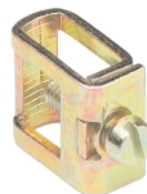

### CC35

525 363i

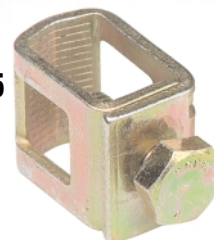

Electrical ratings/Caratteristiche nominali Elettriche									
Voltage/Current/Cross section / Tensione/Corrente/Sezione	380V~ 450V-/4mm <sup>2</sup>			380V~ 450V-/10mm <sup>2</sup>			380V~ 450V-/35mm <sup>2</sup>		
Insulation stripping length/Spellatura carvo	16mm			19mm			19mm		
Fixing Screw/Vite di Fissaggio	M 3			M 4			M 6		
Busbar Dimensions/Dimensioni Barra	10 x 3			10 x 3			10 x 3		
Isolation Cap/Coperchio Isolamento	-			-			-		
Connection Data/Dati di Connessione									
Solid Strand /Cavo Rigido	0.5.....6mm <sup>2</sup>			1.5.....10mm <sup>2</sup>			16.....50mm <sup>2</sup>		
Fine Strand/Cavo Flessibile	0.5.....4mm <sup>2</sup>			2.5.....10mm <sup>2</sup>			16.....35mm <sup>2</sup>		
Ordering Data/Dati di Ordinazione									
Type/TypoCat.	No/Nr.Cat	Qty/Q.ta	Type/TypoCat.	No/Nr.Cat	Qty/Q.ta	Type/TypoCat.	No/Nr.Cat	Qty/Q.ta	
CC4	525 361i	200	CC10	525 362i	100	CC35	525 363i	50	

CCB type clamping yokes are designed with blue insulation caps in order to indicate connection to the N-Lead. They can be used with marking tags

I morsetto a staffa per barre tipo CCB sono stati progettati con il capuccio isolante blu per indicare la connessione al polo Neutro. Possono essere usati con i cartellini di siglatura

### CCB 4

525 371i



### CCB 10

525 372i



### CCB 35

525 373i



Electrical ratings/Caratteristiche nominali Elettriche									
Voltage/Current/Cross section / Tensione/Corrente/Sezione	380V~ 450V-/4mm <sup>2</sup>			380V~ 450V-/10mm <sup>2</sup>			380V~ 450V-/35mm <sup>2</sup>		
Insulation stripping length/Spellatura carvo	16mm			19mm			19mm		
Fixing Screw/Vite di Fissaggio	M 3			M 4			M 6		
Busbar Dimensions/Dimensioni Barra	10 x 3			10 x 3			10 x 3		
Isolation Cap/Coperchio Isolamento	BLUE/BLU			BLUE/BLU			BLUE/BLU		
Connection Data/Dati di Connessione									
Solid Strand /Cavo Rigido	0.5.....6mm <sup>2</sup>			1.5.....10mm <sup>2</sup>			16.....50mm <sup>2</sup>		
Fine Strand/Cavo Flessibile	0.5.....4mm <sup>2</sup>			2.5.....10mm <sup>2</sup>			16.....35mm <sup>2</sup>		
Ordering Data/Dati di Ordinazione									
Type/TypoCat.	No/Nr.Cat	Qty/Q.ta	Type/TypoCat.	No/Nr.Cat	Qty/Q.ta	Type/TypoCat.	No/Nr.Cat	Qty/Q.ta	
CCB 4	525 371i	100	CCB10	525 372i	100	CCB35	525 373i	50	

CC4 G/Y type clamping yokes are designed with yellow, green insulation caps to emphasise the protection function. They can be used with marking tags

I morsetto a staffa per barre tipo CC4 G/Y sono progettati con il capuccio isolante giallo-verde per evidenziare la funzione della protezione. Possono essere usati con i cartellini di siglatura.

Possono essere usati con i cartellini di siglatura

### CC4 G/Y

525 381i

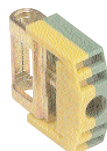

### CC10 G/Y

525 382i



### CC35 G/Y

525 383i



Electrical ratings/Caratteristiche nominali Elettriche									
Voltage/Current/Cross section / Tensione/Corrente/Sezione	380V~ 450V-/4mm <sup>2</sup>			380V~ 450V-/10mm <sup>2</sup>			380V~ 450V-/35mm <sup>2</sup>		
Insulation stripping length/Spellatura carvo	16mm			19mm			19mm		
Fixing Screw/Vite di Fissaggio	M 3			M 4			M 6		
Busbar Dimensions/Dimensioni Barra	10 x 3			10 x 3			10 x 3		
Isolation Cap/Coperchio Isolamento	-			-			-		
Connection Data/Dati di Connessione									
Solid Strand /Cavo Rigido	0.5.....6mm <sup>2</sup>			1.5.....10mm <sup>2</sup>			16.....50mm <sup>2</sup>		
Fine Strand/Cavo Flessibile	0.5.....4mm <sup>2</sup>			2.5.....10mm <sup>2</sup>			16.....35mm <sup>2</sup>		
Ordering Data/Dati di Ordinazione									
Type/TypoCat.	No/Nr.Cat	Qty/Q.ta	Type/TypoCat.	No/Nr.Cat	Qty/Q.ta	Type/TypoCat.	No/Nr.Cat	Qty/Q.ta	
CC4 G/Y	525 381i	100	CC10 G/Y	525 382i	100	CC35 G/Y	525 383i	50	

# Marking tags Dekafix (Targhette Siglatura)

## MT5 1-50

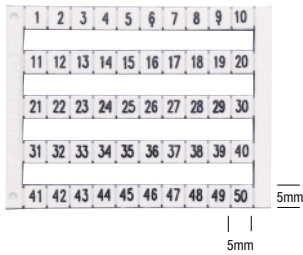

## MT5

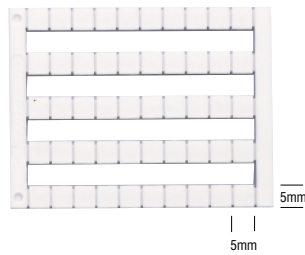

## MT5 Special

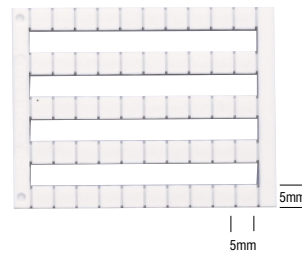

Max. 2 digits can be printed for MT5 Special. Whole series can be used with following MT5/MT5/MTO 5

Possono essere stampati al massimo 2 cifre. L'intera serie può essere usata con MT 5/MT 5/MTO 5

## MT 10/5

## MT 10/5

Max. 5 digits can be printed for MT10/5 and MT10/6.5

Possono essere stampati al massimo 5 cifre per la serie può essere usata con MT10/5 and MT10/6.5

MT 10/5 and MT10/15 type marking tags can be used with the following terminals ER (4...70) ERPEG, ERWT

I cartellini di siglatura MT 10/5 e MT 10/15 possono essere utilizzati con i seguenti morsetti ER ,ERPEG, ERWT

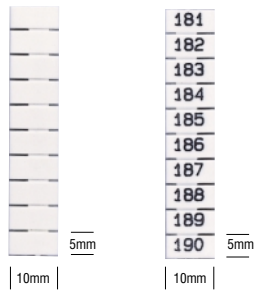

## MT10/6

MT10/6 type marking tags can be used with the following terminals ER(4...70) ,ERPEG, ERWT

I cartellini di siglatura MT10/6 può essere utilizzato con i seguenti morsetti ER(4...70) ,ERPEG, ERWT



## MT 10/6.5- MT 10/6.5 MT 10/6.5-... 1-10

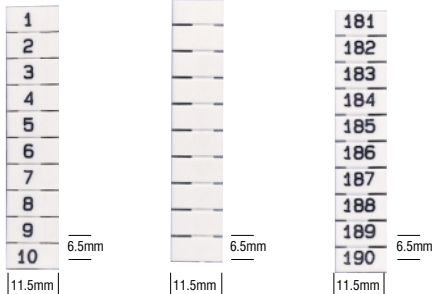

MT10/6.5-1-10, MT10/6.5 and MT10/6.5 type marking tags can be used with the following terminals ER(6..70) ,ERPEG(6...35) ERWT

I cartellini di siglatura tipo MT10/6.5-1-10, MT10/6.5 MT10/6.5 possono essere utilizzati con i seguenti morsetti ER(6..70) ERPEG(6...35) ERWT

Type/Tipo	Description/Descrizione	Cat.No/Nr.Cat	Qty/Q.ta
MT 5	Standard print/Stampa Standard	505---i	500 plate/pezzi
MTO 5	Special print/Stampa Speciale	505 650i	500 plate/pezzi
MT 5	Without print/Senza Stampa/neutri	505 850i	500 plate/pezzi
MT 10/5	Special print/Stampa Speciale	505 710i	500 plate/pezzi
MT10/5	Without print/Senza Stampa/neutri	505 910i	500 plate/pezzi
MT 10/6	Without print/Senza Stampa/neutri	505 915i	500 plate/pezzi
MT10/6.5	Standard print/Stampa Standard	505---i	500 plate/pezzi
MT 10/6.5	Special print/Stampa Speciale	505 720i	500 plate/pezzi
MT 10/6.5	Without print/Senza Stampa/neutri	505 920i	500 plate/pezzi

Type	Description	Cat.No	Type	Description	Cat.No	Type	Description	Cat.No	Type	Description	Cat.No
Tipo	Descrizione	Q.ta	Tipo	Descrizione	Q.ta	Tipo	Descrizione	Q.ta	Tipo	Descrizione	Q.ta
MT 5	0	505 000i	MT 5	51-100	505 041i	MT 5	951-999	505 059i	MT 5	R	505 077i
MT 5	1	505 001i	MT 5	100-150	505 042i	MT 5	A	505 060i	MT 5	S	505 078i
MT5	2	505 002i	MT 5	151-200	505 043i	MT 5	B	505 061i	MT 5	T	505 079i
MT 5	3	505 003i	MT 5	201-250	505 044i	MT 5	C	505 062i	MT 5	U	505 080i
MT 5	4	505 004i	MT 5	251-300	505 045i	MT 5	D	505 063i	MT 5	V	505 081i
MT 5	5	505 005i	MT 5	301-350	505 046i	MT 5	E	505 064i	MT 5	W	505 082i
MT 5	6	505 006i	MT 5	351-400	505 047i	MT 5	F	505 065i	MT 5	X	505 083i
MT 5	7	505 007i	MT 5	401-450	505 048i	MT 5	G	505 066i	MT 5	Y	505 084i
MT 5	8	505 008i	MT 5	451-500	505 049i	MT 5	H	505 067i	MT 5	Z	505 085i
MT 5	9	505 009i	MT 5	501-550	505 050i	MT 5	I	505 068i	MT 5	L1	505 090i
MT 5	10	505 010i	MT 5	551-600	505 051i	MT 5	J	505 069i	MT 5	L2	505 091i
MT 5	1-10	505 020i	MT 5	601-650	505 052i	MT 5	K	505 070i	MT 5	L3	505 092i
MT 5	11-20	505 021i	MT 5	651-700	505 053i	MT 5	L	505 071i	MT5	RSNT <sub>Q</sub>	505 093i
MT 5	21-30	505 022i	MT 5	701-750	505 054i	MT 5	M	505 072i	MT 5	Mp	505 094i
MT 5	31-40	505 023i	MT 5	751-800	505 055i	MT 5	N	505 073i	MT5	+	505 095i
MT 5	41-50	505 024i	MT 5	801-850	505 056i	MT 5	O	505 074i	MT 5	-	505 096i
MT 5	10-100	505 030i	MT 5	851-900	505 057i	MT 5	P	505 075i	MT 5	Q	505 097i
MT 5	1-50	505 040i	MT 5	901-950	505 058i	MT 5	Q	505 076i			

Type	Description	Cat.No
Tipo	Descrizione	Q.ta
MT 10/6.5	1-10	505 201i
MT 10/6.5	11-20	505 202i
MT 10/6.5	21-30	505 203i
MT 10/6.5	31-40	505 204i
MT 10/6.5	41-50	505 205i
MT 10/6.5	51-60	505 206i
MT 10/6.5	61-70	505 207i
MT 10/6.5	71-80	505 208i
MT 10/6.5	81-90	505 209i
MT 10/6.5	91-100	505 210i

## X-ON Electronics

Largest Supplier of Electrical and Electronic Components

*Click to view similar products for imo manufacturer:*

Other Similar products are found below :

[20.155MV/12-E](#) [MC14N-S-10110AC](#) [DPS-1-030-24](#) [SRF-1C-SL-12VDC](#) [MB09-S-1024](#) [LDC18RRS](#) [SFSYE0111](#) [21.1500M/6-E](#)  
[20.3304M/2-E](#) [21.910M/5-E](#) [20.95MA/2-E](#) [21.95MHF/2-E](#) [PE69-4032](#) [DPS-1-060-24](#) [CS20A-A2](#) [CS20A-U1](#) [VFC02](#) [MSSTC11DA06](#)  
[20.2500M/4-E](#) [20.95MHF/3-E](#) [B3T10](#) [XKL-040-21](#) [20.3304M/4-E](#) [SRDH-1A-SL-24VDC](#) [20.2500M/5-E](#) [21.155MH/12](#) [SRRHN-2CN-SL-](#)  
[12VDC](#) [QYE21XXF24DC](#) [20.920M/5-E](#) [21.1550MF/8-E](#) [20.910M/6-E](#) [20.95MH/3-E](#) [MC10N-S-10110AC](#) [21.95MV/3](#) [MA05-S-01230AC](#)  
[SRRHN-2CN-SL-5VDC](#) [LB69-4040](#) [20.3001M/6](#) [SRGA-1A-SL-24VDC](#) [21.1500M/3-E](#) [21.95MHF/6-E](#) [20.95MV/2-E](#) [20.155MV/4-E](#)  
[ER2.5BEIGE](#) [20.950M/2-E](#) [MT5 1-50-FAR](#) [BS3P3REDO](#) [MB12-S-10=24](#) [MA05-S-1024DC](#) [20.155MVF/8-E](#)