

REV	A	16/04/08	16/04/08
DETAIL	RELEASE	CHANGE TO SOLDER TEMP. INFORMATION	ASE
BY	ASE	DIM. C ADDED TO TABLE	ASE
	AJO	B2B PITCH SOCKET NET REMOVAL CORRECTION	AJO
	AJO	DIMENSION C	AJO
	E	13/12/12	10/07/13

SPECIFICATIONS 规格:

CURRENT RATING 电流额定值: 1 Amp
 INSULATOR RESISTANCE 绝缘电阻值: 1000 MΩ Min.
 DIELECTRIC WITHSTANDING 耐电压: AC 300 V
 CONTACT RESISTANCE 接触电阻值: 20 mΩ Max.
 OPERATING TEMPERATURE 工作温度: -40°C TO +105°C
 CONTACT MATERIAL 端子物料: COPPER ALLOY
 INSULATOR MATERIAL 绝缘体物料: POLYESTER 聚酯, LCP, UL 94V-0
 SOLDERING PROCESS 可焊性: LCP -
 IR REFLOW 回流焊: 260°C for 10 sec. ∇
 WAVE 波峰焊: 250°C for 5-10 sec
 MANUAL SOLDER 人工焊接: 350°C for 3-5 sec
 MATES WITH 配套之母座 (SUBJECT TO PIN LENGTH 在端子长度适合的条件下): BD025 BD030 BD035 BD038 BD040 BD095

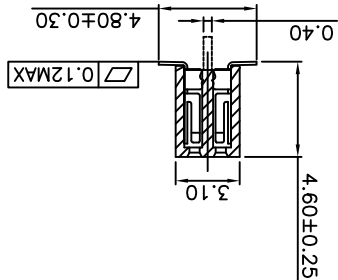
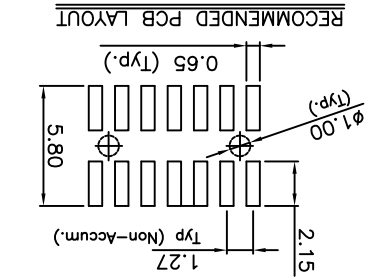
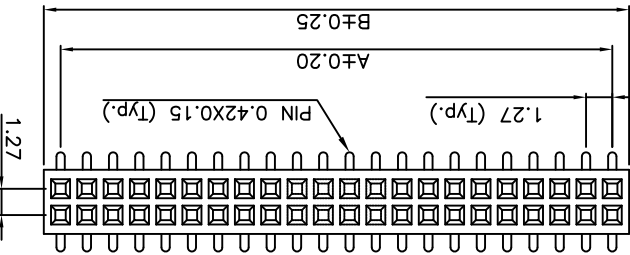
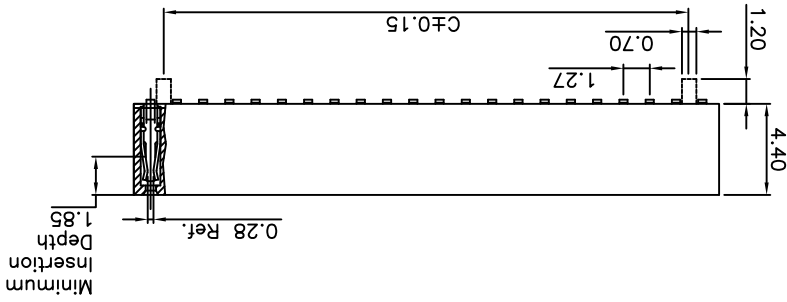

Ordering Grid

BD064 - XX - X - X - L - X

No. of Contacts: 04 to 100, 00 = 100

Contact Plating: A = Gold Flash All Over (Standard), B = Selective Gold Flash Contact Area/Tin On Tail, C = Tin All Over, G = 10µ" Gold Contact Area/Tin On Tail, I = 30µ" Gold Contact Area/Tin On Tail

Packing Options: C = Tape and Reel with Film (Standard), B = Tape and Reel with Cap, D = Tube, E = Tube with Cap, F = Tube with Film

Locating Peg: 0 = No Peg, 1 = With Peg

Insulator Material: L = LCP, D = Insulator Material

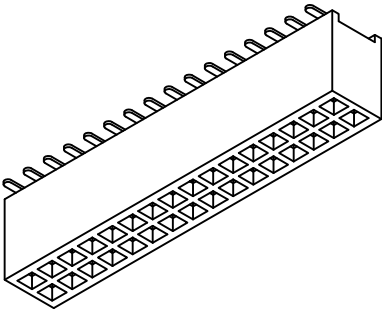

Tolerances (Except as noted)	Part Number:-	Date:-
Dimensions in mm	BD064	16 APR 08
X ± 0.30	Description:-	
X ± 0.25	1.27mm PITCH SOCKET, DUAL ROW, SURFACE MOUNT, VERTICAL	
X ± 0.15		
XXX ± 0.10		



THIS DRAWING IS CONFIDENTIAL AND MUST NOT BE COPIED OR DISCLOSED WITHOUT WRITTEN CONSENT

Scale

Revision

Material

See Note

ASE

E & OE

Sheet No. 1/1

GCT

www.gct.co

CONTACTS		DIMENSIONS	
A	B	A	B
4	2.89	-	-
6	4.16	2.54	4.16
8	5.43	3.81	5.43
10	6.70	5.08	6.70
12	7.97	6.35	7.97
14	9.24	7.62	9.24
16	10.51	8.89	10.51
18	11.78	10.16	11.78
20	13.05	11.43	13.05
22	14.32	12.70	14.32
24	15.59	13.97	15.59
26	16.86	15.24	16.86
28	18.13	16.51	18.13
30	19.40	17.78	19.40
32	20.67	19.05	20.67
34	21.94	20.32	21.94
36	23.21	21.59	23.21
38	24.48	22.86	24.48
40	25.75	24.13	25.75
42	27.02	25.40	27.02
44	28.29	26.67	28.29
46	29.56	27.94	29.56
48	30.83	29.21	30.83
50	32.10	30.48	32.10
52	33.37	31.75	33.37
54	34.64	33.02	34.64
56	35.91	34.29	35.91
58	37.18	35.56	37.18
60	38.45	36.83	38.45
62	39.72	38.10	39.72
64	40.99	39.37	40.99
66	42.26	40.64	42.26
68	43.53	41.91	43.53
70	44.80	43.18	44.80
72	46.07	44.45	46.07
74	47.34	45.72	47.34
76	48.61	46.99	48.61
78	49.88	48.26	49.88
80	51.15	49.53	51.15
82	52.42	50.80	52.42
84	53.69	52.07	53.69
86	54.96	53.34	54.96
88	56.23	54.61	56.23
90	57.50	55.88	57.50
92	58.77	57.15	58.77
94	60.04	58.42	60.04
96	61.31	59.69	61.31
98	62.58	60.96	62.58
100	64.23	63.85	64.23
		60.96	60.96

A B C D E F G H

8

7

6

5

4

3

2

1

A

C

D

E

F

G

H

X-ON Electronics

Largest Supplier of Electrical and Electronic Components

Click to view similar products for [FFC & FPC Connectors](#) category:

Click to view products by [GCT](#) manufacturer:

Other Similar products are found below :

[HFW11R-1STE1H1LF](#) [FH29B-100S-0.2SHW\(99\)](#) [FA5S008HP1](#) [FH29B-120S-0.2SHW\(99\)](#) [FH29B-80S-0.2SHW\(99\)](#) [FHS-16](#) [FPH-2022G](#)
[52610-1075](#) [52610-1275](#) [52610-1934](#) [XF3M\(1\)-1415-1B-R100](#) [501864-3091-TR225](#) [0525594033](#) [086210010340800](#) [086222026001800](#)
[52271-2869-CUT-TAPE](#) [62674-201121DLF](#) [62684-36210E9ALF](#) [52610-1675](#) [52746-1671-TR250](#) [10051922-2810EHLF](#) [6-520415-9](#)
[BD021-09A-A1-0350-0200-0550-LD](#) [SFV6R-1STE9HLF](#) [XF3M-2915-1B-R100](#) [1658549-1](#) [62674-221121ALF](#) [46214008010800](#)
[046298003000883](#) [151660622](#) [842-816-2630-035](#) [AYF530665TA](#) [AYF351525](#) [046296011930846+](#) [AYF352325A](#) [046254020000800+](#)
[FH19C-13S-0.5SH\(99\)](#) [FH39J-51S-0.3SHW\(99\)](#) [AYF355125A](#) [AYF530365TA](#) [FH29B-44S-0.2SHW\(99\)](#) [SFW5R-2STAE9LF](#) [AYF351125A](#)
[AYF350725A](#) [62684-502100AHLF](#) [FH39-61S-0.3SHW\(99\)](#) [AYF414035A](#) [10064555-172520HLF](#) [AYF212335A](#) [504754-2500](#)