

**nominal voltage:** 1,2V  
**max. charge voltage:** 1,5V

**capacity**  
 nominal : 2700mAh  
 minimum: 2400mAh  
 2250mAh

**max. continuous discharge current:** 2700mA  
 ambient temperature 20....50°C

**charge**  
 standard charge: charge current 240mA charge time 14hrs at 20°C  
 quick charge: 525mA 5hrs  
 fast charge: 2400mA 1,1hrs

recommended charge termination control parameters:  
 -dV: 5....10mV  
 dT/dt: 0,8....1°C per min  
 TCO: 40...50°C

trickle charge current: 20....100mA (recommended)

continuous overcharge: ≤ 100mA (less than 1 year)  
 no conspicuous deformation, no leakage

**internal resistance:** ≤ 30mOhms at 1000Hz, battery fully charged

**life expectancy:** > 500 cycles IEC standard

**ambient temperature range:** 0....45°C standard charge  
 10....40°C fast charge  
 -20....50°C discharge  
 -20....55°C storage less than 30 days  
 -20....45°C storage less than 3 months  
 -20....35°C storage less than 1 year

conditions

at standard charge (0,1C / 20°C)

discharge at 0,2C  
 discharge at 0,2C  
 discharge at 1C  
 1,0V end discharge voltage  
 ambient temperature 20°C

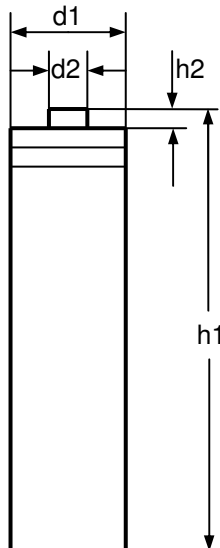
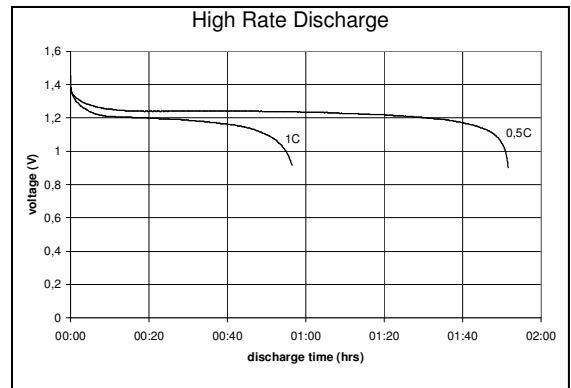
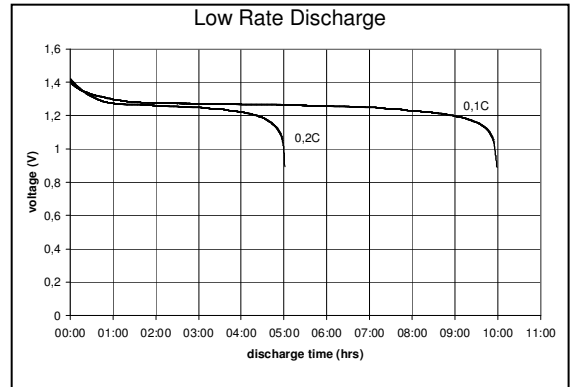
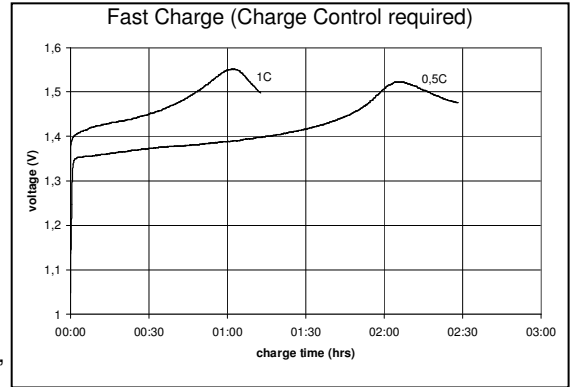
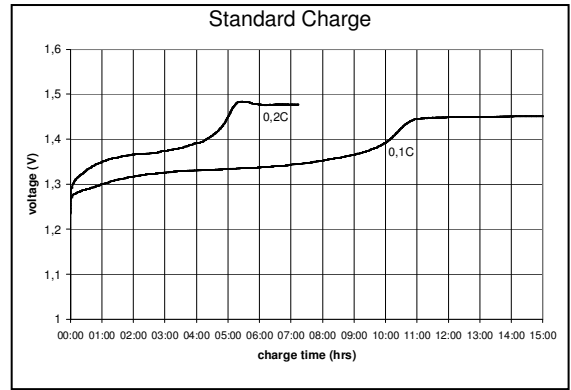

**mechanical specifications**

cell dimensions  
 diameter d1: 14,1 - 0,5mm  
 diameter d2: 5,5 - 0,5mm  
 height h1: 50,4 - 1,0mm  
 height h2: 1,8 +/- 0,5mm  
 weight: approx. 30g

|  |                                       |                       |
|--|---------------------------------------|-----------------------|
|  | specifications for model/type:        | AA – NiMH 2850mAh     |
|  | Ansmann drawing number / part number: | 5035201               |
|  | author / date:                        | Gramlich / 29.08.2007 |
|  |                                       |                       |

## X-ON Electronics

Largest Supplier of Electrical and Electronic Components

*Click to view similar products for [ansmann](#) manufacturer:*

Other Similar products are found below :

[5020012](#) [1000-0003](#) [5013233](#) [5030992](#) [1520-0004](#) [1501-0004-1](#) [1001-0020-UK](#) [2312-3003](#) [1250-0013](#) [1600-0199](#) [5030902](#) [1900-0019](#)  
[1001-0014-UK](#) [5035362](#) [5013243](#) [5707173](#) [1600-0137](#) [5035391](#) [5000023](#) [5311113 / APS 1000](#) [1600-0138](#) [1250-0014](#) [BCA120-350](#) [1600-0145](#) [5015293](#) [5030982](#) [2311-3003](#) [5030802](#) [10950964/01](#) [5030912](#) [5016243](#) [5035222](#) [2310-3001](#) [5030641](#) [5001183](#) [1600-0154](#) [5035352](#)  
[5035342](#) [ACS310](#) [5035202](#) [5015332](#) [5035201](#) [5015303](#) [2311-3002](#)