

nominal voltage:	1,2V	conditions
max. charge voltage:	1,5V	at standard charge (0,1C / 20°C)
capacity		discharge at 0,2C
nominal :	800mAh	discharge at 1C
minimal:	>700mAh 750mAh	discharge at 0,2C 1,0V end discharge voltage ambient temperature 20°C
max. continuous discharge current:	1600mA	ambient temperature 20....50°C
charge		charge current
standard charge:	80mA	charge time 16hrs at 20°C
quick charge:	400mA	2,5hrs
fast charge:	800mA	1,2hrs
recommended charge termination control parameters:	-dV: 5....10mV dT/dt: 0,8....1°C per min TCO: 40....50°C	
trickle charge current:	8....40mA	(recommended)
continuous overcharge: (less than 1 year)	≤40mA	no conspicuous deformation, no leakage
internal resistance:	≤45mOhms	at 1000Hz, battery fully charged
life expectancy:	>500 cycles	IEC standard
self discharge		
charge retention:	>75%	after 12months storage at 20°C
ambient temperature range:	0....45°C 0....40°C -20....65°C -20....50°C -20....40°C -20....35°C	standard charge fast charge discharge storage less than 30 days storage less than 3 months storage less than 1 year

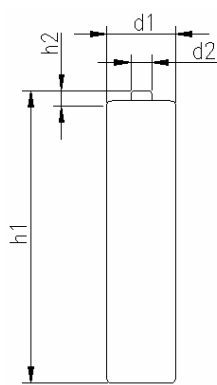
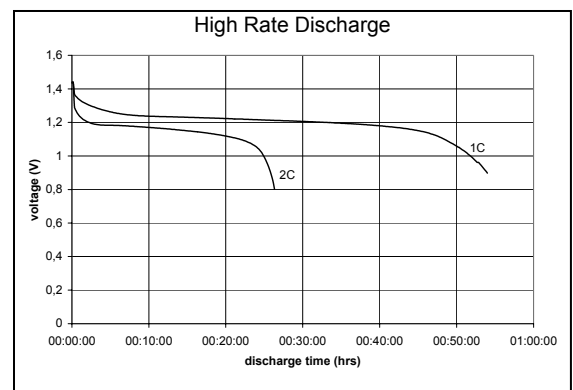
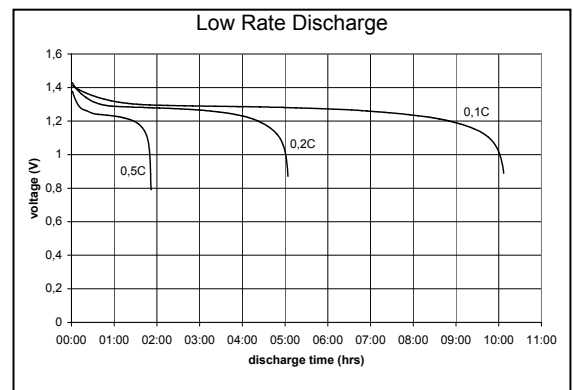
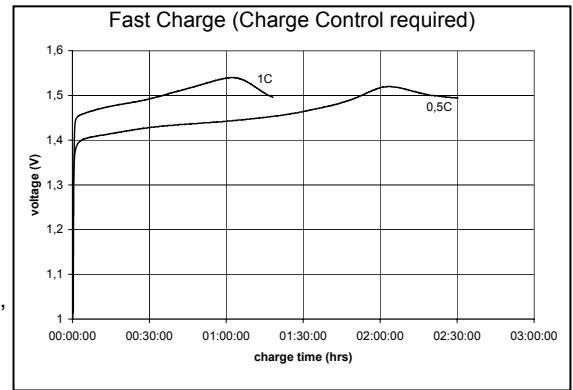
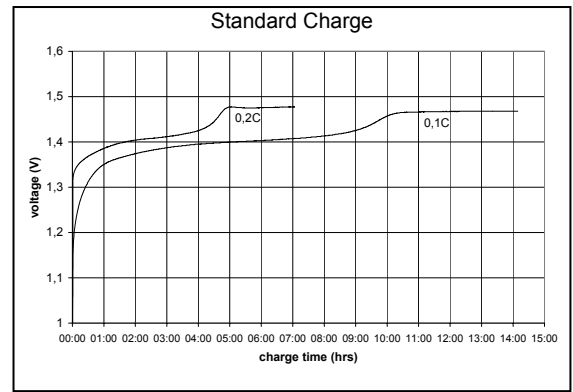

mechanical specifications

cell dimensions (with sleeve)	
diameter d1:	10,5 – 0,7mm
diameter d2:	max. 3,8mm
height h1:	44,5 – 1,5mm
height h2:	min. 0,8mm
weight:	approx. 13g

	specifications for model/type:	AAA – NiMH 800mAh Max e (2pcs)
		low self discharge cell
	Ansmann drawing number / part number:	5030982
	drawn by / date:	Gramlich / 13.09.2006

X-ON Electronics

Largest Supplier of Electrical and Electronic Components

Click to view similar products for [ansmann](#) manufacturer:

Other Similar products are found below :

[5020012](#) [1000-0003](#) [5013233](#) [5030992](#) [1520-0004](#) [1501-0004-1](#) [1001-0020-UK](#) [2312-3003](#) [1250-0013](#) [1600-0199](#) [5030902](#) [1900-0019](#)
[1001-0014-UK](#) [5035362](#) [5013243](#) [5707173](#) [1600-0137](#) [5035391](#) [5000023](#) [5311113 / APS 1000](#) [1600-0138](#) [1250-0014](#) [BCA120-350](#) [1600-0145](#) [5015293](#) [5030982](#) [2311-3003](#) [5030802](#) [10950964/01](#) [5030912](#) [5016243](#) [5035222](#) [2310-3001](#) [5030641](#) [5001183](#) [1600-0154](#) [5035352](#)
[5035342](#) [ACS310](#) [5035202](#) [5015332](#) [5035201](#) [5015303](#) [2311-3002](#)