

nominal voltage:	1,2V	conditions
max. charge voltage:	1,5V	at standard charge (0,1C / 20°C)
capacity		
nominal :	10000mAh	discharge at 0,2C
	8300mAh	discharge at 1C
minimum:	9300mAh	discharge at 0,2C
		1,0V end discharge voltage
		ambient temperature 20°C
max. continuous discharge current:	10A	ambient temperature 20....50°C
charge	charge current	charge time
standard charge:	1000mA	16hrs
rapid charge:	2500mA	4,4hrs
fast charge:	5000mA	2,2hrs
recommended charge termination control parameters:	-dV: 0....5mV dT/dt: 0,8....1°C per min TCO: 45....50°C	
trickle charge current:	100....500mA	(recommended)
continuous overcharge: (less than 1 year)	≤750mA	no conspicuous deformation, no leakage
internal resistance:	≤15mOhms	at 1000Hz, battery fully charged
life expectancy:	>500 cycles	IEC standard
ambient temperature range:	0....45°C 10....40°C -20....60°C -20....35°C -20....45°C	standard charge fast charge discharge storage less than 6 months storage less than 1 month

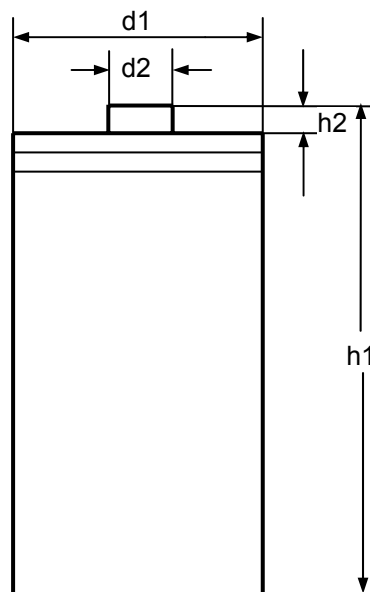
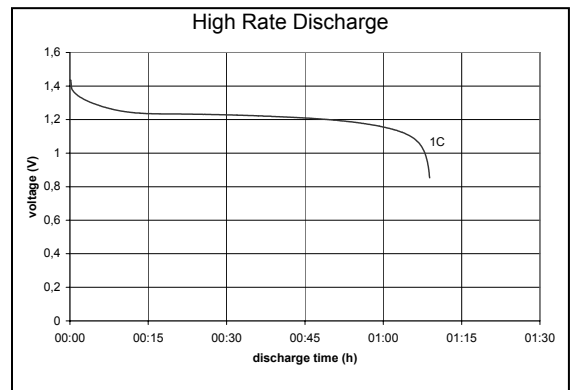
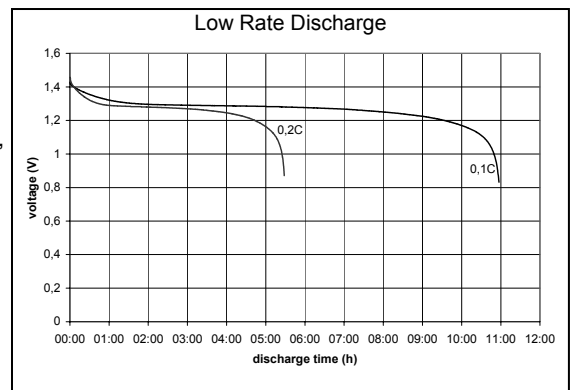
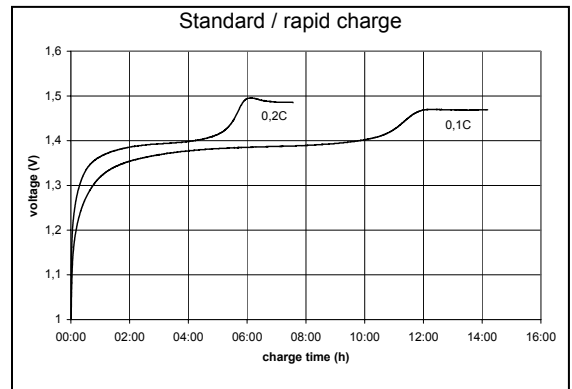

mechanical specifications
cell dimensions (with sleeve)
diameter d1: 33,0 -1,0mm
diameter d2: 8,0 ±1,0mm
height h1: 61,5 -2,0mm
height h2: min. 1,5mm
weight: approx. 155g

	specifications for model/type:	D – NiMH 10000mAh
	Ansmann drawing number / part number:	5030641
	drawn by / date:	Gramlich / 27.12.2005

X-ON Electronics

Largest Supplier of Electrical and Electronic Components

Click to view similar products for [ansmann](#) manufacturer:

Other Similar products are found below :

[5020012](#) [1000-0003](#) [5013233](#) [5030992](#) [1520-0004](#) [1501-0004-1](#) [1001-0020-UK](#) [2312-3003](#) [1250-0013](#) [1600-0199](#) [5030902](#) [1900-0019](#)
[1001-0014-UK](#) [5035362](#) [5013243](#) [5707173](#) [1600-0137](#) [5035391](#) [5000023](#) [5311113 / APS 1000](#) [1600-0138](#) [1250-0014](#) [BCA120-350](#) [1600-](#)
[0145](#) [5015293](#) [5030982](#) [2311-3003](#) [5030802](#) [10950964/01](#) [5030912](#) [5016243](#) [5035222](#) [2310-3001](#) [5030641](#) [5001183](#) [1600-0154](#) [5035352](#)
[5035342](#) [ACS310](#) [5035202](#) [5015332](#) [5035201](#) [5015303](#) [2311-3002](#)