

# DURACELL® Rechargeable

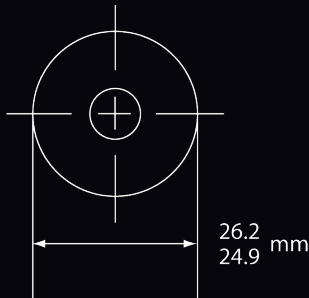

## Rechargeable C



Dimensions shown are IEC standards

Product can be charged on most NiMH or NiCd chargers utilizing standard dV, dV/dt, time and temperature dynamic charge termination methods. Duracell brand NiMH chargers are recommended for best results.

Delivered capacity is dependent on the applied load, operating temperature, and cut-off voltage. Please refer to the charts and discharge data shown for example of the energy/service life that the battery will provide for various local conditions.

This data is subject to change. Performance information is typical. Contact Duracell for latest information.

## BENEFITS

- Reliable Performance in Everyday Devices!

## TECHNICAL

Type:	NiMH C 2200 mAh
Nominal Voltage	1.2V
Nominal Internal Impedance:	30 m-ohm @ 1 kHz
Average Weight:	61.0 grams (2.15 ounces)
Volume:	26.9 cm <sup>3</sup> (1.64 in <sup>3</sup> )
Operating Temperature Range:	-20° C to 50° C (-4° F to 122° F)
ANSI:	1.2H3
IEC:	HR14
Product Codes	Blister x2
	EU/UK SAP Code: 75052458
	EU/UK EAN Code: 5000394055988

LOW RATE DISCHARGE

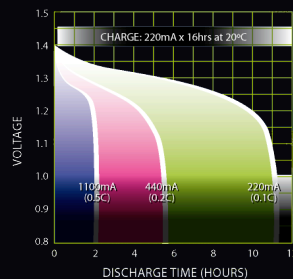

HIGH RATE DISCHARGE

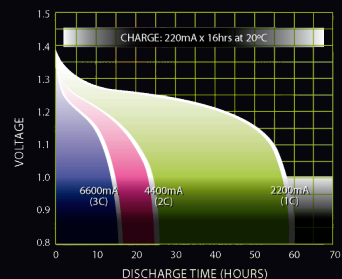

FAST CHARGE  
(CHARGE CONTROL REQUIRED)

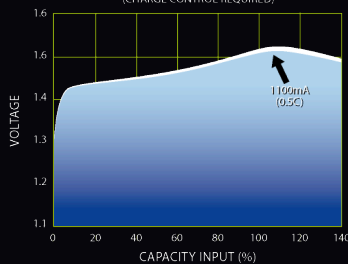

Confidential for internal use only

## X-ON Electronics

Largest Supplier of Electrical and Electronic Components

*Click to view similar products for [duracell](#) manufacturer:*

Other Similar products are found below :

[DL1620B](#) [MS76B](#) [LR20/D/MN1300\(K2\)](#) [MN2400 TURBO](#) [DA146](#) [LR03/AAA/MN2400\(K4\)](#) [MN2400B4](#) [15035031 M3 C 2PK](#) [10 ET](#) [13 ET](#) [LR20/D \(K2\) PLUS POWER](#) [LR3/AAA/MN2400\(K8\) ECONOMY PACK](#) [LR6/AA/MN1500\(K2\) ECONOMY PACK](#) [LR6/AA/MN1500\(K8\) ECONOMY PACK](#) [MN11 E11A](#) [CEF27 2XAA 2XAAA](#) [MN1500 ULTRA POWER](#) [DL223AB](#) [75044300](#) [PC1400](#) [MN2400](#) [LR43](#) [PC134A](#) [CEF14 2XAA 2XAAA](#) [ACCU 9V1](#) [5000394002883](#) [MN1604](#) [DRC5906](#) [DRC5902](#) [15035025 M3 PP3](#) [PC1604](#) [DRS5964](#) [DRO5941](#) [DRC5908](#) [DRN5924](#) [5000394019126](#) [DRP6116](#) [5000394105522](#) [DRG5945](#) [ACCU D2](#) [5000394082991](#) [DRP5953](#) [5000394020092](#) [DRO5940](#) [DRC5904](#) [DRC5907](#) [DRC5905](#) [DR5030A](#) [DRG5944](#) [DRP5954](#)