

20021311-XXXXXXLF

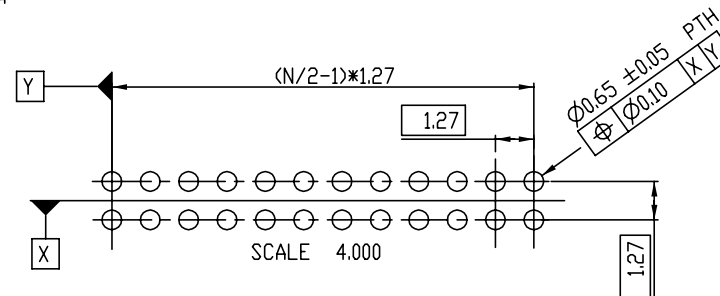
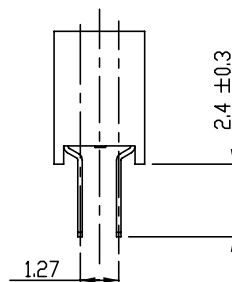
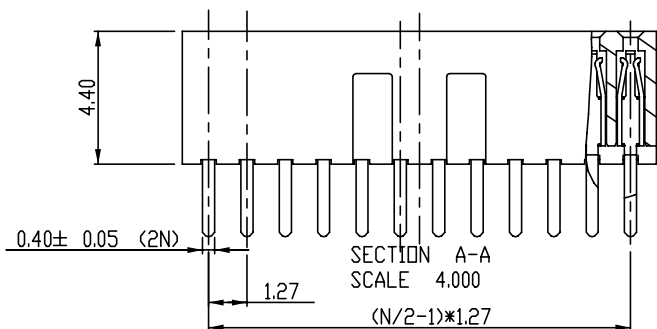
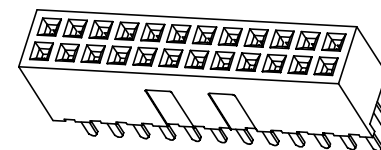
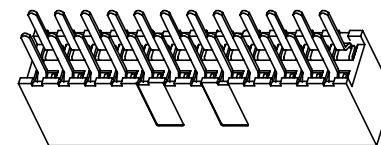
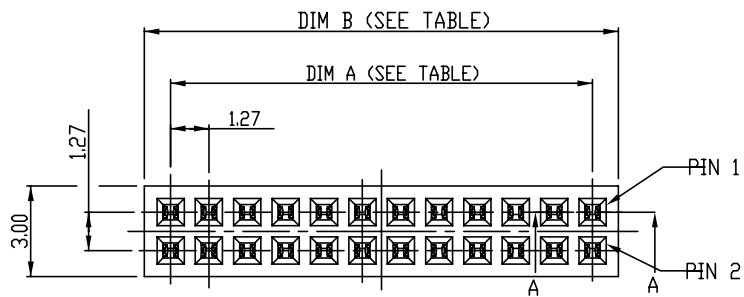

RECOMMENDED PCB LAYOUT  
LAYOUT TOLERANCE = ±0.05mm

|                                       |        |        |             |            |                        |                  |              |                    |          |       |       |
|---------------------------------------|--------|--------|-------------|------------|------------------------|------------------|--------------|--------------------|----------|-------|-------|
| spec ref                              |        |        | dr          | ANDY ZHANG | 2012-10-29             | projection<br>   | MM<br>←→     | size               | A4       | scale | 4.000 |
| tolerance std                         |        |        | eng         | ANDY ZHANG | 2012-10-29             |                  |              | ecn no ELX-N-14378 |          |       |       |
| TOLERANCES UNLESS OTHERWISE SPECIFIED |        |        | chr         | RICK BIAN  | 2012-10-29             |                  |              |                    |          |       |       |
| surface ✓                             |        |        | appr        | RICK BIAN  | 2012-10-29             | product family   | -            | rel level          | RELEASED |       |       |
| linear                                | 0.X    | ± 0.30 |             | title      | MINITEK 127 RECEPTACLE | VT TH            | dwg no       | 20021311           | rev      | D     |       |
|                                       | 0.XX   | ± 0.20 |             |            |                        |                  |              |                    |          |       |       |
| 0.XXX                                 | ± 0.10 |        |             |            |                        |                  |              |                    |          |       |       |
| angular                               | 0~     | ± 2°   | www.fci.com | cat. no.   | -                      | CUSTOMER DRAWING | sheet 1 of 3 |                    |          |       |       |

TABLE 1

| PRODDUCT NO.       | POSITIONS | DIM. A | DIM. B |
|--------------------|-----------|--------|--------|
| 20021311-XXX06XXLF | 2 X 3     | 2.54   | 4.27   |
| 20021311-XXX08XXLF | 2 X 4     | 3.81   | 5.54   |
| 20021311-XXX10XXLF | 2 X 5     | 5.08   | 6.81   |
| 20021311-XXX12XXLF | 2 X 6     | 6.35   | 8.08   |
| 20021311-XXX14XXLF | 2 X 7     | 7.62   | 9.35   |
| 20021311-XXX16XXLF | 2 X 8     | 8.89   | 10.62  |
| 20021311-XXX18XXLF | 2 X 9     | 10.16  | 11.89  |
| 20021311-XXX20XXLF | 2 X 10    | 11.43  | 13.16  |
| 20021311-XXX22XXLF | 2 X 11    | 12.7   | 14.43  |
| 20021311-XXX24XXLF | 2 X 12    | 13.97  | 15.7   |
| 20021311-XXX26XXLF | 2 X 13    | 15.24  | 16.97  |
| 20021311-XXX28XXLF | 2 X 14    | 16.51  | 18.24  |
| 20021311-XXX30XXLF | 2 X 15    | 17.78  | 19.51  |
| 20021311-XXX32XXLF | 2 X 16    | 19.05  | 20.78  |
| 20021311-XXX34XXLF | 2 X 17    | 20.32  | 22.05  |
| 20021311-XXX36XXLF | 2 X 18    | 21.59  | 23.32  |
| 20021311-XXX38XXLF | 2 X 19    | 22.86  | 24.59  |
| 20021311-XXX40XXLF | 2 X 20    | 24.13  | 25.86  |
| 20021311-XXX42XXLF | 2 X 21    | 25.4   | 27.13  |
| 20021311-XXX44XXLF | 2 X 22    | 26.67  | 28.4   |
| 20021311-XXX46XXLF | 2 X 23    | 27.94  | 29.67  |
| 20021311-XXX48XXLF | 2 X 24    | 29.21  | 30.94  |
| 20021311-XXX50XXLF | 2 X 25    | 30.48  | 32.21  |
| 20021311-XXX52XXLF | 2 X 26    | 31.75  | 33.48  |
| 20021311-XXX54XXLF | 2 X 27    | 33.02  | 34.75  |
| 20021311-XXX56XXLF | 2 X 28    | 34.29  | 36.02  |
| 20021311-XXX58XXLF | 2 X 29    | 35.56  | 37.29  |
| 20021311-XXX60XXLF | 2 X 30    | 36.83  | 38.56  |
| 20021311-XXX62XXLF | 2 X 31    | 38.1   | 39.83  |
| 20021311-XXX64XXLF | 2 X 32    | 39.37  | 41.1   |
| 20021311-XXX66XXLF | 2 X 33    | 40.64  | 42.37  |
| 20021311-XXX66XXLF | 2 X 34    | 41.91  | 43.64  |

| PRODUCT NO.        | POSITIONS | DIM. A | DIM. B |
|--------------------|-----------|--------|--------|
| 20021311-XXX70XXLF | 2 X 35    | 43.18  | 44.91  |
| 20021311-XXX72XXLF | 2 X 36    | 44.45  | 46.18  |
| 20021311-XXX74XXLF | 2 X 37    | 45.72  | 47.45  |
| 20021311-XXX76XXLF | 2 X 38    | 46.99  | 48.72  |
| 20021311-XXX78XXLF | 2 X 39    | 48.26  | 49.99  |
| 20021311-XXX80XXLF | 2 X 40    | 49.53  | 51.26  |
| 20021311-XXX82XXLF | 2 X 41    | 50.8   | 52.53  |
| 20021311-XXX84XXLF | 2 X 42    | 52.07  | 53.8   |
| 20021311-XXX86XXLF | 2 X 43    | 53.34  | 55.07  |
| 20021311-XXX88XXLF | 2 X 44    | 54.61  | 56.34  |
| 20021311-XXX90XXLF | 2 X 45    | 55.88  | 57.61  |
| 20021311-XXX92XXLF | 2 X 46    | 57.15  | 58.88  |
| 20021311-XXX94XXLF | 2 X 47    | 58.42  | 60.15  |
| 20021311-XXX96XXLF | 2 X 48    | 59.69  | 61.42  |
| 20021311-XXX98XXLF | 2 X 49    | 60.96  | 62.69  |
| 20021311-XXXA0XXLF | 2 X 50    | 62.23  | 63.96  |



Copyright FCI.

|                                             |         |       |            |             |                  |                        |                    |              |       |       |
|---------------------------------------------|---------|-------|------------|-------------|------------------|------------------------|--------------------|--------------|-------|-------|
| spec ref                                    |         | dr    | ANDY ZHANG | 2012-10-29  | projection<br>   | MM<br>                 | size               | A4           | scale | 4.000 |
| tolerance std                               |         | eng   | ANDY ZHANG | 2012-10-29  |                  |                        | ecn no ELX-N-14378 |              |       |       |
| TOLERANCES UNLESS OTHERWISE SPECIFIED       |         | chr   | RICK BIAN  | 2012-10-29  |                  |                        | rel level RELEASED |              |       |       |
|                                             |         | appr  | RICK BIAN  | 2012-10-29  | product family - |                        |                    |              |       |       |
| surface <input checked="" type="checkbox"/> | linear  | 0.X   | ± 0.30     |             | title            | MINITEK 127 RECEPTACLE | dwg no             | 20021311     | rev   | D     |
|                                             |         | 0.XX  | ± 0.20     |             |                  |                        |                    |              |       |       |
|                                             |         | 0.XXX | ± 0.10     | www.fci.com | cat. no.         | -                      | CUSTOMER DRAWING   | sheet 2 of 3 |       |       |
|                                             | angular | 0~    | ± 2°       |             |                  |                        |                    |              |       |       |

ProE File - REV C - 2009-06-09

NOTES:

- 1. MATERIAL:  
HOUSING: HIGH TEMPERATURE PLASTIC; UL94-V0; BLACK.  
TERMINAL: PHOSPHOR BRONZE.
- 2. FINISH:  
TERMINAL: GOLD OR GXT PLATING AT CONTACT AREA (SEE TABLE);  
2.54um/100u" MIN MATTE TIN OR GOLD FLASH AT SOLDER TAIL AREA;  
1.27um/50u" MIN Ni OVER ALL AS UNDERPLATIN
- 3. PRODUCT SPEC PER GS-12-629;
- 4. PACKAGE SPEC PER GS-14-1420;
- 5. RECOMMENDED PCB THICKNESS IS 1.6MM.
- 6. THE HOUSING WILL WITHSTAND EXPOSURE TO 260~C PEAK TEMPERATURE FOR 10 SECONDS IN A CONVECTION INFRA-RED OR VAPOR PHASE REFLOW OVEN.
- 7. PRODUCT MEETS ERUPEAN UNION DIRECTIVES AND OTHER COUNTRY REGULATIONS AS DESCRIBED IN GS-22-008.
- 8. PART NUMBER DESCRIPTION:

20021311 - X X X XX X X LF

- LEAD FREE
- PLATING(SEE TABLE 2)
- 1: GOLD FLASH AT CONTACT, 2.54um MIN. MATTE TIN AT TAIL
- 2: GOLD FLASH AT CONTACT, GOLD FLASH AT TAIL
- 4: 0.25um Au MIN. AT CONTACT, 2.54um MIN.MATTE TIN AT TAIL
- 5: 0.25um Au MIN. AT CONTACT, GOLD FLASH AT TAIL
- 6: 0.38um GXT MIN. AT CONTACT, 2.54um MIN.MATTE TIN AT TAIL
- 7: 0.38um GXT MIN. AT CONTACT, GOLD FLASH AT TAIL
- 8: 0.76um GXT MIN. AT CONTACT, 2.54um MIN.MATTE TIN AT TAIL
- 9: 0.76um GXT MIN. AT CONTACT, GOLD FLASH AT TAIL
- PACKAGE:
- T: TUBE
- PIN COUNT: (SEE TABLE 1)
- 06, 08, 10, ..., 98, A0
- (6 - 100 EVERY EVEN PIN)
- TAIL LENGTH:
- 0: 2.40MM
- RESIN:
- 0: HIGH TEMPERATURE PLASTIC, BLACK
- POST:
- 0: WITHOUT POST



Copyright FCI.

|               |                                       |       |            |            |                |          |                        |            |                    |          |              |   |
|---------------|---------------------------------------|-------|------------|------------|----------------|----------|------------------------|------------|--------------------|----------|--------------|---|
| spec ref      |                                       | dr    | ANDY ZHANG | 2012-10-29 | projection<br> | MM<br>   | size                   | A4         | scale              | 4.000    |              |   |
| tolerance std | TOLERANCES UNLESS OTHERWISE SPECIFIED |       |            | eng        |                |          | ANDY ZHANG             | 2012-10-29 | ecn no ELX-N-14378 |          |              |   |
|               |                                       |       |            | chr        |                |          | RICK BIAN              | 2012-10-29 | rel level          |          |              |   |
|               |                                       | appr  | RICK BIAN  | 2012-10-29 | product family |          | -                      |            |                    |          |              |   |
| surface       | linear                                | 0.X   | ± 0.30     |            |                | title    | MINITEK 127 RECEPTACLE |            | dwg no             | 20021311 | rev          | D |
|               |                                       | 0.XX  | ± 0.20     |            |                |          |                        |            |                    |          |              |   |
|               |                                       | 0.XXX | ± 0.10     |            |                |          |                        |            |                    |          |              |   |
|               | angular                               | 0~    | ± 2°       |            | www.fci.com    | cat. no. | -                      |            | CUSTOMER DRAWING   |          | sheet 3 of 3 |   |

## X-ON Electronics

Largest Supplier of Electrical and Electronic Components

*Click to view similar products for [Headers & Wire Housings](#) category:*

*Click to view products by [Amphenol](#) manufacturer:*

Other Similar products are found below :

[95000-104TRLF](#) [10135584-644402LF](#) [DF62W-EP2022PCA](#) [95000-106TRLF](#) [DF62W-2022SCA](#) [DF62W-EP2022PC](#) [2203348](#) [DF62W-2022SC](#) [1084018](#) [1029039](#) [1084017](#) [802-10-012-10-002000](#) [1112640](#) [1112639](#) [891-007-9SS-BST1T](#) [000-34000](#) [0008550134](#) [0009482033](#) [0009507031](#) [57102-F02-18ULF](#) [57102-S06-03LF](#) [57202-S52-04LF](#) [PCN6-15S-2.5E](#) [0039019024](#) [58102-G61-06LF](#) [582553-1](#) [0009485154](#) [0009508121](#) [0022285053](#) [0050291907](#) [018731A](#) [LY20-4P-DT1-P1E-BR](#) [02.125.8002.8](#) [60101931](#) [60598-1 \(Cut Strip\)](#) [M1625-3R/100](#) [61062-3](#) [61082-181009](#) [CSU011177004](#) [636-1427](#) [638009-1](#) [641938-9](#) [641991-4](#) [644168-1](#) [644827-2](#) [647662-1](#) [65039-019ELF](#) [65692-001LF](#) [65781-018](#) [65781-047](#)