

High Voltage Ceramic Disc Capacitors (Low loss type)

Series: **KGE Char. SL/GP, 1 kVDC to 3 kVDC**

Series: **HT-KB Char. B/Y5P, 500 VDC**

Series: **KBP Char. B/Y5P, 1 kVDC to 3 kVDC**

Series: **HT-KC Char. C/Y5S, 500 VDC**

Series: **KRP Char. R/Y5R 1 kVDC to 3 kVDC**

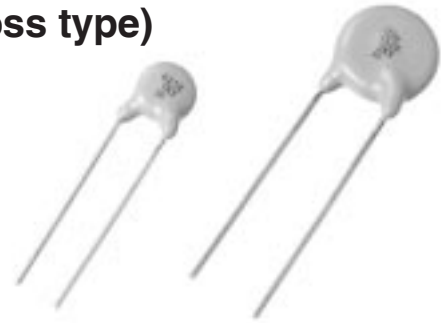

■ Features

- Wide operating temperature: -25 to 105 °C or -25 to 125 °C
- Improved in "Voltage vs. Temperature Rise" through low loss ceramic dielectric material applied
- Flame-retardant insulating coating applied
- Easy mounting through kinked Lead and Radial Taping

■ Recommended Applications

- Snubber circuit of switching power supply
- Horizontal resonance circuit of TV and CRT display
- Inverter type lighting apparatus
- Ballast circuit of LCD backlighting inverter (For series KGE)
- Others High voltage pulse and DC circuits

■ Explanation of Part Numbers

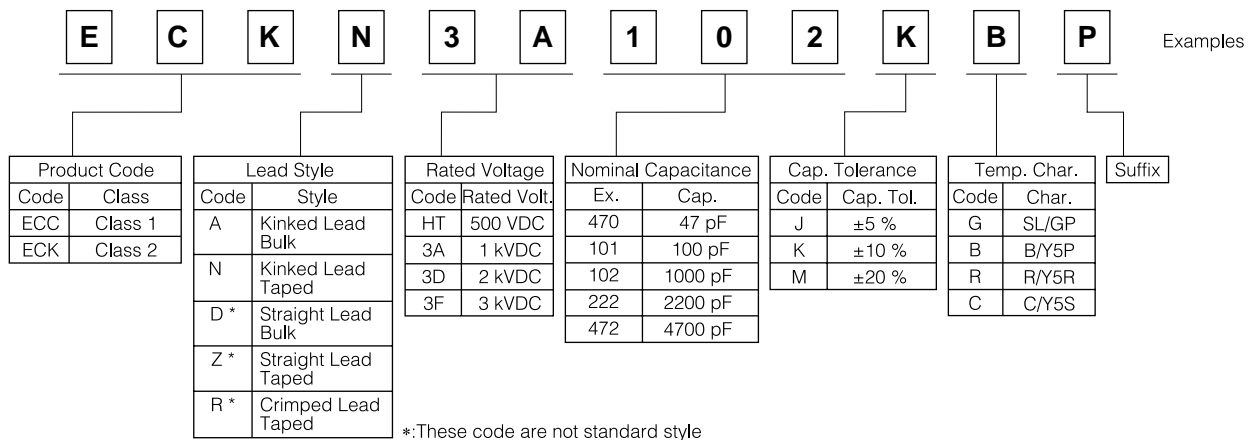

■ Specifications

| | | | | | | | | | | | | | | | | |
|---------------------------------|--|---|--------------|-------|-------|--------------|-----|-------|-------|--------------|-------|-------|-------|--------------|-----|-------|
| Characteristic | Series KGE | Series HT-KB, KBP, HT-KC and KRP | | | | | | | | | | | | | | |
| Operating Temperature Range | -25 to 105 °C | Series HT-KB: -25 to 105 °C Series KBP, HT-KC and KRP: -25 to 125 °C | | | | | | | | | | | | | | |
| Rated Voltage | 1 to 3 kVDC | 500 VDC to 3 kVDC | | | | | | | | | | | | | | |
| Dielectric Withstanding Voltage | 200 % of Rted Voltage for 1 to 5 seconds | Rated Voltage 500VDC: 1250 VDC for 1 to 5 seconds Rated Voltage 1 to 3 kVDC: 200 % of Rated Voltage for 1 to 5 seconds | | | | | | | | | | | | | | |
| Capacitance | Within the specified tolerance, when measured at 1 MHz ± 20 %, 1 to 5 Vrms, and 20 °C | Within the specified tolerance, when measured at 1 kHz ± 20 %, 1 to 5 Vrms, and 20 °C | | | | | | | | | | | | | | |
| Q or Dissipation Factor (tanδ) | 30 pF or under Q ≥ 400+20 C (C: Cap.pF) over 30 pF Q ≥ 1000 at 1 MHz ± 20 %, 1 to 5 Vrms. and 20 °C | Series HT-KB and KBP: tanδ ≥ 0.025 Series HT-KC : tanδ ≥ 0.003 Series KRP : tanδ ≥ 0.002 at 1 kHz ± 20 %, 1 to 5 Vrms. and 20 °C | | | | | | | | | | | | | | |
| Insulation Resistance | 10000 M Ω min. at 500 VDC 1 minute electrification | | | | | | | | | | | | | | | |
| Temperature Characteristics | Temperature Coefficient: +350 to -1000 ppm/°C (Temperature Range: 20 to 85 °C) | Series | | | | | | | | | | | | | | |
| | | Temp.Char | | | | | | | | | | | | | | |
| | | max.Cap.Change | | | | | | | | | | | | | | |
| | | Temp. Range | | | | | | | | | | | | | | |
| | | <table border="1" style="width: 100%; border-collapse: collapse;"> <tr> <td style="width: 15%;">HT-KB</td> <td style="width: 15%;">B/Y5P</td> <td style="width: 15%;">±10 %</td> <td style="width: 15%;">-25 to 85 °C</td> </tr> <tr> <td>KBP</td> <td>B/Y5P</td> <td>±10 %</td> <td>-25 to 85 °C</td> </tr> <tr> <td>HT-KC</td> <td>C/Y5S</td> <td>±20 %</td> <td>-25 to 85 °C</td> </tr> <tr> <td>KRP</td> <td>R/Y5R</td> <td>±15 %</td> <td>-25 to 85 °C</td> </tr> </table> | HT-KB | B/Y5P | ±10 % | -25 to 85 °C | KBP | B/Y5P | ±10 % | -25 to 85 °C | HT-KC | C/Y5S | ±20 % | -25 to 85 °C | KRP | R/Y5R |
| HT-KB | B/Y5P | ±10 % | -25 to 85 °C | | | | | | | | | | | | | |
| KBP | B/Y5P | ±10 % | -25 to 85 °C | | | | | | | | | | | | | |
| HT-KC | C/Y5S | ±20 % | -25 to 85 °C | | | | | | | | | | | | | |
| KRP | R/Y5R | ±15 % | -25 to 85 °C | | | | | | | | | | | | | |

■ Precautions for Handling

See Page 57 to 58

■ Packaging Informations

See Page 59 to 60

■ Dimensions in mm (not to scale)

Standard lead style are kinked Lead and Kinked Lead Taping as below.

As usual style as Straight Lead, Straight Lead Taping and Crimped Lead Taping are available on special order.

● Kinked Lead Type

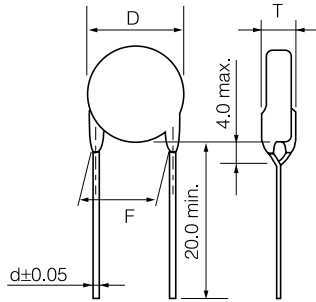

● Straight Lead Type (For reference)

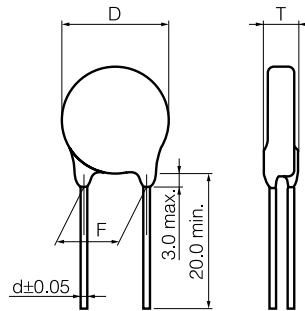

Note: Tolerance of Lead Space

| Dim. F (Nominal) | Tolerance of Dim. F |
|------------------|---------------------|
| 5.0 | ±1.0 |
| 7.5 | ±1.5 |
| 10.0 | ±1.5 |

● Kinked Lead Taping

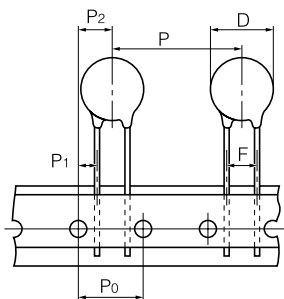
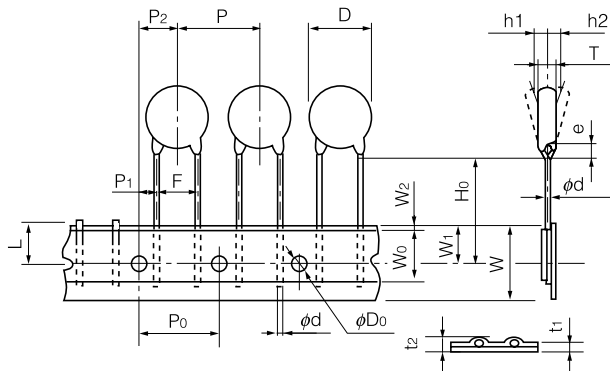

| Taping Type | N0 | N1 | N2 |
|-----------------------------------|--|-----------|-----------|
| Symbol | | | |
| P | 12.7±1.0 | 15.0±2.0 | 30.0±2.0 |
| P ₀ | 12.7±0.3 | 15.0±0.3 | 15.0±0.3 |
| F | 5.0±0.8 | 7.5±1.0 | 7.5±1.0 |
| P ₁ | 3.85±0.70 | 3.75±0.80 | 3.75±0.80 |
| P ₂ | 6.35±1.30 | 7.5±1.5 | 7.5±1.5 |
| D | To comply with each individual specification | | |
| W | 18.0 ^{+1.0} _{-0.5} | | |
| W ₀ | 10.0 min. | | |
| W ₁ | 9.0±0.5 | | |
| W ₂ | 3.0 max. | | |
| H ₀ | 18.0 ^{+2.0} ₀ | | |
| e | 4.0 max. | | |
| ϕD ₀ | 4.0±0.2 | | |
| ϕd | 0.60±0.05 | 0.65±0.05 | |
| t ₁ | 0.6±0.3 | | |
| t ₂ | 1.5 max. | | |
| T | To comply with each individual specification | | |
| Δh ₁ , Δh ₂ | 2.0 max. | | |
| L | 11.0 max. | | |

Same dimensions as Type N0, N1 except for special dimensions.

■ Rated Voltage and Capacitance Range

| Series Name | Temp. Char. | Rated Voltage | Capacitance Range in pF | | | | Typical Applications |
|-------------------------|-------------|---------------|-------------------------|-----|------|-------|--|
| | | | 10 | 100 | 1000 | 10000 | |
| Series KGE | SL/GP | 1 kVDC | 470 | | | | Ballast circuit of LCD backlighting inverter |
| | | 2 kVDC | 220 | | | | |
| | | 3 kVDC | 150 | | | | Snubber circuit of switching power supply |
| Series HT-KB | B/Y5P | 500 VDC | 4700 | | | | Snubber circuit of switching power supply |
| Series KBP | B/Y5P | 1 kVDC | 5600 | | | | Horizontal resonance circuit of TV and CRT display |
| | | 2 kVDC | 5600 | | | | |
| | | 3 kVDC | 2700 | | | | |
| NEW Series HT-KC | C/Y5S | 500 VDC | 4700 | | | | Snubber circuit of switching power supply |
| NEW Series KRP | R/Y5R | 1 kVDC | 4700 | | | | |
| | | 2 kVDC | 4700 | | | | |
| | | 3 kVDC | 2200 | | | | |

■ Dimensions "D" (Body Diameter)

unit : mm

| Cap. in pF | KGE | | | HT-KB | KBP | | | HT-KC | KRP | | |
|------------|------|------|------|-------|------|------|------|-------|------|------|------|
| | 1 kV | 2 kV | 3 kV | 500 V | 1 kV | 2 kV | 3 kV | 500 V | 1 kV | 2 kV | 3 kV |
| 12 to 39 | 6.0 | 7.0 | 7.0 | | | | | | | | |
| 47 | 6.0 | 7.0 | 7.0 | | | | | | | | |
| 56 | 6.0 | 7.0 | 8.0 | | | | | | | | |
| 68 | 6.0 | 7.0 | 8.0 | | | | | | | | |
| 82 | 6.0 | 7.0 | 9.0 | | | | | | | | |
| 100 | 7.0 | 8.0 | 10.0 | 6.0 | 6.0 | 7.0 | 7.5 | 6.0 | 6.0 | 7.0 | 7.5 |
| 120 | 7.0 | 8.0 | 10.0 | 6.0 | 6.0 | 7.0 | 7.5 | 6.0 | 6.0 | 7.0 | 7.5 |
| 150 | 8.0 | 9.0 | 11.0 | 6.0 | 6.0 | 7.0 | 7.5 | 6.0 | 6.0 | 7.0 | 7.5 |
| 180 | 8.0 | 10.0 | | 6.0 | 6.0 | 7.0 | 7.5 | 6.0 | 6.0 | 7.0 | 7.5 |
| 220 | 9.0 | 10.0 | | 6.0 | 6.0 | 7.0 | 7.5 | 6.0 | 6.0 | 7.0 | 8.0 |
| 270 | 9.0 | | | 6.0 | 6.0 | 7.0 | 7.5 | 6.0 | 6.0 | 7.0 | 8.0 |
| 330 | 11.0 | | | 6.0 | 6.0 | 7.0 | 8.0 | 6.0 | 6.0 | 7.5 | 8.5 |
| 390 | 11.0 | | | 6.0 | 6.0 | 7.0 | 9.0 | 6.0 | 7.0 | 7.5 | 9.5 |
| 470 | 13.0 | | | 6.0 | 6.0 | 7.5 | 9.5 | 6.0 | 7.0 | 9.0 | 9.5 |
| 560 | | | | 6.0 | 7.0 | 8.0 | 10.0 | 7.0 | 7.0 | 9.0 | 10.5 |
| 680 | | | | 7.0 | 7.0 | 9.0 | 11.0 | 7.0 | 7.5 | 10.0 | 10.5 |
| 820 | | | | 7.0 | 7.5 | 9.0 | 11.0 | 7.0 | 7.5 | 10.0 | 12.5 |
| 1000 | | | | 7.0 | 9.0 | 10.0 | 12.5 | 7.0 | 9.0 | 12.0 | 12.5 |
| 1200 | | | | 8.5 | 9.0 | 10.5 | 14.5 | 8.5 | 9.0 | 12.0 | 14.5 |
| 1500 | | | | 8.5 | 9.5 | 12.0 | 14.5 | 8.5 | 10.5 | 12.0 | 14.5 |
| 1800 | | | | 10.0 | 12.0 | 12.5 | 16.0 | 10.0 | 10.5 | 14.0 | 16.5 |
| 2200 | | | | 10.0 | 12.0 | 14.0 | 17.0 | 10.0 | 11.5 | 16.0 | 17.0 |
| 2700 | | | | 10.0 | 13.5 | 16.0 | 18.5 | 11.0 | 13.0 | 16.0 | |
| 3300 | | | | 11.0 | 13.5 | 17.0 | | 13.0 | 13.0 | 19.0 | |
| 3900 | | | | 13.0 | 15.5 | 18.0 | | 13.0 | 14.0 | 20.0 | |
| 4700 | | | | 13.0 | 15.5 | 25.0 | | 14.0 | 16.5 | 21.0 | |
| 5600 | | | | | 17.0 | 25.0 | | | | | |

Rating and Characteristics

- Series KGE (Class 1, Temp. Char. SL/GP, 1 kVDC to 3 kVDC)

| Rated Volt. | Cap. in pF | Capacitance Tolerance (%) | Dimensions in mm | | Kinked Lead Type (Bulk) | | | | Kinked Lead Taping Type | | | |
|-------------|------------|---------------------------|------------------|--------------|-------------------------|------------------|--------------|--------------|-------------------------|------------------|------|--|
| | | | D max. | T max. | Part Number | Dimensions in mm | | Part Number | Taped Type | Dimensions in mm | | |
| | | | | | | F | d | | | F | d | |
| 1 kVDC | 12 | ±5 or ±10 | 6.0 | 5.0 | ECCA3A120□GE | 5.0 | 0.60 | ECCN3A120□GE | NO | 5.0 | 0.60 | |
| | 15 | ±5 or ±10 | 6.0 | 5.0 | ECCA3A150□GE | 5.0 | 0.60 | ECCN3A150□GE | NO | 5.0 | 0.60 | |
| | 18 | ±5 or ±10 | 6.0 | 5.0 | ECCA3A180□GE | 5.0 | 0.60 | ECCN3A180□GE | NO | 5.0 | 0.60 | |
| | 22 | ±5 or ±10 | 6.0 | 5.0 | ECCA3A220□GE | 5.0 | 0.60 | ECCN3A220□GE | NO | 5.0 | 0.60 | |
| | 27 | ±5 or ±10 | 6.0 | 5.0 | ECCA3A270□GE | 5.0 | 0.60 | ECCN3A270□GE | NO | 5.0 | 0.60 | |
| | 33 | ±5 or ±10 | 6.0 | 5.0 | ECCA3A330□GE | 5.0 | 0.60 | ECCN3A330□GE | NO | 5.0 | 0.60 | |
| | 39 | ±5 or ±10 | 6.0 | 5.0 | ECCA3A390□GE | 5.0 | 0.60 | ECCN3A390□GE | NO | 5.0 | 0.60 | |
| | 47 | ±5 or ±10 | 6.0 | 5.0 | ECCA3A470□GE | 5.0 | 0.60 | ECCN3A470□GE | NO | 5.0 | 0.60 | |
| | 56 | ±5 or ±10 | 6.0 | 5.0 | ECCA3A560□GE | 5.0 | 0.60 | ECCN3A560□GE | NO | 5.0 | 0.60 | |
| | 68 | ±5 or ±10 | 6.0 | 5.0 | ECCA3A680□GE | 5.0 | 0.60 | ECCN3A680□GE | NO | 5.0 | 0.60 | |
| | 82 | ±5 or ±10 | 6.0 | 5.0 | ECCA3A820□GE | 5.0 | 0.60 | ECCN3A820□GE | NO | 5.0 | 0.60 | |
| | 100 | ±5 or ±10 | 7.0 | 5.0 | ECCA3A101□GE | 5.0 | 0.60 | ECCN3A101□GE | NO | 5.0 | 0.60 | |
| | 120 | ±5 or ±10 | 7.0 | 5.0 | ECCA3A121□GE | 5.0 | 0.60 | ECCN3A121□GE | NO | 5.0 | 0.60 | |
| | 150 | ±5 or ±10 | 8.0 | 5.0 | ECCA3A151□GE | 5.0 | 0.60 | ECCN3A151□GE | NO | 5.0 | 0.60 | |
| | 180 | ±5 or ±10 | 8.0 | 5.0 | ECCA3A181□GE | 5.0 | 0.60 | ECCN3A181□GE | NO | 5.0 | 0.60 | |
| | 220 | ±5 or ±10 | 9.0 | 5.0 | ECCA3A221□GE | 5.0 | 0.60 | ECCN3A221□GE | NO | 5.0 | 0.60 | |
| | 270 | ±5 or ±10 | 9.0 | 5.0 | ECCA3A271□GE | 5.0 | 0.60 | ECCN3A271□GE | NO | 5.0 | 0.60 | |
| | 330 | ±5 or ±10 | 11.0 | 5.0 | ECCA3A331□GE | 5.0 | 0.60 | ECCN3A331□GE | NO | 5.0 | 0.60 | |
| | 390 | ±5 or ±10 | 11.0 | 5.0 | ECCA3A391□GE | 5.0 | 0.60 | ECCN3A391□GE | NO | 5.0 | 0.60 | |
| 470 | ±5 or ±10 | 13.0 | 5.0 | ECCA3A471□GE | 7.5 | 0.65 | ECCN3A471□GE | N1 | 7.5 | 0.65 | | |
| 2 kVDC | 12 | ±5 or ±10 | 7.0 | 5.5 | ECCA3D120□GE | 7.5 | 0.65 | ECCN3D120□GE | N1 | 7.5 | 0.65 | |
| | 15 | ±5 or ±10 | 7.0 | 5.5 | ECCA3D150□GE | 7.5 | 0.65 | ECCN3D150□GE | N1 | 7.5 | 0.65 | |
| | 18 | ±5 or ±10 | 7.0 | 5.5 | ECCA3D180□GE | 7.5 | 0.65 | ECCN3D180□GE | N1 | 7.5 | 0.65 | |
| | 22 | ±5 or ±10 | 7.0 | 5.5 | ECCA3D220□GE | 7.5 | 0.65 | ECCN3D220□GE | N1 | 7.5 | 0.65 | |
| | 27 | ±5 or ±10 | 7.0 | 5.5 | ECCA3D270□GE | 7.5 | 0.65 | ECCN3D270□GE | N1 | 7.5 | 0.65 | |
| | 33 | ±5 or ±10 | 7.0 | 5.5 | ECCA3D330□GE | 7.5 | 0.65 | ECCN3D330□GE | N1 | 7.5 | 0.65 | |
| | 39 | ±5 or ±10 | 7.0 | 5.5 | ECCA3D390□GE | 7.5 | 0.65 | ECCN3D390□GE | N1 | 7.5 | 0.65 | |
| | 47 | ±5 or ±10 | 7.0 | 5.5 | ECCA3D470□GE | 7.5 | 0.65 | ECCN3D470□GE | N1 | 7.5 | 0.65 | |
| | 56 | ±5 or ±10 | 7.0 | 5.5 | ECCA3D560□GE | 7.5 | 0.65 | ECCN3D560□GE | N1 | 7.5 | 0.65 | |
| | 68 | ±5 or ±10 | 7.0 | 5.5 | ECCA3D680□GE | 7.5 | 0.65 | ECCN3D680□GE | N1 | 7.5 | 0.65 | |
| | 82 | ±5 or ±10 | 7.0 | 5.5 | ECCA3D820□GE | 7.5 | 0.65 | ECCN3D820□GE | N1 | 7.5 | 0.65 | |
| | 100 | ±5 or ±10 | 8.0 | 5.5 | ECCA3D101□GE | 7.5 | 0.65 | ECCN3D101□GE | N1 | 7.5 | 0.65 | |
| | 120 | ±5 or ±10 | 8.0 | 5.5 | ECCA3D121□GE | 7.5 | 0.65 | ECCN3D121□GE | N1 | 7.5 | 0.65 | |
| | 150 | ±5 or ±10 | 9.0 | 5.5 | ECCA3D151□GE | 7.5 | 0.65 | ECCN3D151□GE | N1 | 7.5 | 0.65 | |
| 180 | ±5 or ±10 | 10.0 | 5.5 | ECCA3D181□GE | 7.5 | 0.65 | ECCN3D181□GE | N1 | 7.5 | 0.65 | | |
| 220 | ±5 or ±10 | 10.0 | 5.5 | ECCA3D221□GE | 7.5 | 0.65 | ECCN3D221□GE | N1 | 7.5 | 0.65 | | |
| 3 kVDC | 12 | ±5 or ±10 | 7.0 | 6.0 | ECCA3F120□GE | 7.5 | 0.65 | ECCN3F120□GE | N1 | 7.5 | 0.65 | |
| | 15 | ±5 or ±10 | 7.0 | 6.0 | ECCA3F150□GE | 7.5 | 0.65 | ECCN3F150□GE | N1 | 7.5 | 0.65 | |
| | 18 | ±5 or ±10 | 7.0 | 6.0 | ECCA3F180□GE | 7.5 | 0.65 | ECCN3F180□GE | N1 | 7.5 | 0.65 | |
| | 22 | ±5 or ±10 | 7.0 | 6.0 | ECCA3F220□GE | 7.5 | 0.65 | ECCN3F220□GE | N1 | 7.5 | 0.65 | |
| | 27 | ±5 or ±10 | 7.0 | 6.0 | ECCA3F270□GE | 7.5 | 0.65 | ECCN3F270□GE | N1 | 7.5 | 0.65 | |
| | 33 | ±5 or ±10 | 7.0 | 6.0 | ECCA3F330□GE | 7.5 | 0.65 | ECCN3F330□GE | N1 | 7.5 | 0.65 | |
| | 39 | ±5 or ±10 | 7.0 | 6.0 | ECCA3F390□GE | 7.5 | 0.65 | ECCN3F390□GE | N1 | 7.5 | 0.65 | |
| | 47 | ±5 or ±10 | 7.0 | 6.0 | ECCA3F470□GE | 7.5 | 0.65 | ECCN3F470□GE | N1 | 7.5 | 0.65 | |
| | 56 | ±5 or ±10 | 8.0 | 6.0 | ECCA3F560□GE | 7.5 | 0.65 | ECCN3F560□GE | N1 | 7.5 | 0.65 | |
| | 68 | ±5 or ±10 | 8.0 | 6.0 | ECCA3F680□GE | 7.5 | 0.65 | ECCN3F680□GE | N1 | 7.5 | 0.65 | |
| | 82 | ±5 or ±10 | 9.0 | 6.0 | ECCA3F820□GE | 7.5 | 0.65 | ECCN3F820□GE | N1 | 7.5 | 0.65 | |
| | 100 | ±5 or ±10 | 10.0 | 6.0 | ECCA3F101□GE | 7.5 | 0.65 | ECCN3F101□GE | N1 | 7.5 | 0.65 | |
| | 120 | ±5 or ±10 | 10.0 | 6.0 | ECCA3F121□GE | 7.5 | 0.65 | ECCN3F121□GE | N1 | 7.5 | 0.65 | |
| | 150 | ±5 or ±10 | 11.0 | 6.0 | ECCA3F151□GE | 7.5 | 0.65 | ECCN3F151□GE | N1 | 7.5 | 0.65 | |

Note: Lead spacing (Dim. F) of 5.0 mm is available for rated voltage 2 kVDC and 3 kVDC capacitors that are 11.0 mm or less in the body diameter (Dim. D) on special order.

■ Rating and Characteristics

● Series HT-KB (Class 2, Temp. Char. B/Y5P, 500 VDC)

| Rated Volt. | Cap. in pF | Cap. Tol. (%) | Dimensions in mm | | Kinked Lead Type (Bulk) | | | Kinked Lead Taping Type | | | |
|-------------|------------|---------------|------------------|-------------|-------------------------|------------------|-------------|-------------------------|------------|------------------|------|
| | | | D max. | T max. | Part Number | Dimensions in mm | | Part Number | Taped Type | Dimensions in mm | |
| | | | | | | F | d | | | F | d |
| 500 VDC | 100 | ±10 | 6.0 | 4.0 | ECKAHT101KB | 5.0 | 0.60 | ECKNHT101KB | N0 | 5.0 | 0.60 |
| | 120 | ±10 | 6.0 | 4.0 | ECKAHT121KB | 5.0 | 0.60 | ECKNHT121KB | N0 | 5.0 | 0.60 |
| | 150 | ±10 | 6.0 | 4.0 | ECKAHT151KB | 5.0 | 0.60 | ECKNHT151KB | N0 | 5.0 | 0.60 |
| | 180 | ±10 | 6.0 | 4.0 | ECKAHT181KB | 5.0 | 0.60 | ECKNHT181KB | N0 | 5.0 | 0.60 |
| | 220 | ±10 | 6.0 | 4.0 | ECKAHT221KB | 5.0 | 0.60 | ECKNHT221KB | N0 | 5.0 | 0.60 |
| | 270 | ±10 | 6.0 | 4.0 | ECKAHT271KB | 5.0 | 0.60 | ECKNHT271KB | N0 | 5.0 | 0.60 |
| | 330 | ±10 | 6.0 | 4.0 | ECKAHT331KB | 5.0 | 0.60 | ECKNHT331KB | N0 | 5.0 | 0.60 |
| | 390 | ±10 | 6.0 | 4.0 | ECKAHT391KB | 5.0 | 0.60 | ECKNHT391KB | N0 | 5.0 | 0.60 |
| | 470 | ±10 | 6.0 | 4.0 | ECKAHT471KB | 5.0 | 0.60 | ECKNHT471KB | N0 | 5.0 | 0.60 |
| | 560 | ±10 | 6.0 | 4.0 | ECKAHT561KB | 5.0 | 0.60 | ECKNHT561KB | N0 | 5.0 | 0.60 |
| | 680 | ±10 | 7.0 | 4.0 | ECKAHT681KB | 5.0 | 0.60 | ECKNHT681KB | N0 | 5.0 | 0.60 |
| | 820 | ±10 | 7.0 | 4.0 | ECKAHT821KB | 5.0 | 0.60 | ECKNHT821KB | N0 | 5.0 | 0.60 |
| | 1000 | ±10 | 7.0 | 4.0 | ECKAHT102KB | 5.0 | 0.60 | ECKNHT102KB | N0 | 5.0 | 0.60 |
| | 1200 | ±10 | 8.5 | 4.0 | ECKAHT122KB | 5.0 | 0.60 | ECKNHT122KB | N0 | 5.0 | 0.60 |
| | 1500 | ±10 | 8.5 | 4.0 | ECKAHT152KB | 5.0 | 0.60 | ECKNHT152KB | N0 | 5.0 | 0.60 |
| | 1800 | ±10 | 10.0 | 4.0 | ECKAHT182KB | 5.0 | 0.60 | ECKNHT182KB | N0 | 5.0 | 0.60 |
| | 2200 | ±10 | 10.0 | 4.0 | ECKAHT222KB | 5.0 | 0.60 | ECKNHT222KB | N0 | 5.0 | 0.60 |
| | 2700 | ±10 | 10.0 | 4.0 | ECKAHT272KB | 5.0 | 0.60 | ECKNHT272KB | N0 | 5.0 | 0.60 |
| 3300 | ±10 | 11.0 | 4.0 | ECKAHT332KB | 5.0 | 0.60 | ECKNHT332KB | N0 | 5.0 | 0.60 | |
| 3900 | ±10 | 13.0 | 4.0 | ECKAHT392KB | 10.0 | 0.65 | ECKNHT392KB | N1 | 7.5 | 0.65 | |
| 4700 | ±10 | 13.0 | 4.0 | ECKAHT472KB | 10.0 | 0.65 | ECKNHT472KB | N1 | 7.5 | 0.65 | |

● Series KBP (Class 2, Temp. Char. B/Y5P, 1 to 3 kVDC)

| Rated Volt. | Cap. in pF | Cap. Tol. (%) | Dimensions in mm | | Kinked Lead Type (Bulk) | | | Kinked Lead Taping Type | | | |
|-------------|------------|---------------|------------------|--------------|-------------------------|------------------|--------------|-------------------------|------------|------------------|------|
| | | | D max. | T max. | Part Number | Dimensions in mm | | Part Number | Taped Type | Dimensions in mm | |
| | | | | | | F | d | | | F | d |
| 1 kVDC | 100 | ±10 | 6.0 | 4.5 | ECKA3A101KBP | 5.0 | 0.60 | ECKN3A101KBP | N0 | 5.0 | 0.60 |
| | 120 | ±10 | 6.0 | 4.5 | ECKA3A121KBP | 5.0 | 0.60 | ECKN3A121KBP | N0 | 5.0 | 0.60 |
| | 150 | ±10 | 6.0 | 4.5 | ECKA3A151KBP | 5.0 | 0.60 | ECKN3A151KBP | N0 | 5.0 | 0.60 |
| | 180 | ±10 | 6.0 | 4.5 | ECKA3A181KBP | 5.0 | 0.60 | ECKN3A181KBP | N0 | 5.0 | 0.60 |
| | 220 | ±10 | 6.0 | 4.5 | ECKA3A221KBP | 5.0 | 0.60 | ECKN3A221KBP | N0 | 5.0 | 0.60 |
| | 270 | ±10 | 6.0 | 4.5 | ECKA3A271KBP | 5.0 | 0.60 | ECKN3A271KBP | N0 | 5.0 | 0.60 |
| | 330 | ±10 | 6.0 | 4.5 | ECKA3A331KBP | 5.0 | 0.60 | ECKN3A331KBP | N0 | 5.0 | 0.60 |
| | 390 | ±10 | 6.0 | 4.5 | ECKA3A391KBP | 5.0 | 0.60 | ECKN3A391KBP | N0 | 5.0 | 0.60 |
| | 470 | ±10 | 6.0 | 4.5 | ECKA3A471KBP | 5.0 | 0.60 | ECKN3A471KBP | N0 | 5.0 | 0.60 |
| | 560 | ±10 | 7.0 | 4.5 | ECKA3A561KBP | 5.0 | 0.60 | ECKN3A561KBP | N0 | 5.0 | 0.60 |
| | 680 | ±10 | 7.0 | 4.5 | ECKA3A681KBP | 5.0 | 0.60 | ECKN3A681KBP | N0 | 5.0 | 0.60 |
| | 820 | ±10 | 7.5 | 4.5 | ECKA3A821KBP | 5.0 | 0.60 | ECKN3A821KBP | N0 | 5.0 | 0.60 |
| | 1000 | ±10 | 9.0 | 4.5 | ECKA3A102KBP | 5.0 | 0.60 | ECKN3A102KBP | N0 | 5.0 | 0.60 |
| | 1200 | ±10 | 9.0 | 4.5 | ECKA3A122KBP | 5.0 | 0.60 | ECKN3A122KBP | N0 | 5.0 | 0.60 |
| | 1500 | ±10 | 9.5 | 4.5 | ECKA3A152KBP | 5.0 | 0.60 | ECKN3A152KBP | N0 | 5.0 | 0.60 |
| | 1800 | ±10 | 10.0 | 4.5 | ECKA3A182KBP | 5.0 | 0.60 | ECKN3A182KBP | N0 | 5.0 | 0.60 |
| | 2200 | ±10 | 12.0 | 4.5 | ECKA3A222KBP | 5.0 | 0.60 | ECKN3A222KBP | N0 | 5.0 | 0.60 |
| | 2700 | ±10 | 12.0 | 4.5 | ECKA3A272KBP | 5.0 | 0.60 | ECKN3A272KBP | N0 | 5.0 | 0.60 |
| 3300 | ±10 | 13.5 | 4.5 | ECKA3A332KBP | 10.0 | 0.65 | ECKN3A332KBP | N1 | 7.5 | 0.65 | |
| 3900 | ±10 | 13.5 | 4.5 | ECKA3A392KBP | 10.0 | 0.65 | ECKN3A392KBP | N1 | 7.5 | 0.65 | |
| 4700 | ±10 | 15.5 | 4.5 | ECKA3A472KBP | 10.0 | 0.65 | ECKN3A472KBP | N2 | 7.5 | 0.65 | |
| 5600 | ±10 | 17.0 | 4.5 | ECKA3A562KBP | 10.0 | 0.65 | ECKN3A562KBP | N2 | 7.5 | 0.65 | |

■ Rating and Characteristics

● Series KBP (Class 2, Temp. Char. B/Y5P, 1 to 3 kVDC) (Continuation)

| Rated Volt. | Cap. in pF | Cap. Tol. (%) | Dimensions in mm | | Kinked Lead Type (Bulk) | | | Kinked Lead Taping Type | | | |
|-------------|------------|---------------|------------------|--------------|-------------------------|------------------|--------------|-------------------------|------------|------------------|------|
| | | | D max. | T max. | Part Number | Dimensions in mm | | Part Number | Taped Type | Dimensions in mm | |
| | | | | | | F | d | | | F | d |
| 2 kVDC | 100 | ±10 | 7.0 | 5.0 | ECKA3D101KBP | 7.5 | 0.65 | ECKN3D101KBP | N1 | 7.5 | 0.65 |
| | 120 | ±10 | 7.0 | 5.0 | ECKA3D121KBP | 7.5 | 0.65 | ECKN3D121KBP | N1 | 7.5 | 0.65 |
| | 150 | ±10 | 7.0 | 5.0 | ECKA3D151KBP | 7.5 | 0.65 | ECKN3D151KBP | N1 | 7.5 | 0.65 |
| | 180 | ±10 | 7.0 | 5.0 | ECKA3D181KBP | 7.5 | 0.65 | ECKN3D181KBP | N1 | 7.5 | 0.65 |
| | 220 | ±10 | 7.0 | 5.0 | ECKA3D221KBP | 7.5 | 0.65 | ECKN3D221KBP | N1 | 7.5 | 0.65 |
| | 270 | ±10 | 7.0 | 5.0 | ECKA3D271KBP | 7.5 | 0.65 | ECKN3D271KBP | N1 | 7.5 | 0.65 |
| | 330 | ±10 | 7.0 | 5.0 | ECKA3D331KBP | 7.5 | 0.65 | ECKN3D331KBP | N1 | 7.5 | 0.65 |
| | 390 | ±10 | 7.0 | 5.0 | ECKA3D391KBP | 7.5 | 0.65 | ECKN3D391KBP | N1 | 7.5 | 0.65 |
| | 470 | ±10 | 7.5 | 5.0 | ECKA3D471KBP | 7.5 | 0.65 | ECKN3D471KBP | N1 | 7.5 | 0.65 |
| | 560 | ±10 | 8.0 | 5.0 | ECKA3D561KBP | 7.5 | 0.65 | ECKN3D561KBP | N1 | 7.5 | 0.65 |
| | 680 | ±10 | 9.0 | 5.0 | ECKA3D681KBP | 7.5 | 0.65 | ECKN3D681KBP | N1 | 7.5 | 0.65 |
| | 820 | ±10 | 9.0 | 5.0 | ECKA3D821KBP | 7.5 | 0.65 | ECKN3D821KBP | N1 | 7.5 | 0.65 |
| | 1000 | ±10 | 10.0 | 5.0 | ECKA3D102KBP | 7.5 | 0.65 | ECKN3D102KBP | N1 | 7.5 | 0.65 |
| | 1200 | ±10 | 10.5 | 5.0 | ECKA3D122KBP | 7.5 | 0.65 | ECKN3D122KBP | N1 | 7.5 | 0.65 |
| | 1500 | ±10 | 12.0 | 5.0 | ECKA3D152KBP | 7.5 | 0.65 | ECKN3D152KBP | N1 | 7.5 | 0.65 |
| | 1800 | ±10 | 12.5 | 5.0 | ECKA3D182KBP | 7.5 | 0.65 | ECKN3D182KBP | N1 | 7.5 | 0.65 |
| | 2200 | ±10 | 14.0 | 5.0 | ECKA3D222KBP | 10.0 | 0.65 | ECKN3D222KBP | N2 | 7.5 | 0.65 |
| | 2700 | ±10 | 16.0 | 5.0 | ECKA3D272KBP | 10.0 | 0.65 | ECKN3D272KBP | N2 | 7.5 | 0.65 |
| | 3300 | ±10 | 17.0 | 5.0 | ECKA3D332KBP | 10.0 | 0.65 | ECKN3D332KBP | N2 | 7.5 | 0.65 |
| | 3900 | ±10 | 18.0 | 5.0 | ECKA3D392KBP | 10.0 | 0.65 | ECKN3D392KBP | N2 | 7.5 | 0.65 |
| 4700 | ±10 | 25.0 | 5.0 | ECKA3D472KBP | 10.0 | 0.65 | — | — | — | — | |
| 5600 | ±10 | 25.0 | 5.0 | ECKA3D562KBP | 10.0 | 0.65 | — | — | — | — | |
| 3 kVDC | 100 | ±10 | 7.5 | 6.0 | ECKA3F101KBP | 7.5 | 0.65 | ECKN3F101KBP | N1 | 7.5 | 0.65 |
| | 120 | ±10 | 7.5 | 6.0 | ECKA3F121KBP | 7.5 | 0.65 | ECKN3F121KBP | N1 | 7.5 | 0.65 |
| | 150 | ±10 | 7.5 | 6.0 | ECKA3F151KBP | 7.5 | 0.65 | ECKN3F151KBP | N1 | 7.5 | 0.65 |
| | 180 | ±10 | 7.5 | 6.0 | ECKA3F181KBP | 7.5 | 0.65 | ECKN3F181KBP | N1 | 7.5 | 0.65 |
| | 220 | ±10 | 7.5 | 6.0 | ECKA3F221KBP | 7.5 | 0.65 | ECKN3F221KBP | N1 | 7.5 | 0.65 |
| | 270 | ±10 | 7.5 | 6.0 | ECKA3F271KBP | 7.5 | 0.65 | ECKN3F271KBP | N1 | 7.5 | 0.65 |
| | 330 | ±10 | 8.0 | 6.0 | ECKA3F331KBP | 7.5 | 0.65 | ECKN3F331KBP | N1 | 7.5 | 0.65 |
| | 390 | ±10 | 9.0 | 6.0 | ECKA3F391KBP | 7.5 | 0.65 | ECKN3F391KBP | N1 | 7.5 | 0.65 |
| | 470 | ±10 | 9.5 | 6.0 | ECKA3F471KBP | 7.5 | 0.65 | ECKN3F471KBP | N1 | 7.5 | 0.65 |
| | 560 | ±10 | 10.0 | 6.0 | ECKA3F561KBP | 7.5 | 0.65 | ECKN3F561KBP | N1 | 7.5 | 0.65 |
| | 680 | ±10 | 11.0 | 6.0 | ECKA3F681KBP | 7.5 | 0.65 | ECKN3F681KBP | N1 | 7.5 | 0.65 |
| | 820 | ±10 | 11.0 | 6.0 | ECKA3F821KBP | 7.5 | 0.65 | ECKN3F821KBP | N1 | 7.5 | 0.65 |
| | 1000 | ±10 | 12.5 | 6.0 | ECKA3F102KBP | 7.5 | 0.65 | ECKN3F102KBP | N1 | 7.5 | 0.65 |
| | 1200 | ±10 | 14.5 | 6.0 | ECKA3F122KBP | 10.0 | 0.65 | ECKN3F122KBP | N1 | 7.5 | 0.65 |
| | 1500 | ±10 | 14.5 | 6.0 | ECKA3F152KBP | 10.0 | 0.65 | ECKN3F152KBP | N1 | 7.5 | 0.65 |
| | 1800 | ±10 | 16.0 | 6.0 | ECKA3F182KBP | 10.0 | 0.65 | ECKN3F182KBP | N2 | 7.5 | 0.65 |
| | 2200 | ±10 | 17.0 | 6.0 | ECKA3F222KBP | 10.0 | 0.65 | ECKN3F222KBP | N2 | 7.5 | 0.65 |
| 2700 | ±10 | 18.5 | 6.0 | ECKA3F272KBP | 10.0 | 0.65 | ECKN3F272KBP | N2 | 7.5 | 0.65 | |

Note: Lead spacing (Dim. F) of 5.0 mm is available for rated voltage 2 kVDC and 3 kVDC capacitors that are 11.0 mm or less in the body diameter (Dim. D) on special order.

Rating and Characteristics

NEW

● Series HT-KC (Class 2, Temp. Char. C/Y5S, 500 VDC)

| Rated Volt. | Cap. in pF | Cap. Tol. (%) | Dimensions in mm | | Kinked Lead Type (Bulk) | | | Kinked Lead Taping Type | | | |
|-------------|------------|---------------|------------------|-------------|-------------------------|------------------|-------------|-------------------------|------------|------------------|------|
| | | | D max. | T max. | Part Number | Dimensions in mm | | Part Number | Taped Type | Dimensions in mm | |
| | | | | | | F | d | | | F | d |
| 500 VDC | 100 | ±10 | 6.0 | 4.0 | ECKAHT101KC | 5.0 | 0.60 | ECKNHT101KC | N0 | 5.0 | 0.60 |
| | 120 | ±10 | 6.0 | 4.0 | ECKAHT121KC | 5.0 | 0.60 | ECKNHT121KC | N0 | 5.0 | 0.60 |
| | 150 | ±10 | 6.0 | 4.0 | ECKAHT151KC | 5.0 | 0.60 | ECKNHT151KC | N0 | 5.0 | 0.60 |
| | 180 | ±10 | 6.0 | 4.0 | ECKAHT181KC | 5.0 | 0.60 | ECKNHT181KC | N0 | 5.0 | 0.60 |
| | 220 | ±10 | 6.0 | 4.0 | ECKAHT221KC | 5.0 | 0.60 | ECKNHT221KC | N0 | 5.0 | 0.60 |
| | 270 | ±10 | 6.0 | 4.0 | ECKAHT271KC | 5.0 | 0.60 | ECKNHT271KC | N0 | 5.0 | 0.60 |
| | 330 | ±10 | 6.0 | 4.0 | ECKAHT331KC | 5.0 | 0.60 | ECKNHT331KC | N0 | 5.0 | 0.60 |
| | 390 | ±10 | 6.0 | 4.0 | ECKAHT391KC | 5.0 | 0.60 | ECKNHT391KC | N0 | 5.0 | 0.60 |
| | 470 | ±10 | 6.0 | 4.0 | ECKAHT471KC | 5.0 | 0.60 | ECKNHT471KC | N0 | 5.0 | 0.60 |
| | 560 | ±10 | 7.0 | 4.0 | ECKAHT561KC | 5.0 | 0.60 | ECKNHT561KC | N0 | 5.0 | 0.60 |
| | 680 | ±10 | 7.0 | 4.0 | ECKAHT681KC | 5.0 | 0.60 | ECKNHT681KC | N0 | 5.0 | 0.60 |
| | 820 | ±10 | 7.0 | 4.0 | ECKAHT821KC | 5.0 | 0.60 | ECKNHT821KC | N0 | 5.0 | 0.60 |
| | 1000 | ±10 | 7.0 | 4.0 | ECKAHT102KC | 5.0 | 0.60 | ECKNHT102KC | N0 | 5.0 | 0.60 |
| | 1200 | ±10 | 8.5 | 4.0 | ECKAHT122KC | 5.0 | 0.60 | ECKNHT122KC | N0 | 5.0 | 0.60 |
| | 1500 | ±10 | 8.5 | 4.0 | ECKAHT152KC | 5.0 | 0.60 | ECKNHT152KC | N0 | 5.0 | 0.60 |
| | 1800 | ±10 | 10.0 | 4.0 | ECKAHT182KC | 5.0 | 0.60 | ECKNHT182KC | N0 | 5.0 | 0.60 |
| | 2200 | ±10 | 10.0 | 4.0 | ECKAHT222KC | 5.0 | 0.60 | ECKNHT222KC | N0 | 5.0 | 0.60 |
| | 2700 | ±10 | 11.0 | 4.0 | ECKAHT272KC | 5.0 | 0.60 | ECKNHT272KC | N0 | 5.0 | 0.60 |
| 3300 | ±10 | 13.0 | 4.0 | ECKAHT332KC | 7.5 | 0.65 | ECKNHT332KC | N1 | 7.5 | 0.65 | |
| 3900 | ±10 | 13.0 | 4.0 | ECKAHT392KC | 7.5 | 0.65 | ECKNHT392KC | N1 | 7.5 | 0.65 | |
| 4700 | ±10 | 14.0 | 4.0 | ECKAHT472KC | 7.5 | 0.65 | ECKNHT472KC | N1 | 7.5 | 0.65 | |

NEW

● Series KRP (Class 2, Temp. Char. R/Y5R, 1 to 3 kVDC)

| Rated Volt. | Cap. in pF | Cap. Tol. (%) | Dimensions in mm | | Kinked Lead Type (Bulk) | | | Kinked Lead Taping Type | | | |
|-------------|------------|---------------|------------------|--------------|-------------------------|------------------|--------------|-------------------------|------------|------------------|------|
| | | | D max. | T max. | Part Number | Dimensions in mm | | Part Number | Taped Type | Dimensions in mm | |
| | | | | | | F | d | | | F | d |
| 1 kVDC | 100 | ±10 | 6.0 | 4.5 | ECKA3A101KRP | 5.0 | 0.60 | ECKN3A101KRP | N0 | 5.0 | 0.60 |
| | 120 | ±10 | 6.0 | 4.5 | ECKA3A121KRP | 5.0 | 0.60 | ECKN3A121KRP | N0 | 5.0 | 0.60 |
| | 150 | ±10 | 6.0 | 4.5 | ECKA3A151KRP | 5.0 | 0.60 | ECKN3A151KRP | N0 | 5.0 | 0.60 |
| | 180 | ±10 | 6.0 | 4.5 | ECKA3A181KRP | 5.0 | 0.60 | ECKN3A181KRP | N0 | 5.0 | 0.60 |
| | 220 | ±10 | 6.0 | 4.5 | ECKA3A221KRP | 5.0 | 0.60 | ECKN3A221KRP | N0 | 5.0 | 0.60 |
| | 270 | ±10 | 6.0 | 4.5 | ECKA3A271KRP | 5.0 | 0.60 | ECKN3A271KRP | N0 | 5.0 | 0.60 |
| | 330 | ±10 | 6.0 | 4.5 | ECKA3A331KRP | 5.0 | 0.60 | ECKN3A331KRP | N0 | 5.0 | 0.60 |
| | 390 | ±10 | 7.0 | 4.5 | ECKA3A391KRP | 5.0 | 0.60 | ECKN3A391KRP | N0 | 5.0 | 0.60 |
| | 470 | ±10 | 7.0 | 4.5 | ECKA3A471KRP | 5.0 | 0.60 | ECKN3A471KRP | N0 | 5.0 | 0.60 |
| | 560 | ±10 | 7.0 | 4.5 | ECKA3A561KRP | 5.0 | 0.60 | ECKN3A561KRP | N0 | 5.0 | 0.60 |
| | 680 | ±10 | 7.5 | 4.5 | ECKA3A681KRP | 5.0 | 0.60 | ECKN3A681KRP | N0 | 5.0 | 0.60 |
| | 820 | ±10 | 7.5 | 4.5 | ECKA3A821KRP | 5.0 | 0.60 | ECKN3A821KRP | N0 | 5.0 | 0.60 |
| | 1000 | ±10 | 9.0 | 4.5 | ECKA3A102KRP | 5.0 | 0.60 | ECKN3A102KRP | N0 | 5.0 | 0.60 |
| | 1200 | ±10 | 9.0 | 4.5 | ECKA3A122KRP | 5.0 | 0.60 | ECKN3A122KRP | N0 | 5.0 | 0.60 |
| | 1500 | ±10 | 10.5 | 4.5 | ECKA3A152KRP | 5.0 | 0.60 | ECKN3A152KRP | N0 | 5.0 | 0.60 |
| | 1800 | ±10 | 10.5 | 4.5 | ECKA3A182KRP | 5.0 | 0.60 | ECKN3A182KRP | N0 | 5.0 | 0.60 |
| | 2200 | ±10 | 11.5 | 4.5 | ECKA3A222KRP | 5.0 | 0.60 | ECKN3A222KRP | N0 | 5.0 | 0.60 |
| | 2700 | ±10 | 13.0 | 4.5 | ECKA3A272KRP | 7.5 | 0.65 | ECKN3A272KRP | N1 | 7.5 | 0.65 |
| 3300 | ±10 | 13.0 | 4.5 | ECKA3A332KRP | 7.5 | 0.65 | ECKN3A332KRP | N1 | 7.5 | 0.65 | |
| 3900 | ±10 | 14.0 | 4.5 | ECKA3A392KRP | 7.5 | 0.65 | ECKN3A392KRP | N1 | 7.5 | 0.65 | |
| 4700 | ±10 | 16.5 | 4.5 | ECKA3A472KRP | 7.5 | 0.65 | ECKN3A472KRP | N1 | 7.5 | 0.65 | |

Rating and Characteristics

NEW

● Series KRP (Class 2, Temp. Char. R/Y5R, 1 to 3 kVDC) (Continuation)

| Rated Volt. | Cap. in pF | Cap. Tol. (%) | Dimensions in mm | | Kinked Lead Type (Bulk) | | | Kinked Lead Taping Type | | | |
|-------------|------------|---------------|------------------|--------------|-------------------------|------------------|------|-------------------------|------------|------------------|------|
| | | | D max. | T max. | Part Number | Dimensions in mm | | Part Number | Taped Type | Dimensions in mm | |
| | | | | | | F | d | | | F | d |
| 2 kVDC | 100 | ±10 | 7.0 | 5.0 | ECKA3D101KRP | 7.5 | 0.65 | ECKN3D101KRP | N1 | 7.5 | 0.65 |
| | 120 | ±10 | 7.0 | 5.0 | ECKA3D121KRP | 7.5 | 0.65 | ECKN3D121KRP | N1 | 7.5 | 0.65 |
| | 150 | ±10 | 7.0 | 5.0 | ECKA3D151KRP | 7.5 | 0.65 | ECKN3D151KRP | N1 | 7.5 | 0.65 |
| | 180 | ±10 | 7.0 | 5.0 | ECKA3D181KRP | 7.5 | 0.65 | ECKN3D181KRP | N1 | 7.5 | 0.65 |
| | 220 | ±10 | 7.0 | 5.0 | ECKA3D221KRP | 7.5 | 0.65 | ECKN3D221KRP | N1 | 7.5 | 0.65 |
| | 270 | ±10 | 7.0 | 5.0 | ECKA3D271KRP | 7.5 | 0.65 | ECKN3D271KRP | N1 | 7.5 | 0.65 |
| | 330 | ±10 | 7.5 | 5.0 | ECKA3D331KRP | 7.5 | 0.65 | ECKN3D331KRP | N1 | 7.5 | 0.65 |
| | 390 | ±10 | 7.5 | 5.0 | ECKA3D391KRP | 7.5 | 0.65 | ECKN3D391KRP | N1 | 7.5 | 0.65 |
| | 470 | ±10 | 9.0 | 5.0 | ECKA3D471KRP | 7.5 | 0.65 | ECKN3D471KRP | N1 | 7.5 | 0.65 |
| | 560 | ±10 | 9.0 | 5.0 | ECKA3D561KRP | 7.5 | 0.65 | ECKN3D561KRP | N1 | 7.5 | 0.65 |
| | 680 | ±10 | 10.0 | 5.0 | ECKA3D681KRP | 7.5 | 0.65 | ECKN3D681KRP | N1 | 7.5 | 0.65 |
| | 820 | ±10 | 10.0 | 5.0 | ECKA3D821KRP | 7.5 | 0.65 | ECKN3D821KRP | N1 | 7.5 | 0.65 |
| | 1000 | ±10 | 12.0 | 5.0 | ECKA3D102KRP | 7.5 | 0.65 | ECKN3D102KRP | N1 | 7.5 | 0.65 |
| | 1200 | ±10 | 12.0 | 5.0 | ECKA3D122KRP | 7.5 | 0.65 | ECKN3D122KRP | N1 | 7.5 | 0.65 |
| | 1500 | ±10 | 12.0 | 5.0 | ECKA3D152KRP | 7.5 | 0.65 | ECKN3D152KRP | N1 | 7.5 | 0.65 |
| | 1800 | ±10 | 14.0 | 5.0 | ECKA3D182KRP | 10.0 | 0.65 | — | — | — | — |
| | 2200 | ±10 | 16.0 | 5.0 | ECKA3D222KRP | 10.0 | 0.65 | — | — | — | — |
| | 2700 | ±10 | 16.0 | 5.0 | ECKA3D272KRP | 10.0 | 0.65 | — | — | — | — |
| 3300 | ±10 | 19.0 | 5.0 | ECKA3D332KRP | 10.0 | 0.65 | — | — | — | — | |
| 3900 | ±10 | 20.0 | 5.0 | ECKA3D392KRP | 10.0 | 0.65 | — | — | — | — | |
| 4700 | ±10 | 21.0 | 5.0 | ECKA3D472KRP | 10.0 | 0.65 | — | — | — | — | |
| 3 kVDC | 100 | ±10 | 7.5 | 5.5 | ECKA3F101KRP | 7.5 | 0.65 | ECKN3F101KRP | N1 | 7.5 | 0.65 |
| | 120 | ±10 | 7.5 | 5.5 | ECKA3F121KRP | 7.5 | 0.65 | ECKN3F121KRP | N1 | 7.5 | 0.65 |
| | 150 | ±10 | 7.5 | 5.5 | ECKA3F151KRP | 7.5 | 0.65 | ECKN3F151KRP | N1 | 7.5 | 0.65 |
| | 180 | ±10 | 7.5 | 5.5 | ECKA3F181KRP | 7.5 | 0.65 | ECKN3F181KRP | N1 | 7.5 | 0.65 |
| | 220 | ±10 | 8.0 | 5.5 | ECKA3F221KRP | 7.5 | 0.65 | ECKN3F221KRP | N1 | 7.5 | 0.65 |
| | 270 | ±10 | 8.0 | 5.5 | ECKA3F271KRP | 7.5 | 0.65 | ECKN3F271KRP | N1 | 7.5 | 0.65 |
| | 330 | ±10 | 8.5 | 5.5 | ECKA3F331KRP | 7.5 | 0.65 | ECKN3F331KRP | N1 | 7.5 | 0.65 |
| | 390 | ±10 | 9.5 | 5.5 | ECKA3F391KRP | 7.5 | 0.65 | ECKN3F391KRP | N1 | 7.5 | 0.65 |
| | 470 | ±10 | 9.5 | 5.5 | ECKA3F471KRP | 7.5 | 0.65 | ECKN3F471KRP | N1 | 7.5 | 0.65 |
| | 560 | ±10 | 10.5 | 5.5 | ECKA3F561KRP | 7.5 | 0.65 | ECKN3F561KRP | N1 | 7.5 | 0.65 |
| | 680 | ±10 | 10.5 | 5.5 | ECKA3F681KRP | 7.5 | 0.65 | ECKN3F681KRP | N1 | 7.5 | 0.65 |
| | 820 | ±10 | 12.5 | 5.5 | ECKA3F821KRP | 7.5 | 0.65 | ECKN3F821KRP | N1 | 7.5 | 0.65 |
| | 1000 | ±10 | 12.5 | 5.5 | ECKA3F102KRP | 10.0 | 0.65 | — | — | — | — |
| | 1200 | ±10 | 14.5 | 5.5 | ECKA3F122KRP | 10.0 | 0.65 | — | — | — | — |
| | 1500 | ±10 | 14.5 | 5.5 | ECKA3F152KRP | 10.0 | 0.65 | — | — | — | — |
| 1800 | ±10 | 16.5 | 5.5 | ECKA3F182KRP | 10.0 | 0.65 | — | — | — | — | |
| 2200 | ±10 | 17.0 | 5.5 | ECKA3F222KRP | 10.0 | 0.65 | — | — | — | — | |

Note: Lead spacing (Dim. F) of 5.0 mm is available for rated voltage 2 kVDC and 3 kVDC capacitors that are 10.5 mm or less in the body diameter (Dim. D) on special order.

Typical Temperature Characteristics

Series KGE (Char. SL/GP)

(Temp. Coeff. : +350 to -1000 ppm/°C)

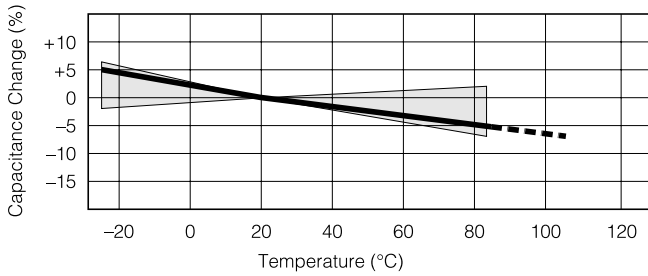

Series HT-KB, KBP (Char. B/Y5P)

(Temp. Range : -25 to 85 °C)
(max. Cap. Change : ±10 %)

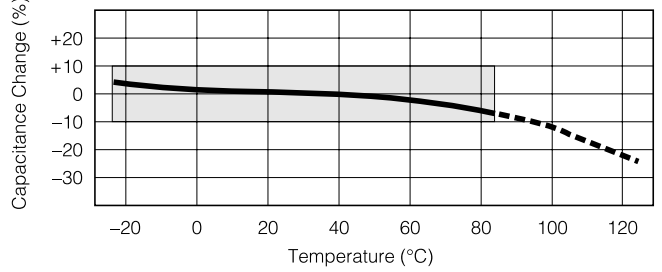

Series HT-KC (Char. C/Y5S)

(Temp. Range : -25 to 85 °C)
(max. Cap. Change : ±20 %)

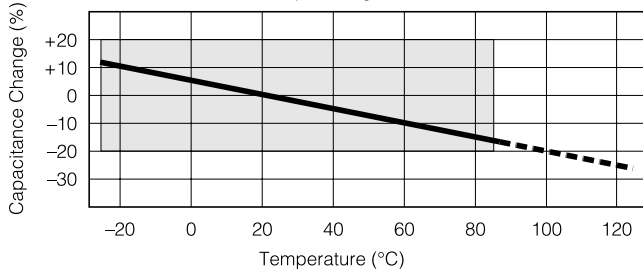

Series KRP (Char. R/Y5R)

(Temp. Range : -25 to 85 °C)
(max. Cap. Change : ±15 %)

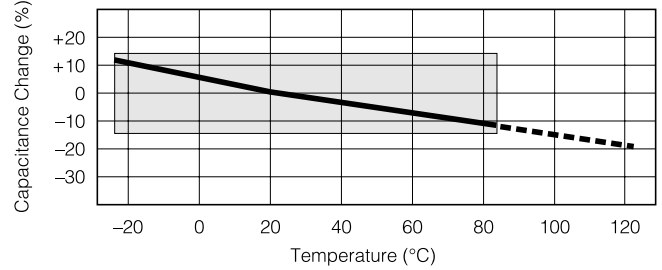

Characteristics of Voltage-Frequency

Series HT-KB 500 VDC

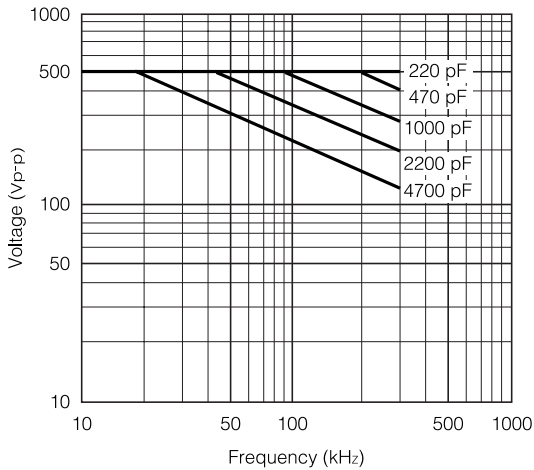

Series HT-KC 500 VDC

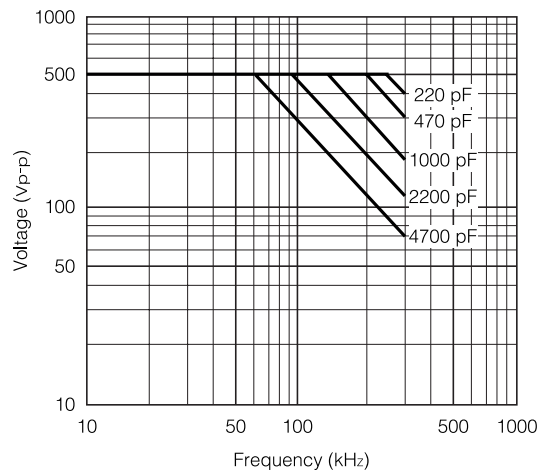

Above-mentioned graph shows the maximum permission voltage when using a capacitor at the AC sine wave voltage. As for this voltage, when measuring in room temperature (25 °C), the capacitor self generation of heat shows the voltage which becomes a maximum of 20 °C.

When using at the pulse voltage or AC voltage except the sine wave, Use on confirming that the capacitor self generation of heat temperature is less than 20 °C in room temperature (ambient temperature is 25 °C)

The self generation of heat temperature (the difference between the surface temperature and the ambient temperature of capacitor) changes according to ambient temperature.

As for the permission self generation of heat temperature when the ambient temperature is more than 25 °C, refer to the figure of the next page.

■ Characteristics of Voltage – Frequency (Continuation)

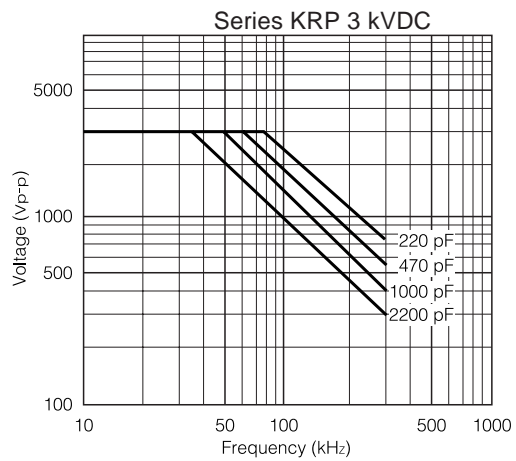
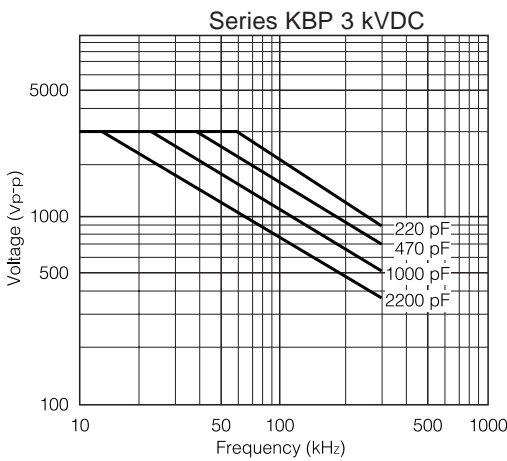
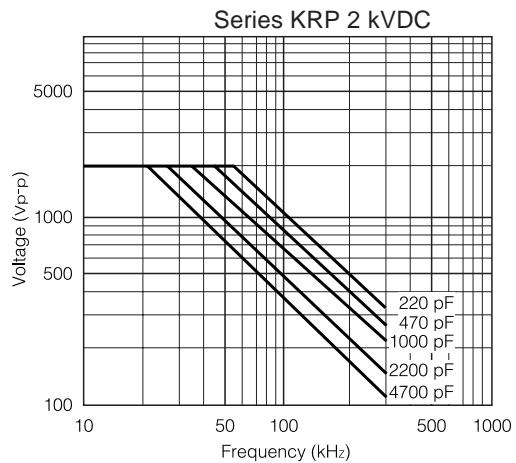
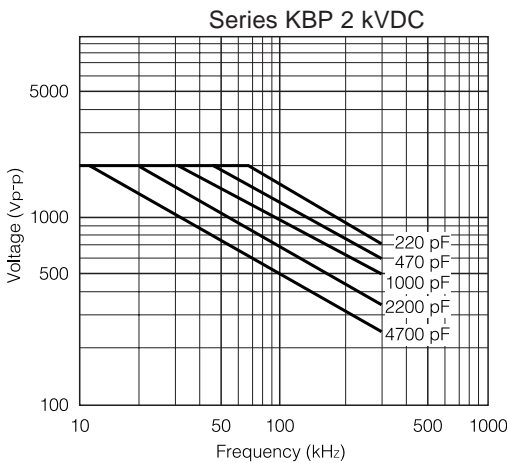
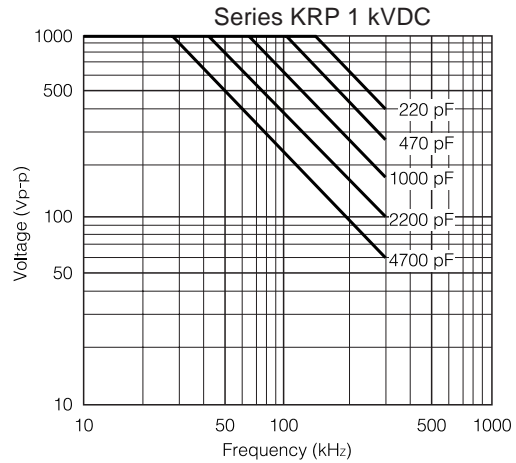
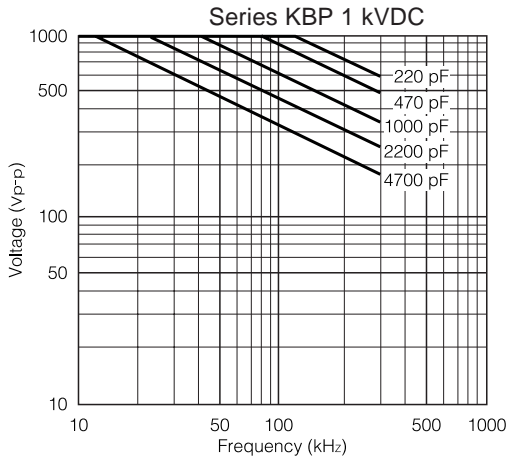

Above-mentioned graph shows the maximum permission Voltage when using a capacitor at the AC sine wave voltage.

As for this voltage, when measuring in room temperature (25 °C), the capacitor self generation of heat shows the voltage which becomes a maximum of 20 °C.

When using at the pulse voltage or AC voltage except the sine wave, Use on confirming that the capacitor self generation of heat temperature is less than 20 °C in room temperature (ambient temperature is 25 °C) The self generation of heat temperature (the difference between the surface temperature and the ambient temperature of capacitor) changes according to ambient temperature.

As for the permission self generation of heat temperature when the ambient temperature is more than 25 °C, refer to the right figure.

Permission self generation of heat temperature vs. ambient temperature

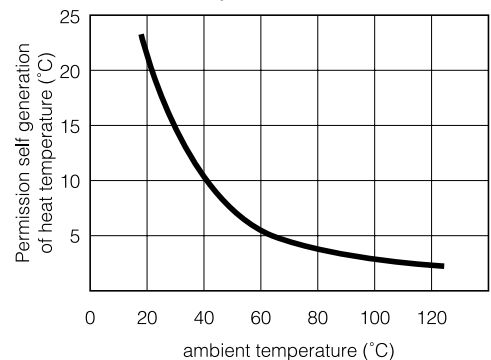

X-ON Electronics

Largest Supplier of Electrical and Electronic Components

Click to view similar products for [Ceramic Disc Capacitors](#) category:

Click to view products by [Panasonic](#) manufacturer:

Other Similar products are found below :

[009377XM](#) [5AS560JCFCA](#) [5AU100JCECA](#) [5AU470JCJCA](#) [DEF2CLH020CA3B](#) [HSE102MAQBF0KR](#) [432202101621](#) [432202282431](#)
[DEF2CLH030CJ3B](#) [W1X223MCVCF0KR](#) [564RC0GBA302EJ470K](#) [5AS270JCDCA](#) [5AS330JCDCA](#) [5AU330JCGCA](#)
[DE1E3KX222MJ4BN01F](#) [440LT68AP-R](#) [JN222MQ47FAAAAKPLP](#) [H8000090-245](#) [H8000090-225RY](#) [H8000090-309RY](#) [H8000090-](#)
[291RY](#) [F471K39S3NR63K7R](#) [DEF2CLH040CN3A](#) [DEF2CLH080DA3B](#) [564R3DF0T22](#) [CC2150KY5P1KVB5LS-LF](#)
[CC2180KY5P1KVB5LS-LF](#) [CC2470KY5P1KVB5LS-LF](#) [CC2820KY5P1KVB5LS-LF](#) [0838-040-X7R0-220K](#) [JN102MQ35FAAAAKPLP](#)
[0841-040-X5U0-103M](#) [CCH-6K8-5/1000V](#) [140-50N2-101J-TB-RC](#) [ECK-DGL102ME](#) [562R5GAD47RR](#) [S103K75Y5PN8BT0R](#)
[615R100GAD10](#) [615R150GAD10](#) [NCD100K1KVSLF](#) [NCD682M1KVZ5UF](#) [CCK-100N](#) [CCK-100P](#) [CCK-22N](#) [CCK-2N2](#) [CCK-47N](#) [CCK-](#)
[47P](#) [CCK-4N7](#) [CCK-4P7](#) [CK45-B3FD681KYNNA](#)