

6871-0C / AC

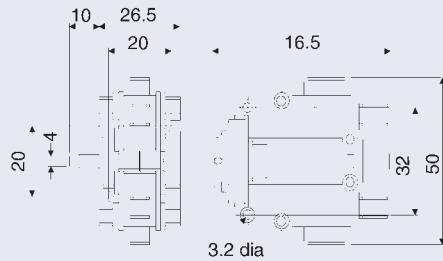

6872-00 / 0C / A0 / AC

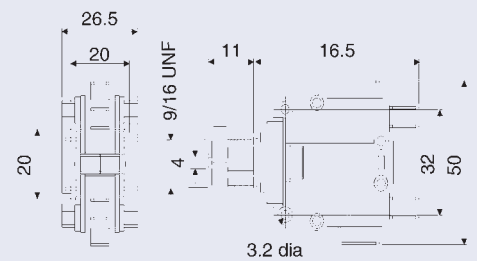

6872-H0 / HC

**Benefits**

- ❖ UL approved compact and economical switches
- ❖ Ideal for OEM applications

- ❖ Base or side entry
- ❖ Choice of alternate and momentary actions available

Model No	6871-0C	6871-AC	6872-0C	6872-AC	6872-HC
Switch Details Number of Poles & Action	1 pole C/O momentary	1 pole C/O alternate	2 pole C/O momentary	2 pole C/O alternate	2 pole C/O 1 pole momentary 1 pole alternate
Air Connection	Back entry	Back entry	Back entry	Back entry	Back entry
Air Spout Diameter	4mm	4mm	4mm	4mm	4mm
Connecting Tube Part Number	2311-08	2311-08	2311-08	2311-08	2311-08
Alternative Air Connection Model Number	Back entry 2mm spout 6871-0K side entry 4mm spout 6871-01	Back entry 2mm spout 6871-AK side entry 4mm spout 6871-AO	Back entry 2mm spout 6872-0K side entry 4mm spout 6872-00	Back entry 2mm spout 6872-AK side entry 4mm spout 6872-A0	Back entry 2mm spout 6872-HK side entry 4mm spout 6872-HO
Body Material	Acetal	Acetal	Acetal	Acetal	Acetal
Diaphragm Material	Silicone	Silicone	Silicone	Silicone	Silicone
Electrical rating @ 250V ac	16A Res 4A Ind 1/2 HP	16A Res 4A Ind 1/2 HP	21A (8A) 250V 2HP 250V ac 1HP 125V ac	21A (8A) 250V 2HP 250V ac 1HP 125V ac	21A (8A) 250V 2HP 250V ac 1HP 125V ac
Special Approvals Upon request	UL CSA	UL CSA	UL CSA	UL CSA	UL CSA

All European electrical switch approvals apply.

- ❖ 6872 Variants can be obtained with double diaphragm upon request.

## **X-ON Electronics**

Largest Supplier of Electrical and Electronic Components

*Click to view similar products for [herga manufacturer](#):*

Other Similar products are found below :

[6433-0019](#) [6289-PP](#) [6254-OB](#) [6442-OW](#) [6438-ACAC-AB00](#) [6227-0004](#) [6289-01](#) [6251-BAAA-CBZ0](#) [6226-0003](#) [6438-ABAB-AB00](#) [6289-CC](#) [6753-AEJA-A000](#) [6448-AAAB-0000](#) [6871-0C](#)