

FEATURES

Relative Clamping Force*	
Relative Retention Force*	
Relative Thermal Resistance*	-
Relative Price	

*For mechanical and thermal performance data see the Technical Applications section pages 77-94



Series 24 Lok-Tainer

DSCC 84168

MATERIAL

HOUSING

.025 (.64mm) thick
Beryllium Copper or
.024 (.61mm) thick Cold
Rolled Steel

CAM

Beryllium Copper

LEVER

Steel
Note: Beryllium Copper lever
furnished when housing is
unplated

**MODERATE SHOCK & VIBRATION APPLICATIONS
LOW HEAT DISSIPATION**

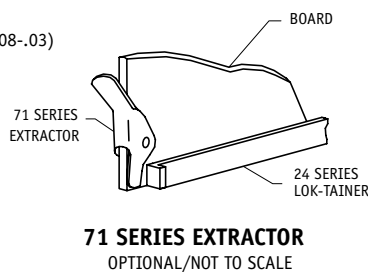
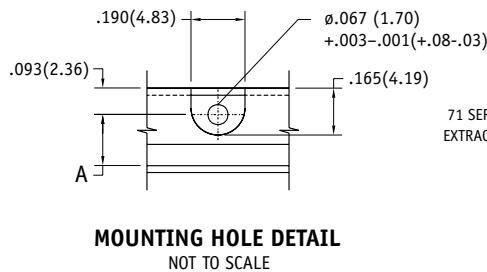
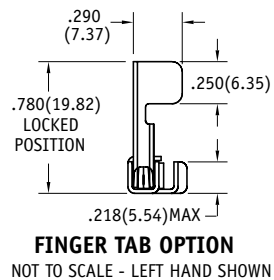
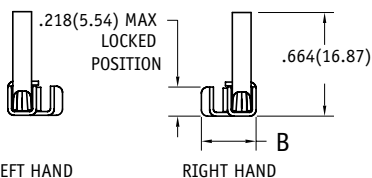
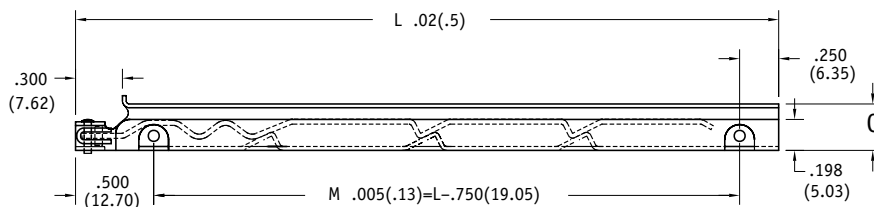
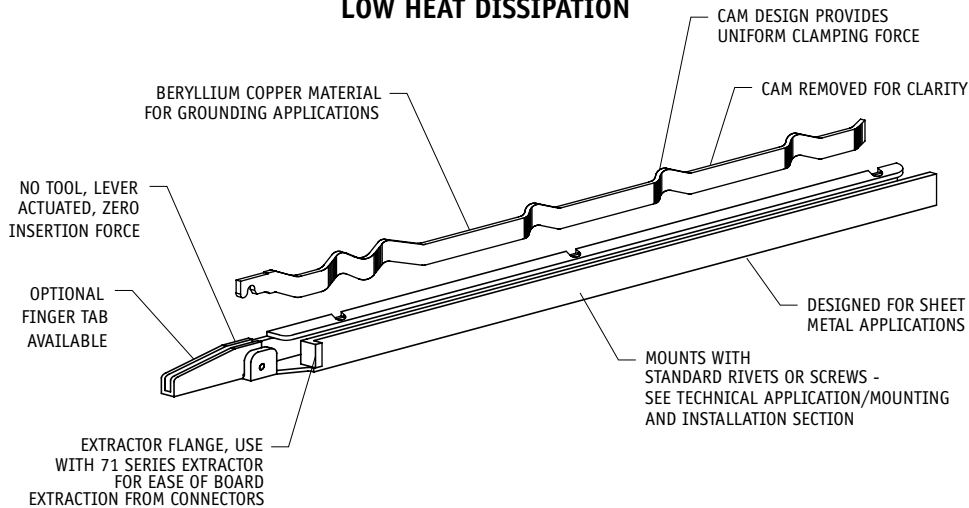

NOTE ON DIMENSIONS:
ENGLISH LISTED FIRST
FOLLOWED BY METRIC
IN PARENTHESES

TOLERANCES:
UNLESS OTHERWISE SPECIFIED
.XXX(.XX)=.01(.25)
.XX (.X) =.02(.5)

MOUNTING HOLE DIMENSIONS 24 SERIES

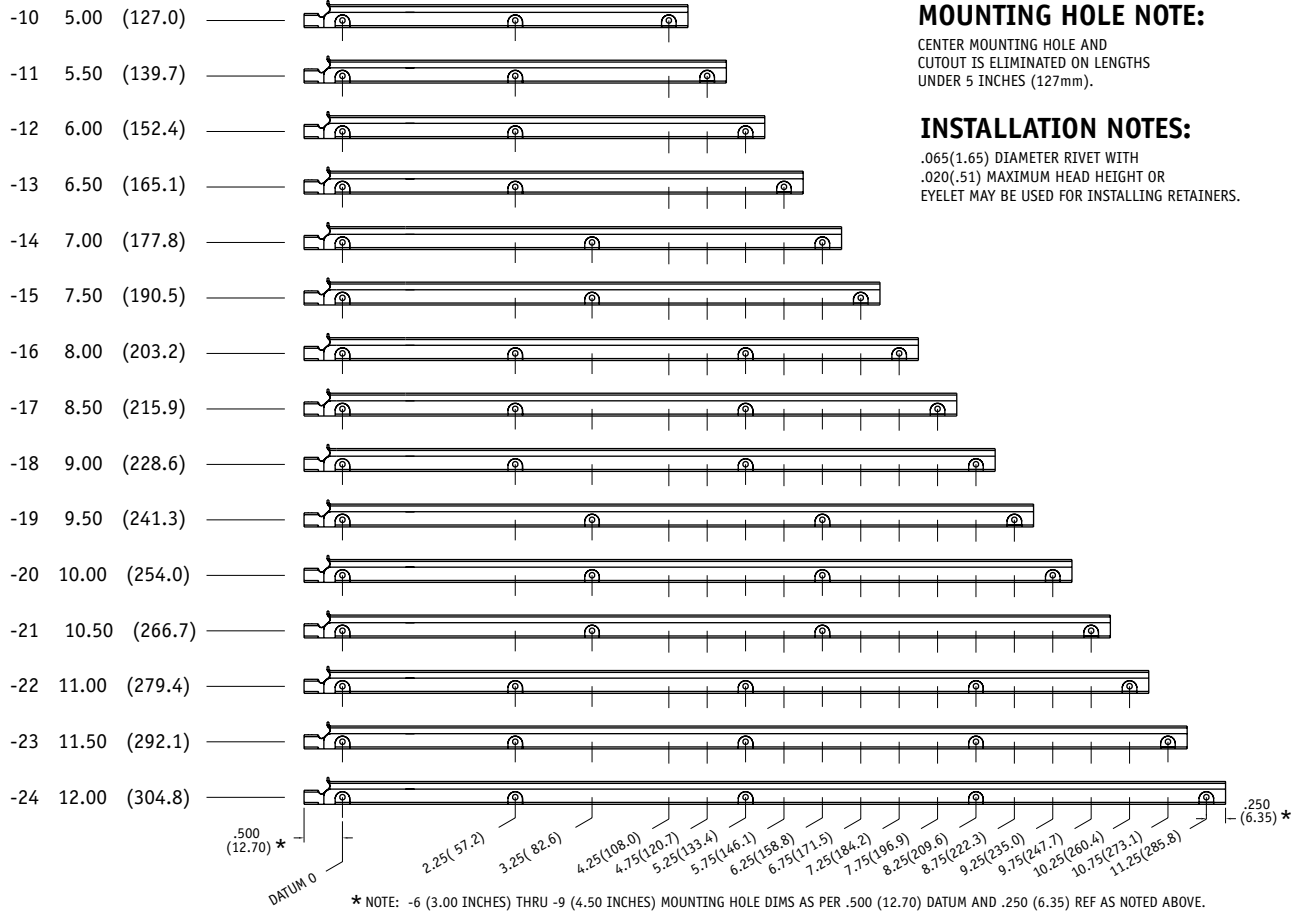

Part Number Code
Series 24 Lok-Tainer Lever Actuated

Finger Tab
Finger tab _____ T
None _____ [Blank]

Housing Material
Select from Materials Table ③ _____

Extractor Flange
(Standard) _____ X
None _____ [Blank]

Board Thickness
Select dash number from Board Thickness Table ② _____

Length
In 1/2" increments _____ -6 (3") thru -24 (12")
In 12.7mm increments _____ -6 (76.2mm) thru -24 (304.8mm)

Finish
Select dash number from Finish Table ① _____

Lever Action
Left hand _____ L
Right hand _____ R

Part Number Code example: 24BX-3-10-6-L

Series 24 Lever-actuated Lok-Tainer, Beryllium Copper housing with flange, .094(2.39) board thickness, 5 in(127.2mm) long, Nickel plate finish and left hand lever action

① FINISH TABLE

CONTACT FACTORY FOR OTHER FINISHES

DASH #	FINISH (see pg.9 for RoHS Compliance)
NONE	SILVER PLATE PER QQ-S-365, TYPE III, GRADE A
-1	NONE
-2	EBANOLPER MIL-F-495 FOR BERYLLIUM COPPER PER MIL-C-13924 FOR STEEL
-4	COPPER PLATE PER MIL-C-14550, CLASS 2
-5	GOLD PLATE PER MIL-G-45204, TYPE 1, CLASS 1
-6	NICKEL PLATE PER QQ-N-290, CLASS 1, GRADE G, BRIGHT
-7	ZINC PLATE CLEAR CHROMATE, PER ASTM-B-633, Fe/Zn 8
-8	ZINC PLATE YELLOW CHROMATE, PER ASTM-B-633 Fe/Zn 8

NOTE: No finish (-1) not available with "S" Steel material

② BOARD THICKNESS TABLE

DASH #	THICKNESS			
	-.000 +.005	A	B	C
-1	.031(0.79)	.180(4.58)	.350(8.89)	.297(7.55)
-2	.063(1.60)	.180(4.58)	.350(8.89)	.297(7.55)
-3	.094(2.39)	.210(5.34)	.380(9.66)	.327(8.31)

③ MATERIALS TABLE

CODE LETTER	MATERIAL	WEIGHT
B	BERYLLIUM COPPER, 1/4H PER, ASTM-B-194	.087 oz/in (1.97 gm/cm)
S	STEEL PER, ASTM-A-366	EITHER MATERIAL

**FOR MECHANICAL AND THERMAL PERFORMANCE
SEE THE TECHNICAL APPLICATIONS SECTION PAGES 77-94**

X-ON Electronics

Largest Supplier of Electrical and Electronic Components

Click to view similar products for [Birtcher](#) manufacturer:

Other Similar products are found below :

[24SX-3-11-3-R](#) [127B-2-10-3-R](#) [340L-100S-12C](#) [340R-100S-10C](#) [CCK-KIT-ZD](#) [24BX-2-10-3-L](#) [24BX-2-10-3-R](#) [35-1B-2-6-3](#) [24SX-3-16-6-L](#) [24SX-3-16-6-R](#) [340L-100S-08C](#) [71-3-L](#) [40-5-10-LF-LN](#) [40-8-LF](#)