

### Technical Data:

- through-hole or SMD
- 50mA/24VDC
- single pole/momentary
- 10.000.000 operations life time
- IP67 sealing
- temperature range:  
low temp: -40/+115°C  
high temp: -40/+160°C

### Dimensions 1ZB (through-hole)

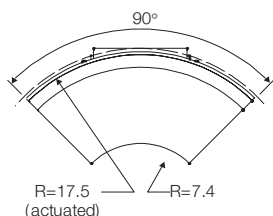
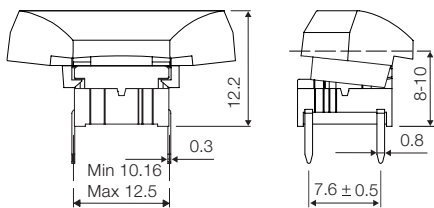

### PCB layout

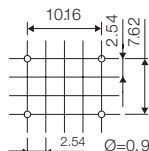

### Dimensions 1ZC (through-hole)

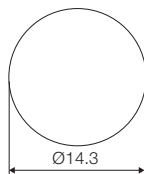
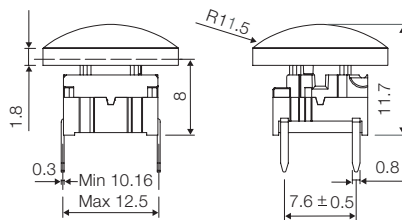

### PCB layout (top view)

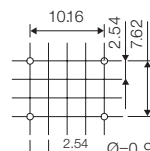

### Dimensions 1ZA (SMD)

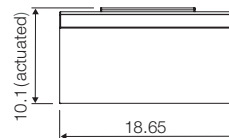
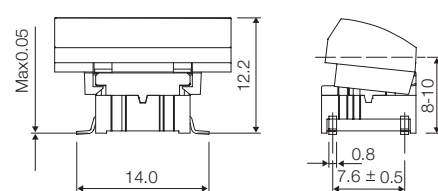

### PCB layout

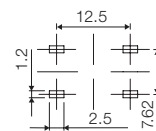

### HOW TO ORDER



### Switch

### Mounting

**T** through-hole  
**S** surface mount

**L 6** low temp.  
**H 9** high temp.

### Cap 1ZA

- 03** grey
- 06** white
- 09** black
- 30** ultra blue
- 40** dusty blue
- 42** aqua blue
- 50** metal dark blue
- 53** metal light grey
- 57** metal dark grey
- 58** metal bordeaux

### Cap 1ZB



### Switch

### Mounting

**T** through-hole  
**S** surface mount

**L 6** low temp.  
**H 9** high temp.

### Cap 1ZC

- 03** grey
- 06** white
- 09** black
- 30** ultra blue
- 40** dusty blue
- 42** aqua blue
- 50** metal dark blue
- 53** metal light grey
- 57** metal dark grey
- 58** metal bordeaux

### Standard versions:

3ATL6, 3ATH9, 3ASH9, 3ASH9R (tape/reel)  
3FTL6, 3FTH9, 3FSH9, 3FSH9R (tape/reel)

Dimensions (mm): Unless otherwise specified, all tolerances ± 0.2

**Ordering example:** 3ATL6 + 1ZA58, 3FTL6 + 1ZC53

### Design example

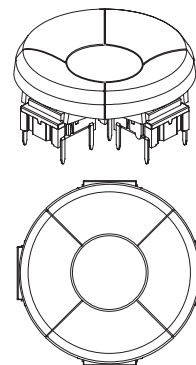

Consisting of: 4x3ATL6 + 4x1ZB + 1x3FTL6 + 1x3FTL6 (3F in centre position)

### Recommended panel cut-out:

ø = 35,0 - 35,5 Depending on application

### PCB layout

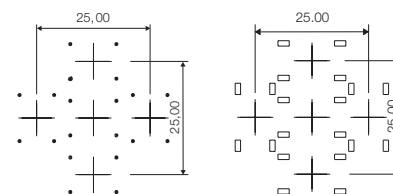

## X-ON Electronics

Largest Supplier of Electrical and Electronic Components

*Click to view similar products for [mec switches](#) manufacturer:*

Other Similar products are found below :

[95NA3509](#) [1R001](#) [1B00](#) [1630004](#) [1D27F1500](#) [1SS06-08.0](#) [1A02](#) [4FTH901](#) [2SS09-07.0](#) [1ZCS53](#) [025773H](#) [5GTH9208222](#) [1DS11](#)  
[5GSH96501](#) [1TS03](#) [1US00](#) [1692108](#) [5GTH96561](#) [2A03](#) [MSFC-10KEX](#) [099196G](#) [429981B](#) [1ZW09](#) [1IS16-12.0](#) [10C1616LMH11809](#)  
[1ZB09](#) [1Z09](#) [1ZCS30](#) [1630008](#) [1670003](#) [1SS02-09.5](#) [5GSH92022](#) [5GSH96522](#) [1SS06-12.0](#) [1US03](#) [1Q001](#) [5GTH9202242](#) [1D30](#) [1D04](#)  
[AQN-2.5](#) [1A09XU134](#) [5GSH920Q](#) [1632609](#) [XO-08-7.37280MHZ](#) [099349E](#) [4FSH961](#) [2D032](#) [1630000](#) [1ZB57](#) [15452](#)