

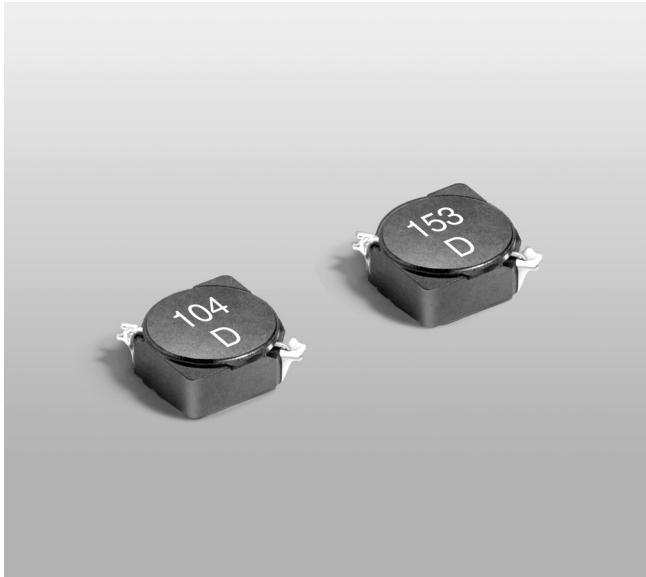

# Shielded Power Inductors – MSS7331



- 7.0 × 7.0 mm footprint; 3.1 mm high shielded inductors
- Low DCR and excellent current handling

**Core material** Ferrite

**Core and winding loss** See [www.coilcraft.com/coreloss](http://www.coilcraft.com/coreloss)

**Terminations** RoHS compliant matte tin over nickel over phos bronze. Other terminations available at additional cost.

**Weight** 0.48 – 0.51 g

**Ambient temperature** –40°C to +85°C with (40°C rise) Irms current.

**Maximum part temperature** +125°C (ambient + temp rise). [Derating](#).

**Storage temperature** Component: –40°C to +125°C.

Tape and reel packaging: –40°C to +80°C

**Resistance to soldering heat** Max three 40 second reflows at +260°C, parts cooled to room temperature between cycles

**Moisture Sensitivity Level (MSL)** 1 (unlimited floor life at <30°C / 85% relative humidity)

**Failures in Time (FIT) / Mean Time Between Failures (MTBF)**

38 per billion hours / 26,315,789 hours, calculated per Telcordia SR-332

**Packaging** 350/7" reel, 1500/13" reel; Plastic tape: 16 mm wide, 0.35 mm thick, 12 mm pocket spacing, 3.7 mm pocket depth

**PCB washing** Tested to MIL-STD-202 Method 215 plus an additional aqueous wash. See [Doc787\\_PCB\\_Washing.pdf](#).

| Part number <sup>1</sup> | Inductance <sup>2</sup><br>(µH) | DCR<br>(Ohms) |       | SRF<br>typ <sup>3</sup><br>(MHz) | Isat (A) <sup>4</sup> |             |             | Irms (A) <sup>5</sup> |              |
|--------------------------|---------------------------------|---------------|-------|----------------------------------|-----------------------|-------------|-------------|-----------------------|--------------|
|                          |                                 | typ           | max   |                                  | 10%<br>drop           | 20%<br>drop | 30%<br>drop | 20°C<br>rise          | 40°C<br>rise |
| MSS7331-152NL_           | 1.5 ±30%                        | 0.009         | 0.012 | 80.0                             | 3.5                   | 4.4         | 5.1         | 4.8                   | 6.9          |
| MSS7331-302NL_           | 3.0 ±30%                        | 0.014         | 0.020 | 55.0                             | 2.3                   | 3.0         | 3.5         | 4.2                   | 6.0          |
| MSS7331-392NL_           | 3.9 ±30%                        | 0.017         | 0.023 | 45.0                             | 2.2                   | 2.8         | 3.2         | 4.1                   | 5.7          |
| MSS7331-502ML_           | 5.0 ±20%                        | 0.022         | 0.030 | 40.0                             | 2.0                   | 2.4         | 2.8         | 3.3                   | 4.5          |
| MSS7331-602ML_           | 6.0 ±20%                        | 0.025         | 0.033 | 38.0                             | 1.8                   | 2.2         | 2.6         | 3.4                   | 4.6          |
| MSS7331-732ML_           | 7.3 ±20%                        | 0.035         | 0.045 | 35.0                             | 1.8                   | 2.2         | 2.5         | 2.8                   | 3.8          |
| MSS7331-862ML_           | 8.6 ±20%                        | 0.038         | 0.048 | 33.5                             | 1.6                   | 2.0         | 2.2         | 2.5                   | 3.4          |
| MSS7331-103ML_           | 10 ±20%                         | 0.046         | 0.052 | 30.0                             | 1.4                   | 1.7         | 1.9         | 2.4                   | 3.2          |
| MSS7331-123ML_           | 12 ±20%                         | 0.058         | 0.066 | 26.0                             | 1.3                   | 1.6         | 1.7         | 2.1                   | 2.8          |
| MSS7331-153ML_           | 15 ±20%                         | 0.067         | 0.075 | 24.0                             | 1.2                   | 1.4         | 1.6         | 2.0                   | 2.7          |
| MSS7331-183ML_           | 18 ±20%                         | 0.071         | 0.088 | 22.0                             | 1.1                   | 1.3         | 1.4         | 1.9                   | 2.6          |
| MSS7331-223ML_           | 22 ±20%                         | 0.095         | 0.113 | 21.0                             | 0.98                  | 1.2         | 1.3         | 1.6                   | 2.2          |
| MSS7331-273ML_           | 27 ±20%                         | 0.105         | 0.132 | 17.0                             | 0.89                  | 1.1         | 1.2         | 1.5                   | 2.0          |
| MSS7331-333ML_           | 33 ±20%                         | 0.123         | 0.150 | 16.0                             | 0.80                  | 0.97        | 1.1         | 1.4                   | 1.9          |
| MSS7331-393ML_           | 39 ±20%                         | 0.161         | 0.180 | 14.5                             | 0.70                  | 0.86        | 0.96        | 1.2                   | 1.6          |
| MSS7331-473ML_           | 47 ±20%                         | 0.180         | 0.215 | 12.5                             | 0.67                  | 0.80        | 0.89        | 1.2                   | 1.6          |
| MSS7331-563ML_           | 56 ±20%                         | 0.240         | 0.270 | 11.5                             | 0.61                  | 0.72        | 0.80        | 1.0                   | 1.4          |
| MSS7331-683ML_           | 68 ±20%                         | 0.273         | 0.300 | 10.5                             | 0.55                  | 0.66        | 0.74        | 0.92                  | 1.2          |
| MSS7331-823ML_           | 82 ±20%                         | 0.304         | 0.370 | 9.5                              | 0.52                  | 0.60        | 0.67        | 0.84                  | 1.2          |
| MSS7331-104ML_           | 100 ±20%                        | 0.419         | 0.495 | 8.5                              | 0.45                  | 0.54        | 0.61        | 0.79                  | 1.1          |

1. Please specify **termination** and **packaging** codes:

**MSS7331-104MLC**

**Termination:** L = RoHS compliant gold over nickel over phos bronze

**Special order:**

**T** = RoHS tin-silver-copper (95.5/4/0.5) over tin over nickel over phos bronze or  
**S** = non-RoHS tin-lead (63/37) over tin over nickel over phos bronze.

**Packaging:** C = 7" machine-ready reel EIA-481 embossed plastic tape (350 per full reel).

**B** = Less than full reel In tape, but not machine-ready. To have a leader and trailer added (\$25 charge), use code letter C instead.

**D** = 13" machine-ready reel EIA-481 embossed plastic tape. Factory order only, not stocked (1500 per reel per full reel).

2. Inductance tested at 100 kHz, 0.1 Vrms, 0 Adc using an Agilent/HP 4284A LCR meter or equivalent.
3. For SRF >13 MHz, SRF measured using an Agilent/HP 8753D network Analyzer or equivalent. For SRF <13 MHz, SRF measured using an Agilent/HP 4192A or equivalent.
4. DC current at 25°C that causes the specified inductance drop from its value without current. [Click for temperature derating information.](#)
5. Current that causes the specified temperature rise from 25°C ambient. This information is for reference only and does not represent absolute maximum ratings. [Click for temperature derating information.](#)
6. Electrical specifications at 25°C. Refer to Doc 362 "Soldering Surface Mount Components" before soldering.



[www.coilcraft.com](http://www.coilcraft.com)

**US** +1-847-639-6400 [sales@coilcraft.com](mailto:sales@coilcraft.com)

**UK** +44-1236-730595 [sales@coilcraft-europe.com](mailto:sales@coilcraft-europe.com)

**Taiwan** +886-2-2264 3646 [sales@coilcraft.com.tw](mailto:sales@coilcraft.com.tw)

**China** +86-21-6218 8074 [sales@coilcraft.com.cn](mailto:sales@coilcraft.com.cn)

**Singapore** + 65-6484 8412 [sales@coilcraft.com.sg](mailto:sales@coilcraft.com.sg)

Document 1097-1 Revised 09/02/15

© Coilcraft Inc. 2015

This product may not be used in medical or high risk applications without prior Coilcraft approval. Specification subject to change without notice. Please check web site for latest information.



# Shielded Power Inductors – MSS7331

## Typical L vs Current

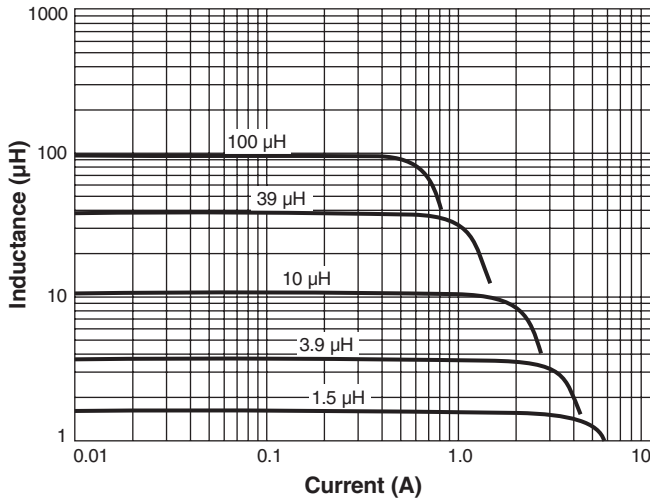

## Typical L vs Frequency

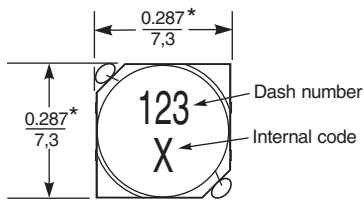
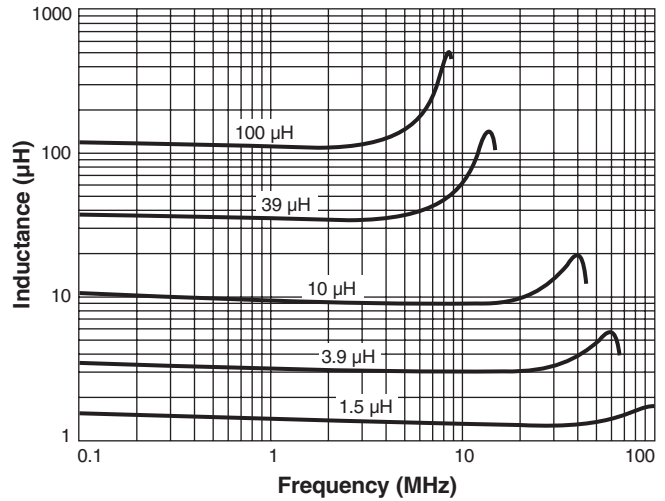

\* Dimensions are of the case not including the termination. For maximum overall dimensions including the termination, add 0.02 in / 0,51 mm.

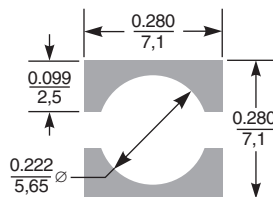
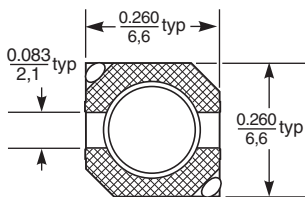
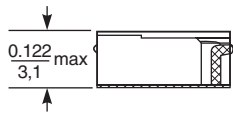

**Recommended Land Pattern**

Dimensions are in  $\frac{\text{inches}}{\text{mm}}$



**US** +1-847-639-6400 sales@coilcraft.com  
**UK** +44-1236-730595 sales@coilcraft-europe.com  
**Taiwan** +886-2-2264 3646 sales@coilcraft.com.tw  
**China** +86-21-6218 8074 sales@coilcraft.com.cn  
**Singapore** + 65-6484 8412 sales@coilcraft.com.sg

Document 1097-2 Revised 09/02/15  
 © Coilcraft Inc. 2015  
 This product may not be used in medical or high risk applications without prior Coilcraft approval. Specification subject to change without notice. Please check web site for latest information.

## X-ON Electronics

Largest Supplier of Electrical and Electronic Components

*Click to view similar products for [Coilcraft](#) manufacturer:*

Other Similar products are found below :

[D05022P-332](#) [RFC1010B-334KE](#) [1008CS-151XJLB](#) [MSS1246-334KLC](#) [SER2915L-223KL](#) [C354](#) [C404](#) [Q4438-BL](#) [C324A-2](#) [C403A-2](#)  
[D01608C-104](#) [D03316P-103](#) [RFB0810-561L](#) [RFB1010-150L](#) [MSS7331-683MLB](#) [MSS1210-825KEB](#) [BU9-103R25BL](#) [BU9S-7020R3BL](#)  
[MA5237-ELD](#) [0603LS-223XJLB](#) [1812LS-273XJLC](#) [AGP2923-332KL](#) [MSS1048-822NLC](#) [BU9H-103R25BL](#) [C406B-2](#) [C300-2](#) [Q4437-BL](#)  
[Q4436-BL](#) [D03308P-104](#) [1812CS-472XK](#) [DS5022P-683](#) [DT3316P-224](#) [RFS1317-334KE](#) [PL300-100L](#) [AGP4233-103ME](#) [AGP2923-472KL](#)  
[MSS1210-225KED](#) [1008LS-273XJLB](#) [MSS1038-824KLC](#) [DO5010H-154MLD](#) [C406A-2](#) [C393](#) [D03316P-331](#) [RFC1010B-106KE](#)  
[RFC0810B-106KE](#) [PCV-0-103-03L](#) [GA3544-BL](#) [HA4061-AL](#) [7M3-681](#) [1812LS-473XJ](#)