

Plug-in sockets and accessories

DZM80

For DM84, DM85, DM87L, DM87P

Screw terminals
1.37 in (35 mm) DIN
snap on rail mounting,
or direct panel mounting
3.07 in (78.1) x 0.63 (15.9)
x 2.4 in (61) [2.64 in (67)]
Double pole
0.2 in (5 mm) pin layout
12 A, 300 V

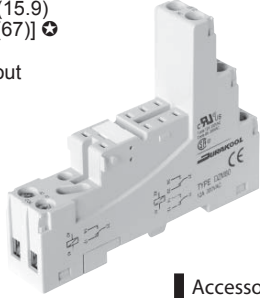

Connection diagrams

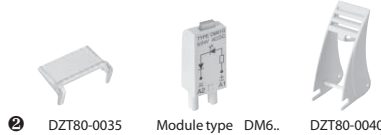
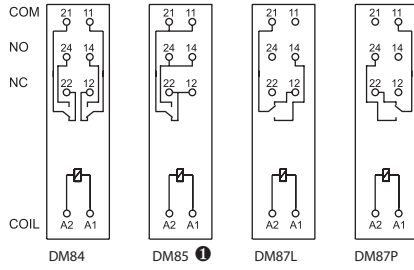

Dimensions

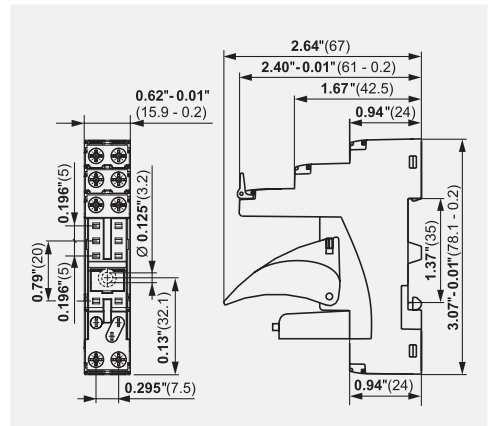

DZM92

For DM87N, DM87N sensitive

Screw terminals
1.37 in (35 mm) DIN
snap on rail mounting,
or direct panel mounting
3.07 in (78.1) x 0.63 (15.9)
x 2.4 in (61) [2.64 in (67)]
Single pole
0.138 in (3.5 mm) pin layout
12 A, 300 V

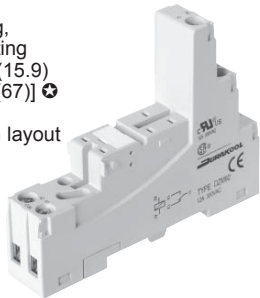

Connection diagram

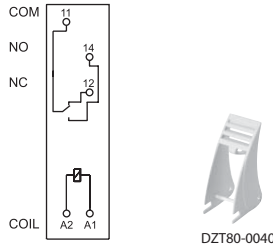

Dimensions

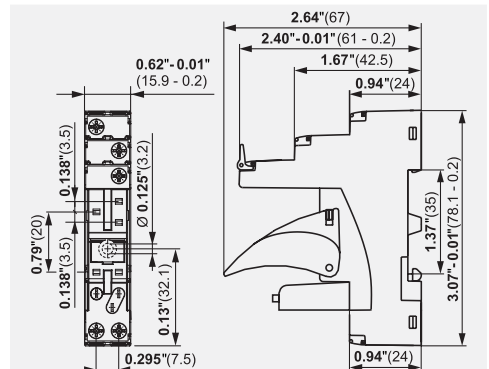

DZM2

For D2

Screw terminals
1.37 in (35 mm) DIN
snap on rail mounting,
or direct panel mounting
2.95 in (75) x 1.06 (27)
x 2.4 in (61) [3.23 in (82)]
Double pole
12 A, 300 V

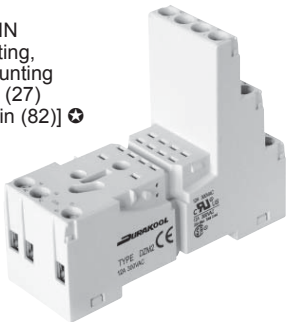

Connection diagram

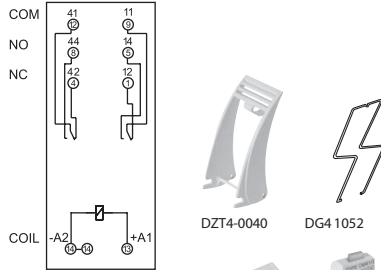

Dimensions

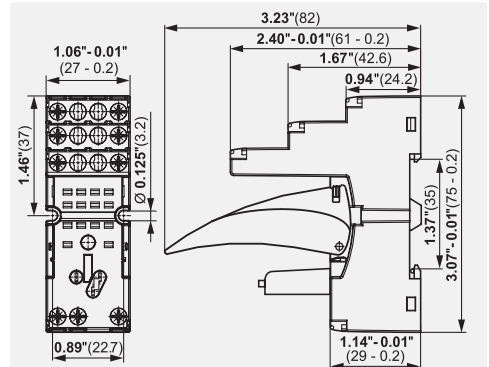

- ① For DM85: loads up to 12 A do not require bridging of common terminals. Loads above 12 A require bridging pairs of terminals: 11 with 21, 12 with 22, 14 with 24 [clamp bridge Cu wire minimum 14 AWG (1.5 mm²)].
- ② Signalling / protection modules type DM6...



For plug-in sockets type:
DZM80, DZM92, DZM2, DZM4

≡ A2 → DM61G : 6/24 V AC/DC
± A1 → DM62G : 24/60 V AC/DC
DM63G : 110/230 V AC/DC

LED green color.
AC/DC voltage allowed.
Coil energized indicator.

- ③ DUC11 limits max switching voltage up to 250 V AC/DC and coil rated voltage up to 240 V AC.
- ④ The height of sockets with retainer / retractor clip is shown in square brackets.

Plug-in sockets and accessories

DZM4

For D4

Screw terminals
1.37 in (35 mm) DIN
snap on rail mounting,
or direct panel mounting
2.95 in (75) x 1.06 (27)
x 2.4 in (61) [3.23 in (82)] Ⓢ
Four pole
6 A, 300 V



Connection diagram

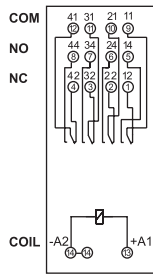

Accessories Ⓢ DZT4-0035 Module type DM6..

Dimensions

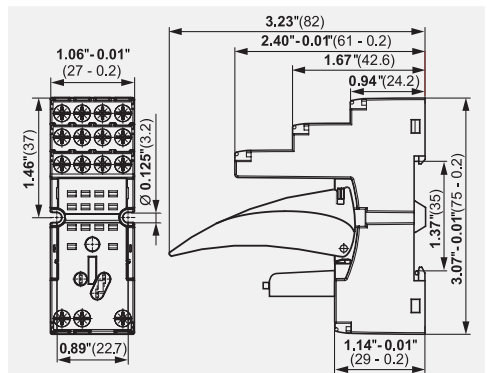

DZ8

For D15 DPDT

Screw terminals
1.37 in (35 mm) DIN
snap on rail mounting,
or direct panel mounting
2.68 in (68.2) x 1.5 (38)
x 0.94 in (24.2)
10 A, 250 V

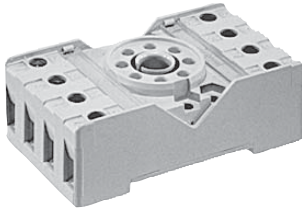

Connection diagram

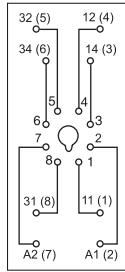

Accessories Ⓢ DZ11 0031

Dimensions

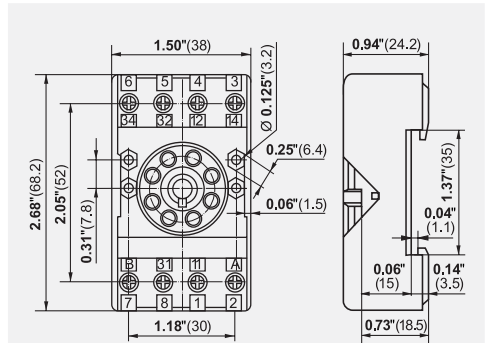

DZ11

For D15 3PDT

Screw terminals
1.37 in (35 mm) DIN
snap on rail mounting,
or direct panel mounting
2.68 in (68.2) x 1.5 (38)
x 0.94 in (24.2)
10 A, 250 V

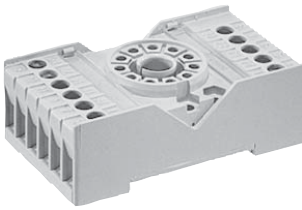

Connection diagram

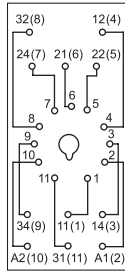

Accessories Ⓢ DZ11 0031

Dimensions

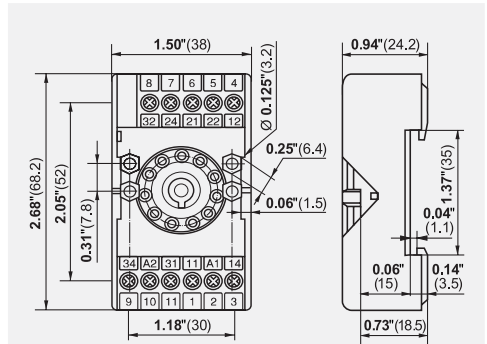

DUC11 Ⓢ

For DUC

Screw terminals
1.37 in (35 mm) DIN
snap on rail mounting,
or direct panel mounting
3.23 in (82) x 1.66 (42.2)
x 1.04 in (26.5)
16 A, 250 V

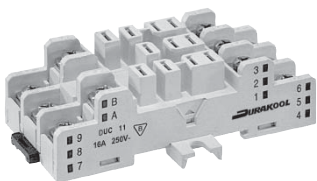

Connection diagram

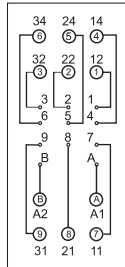

Accessories Ⓢ DMBA

Dimensions

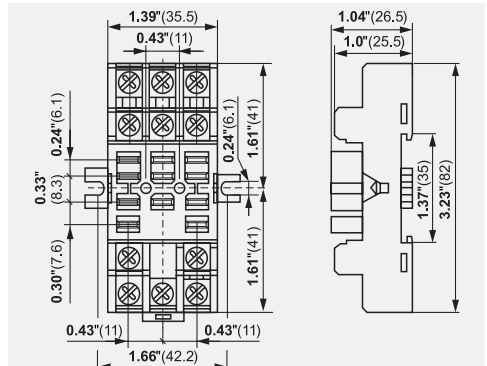

X-ON Electronics

Largest Supplier of Electrical and Electronic Components

Click to view similar products for [Durakool](#) manufacturer:

Other Similar products are found below :

[DG85B-8011-35-1012](#) [SDA3Z-30K-A 4859](#) [DFC3-301](#) [DM84-2012-35-1012](#) [SDA1Z-40K-D](#) [DM85-2011-35-1012](#) [SRA3Z-60K-D](#) [DHS01](#)
[SDA1Z-15K-D](#) [SDA1Z-80K-A](#) [SDA1Z-80K-D](#) [SRA1Z-25K-D](#) [SDA3Z-30K-D](#) [DM84-2012-35-5012](#) [SRA3Z-80K-D](#) [DHS02](#) [SRA1Z-10K-](#)
[D](#) [SRA3Z-60K-A](#) [SRA1Z-40K-D](#) [A1/2-001](#) [SRA1Z-60K-A](#) [SRA1Z-40K-A](#) [SIM212-12VDC](#) [SRA1Z-10K-A](#) [A1B-003](#) [DG85B-](#)
[8021-96-1012-M1](#) [DM84-2012-35-1024](#) [DG85C-8021-75-1012](#) [SRA1Z-25K-A](#) [DG20-8011-35-1012](#) [SRA1Z-60K-D](#) [SRA1Z-100K-A](#) [5002](#)
[SRA2Z-40K-D](#) [SRA1Z-40L-A](#) [SRD-SGR2-M03](#) [DG85CM-5021-76-1012](#) [SRA1Z-15L-D](#) [DG85B-8011-96-1012-M1](#) [SIM112 16VDC](#)
[SRA1Z-80K-A](#) [SRA1Z-25L-A](#) [DTP1](#) [SRA1Z-100K-D](#) [SRA1Z-15L-A](#) [SRA1Z-100L-D](#) [SRA1Z-25L-D](#) [SRA1Z-40L-D](#) [SRA1Z-60L-A](#)