

Pneufit C

Composite Fittings

Ø 3 to 10mm O/D tube
Ø 1/8" to 3/8" O/D tube

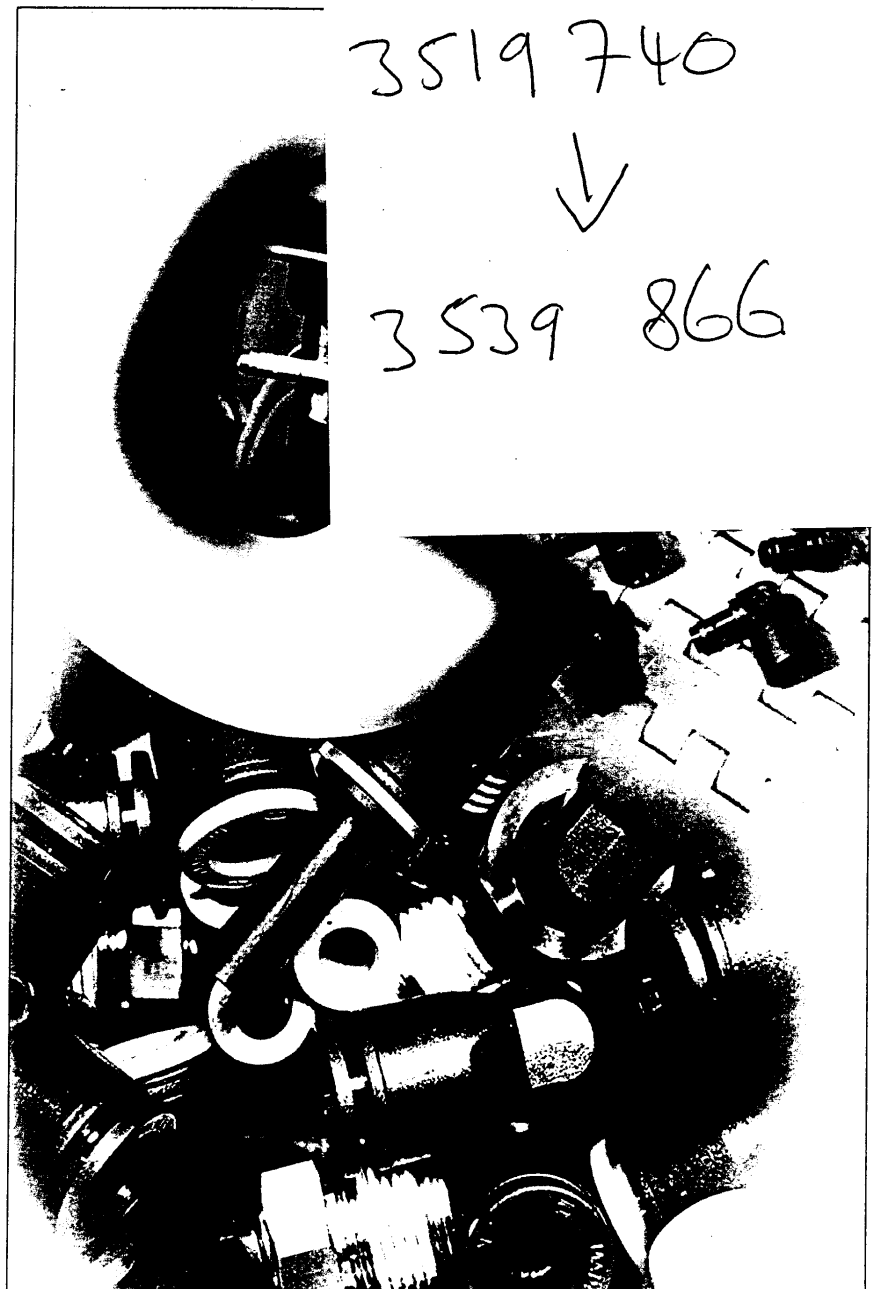

- Innovation through design & technology
- Superior levels of performance
- Compact and light weight
- Inch and metric sizes

Method of assembly



1. Ensure that the end of the tube is cut square and is free from burrs.

2. Push the tube through the release button and grab ring into the fitting.

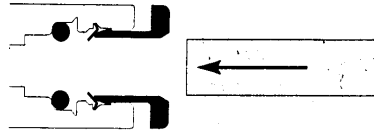

3. Push the tube firmly through the 'O' ring until it bottoms on the tube stop then pull back.

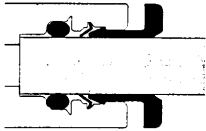

4. To disconnect, push the tube into the fitting, hold down the release button and withdraw the tube.

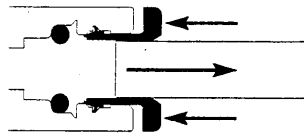

Typical dimensions

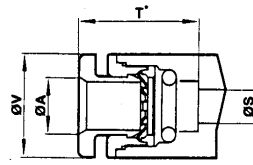

A O/D tube	S†	T* Tube stop	V
3mm	2,3	15,3	10,7
4mm	2,8	15,3	10,7
6mm	4,4	17,1	12,9
8mm	6,0	19,2	14,5
10mm	7,7	20,25	17,6

A O/D tube	S†	T* Tube stop	V
1/8"	2,3	15,3	10,7
5/32"	2,8	15,3	10,7
1/4"	4,4	17,1	12,9
5/16"	6,0	19,2	14,5
3/8"	7,7	20,25	17,6

* Dimensions here and in the individual tables refer to the release button in the 'OUT' position

† Dimensions here (minimum bore diameter) are common per tube size for all connectors, elbow and tees unless otherwise stated

Tube sizes

3, 4, 6, 8, 10mm O/D & 1/8", 5/32", 1/4", 5/16", 3/8" O/D

Warning: The PneuFit C design is not to be used with vehicle air braking or ancillary systems. For push-in fittings suitable for these applications, please refer to the Fleetfit range or contact Technical Sales for assistance

Tube types

Nylon 11 or 12, polyurethane* and other plasticised or unplasticised tubing which conforms to the tolerances specified in DIN 73378, NFE 49-101, ISO / WD 16026, ISO / WD 16627

Copper and stainless steel

* Suitable for 85D

Torque figures

Thread sealant is applied to the full circumference of the thread. The recommended tightening torque figures for designs with thread sealant are found in the table below

Thread (Tapered)	Tightening Torque (Nm)
1/8"	6,86 ... 8,82
1/4"	11,76 ... 13,72
3/8"	21,56 ... 25,32
1/2"	27,44 ... 29,40

C-Clips

For colour coding and tamper-resistant feature

	3mm ... 4mm 1/8" ... 5/32"	6mm 1/4"	8mm 5/16"	10mm 3/8"
RED	48A35501	48B35501	48C35501	48D35501
YELLOW	48A35502	48B35502	48C35502	48D35502
ORANGE	48A35503	48B35503	48C35503	48D35503
GREEN	48A35504	48B35504	48C35504	48D35504
BLACK	48A35505	48B35505	48C35505	48D35505
BROWN	48A35506	48B35506	48C35506	48D35506
VIOLET	48A35507	48B35507	48C35507	48D35507
BLUE	48A35508	48B35508	48C35508	48D35508
WHITE	48A35509	48B35509	48C35509	48D35509
SILVER	48A35510	48B35510	48C35510	48D35510

Boxed in quantities of 30

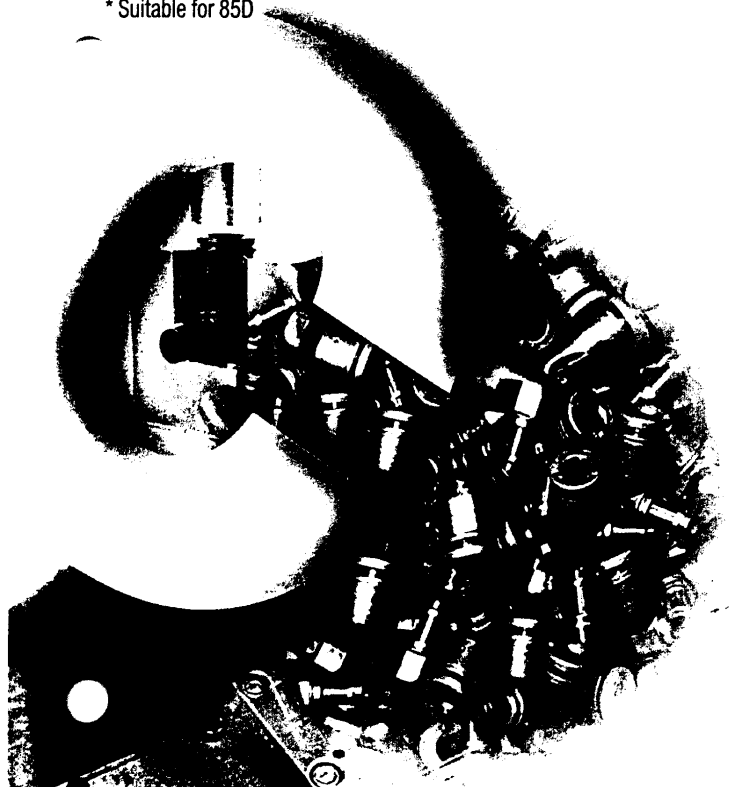

Pneufit C Composite Fittings

Ø 3 to 12 mm O/D tube Ø 1/8" to 3/8" O/D tube

With innovation through design and in-house manufacturing, Pneufit C provides a reliable and superior quality pneumatic fitting

Releasable grab ring technology combining plastic and brass components for a compact fitting design

High-level performance for gripping soft PU tube through to copper and stainless steel

Colour coding option with tamper-resistant feature

Features

- Moulded mounting brackets on tube connector designs
- Lightweight
- Red/grey release sleeve indicates metric/inch tube sizes
- Silicone free 'O' ring seals
- Non-PTFE based thread sealant on tapered threads
- Easy tube insertion for rapid and quick assembly of pneumatic circuits
- Internal hexagon on straight adaptors allows assembly in confined spaces
- Corrosion resistant

Technical data

- Medium:
Compressed air
- Operating pressure:
Vacuum - 18 bar unless otherwise stated (dependent on tubing specification)
- Ambient temperature:
-20° to +80° C

Materials

- Bodies: plastic - PBT, except straight adaptors and straight stem adaptors
- Straight adaptors: nickel plated brass
- Straight stem adaptors: plastic - acetal
- Threads: nickel plated brass
- Grab ring: stainless steel - BS 1440 Pt 2, grade 301.S21
- 'O' rings: silicone free nitrile

Typical part number: C01470628
90° Swivel elbow adaptor

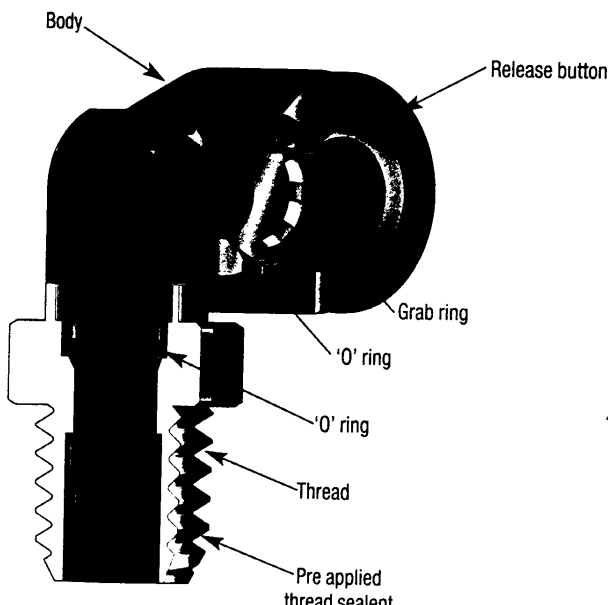

Straight connector

O/D Tube	A	B	C	D
3	33.5	10.7	5.0	13.6
4	33.5	10.7	5.0	13.6
6	39.0	12.9	6.0	15.7
8	43.5	14.5	7.0	17.5
10	48.0	17.4	8.0	20.1

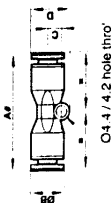

Straight connector

O/D Tube	A	B	C	D
1/8"	33.5	10.7	5.0	13.6
5/32"	33.5	10.7	5.0	13.6
1/4"	39.0	12.9	6.0	15.7
5/16"	43.5	14.5	7.0	17.5
3/8"	48.0	17.4	8.1	20.1

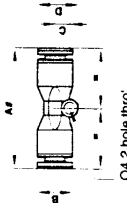

Straight adaptor

O/D BSPP Tube Thread	A	C	D	E
4 M3	19.2	M3	1.5	10.6
4 M5	21.2	M5	2.5	10.6
4 1/8"	18.7	1/8"	13.8	12.0
4 1/4"	21.5	1/4"	17.8	12.0
6 M5	24.6	M5	2.5	12.6
6 1/8"	24.1	1/8"	13.8	14.0
6 1/4"	23.1	1/4"	17.8	14.0
8 1/8"	27.0	1/8"	13.8	16.0
8 1/4"	25.0	1/4"	17.8	16.0
8 3/8"	25.0	3/8"	21.7	16.0
8 1/2"	27.5	1/2"	25.7	16.0
10 1/8"	28.1	1/8"	13.8	21.0
10 1/4"	31.1	1/4"	17.8	21.0
10 3/8"	28.1	3/8"	21.7	21.0
10 1/2"	30.1	1/2"	25.7	21.0

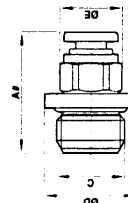

Straight adaptor

O/D BSPP Tube Thread	A	C	D	E
4 M3	19.2	M3	1.5	10.6
4 M5	21.2	M5	2.5	10.6
4 1/8"	18.7	1/8"	13.8	12.0
4 1/4"	21.5	1/4"	17.8	12.0
6 M5	24.6	M5	2.5	12.6
6 1/8"	24.1	1/8"	13.8	14.0
6 1/4"	23.1	1/4"	17.8	14.0
8 1/8"	27.0	1/8"	13.8	16.0
8 1/4"	25.0	1/4"	17.8	16.0
8 3/8"	25.0	3/8"	21.7	16.0
8 1/2"	27.5	1/2"	25.7	16.0
10 1/8"	28.1	1/8"	13.8	21.0
10 1/4"	31.1	1/4"	17.8	21.0
10 3/8"	28.1	3/8"	21.7	21.0
10 1/2"	30.1	1/2"	25.7	21.0



Female straight adaptor

PIF BSPP Female	A	D
4 M5	22.5	12.0
4 1/8"	25.2	14.0
4 1/4"	29.7	18.5
6 1/8"	27.1	14.0
6 1/4"	31.6	18.5
8 1/8"	29.1	16.0
8 1/4"	34.1	18.5
8 1/4"	29.5	21.0
8 3/8"	29.5	21.0



Female straight adaptor

O/D NPTF Tube Thread	A	D
1/8"	28.2	15.8
1/8"	35.2	17.0
5/32"	28.2	15.8
5/32"	35.2	17.0
1/4"	31.6	15.8
1/4"	38.1	17.0
5/16"	33.0	17.0
5/16"	40.5	17.0
3/8"	41.1	21.0
3/8"	42.1	24.0

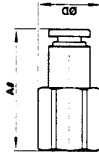

Elbow connector

O/D Tube	A	B	C
3	18.0	10.7	6.5
4	18.0	10.7	6.5
6	21.0	12.9	7.7
8	25.0	14.5	7.25
10	27.5	17.4	8.35
O/D Tube	A	B	C
1/8"	18.0	10.7	6.5
5/32"	18.0	10.7	6.5

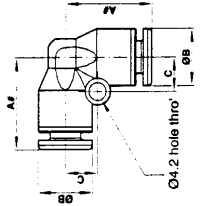

90° Swivel elbow adaptor

O/D BSPT Tube Thread	A	B	C
3 1/8"	18.0	10.7	19.5
4 1/8"	18.0	10.7	19.5
4 1/4"	18.0	10.7	20.5
6 1/8"	21.0	12.9	21.0
6 1/4"	21.0	12.9	24.0
6 3/8"	21.0	12.9	26.0
8 1/4"	25.0	14.5	25.0
8 3/8"	25.0	14.5	26.5
10 3/8"	27.5	17.4	28.5

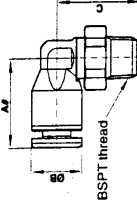

90° Swivel elbow adaptor

O/D NPTF Tube Thread	A	B	C
1/8" 1/8"	18.0	10.7	20.0
1/8" 1/4"	18.0	10.7	26.0
5/32" 1/8"	18.0	10.7	20.0
5/32" 1/4"	18.0	10.7	26.0
1/4" 1/8"	21.0	12.9	21.0
1/4" 1/4"	21.0	12.9	26.5
1/4" 3/8"	21.0	12.9	28.0
5/16" 1/8"	24.5	14.5	32.2
5/16" 1/4"	25.0	14.5	27.0
3/8" 1/4"	27.5	17.4	29.0
3/8" 3/8"	27.5	17.4	31.0
3/8" 1/2"	27.5	17.4	36.5

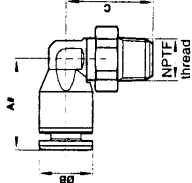

Stem elbow connector

O/D Tube Stem	A	B	C	E
4 4	18.0	10.7	21.0	22.5
6 6	21.0	12.9	24.5	26.0
8 8	25.0	14.5	27.3	31.5

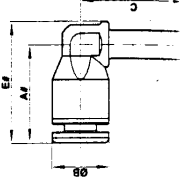

Straight connector

O/D Tube	A	B	C	D
3	33,5	10,7	5,0	13,6
4	33,5	10,7	5,0	13,6
6	39,0	12,9	6,0	15,7
8	43,5	14,5	7,0	17,5
10	48,0	17,4	8,0	20,1

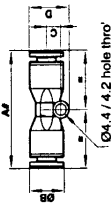

Straight connector

O/D Tube	A	B	C	D
1/8"	33,5	10,7	5,0	13,6
5/32"	33,5	10,7	5,0	13,6
1/4"	39,0	12,9	6,0	15,7
5/16"	43,5	14,5	7,0	17,5
3/8"	48,0	17,4	8,1	20,1

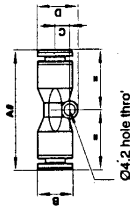

Straight adaptor

O/D BSPPT Tube Thread	A	C	D	E
4 M3	19,2	M3	1,5	10,6
4 M5	21,2	M5	2,5	10,6
4 1/8"	18,7	1/8"	1,8	12,0
4 1/4"	21,5	1/4"	1,8	12,0
6 M5	24,6	M5	2,5	12,6
6 1/8"	24,1	1/8"	1,8	14,0
6 1/4"	23,1	1/4"	1,8	14,0
8 1/8"	27,0	1/8"	1,8	16,0
8 1/4"	25,0	1/4"	1,8	16,0
8 3/8"	25,0	3/8"	2,1	16,0
8 1/2"	27,5	1/2"	2,5	16,0
10 1/8"	28,1	1/8"	1,8	21,0
10 1/4"	31,1	1/4"	1,8	21,0
10 3/8"	28,1	3/8"	2,1	21,0
10 1/2"	30,1	1/2"	2,5	21,0

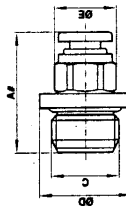

Straight adaptor

O/D BSPPT Tube Thread	A	C	E
1/8"	18,0	10,7	6,5
5/32"	18,0	10,7	6,5



Female straight adaptor

PIF BSPPT Female	A	D
4 M5	22,5	12,0
4 1/8"	25,2	14,0
4 1/4"	29,7	18,5
6 1/8"	27,1	14,0
6 1/4"	31,6	18,5
8 1/8"	29,1	16,0
8 1/4"	34,1	18,5
8 1/4"	29,5	21,0
8 3/8"	29,5	21,0

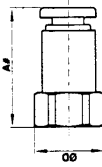

Female straight adaptor

O/D NPTF Tube Thread	A	D
1/8"	28,2	15,8
1/8"	35,2	17,0
5/32"	28,2	15,8
5/32"	35,2	17,0
1/4"	31,6	15,8
1/4"	38,1	17,0
5/16"	33,0	17,0
5/16"	40,5	17,0
3/8"	41,1	21,0
3/8"	42,1	24,0

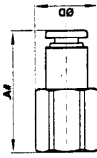

Elbow connector

O/D Tube	A	B	C
3	18,0	10,7	6,5
4	18,0	10,7	6,5
6	21,0	12,9	7,7
8	25,0	14,5	7,25
10	27,5	17,4	8,35

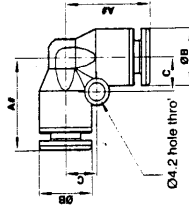

90° Swivel elbow adaptor

O/D BSPPT Tube Thread	A	B	C
3 1/8"	18,0	10,7	19,5
4 1/8"	18,0	10,7	19,5
4 1/4"	18,0	10,7	20,5
6 1/8"	21,0	12,9	21,0
6 1/4"	21,0	12,9	24,0
6 3/8"	21,0	12,9	26,0
8 1/4"	25,0	14,5	25,0
8 3/8"	25,0	14,5	26,5
10 3/8"	27,5	17,4	28,5

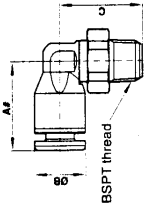

90° Swivel elbow adaptor

O/D NPTF Tube Thread	A	B	C
1/8"	18,0	10,7	20,0
1/8"	18,0	10,7	26,0
5/32"	18,0	10,7	20,0
5/32"	18,0	10,7	26,0
1/4"	21,0	12,9	21,0
1/4"	21,0	12,9	26,5
1/4"	21,0	12,9	28,0
5/16"	24,5	14,5	32,2
5/16"	25,0	14,5	27,0
3/8"	27,5	17,4	29,0
3/8"	27,5	17,4	31,0
3/8"	27,5	17,4	36,5

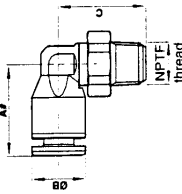

Stem elbow connector

O/D Tube Stem	A	B	C	E
4	4	18,0	10,7	21,0
6	6	21,0	12,9	24,5
8	8	25,0	14,5	27,3

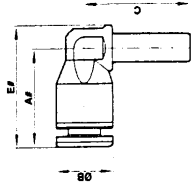

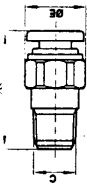

4	1/4"	23,2	1/4"	15,0	C01250428
6	1/8"	25,1	1/8"	14,0	C01250618
6	1/4"	23,1	1/4"	15,0	C01250628
8	1/8"	28,6	1/8"	16,0	C01250818
8	1/4"	26,1	1/4"	16,0	C01250828
8	3/8"	26,1	3/8"	18,5	C01250838
8	1/2"	31,6	1/2"	24,0	C01250848
10	1/8"	30,1	1/8"	21,0	C01251018
10	1/4"	32,1	1/4"	21,0	C01251028
10	3/8"	29,6	3/8"	21,0	C01251038
10	1/2"	33,1	1/2"	24,0	C01251048

Straight adaptor

O/D	UNF Thread	A	B	C	
1/8"	10-32	21,2	10,7	10,6	C24250110
5/32"	10-32	21,2	10,7	10,6	C24250210
1/4"	10-32	24,1	12,9	12,6	C24250410

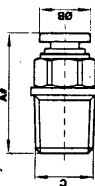

O/D	NPTF Thread	A	B	C	
1/8"	1/16"	21,7	10,7	1/16"	C24250116
1/8"	1/8"	20,2	10,7	1/8"	C24250118
1/8"	1/4"	25,7	10,7	1/4"	C24250128
5/32"	1/8"	21,2	10,7	1/8"	C24250218
5/32"	1/4"	25,7	10,7	1/4"	C24250228
1/4"	1/8"	26,1	12,9	1/8"	C24250418
1/4"	1/4"	27,6	12,9	1/4"	C24250428
1/4"	3/8"	27,6	12,9	3/8"	C24250438
5/16"	1/8"	29,5	14,5	1/8"	C24250518
5/16"	1/4"	29,5	14,5	1/4"	C24250528
5/16"	3/8"	27,5	14,5	3/8"	C24250538
3/8"	1/8"	31,1	17,6	1/8"	C24250618
3/8"	1/4"	34,6	17,6	1/4"	C24250628
3/8"	3/8"	30,1	17,6	3/8"	C24250638
3/8"	1/2"	35,6	17,6	1/2"	C24250648



5/16"	25,0	14,5	7,25	C20400500
3/8"	27,5	17,4	8,35	C20400600



90° Swivel elbow adaptor

O/D	BSP Thread	A	B	C	
3	1/8"	18,0	10,7	20,0	C02470318
4	M5	18,0	10,7	17,5	C02470405
4	1/8"	18,0	10,7	20,0	C02470418
4	1/4"	18,0	10,7	23,0	C02470428
6	M5	21,0	12,9	18,5	C02470605
6	1/8"	21,0	12,9	20,5	C02470618
6	1/4"	21,0	12,9	23,5	C02470628
8	1/4"	25,0	14,5	25,5	C02470828
8	3/8"	25,0	14,5	26,5	C02470838
10	3/8"	27,5	17,4	28,5	C02471038

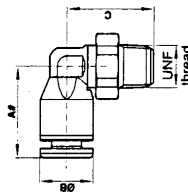
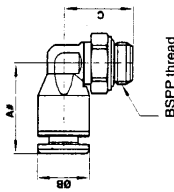

90° Swivel elbow adaptor

O/D	UNF Thread	A	B	C	
1/8"	10-32	18,0	10,7	17,5	C24470110
5/32"	10-32	18,0	10,7	17,5	C24470210
1/4"	10-32	21,0	12,9	18,5	C24470410



O/D	Tube	Stern	A	B	C	E
1/4"	1/4"	21,0	12,9	24,5	26,0	C20430400



Tee connector

O/D	Tube	A	B	C	E
3	18,0	10,7	6,5	23,5	C00600300
4	18,0	10,7	6,5	23,5	C00600400
6	21,0	12,9	7,7	27,5	C00600600
8	25,0	14,5	7,25	32,5	C00600800
10	27,5	17,4	8,35	36,5	C00601000

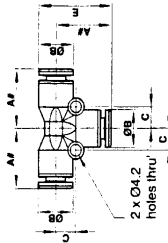

O/D	Tube	A	B	C	E
1/8"	18,0	10,7	6,5	23,5	C20600100
5/32"	18,0	10,7	6,5	23,5	C20600200
1/4"	21,0	12,9	7,7	27,5	C20600400
5/16"	25,0	14,5	7,25	32,5	C20600500
3/8"	27,5	17,4	8,35	36,5	C20600600

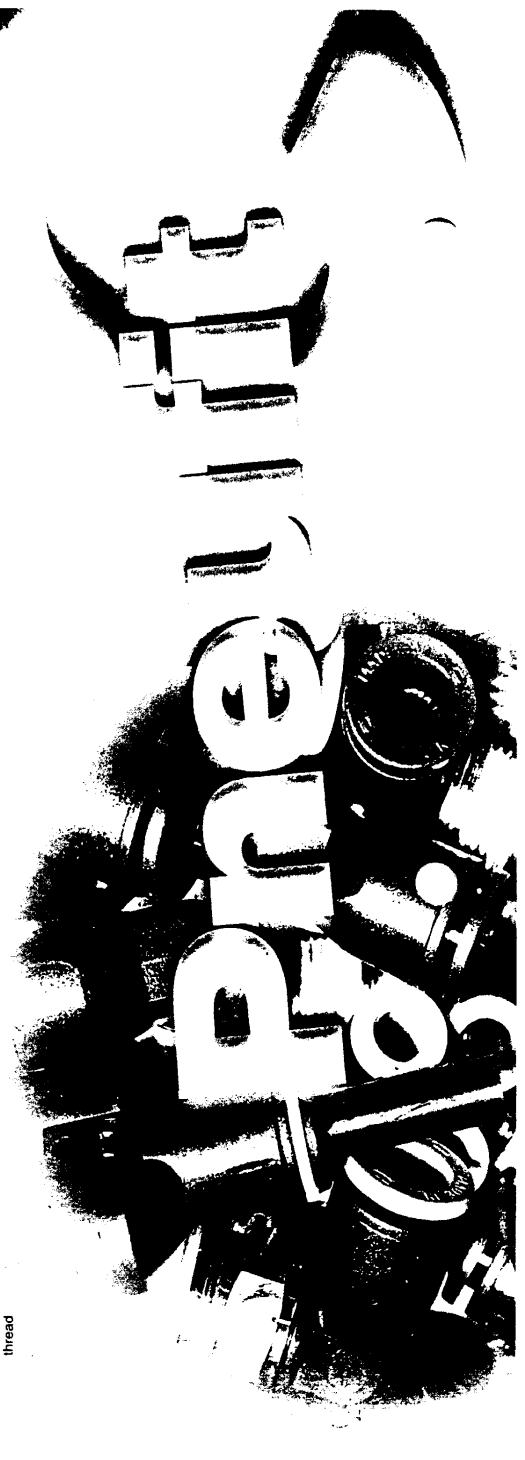

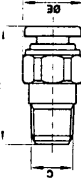

4	1/4"	23.2	1/4"	15.0	C01250428
6	1/8"	25.1	1/8"	14.0	C01250618
6	1/4"	23.1	1/4"	15.0	C01250628
8	1/8"	28.6	1/8"	16.0	C01250818
8	1/4"	26.1	1/4"	16.0	C01250828
8	3/8"	26.1	3/8"	18.5	C01250838
8	1/2"	31.6	1/2"	24.0	C01250848
10	1/8"	30.1	1/8"	21.0	C01251018
10	1/4"	32.1	1/4"	21.0	C01251028
10	3/8"	29.6	3/8"	21.0	C01251038
10	1/2"	33.1	1/2"	24.0	C01251048

Straight adaptor

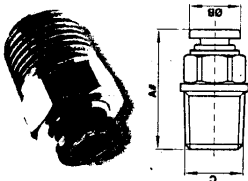

O/D	UNF				
Tube	Thread	A	B	C	
1/8"	10-32	21.2	10.7	10.6	C24250110
5/32"	10-32	21.2	10.7	10.6	C24250210
1/4"	10-32	24.1	12.9	12.6	C24250410



O/D	NPTF				
Tube	Thread	A	B	C	
1/8"	1/16"	21.7	10.7	1/16"	C24250116
1/8"	1/8"	20.2	10.7	1/8"	C24250118
1/8"	1/4"	25.7	10.7	1/4"	C24250128
5/32"	1/8"	21.2	10.7	1/8"	C24250218
5/32"	1/4"	25.7	10.7	1/4"	C24250228
1/4"	1/8"	26.1	12.9	1/8"	C24250418
1/4"	1/4"	27.6	12.9	1/4"	C24250428
1/4"	3/8"	27.6	12.9	3/8"	C24250438
5/16"	1/8"	29.5	14.5	1/8"	C24250518
5/16"	1/4"	29.5	14.5	1/4"	C24250528
5/16"	3/8"	27.5	14.5	3/8"	C24250538
3/8"	1/8"	31.1	17.6	1/8"	C24250618
3/8"	1/4"	34.6	17.6	1/4"	C24250628
3/8"	3/8"	30.1	17.6	3/8"	C24250638
3/8"	1/2"	35.6	17.6	1/2"	C24250648



5/16"	25.0	14.5	7.25	C20400500
3/8"	27.5	17.4	8.35	C20400600



90° Swivel elbow adaptor

O/D	BSPP				
Tube	Thread	A	B	C	
3	1/8"	18.0	10.7	20.0	C02470318
4	M5	18.0	10.7	17.5	C02470405
4	1/8"	18.0	10.7	20.0	C02470418
4	1/4"	18.0	10.7	23.0	C02470428
6	M5	21.0	12.9	18.5	C02470605
6	1/8"	21.0	12.9	20.5	C02470618
6	1/4"	21.0	12.9	23.5	C02470628
8	1/4"	25.0	14.5	25.5	C02470828
8	3/8"	25.0	14.5	26.5	C02470838
10	3/8"	27.5	17.4	28.5	C02471038

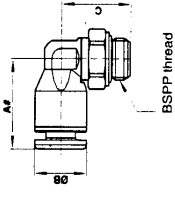

90° Swivel elbow adaptor

O/D	UNF				
Tube	Thread	A	B	C	
1/8"	10-32	18.0	10.7	17.5	C24470110
5/32"	10-32	18.0	10.7	17.5	C24470210
1/4"	10-32	21.0	12.9	18.5	C24470410

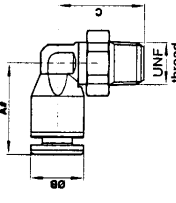

O/D	Tube	Stem	A	B	C	E
1/4"	1/4"	21.0	12.9	24.5	26.0	C20430400



Tee connector

O/D	Tube	A	B	C	E
3	18.0	10.7	6.5	23.5	C00600300
4	18.0	10.7	6.5	23.5	C00600400
6	21.0	12.9	7.7	27.5	C00600600
8	25.0	14.5	7.25	32.5	C00600800
10	27.5	17.4	8.35	36.5	C00601000

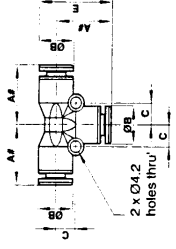

O/D	Tube	A	B	C	E
1/8"	18.0	10.7	6.5	23.5	C20600100
5/32"	18.0	10.7	6.5	23.5	C20600200
1/4"	21.0	12.9	7.7	27.5	C20600400
5/16"	25.0	14.5	7.25	32.5	C20600500
3/8"	27.5	17.4	8.35	36.5	C20600600

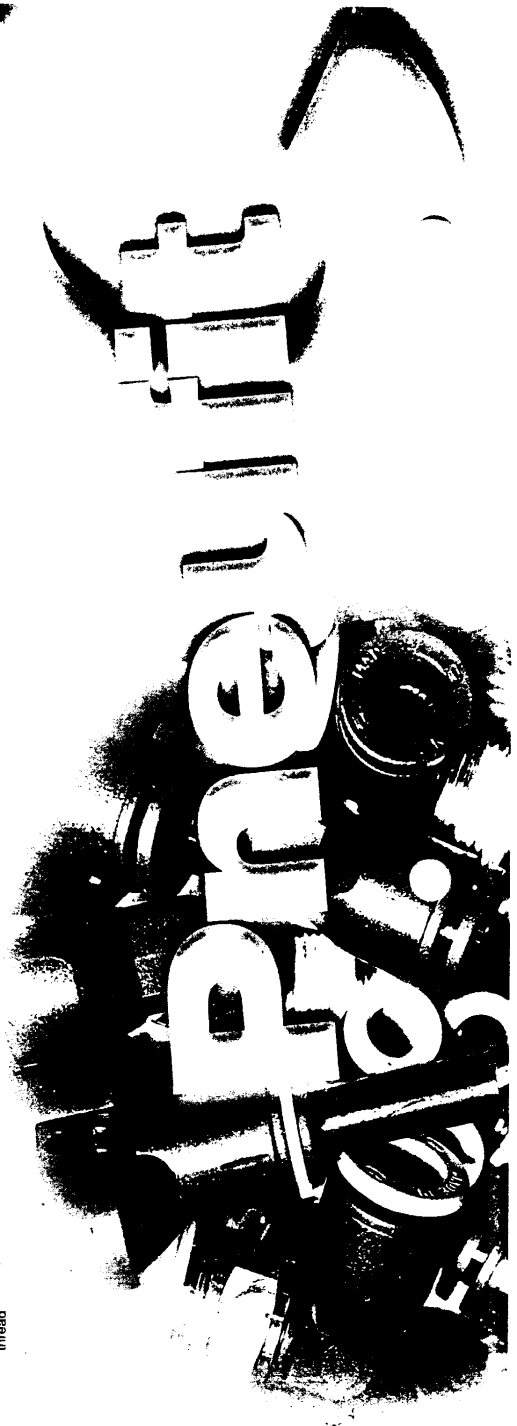

X-ON Electronics

Largest Supplier of Electrical and Electronic Components

Click to view similar products for [norgren](#) manufacturer:

Other Similar products are found below :

[8254200.9151.02400](#) [B72G-2GK-AL3-RMN](#) [C01470828](#) [18-013-989](#) [18-013-990](#) [V61B413A-A213J](#) [100201000](#) [101250828](#) [CS6004010](#)
[F72G-2GN-AL3](#) [101470838](#) [8240400.9101.23050](#) [M/58308/01](#) [RT/57220/M/40](#) [18-015-013](#) [F74G-4GN-AP3](#) [8240400.9101.02400](#)
[C01251048](#) [RT/57212/M/50](#) [M/3314](#) [101250628](#) [101470818](#) [RT/57220/M/80](#) [150050038](#) [602112128](#) [V62C413A-A213J](#) [R07-200-RNKG](#)
[V60A513A-A213J](#) [101250818](#) [10K510618](#) [S/521](#) [101251028](#) [R72G-2GK-RMN](#) [C02260628](#) [C01250838](#) [101470628](#) [C00200400](#) [M/S2](#)
[C01470628](#) [R07-100-RNKG](#) [C01470838](#) [088030000000000000](#) [101250838](#) [101470618](#) [102250628](#) [18-015-989](#) [101470828](#) [C01251038](#) [18-025-003](#) [C01250828](#)