

SECTION B-B

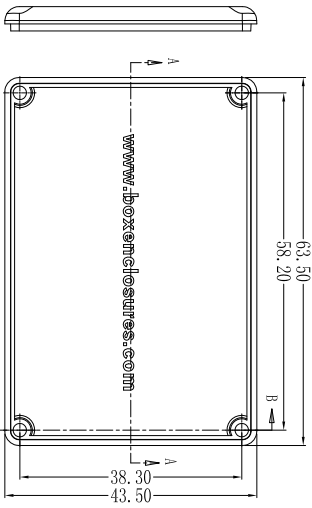

SECTION B-B

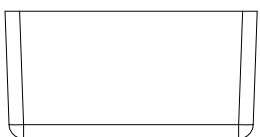
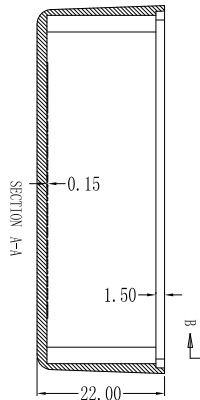
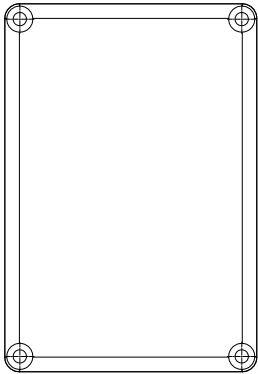
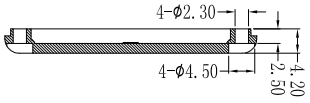

SECTION A-A

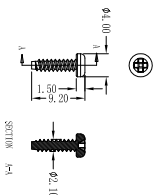
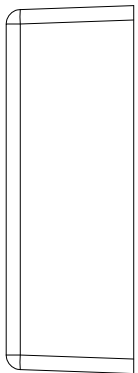

SECTION A-A

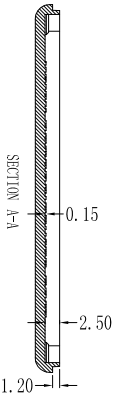

SECTION A-A



ENCLOSURES & ASSEMBLY SERVICES

Title: BMC-209 Master Drawing

Dwg. No.: Part No.:

Material:

ABS

TOLERANCE in mm
 all dimension unless otherwise specified

Color: Dwg. Date
 18/1/2010 HJA

Finish:

x

±0.20
 ±0.10
 ±0.05
 ANGLE ±0.5°

Qty: Chk. Date



Sheet of

App. Date

THIS DRAWING IS THE PROPERTY OF AND MAY CONTAIN PROPRIETARY INFORMATION OWNED BY Box Enclosures. IT IS PROVIDED UNDER A CONFIDENTIAL RELATIONSHIP FOR A SPECIFIC PURPOSE. THE RECIPIENT AGREES TO USE IT ONLY FOR SUCH PURPOSE AND RETURN IT TO Box Enclosure UPON REQUEST.

X-ON Electronics

Largest Supplier of Electrical and Electronic Components

Click to view similar products for [box enclosures manufacturer](#):

Other Similar products are found below :

[101-42-NO-R-BO](#) [B2-080SI](#) [40-RBT-BL](#) [B2-160SI](#) [40-12-NO-F-BL](#) [40-RBT-BLK](#) [40-12-9V-R-BO](#) [55-RBT-BL](#) [B4-220BK](#) [SK1](#) [40-12-9V-F-BO](#) [90-RBT-BL](#) [101-42-4A-R-BL](#) [SK4](#) [SBH-9V-BK](#) [100-42-NO-F-BL](#) [40-RBT-YEL](#) [21G-BK](#) [55-12-9V-R-BL](#) [SBH-4AA-BK](#) [55-12-2A-R-BL](#) [ASK71](#) [B1-120BL](#) [B3-080RD](#) [EC2-BK](#) [WTS127S](#) [ASK70](#) [100-42-9V-F-BL](#) [55-RBD-DBL](#) [ASK74](#) [MBS107](#) [B4-080BK](#) [101-42-9V-R-BL](#) [ASK72](#) [B3-220BK](#) [B1-080SI](#) [B3-080BL](#) [B4-160BL](#) [B2-080BL](#) [101-42-4A-R-BO](#) [310-12-BK](#) [B2-160BK](#) [90-RBT-DBL](#) [B4-160BK](#) [MBM107](#) [PBS107](#) [SBH-29V-BK](#) [PBS109](#) [MBM109](#) [PBM107](#)