

Electr. Installation Multi-Tone

- Loud installation multi-tone sounder for the 22.5 mm control panel programme
- High protection rating IP 65
- Adjustable to 8 different tones
- Adjustable sound output

TECHNICAL SPECIFICATIONS:

Dimensions (Diameter x Depth): 70 mm x 71.6 mm
Housing: PC/ABS-Blend; Deckel: PC
Sound output: max. 100 dB (sound output is adjustable on rear side when mounted)
Tone type: 8 tones adjustable on rear side of the housing

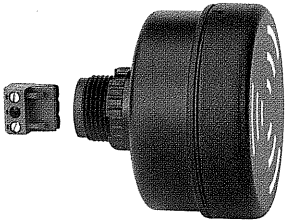

Surface housing (accessory)



Bracket (accessory)

Switch position	Waveform	Frequency	Sound level
Switch position 0		1,6 kHz	86 dB (A)
Switch position 1		1,6 kHz	86 dB (A)
Switch position 2		1,6 kHz	86 dB (A)
Switch position 3		1,6 kHz	88 dB (A)
Switch position 4		3,4 kHz	90 dB (A)
Switch position 5		3,4 kHz	100 dB (A)
Switch position 6		3,4 kHz	96 dB (A)
Switch position 7		3,4 kHz	100 dB (A)

Fixing: Installation mounting for \varnothing 22.5 mm (M 22) with anti-twist device
Connection: Connector plug with screwable connection max. 1.5 mm²
Life duration: > 5,000 hrs

ORDER SPECIFICATIONS:

	24 V \cong	115 V ~	230 V ~
Voltage	24 V \cong	115 V ~	230 V ~
Current consumption	80 mA	40 mA	40 mA
	110 000 75	110 000 67	110 000 68

ACCESSORIES:

Bracket with protective cap (IP 54)	975 109 01
Surface housing IP 65 (single)	975 109 02
Surface housing IP 65 (double) for 1 beacon and 1 audible element	975 109 03
Surface housing IP 65 (triple) for 2 beacons and 1 audible element (see page 108)	975 109 04
Surface housing IP 65 (quadruple)	975 109 05

TECHNICAL DIAGRAMS

see page 140

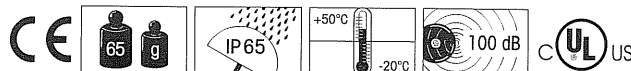

Technical Diagrams

107

Electronic Installation Buzzer 109

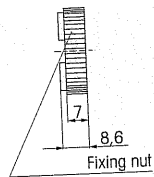
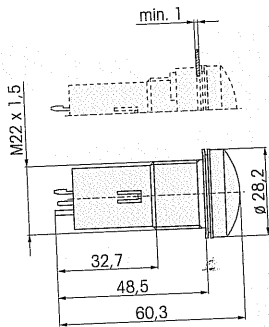

connectors 2 x 1,5mm
2 x terminal screws M3
with wire protection

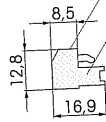

Electronic Installation Buzzer

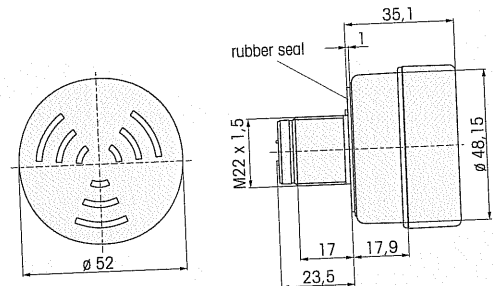

connectors 2 x 1,5² mm
2 x terminal screws M3
with wire protection

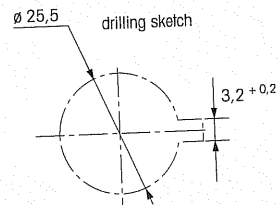
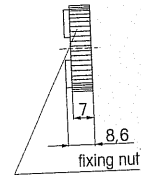
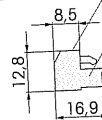

110

Electronic Installation Multi-tone Sounder

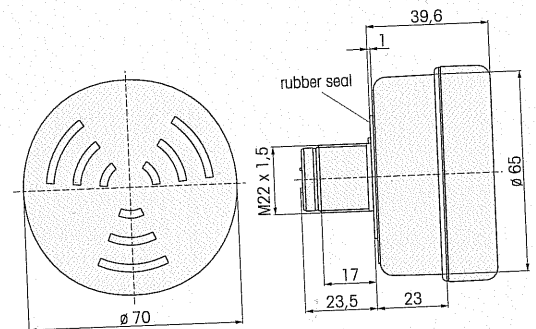

connectors 2 x 1,5² mm
2 x terminal screw M3
with wire protection

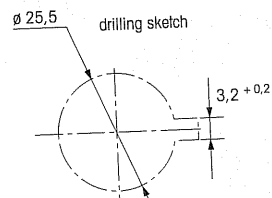
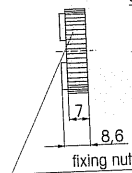
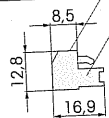

X-ON Electronics

Largest Supplier of Electrical and Electronic Components

Click to view similar products for [werma](#) manufacturer:

Other Similar products are found below :

[64140000](#) [64330068](#) [64411068](#) [64751075](#) [14095060](#) [96000002](#) [42532068](#) [64310055](#) [64712055](#) [64722055](#) [64732055](#) [82810055](#) [85320055](#)
[57005258](#) [63081000](#) [85310060](#) [64752055](#) [64411075](#) [64711075](#) [64721075](#) [42432075](#) [42512075](#) [21010000](#) [69831075](#) [85311060](#) [82830055](#)
[20310000](#) [64421075](#) [57005267](#) [58400068](#) [82620000](#) [20410075](#) [42412075](#) [82610000](#) [82630000](#) [64731075](#) [96000014](#) [57005268](#) [64150000](#)
[21330000](#) [69821075](#) [58015255](#) [44430075](#) [64589075](#) [97584091](#) [14095050](#) [42432068](#) [63082000](#) [85330055](#) [13400075](#)