

DESCRIPTION: MALE CENTRONICS BACKSHELL KIT

- BACKSHELL KIT INCLUDES:
 (1) SOLDER CUP CONNECTOR
 (1) BACKSHELL WITH STRAIN RELIEF, (2) SCREWS
 (1) FACE PLATE
 (1) RUBBER GROMMET

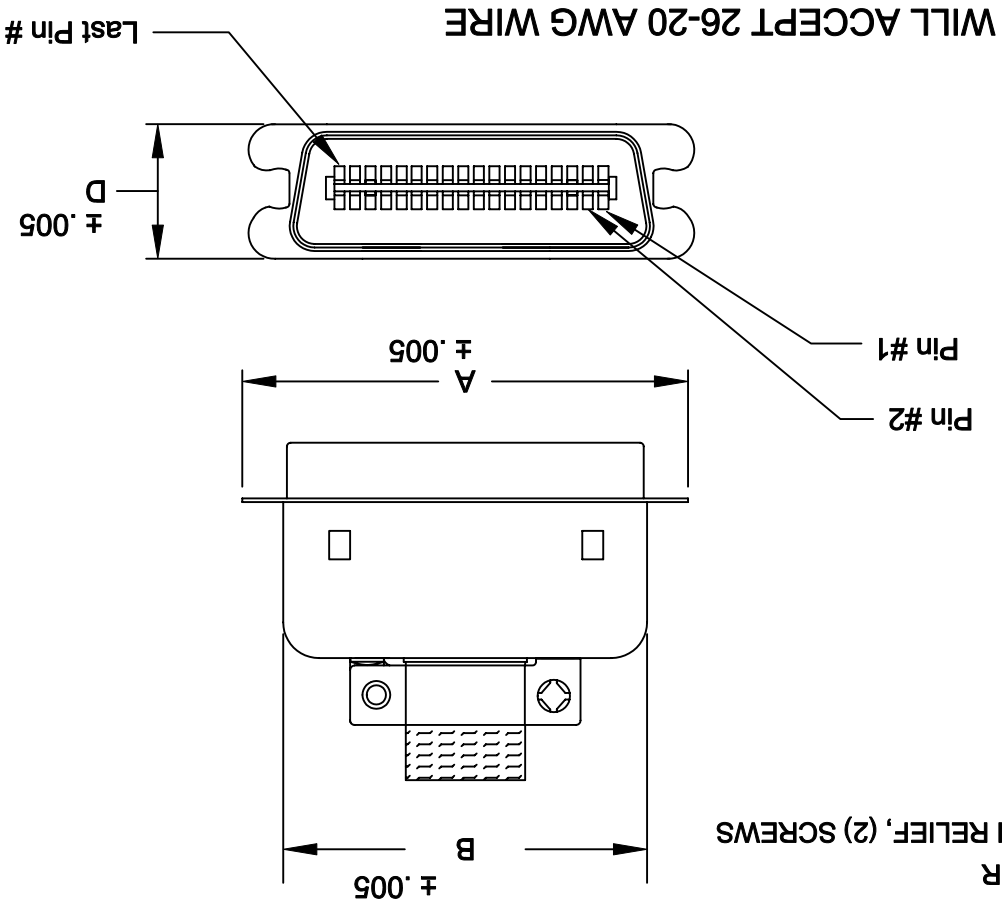

MATERIALS:

- INSULATOR: GLASS-FILLED THERMOPLASTIC
 UL RATED 94V-0 - 230°C PROCESS TEMP.
 CONTACTS: COPPER ALLOY
 SHELL: STEEL, NICKEL PLATED
 ROHS COMPLIANT

ELECTRICALS:

- CONTACT CURRENT RATING: 5 AMPS
 DIELECTRIC WITHSTANDING VOLTAGE: AC 1200 R.M.S.
 INSULATION RESISTANCE: 1000 mohms MINIMUM AT 500V DC
 CONTACT RESISTANCE: 30 MOHMS MAXIMUM
 OPERATING TEMPERATURE: -55°C TO +125°C



THESE DRAWINGS AND SPECIFICATIONS ARE THE PROPERTY OF NorComp AND SHALL NOT BE REPRODUCED, COPIED OR USED AS THE BASIS FOR THE MANUFACTURE OF SALE OF APPARATUS WITHOUT WRITTEN PERMISSION.

NorComp

110-YYY-103L001

DWG NO.

SCALE: 1:1

SHEET 1

OF 1

REV 3

CHECKED:

DATE:

WAYNE ROBBINS

DATE:

7-15-05

| | | | | |
|-----|-------|-------|-------|-------|
| 050 | 76.86 | 68.00 | 43.95 | 15.80 |
| 036 | 61.76 | 53.10 | 41.25 | 15.80 |
| 024 | 48.75 | 40.45 | 39.61 | 15.80 |
| 014 | 38.00 | 29.75 | 40.06 | 15.80 |
| | 1.496 | 1.132 | 1.572 | .622 |
| | A | B | C | D |

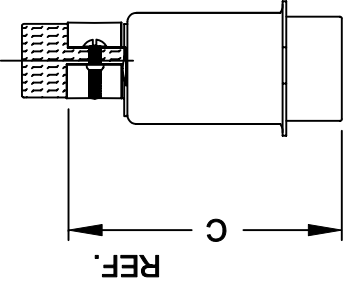

- SERIES POSITIONS
 014
 024 - NOT AVAILABLE
 036
 050
 GENDER
 1 = MALE
 2 = FEMALE
 TERMINATION
 0 = SOLDER CUP
 SHELL PLATING
 3 = NICKEL
 HARDWARE OPTIONS
 00 = NOT AVAILABLE
 PLATING OPTIONS
 1 = GOLD FLASH

110-YYY-103L001

X-ON Electronics

Largest Supplier of Electrical and Electronic Components

Click to view similar products for [I/O Connectors](#) category:

Click to view products by [NorComp](#) manufacturer:

Other Similar products are found below :

[571763P](#) [58098-0628](#) [61-168618-12P](#) [D38999/20FJ24PA L/C](#) [D38999/20FJ29SB L/C](#) [D38999/24FG11SN L/C](#) [72.250.1628.2](#) [72.250.2428.2](#)
[74720-0505](#) [747680210](#) [76.350.0729.0](#) [76871-1403](#) [FCN-244F080-G/1](#) [FCN-260A9920](#) [FCN-268D024-G/2F#10X-R10](#) [MP-5T180MUNNA-005](#) [MP-5XRJ45UNNB-003](#) [PCS-E50FA](#) [PCS-XE26LKA](#) [PCS-XE26MA+](#) [PCS-XES68MS+](#) [G38A71314B](#) [91-569719-35R](#) [9776-18-6](#)
[DX40-50P\(55\)](#) [1571250010](#) [157-22500-3](#) [MS3471L14-19P L/C](#) [MS3476W12-10S L/C](#) [171224-6031](#) [1888020-8](#) [91-569786-35H](#) [91-569786-35M](#) [91-644626-35P](#) [172501-4002](#) [172501-6002](#) [FCN-260C008-A/L0](#) [FCN-260C024-AL0](#) [FCN-261Z008](#) [FCN-268D008-G/1K](#) [2000314-1](#)
[200331-1](#) [2007498-2](#) [PCR-E28LMDAG1+](#) [PCR-E36FC+](#) [PCS-E28FS+](#) [PCS-XE26SLFD+](#) [PCS-XE26SLFDT+](#) [G38A71214B](#) [HDRA-E68W1LFDTC-SL+](#)