

D
C
B
A

PRODUCT NUMBER	STATUS	APPLICATION
7396-001	ABOLITE	5-ROW HEADER
7396-002	ACTIVE (SEE SHT 1)	4-ROW SHROUD
7396-011	ACTIVE (SEE SHT 2)	5-ROW HEADER
7396-012	ACTIVE (SEE SHT 3)	5-ROW THICK CARD HEADER
7396-013	ACTIVE (SEE SHT 4)	5-ROW HEADER (CUSTOMER SPECIAL)

NOTES
 7,8

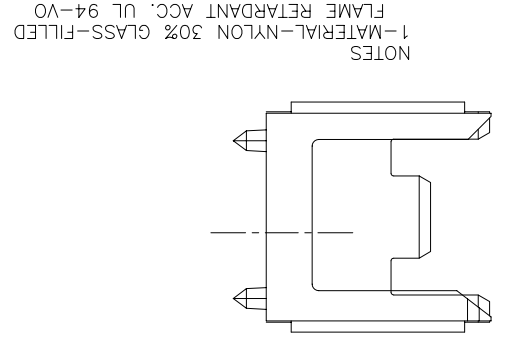
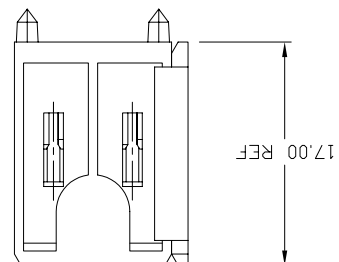
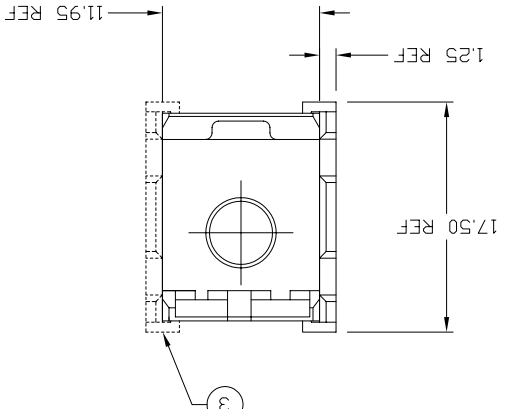

NOTES
 1-MATERIAL-NYLON 30% GLASS-FILLED
 FLAME RETARDANT ACC. UL 94-V0
 COLOR-NATURAL
 2-SHOWN WITH, A METRAL 4-ROW,
 88911-101, 12MM HYBRID HEADER HOUSING, WHICH
 MUST BE ORDERED SEPARATELY.
 3-END WALL CAN BE USED ON EITHER SIDE OF HEADER
 4-ENDWALL CAN ALSO BE USED WITH STANDARD
 METRAL 4-ROW SHROUDS
 5-REFERENCE PRODUCT SPEC GS-12-199.
 6-THIS TABLE IS NOT A COMPLETE LISTING BUT
 REPRESENTS APPLICABLE PRODUCT OFFERINGS.
 FOR OTHER PRODUCT OFFERINGS, CONTACT YOUR
 LOCAL FCI OFFICE.
 7-ADD "LF" SUFFIX AT THE END OF PART NUMBER
 FOR LEAD FREE OPTION.
 8-THIS PRODUCT MEETS EUROPEAN UNION DIRECTIVES AND OTHER
 COUNTRY REGULATION AS DESCRIBED IN GS-22-008.
 9-THE HOUSING WILL WITHSTAND EXPOSURE TO 260°C PEAK TEMPERATURE
 FOR 15 SECONDS IN A WAVE SOLDER APPLICATION WITH A 1.5mm
 MINIMUM THICK CIRCUIT BOARD. SEE APPLICATION NOTES/PROCEDURES
 IF THEY ARE AVAILABLE.

3-END WALL CAN BE USED ON EITHER SIDE OF HEADER

4-ENDWALL CAN ALSO BE USED WITH STANDARD
 METRAL 4-ROW SHROUDS

5-REFERENCE PRODUCT SPEC GS-12-199.

6-THIS TABLE IS NOT A COMPLETE LISTING BUT
 REPRESENTS APPLICABLE PRODUCT OFFERINGS.

FOR OTHER PRODUCT OFFERINGS, CONTACT YOUR
 LOCAL FCI OFFICE.

7-ADD "LF" SUFFIX AT THE END OF PART NUMBER
 FOR LEAD FREE OPTION.

8-THIS PRODUCT MEETS EUROPEAN UNION DIRECTIVES AND OTHER
 COUNTRY REGULATION AS DESCRIBED IN GS-22-008.

9-THE HOUSING WILL WITHSTAND EXPOSURE TO 260°C PEAK TEMPERATURE
 FOR 15 SECONDS IN A WAVE SOLDER APPLICATION WITH A 1.5mm
 MINIMUM THICK CIRCUIT BOARD. SEE APPLICATION NOTES/PROCEDURES
 IF THEY ARE AVAILABLE.

mat'l. code	surface	tolerance	projection	product family	title	scale	dwg no	sheet 1 of 3 size	
ISO 1302	ISO 1302	ISO 406	ISO 1101	METRAL ACC.	HEADER/SHROUD END WALL	1:1	73996	Product Customer Drawing	
dr	date	tolerances unless otherwise specified			revision				
ecn no	dr	tolerances unless otherwise specified			revision				
A	V80952	GCR	6/3/98	revision				sheet	
B	V02723	JRV	11/2/00	revision				index	
C	V02783	JWS	11/29/00	revision				sheet	
D	V1167	RPM	4/9/01	revision				sheet	
E	V12829	CGD	12/18/01	revision				sheet	
F	M06-0353	MHT	9/06/06	revision				sheet	
ppd		B.MATTHEWS		12/18/01				sheet	
chr		B.MATTHEWS		12/18/01				sheet	
engr		B.MATTHEWS		12/18/01				sheet	
dr		C.DAILY		12/18/01				sheet	

tr	ecn no	dr	date	tolerances unless otherwise specified			revision			
A	V80952	GCR	6/3/98	tolerances unless otherwise specified			revision			
B	V02723	JRV	11/2/00	tolerances unless otherwise specified			revision			
C	V02783	JWS	11/29/00	tolerances unless otherwise specified			revision			
D	V1167	RPM	4/9/01	tolerances unless otherwise specified			revision			
E	V12829	CGD	12/18/01	tolerances unless otherwise specified			revision			
F	M06-0353	MHT	9/06/06	tolerances unless otherwise specified			revision			
ppd		B.MATTHEWS		12/18/01				sheet		
chr		B.MATTHEWS		12/18/01				sheet		
engr		B.MATTHEWS		12/18/01				sheet		
dr		C.DAILY		12/18/01				sheet		

product family
 METRAL ACC.

projection

scale 1:1

dwg no
 73996
 sheet 1 of 3 size

Product Customer Drawing

6-002 CAN BE APPLIED TO:

HYBRID HEADER HOUSING P/N	SHROUD P/N
88911	70203
88913	89028

6
5
4
3
2
1

NOTES
 1-MATERIAL-NYLON 30% GLASS-FILLED
 FLAME RETARDANT ACC. UL 94-V0
 COLOR-NATURAL
 2-SHOWN WITH, A METRAL 1000 5-ROW, 12MM HEADER,
 WHICH MUST BE ORDERED SEPARATELY
 3-END WALL CAN BE USED ON EITHER SIDE OF HEADER
 4-ENDWALL CAN ALSO BE USED WITH STANDARD METRAL
 5-ROW HEADERS & SHROUNDS
 5-REFERENCE PRODUCT SPEC GS-12-199.
 6-THIS TABLE IS NOT A COMPLETE LISTING BUT
 REPRESENTS APPLICABLE PRODUCT OFFERINGS.
 FOR OTHER PRODUCT OFFERINGS, CONTACT YOUR
 LOCAL FCI OFFICE.

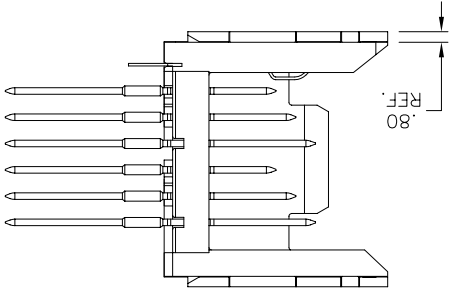
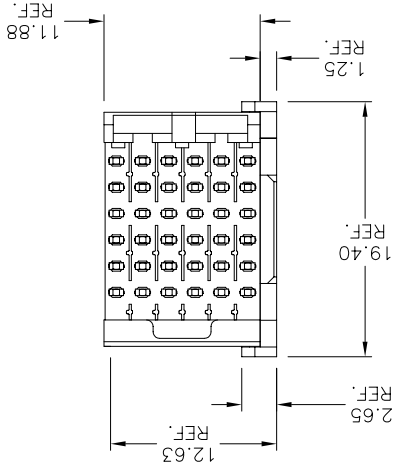
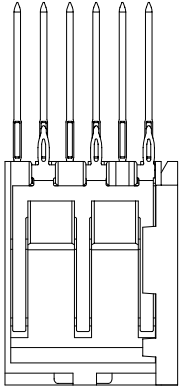

PRODUCT NUMBER	73996-011
APPLICATION	5 ROW HEADER & SHROUD

HEADER P/N	55406
SHROUD P/N	52000
	73983
	73475
	73993
	74773
	84817
	85834
	84818
	89055
	89007
	89008
	89009
	89099

73996-011

mat'l. code	surface	ISO 1302	tolerance	ISO 406	ISO 1101	projection	product family	METRAL ACC.
itr	ecn no	dr	date	tolerances unless otherwise specified			title	HEADER/SHROUD
F	angles	linear	MM	scale 1:1				product family
END WALL		METRAL ACC.						
dwg no		73996						
sheet 2 of 3 size		A3						
type		Product Customer Drawing						

sheet	revision	sheet	index
dr	C.DAILY	12/18/01	
enr	B.MATTHEWS	12/18/01	
chr	B.MATTHEWS	12/18/01	
appd	B.MATTHEWS	12/18/01	

6	5	4	3	2	1
---	---	---	---	---	---

D

Copyright FCI

FCI
FCIconnect.com

A

6

PRODUCT NUMBER	73996-012
APPLICATION	5 ROW THICK CARD HEADER

NOTES
 1-MATERIAL-NYLON 30% GLASS-FILLED
 FLAME RETARDANT ACC. UL 94-V0
 COLOR-NATURAL
 2-SHOWN WITH, A METRAL 1000 5-ROW, 12MM HEADER,
 WHICH MUST BE ORDERED SEPARATELY
 3-END WALL CAN BE USED ON EITHER SIDE OF HEADER
 4-ENDWALL CAN ALSO BE USED WITH STANDARD METRAL
 5-ROW THICK CARD HEADERS & SHROUDS
 5-REFERENCE PRODUCT SPEC GS-12-199.
 6-THIS TABLE IS NOT A COMPLETE LISTING BUT
 REPRESENTS APPLICABLE PRODUCT OFFERINGS.
 FOR OTHER PRODUCT OFFERINGS, CONTACT YOUR
 LOCAL FCI OFFICE.

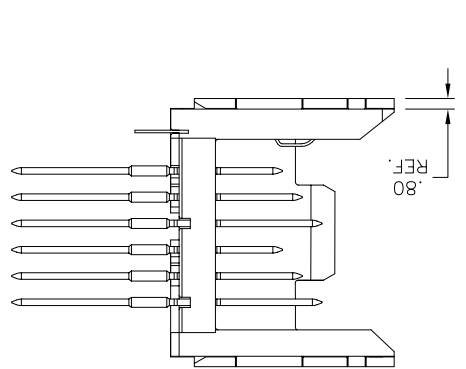
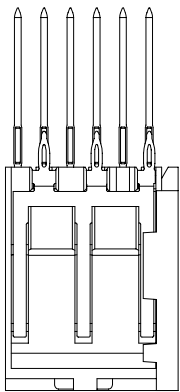

matl. code	surface	ISO 1302	tolerance	ISO 406	ISO 1101	projection	product family	METRAL ACC.
itr	ecn no	dr	date	tolerances unless otherwise specified			title	MM
							HEADER/SHROUD	scale 1:1
							END WALL	dwg no
							73996	sheets of 3 size
							A3	type
							Product Customer Drawing	
sheet	revision							
index	sheet							

73996-012

HEAD P/N	84881
SHROUD P/N	84882
	84809
	84811

6 -012 CAN BE APPLIED TO:

6
D
C
B
A
6

X-ON Electronics

Largest Supplier of Electrical and Electronic Components

Click to view similar products for [High Speed/Modular Connectors](#) category:

Click to view products by [Amphenol](#) manufacturer:

Other Similar products are found below :

[2332816-1](#) [89006-1137LF](#) [650827-1](#) [65762-001LF](#) [73474-201LF](#) [74040-1346](#) [74075-0267](#) [88911-201LF](#) [9514M0C20D](#) [1410191-1](#)
[1410337-1](#) [1410368-3](#) [1410964-2](#) [1410326-3](#) [1410367-3](#) [1410971-4](#) [1467833-1](#) [2000877-1](#) [2000878-1](#) [2041314-1](#) [2065387-1](#) [2187307-1](#)
[2187462-1](#) [2226278-6](#) [KA81-07](#) [91290-101LF](#) [1934290-1](#) [2000875-1](#) [2065917-1](#) [2102736-2](#) [FSR-40](#) [2169868-2](#) [2226279-2](#) [22354-8](#) [437-](#)
[5040-000](#) [5-1393565-0](#) [532449-3](#) [532803-2](#) [34745-0001](#) [0740618502](#) [0760151403](#) [0760551105](#) [0760551608](#) [0761451128](#) [0761651124](#)
[0761655108](#) [0761659807](#) [0769853208](#) [0736440217](#) [0758324203](#)