



**ELECTRONICS, INC.**  
 44 FARRAND STREET  
 BLOOMFIELD, NJ 07003  
 (973) 748-5089

## NTE5318 thru NTE5320 Single Phase Bridge Rectifier 4 Amp

**Features:**

- Ideal for Printed Circuit Board
- Surge Overload Rating: 200A (Peak)

**Maximum Ratings and Electrical Characteristics:** ( $T_A = +25^\circ\text{C}$  unless otherwise specified. Single Phase, Full Wave, 60Hz, Resistive or Inductive Load. For Capacitive Load, Derate Current by 20%)

Maximum Recurrent Peak Reverse Voltage,  $P_{RV}$

NTE5318 .....	200V
NTE5319 .....	600V
NTE5320 .....	1000V

Maximum RMS Bridge Input Voltage,

NTE5318 .....	140V
NTE5319 .....	420V
NTE5320 .....	700V

Maximum DC Blocking Voltage,

NTE5318 .....	200V
NTE5319 .....	600V
NTE5320 .....	1000V

Maximum Average Forward Output Current ( $T_A = +50^\circ\text{C}$ ),  $I_{F(AV)}$  ..... 4A

Peak Forward Surge Current,  $I_{FSM}$   
 (8.3ms Single Sine-Wave Superimposed on Rated Load) ..... 200A

Maximum Forward Voltage Drop (Per Bridge Element,  $I_F = 3A$ ),  $V_F$  ..... 1.0V

Maximum Reverse Current (at Rated DC Blocking Voltage per Element),  $I_R$   
 $T_A = +25^\circ\text{C}$  ..... 10 $\mu$ A  
 $T_A = +100^\circ\text{C}$  ..... 1mA

Operating Junction Temperature Range,  $T_J$  .....  $-55^\circ$  to  $+125^\circ\text{C}$

Storage Temperature Range,  $T_{stg}$  .....  $-55^\circ$  to  $+150^\circ\text{C}$

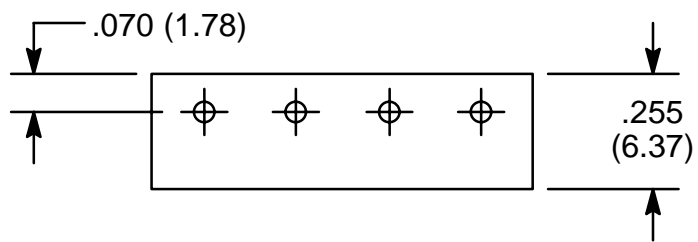
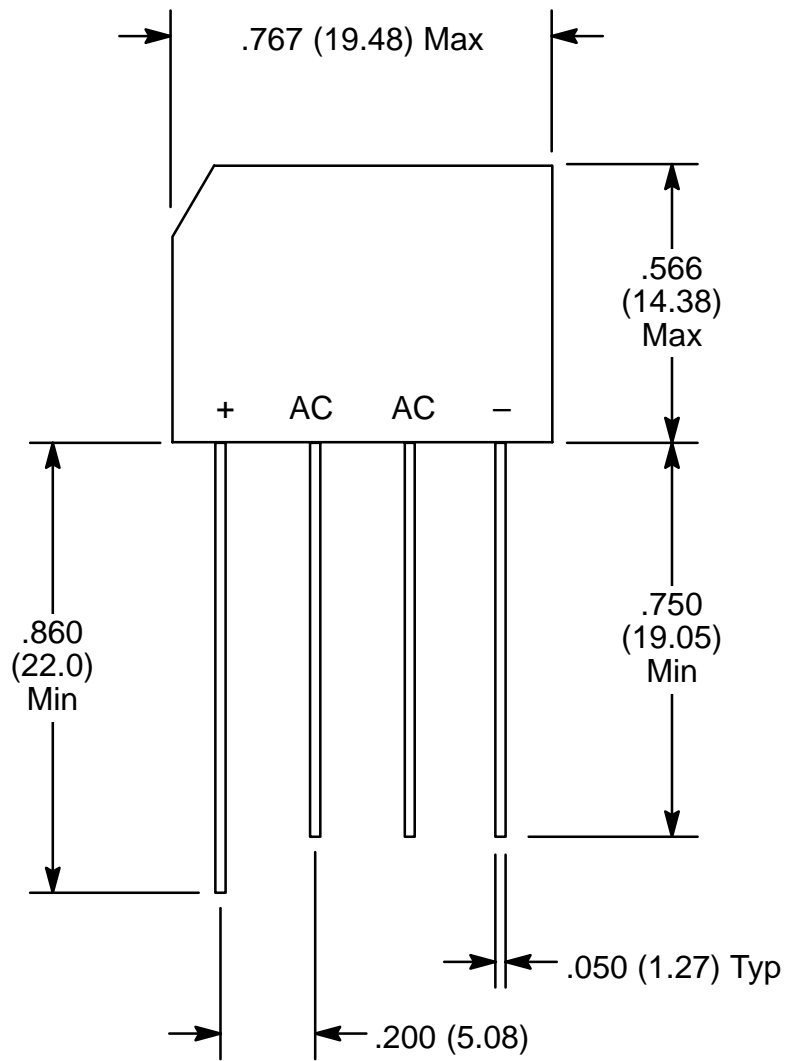

## X-ON Electronics

Largest Supplier of Electrical and Electronic Components

*Click to view similar products for [Bridge Rectifiers](#) category:*

*Click to view products by [NTE](#) manufacturer:*

Other Similar products are found below :

[G3SBA60-E351](#) [GBJ1504-BP](#) [GBU10B-BP](#) [GBU15J-BP](#) [GBU15K-BP](#) [GBU4A-BP](#) [GBU4D-BP](#) [GBU6B-E3/45](#) [GSIB680-E3/45](#) [DB101-BP](#) [DF10SA-E345](#) [RMB2S](#) [RCG](#) [APT30DF100HJ](#) [APT60DF20HJ](#) [B2S-E3/80](#) [BU1506-E351](#) [BU15085S-E345](#) [BU1508-E3/45](#) [BU1510-E3/45](#) [RS404GL-BP](#) [RS405GL-BP](#) [G3SBA20-E3/51](#) [G5SBA20-E3/51](#) [G5SBA60-E3/51](#) [GBJ1502-BP](#) [GBL02-E351](#) [GBL10-E3/45](#) [GBU10J-BP](#) [GBU4J-BP](#) [GBU4K-BP](#) [GBU8B-E3/45](#) [GBU8D-BP](#) [GBU8J-BP](#) [GSIB1520-E3/45](#) [MB1510](#) [MB352W](#) [MB6M-G](#) [B2M-E345](#) [B40C7000A](#) [B500C7000A](#) [MP5010W-BP](#) [MP501W-BP](#) [MP502-BP](#) [BR1005-BP](#) [BR101-BP](#) [BU1006-E345](#) [BU12065S-E3/45](#) [BU1508-E3/51](#) [BU2006-E3/45](#) [BU2008-E345](#)