

Plastic bodied compact limit switches

Combi C2

For confined spaces
 With two mounting options
 Protection class IP 30
 With snap-shut, hinged lid



- Compact switches for safety or control applications
- 3 different contact configurations available as slow-action and snap-action
- All normally-closed contacts are positive break ⊕
- Two channel safety control possible
- Galvanically isolated terminals, type Zb
- Approvals UL, CSA, BG (applied for)
- Rectangular cable inlets (8.5 x 3.5 mm) for 4 x 1-mm² flexible lead
- 4 screw-type connections (M3,5) with self-lifting clamps
- PBT enclosure, glass-fibre reinforced, self-extinguishing UL 94-V0
- Lid, PC UL 94-V0
- 2 mm contact opening of slow-action system according to EN 81-1 for lift applications

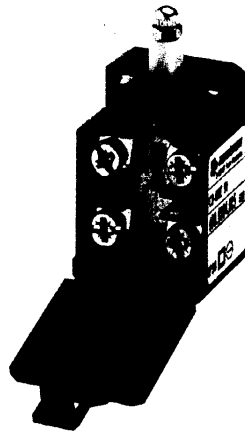

Mounting

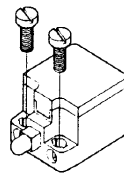

a) 2 holes for M4 screws

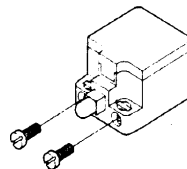

b) 2 captive M3 nuts for end mounting (depending on type)

Switching elements

| Switching element | Switch function | Switch contact | Designation | Voltage | Continuous current |
|-------------------|-----------------|----------------|-------------|---------|--------------------|
| Slow-action | changeover | 1NC/1NO | U1Z | 250 V | 10 A |
| Snap-action | changeover | 1NC/1NO | SU1Z | 250 V | 10 A |
| Slow-action | normally-closed | 2NC | A2Z | 250 V | 10 A |
| Snap-action | normally-closed | 2NC | SA2Z | 250 V | 10 A |
| Slow-action | normally-open | 2NO | E2 | 250 V | 10 A |
| Snap-action | normally-open | 2NO | SE2 | 250 V | 10 A |



Designation

Part no.

Switching diagram

⊕ positive break according to IEC 947-5-1 Chap. 3

Za: changeover contact is not galvanically isolated

Zb: changeover contact is galvanically isolated

Slow-action contact/snap-action contact

Gasket inside (rw)/outside (w)

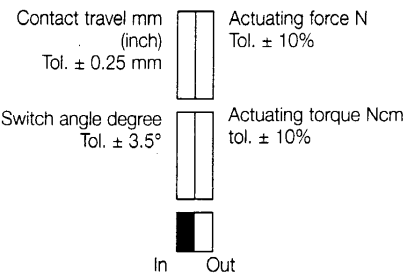

Voltage max.
 Continuous current max.
 Making current, acc. to IEC 947-5-1 AC 15/DC 13

Switching frequency max.
 Mech. operational life - number of switching cycles
 Ambient temperature min./max.

Approvals

(applied for)

Weight

Type of storage/time of delivery as agreed

Further switching functions

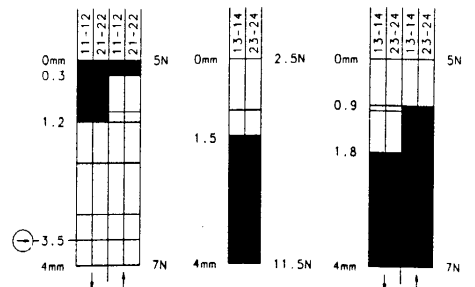
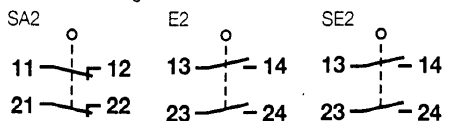

Dimensions

All dimensions in mm (inch)

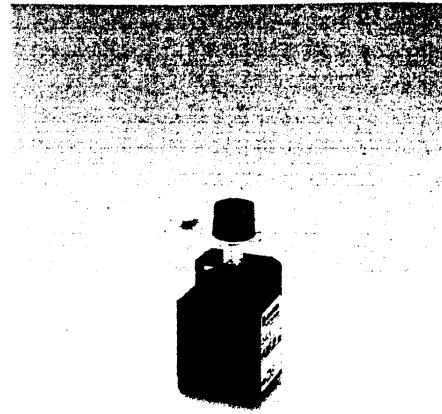
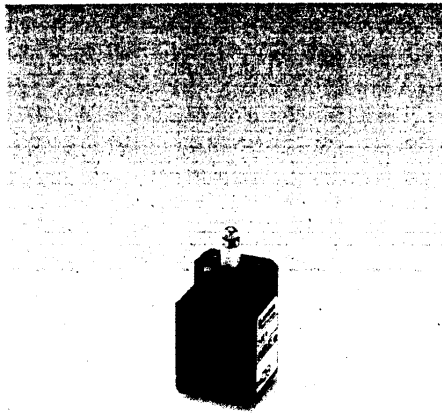
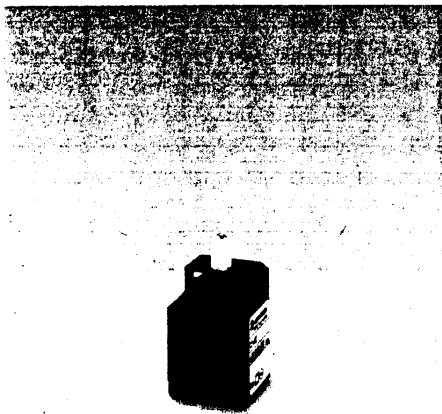

| | | | | | | | | |
|------------------------|-------------------------|------------------------|---------------------------|----------------------------|---------------------------|--------------------------|---------------------------|--------------------------|
| C2-U1Z 600.8101.001 | C2-SU1Z 600.8351.002 | C2-A2Z 600.8801.003 | C2-U1Z St 600.8104.025 | C2-SU1Z St 600.8354.026 | C2-A2Z St 600.8804.027 | C2-U1Z K 600.8107.019 | C2-SU1Z K 600.8357.020 | C2-A2Z K 600.8807.021 |
| | | | | | | | | |
| ⊕ Zb ●/- -/- | ⊕ Zb -/● -/- | ⊕ Zb ●/- -/- | ⊕ Zb ●/- -/- | ⊕ Zb -/● -/- | ⊕ Zb ●/- -/- | ⊕ Zb ●/- -/- | ⊕ Zb -/● -/- | ⊕ Zb ●/- -/- |

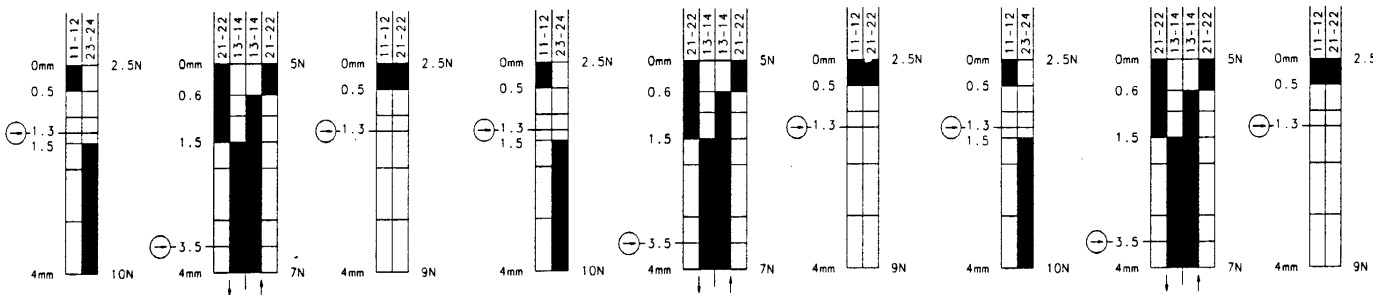

| | | | | | | | | |
|--|--|--|--|--|--|--|--|--|
| 250 V AC 10 A ● | 250 V AC 10 A ● | 250 V AC 10 A ● | 250 V AC 10 A ● | 250 V AC 10 A ● | 250 V AC 10 A ● | 250 V AC 10 A ● | 250 V AC 10 A ● | 250 V AC 10 A ● |
| 100/min. 3 x 10 ⁶ -30 °C/+80 °C -22 °F/+176 °F | 100/min. 3 x 10 ⁶ -30 °C/+80 °C -22 °F/+176 °F | 100/min. 3 x 10 ⁶ -30 °C/+80 °C -22 °F/+176 °F | 100/min. 3 x 10 ⁶ -30 °C/+80 °C -22 °F/+176 °F | 100/min. 3 x 10 ⁶ -30 °C/+80 °C -22 °F/+176 °F | 100/min. 3 x 10 ⁶ -30 °C/+80 °C -22 °F/+176 °F | 100/min. 3 x 10 ⁶ -30 °C/+80 °C -22 °F/+176 °F | 100/min. 3 x 10 ⁶ -30 °C/+80 °C -22 °F/+176 °F | 100/min. 3 x 10 ⁶ -30 °C/+80 °C -22 °F/+176 °F |

| | | | | | | | | |
|---------------------------------|---------------------------------|---------------------------------|---------------------------------|---------------------------------|---------------------------------|---------------------------------|---------------------------------|---------------------------------|
| UL, CSA BG 0.02 kg ●/- | UL, CSA BG 0.02 kg ●/- | UL, CSA BG 0.02 kg ●/- | UL, CSA BG 0.02 kg ●/- | UL, CSA BG 0.02 kg ●/- | UL, CSA BG 0.02 kg ●/- | UL, CSA BG 0.02 kg ●/- | UL, CSA BG 0.02 kg ●/- | UL, CSA BG 0.02 kg ●/- |
|---------------------------------|---------------------------------|---------------------------------|---------------------------------|---------------------------------|---------------------------------|---------------------------------|---------------------------------|---------------------------------|

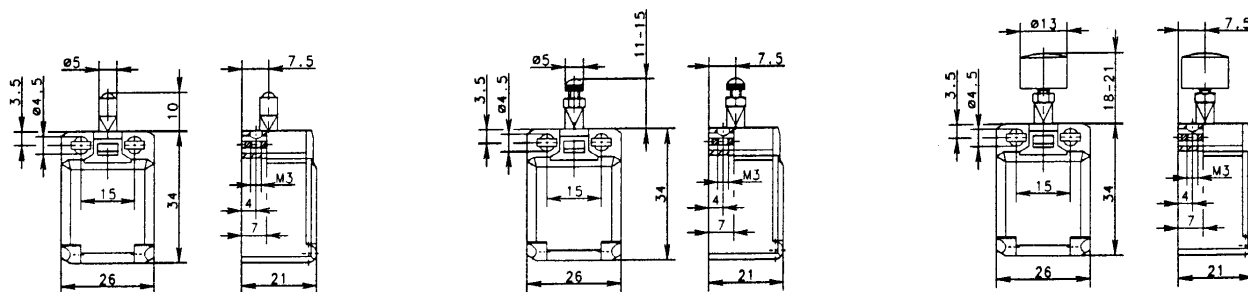

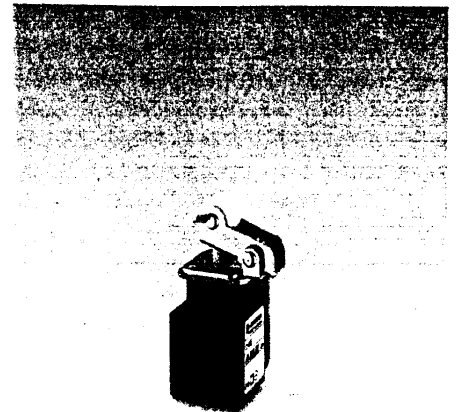
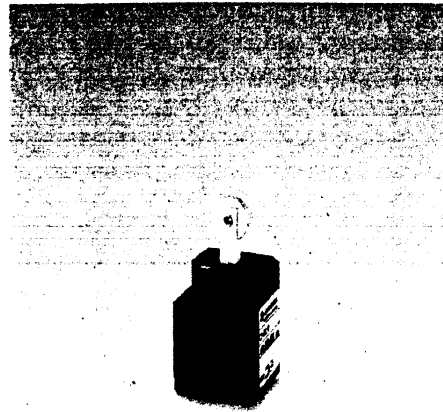

Designation

Switch part number

Actuator part number

Switching diagram

⊕ positive break according to IEC 947-5-1 Chap. 3

Za: changeover contact is not galvanically isolated

Zb: changeover contact is galvanically isolated

Slow-action contact/snap-action contact

Gasket inside (iw)/outside (w)

| C2-U1Z R | C2-SU1Z R | C2-A2Z R | C2-U1Z o.M.+H | C2-SU1Z o.M.+H | C2-A2Z o.M.+H |
|---------------------|---------------------|---------------------|---------------------|---------------------|---------------------|
| 600.8116.013 | 600.8366.014 | 600.8816.015 | 600.8101.007 | 600.8351.008 | 600.8801.009 |
| - | - | - | 391.0190.259 | 391.0190.259 | 391.0190.259 |
| | | | | | |
| ⊕ Zb | ⊕ Zb | ⊕ Zb | Zb | Zb | Zb |
| ●/- | -/● | ●/- | ●/- | -/● | ●/- |
| -/- | -/- | -/- | -/- | -/- | -/- |

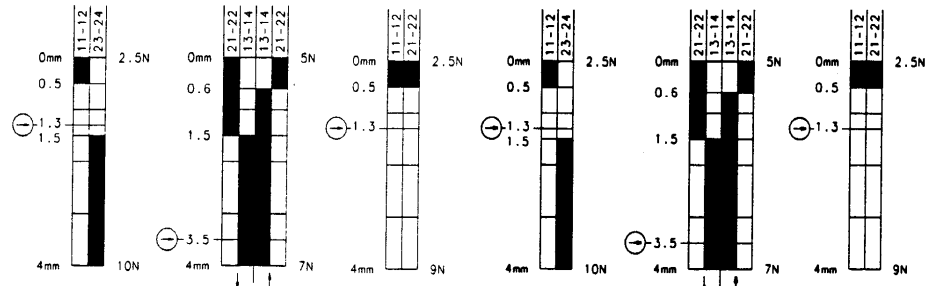
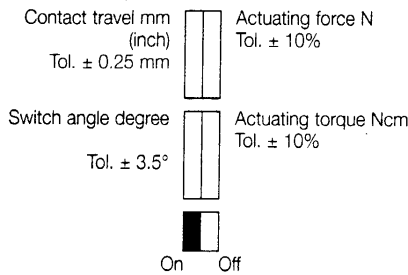

Voltage max. 250 V AC
 Continuous current max. 10 A
 Making current, acc. to IEC 947-5-1 AC 15/DC 13

| | | | | | |
|----------|----------|----------|----------|----------|----------|
| 250 V AC | 250 V AC | 250 V AC | 250 V AC | 250 V AC | 250 V AC |
| 10 A | 10 A | 10 A | 10 A | 10 A | 10 A |
| ● | ● | ● | ● | ● | ● |

Switching frequency max. 100/min.
 Mech. operational life – number of switching cycles 3 x 10⁶
 Ambient temperature min./max. -30 °C/+80 °C

| | | | | | |
|---------------------|---------------------|---------------------|---------------------|---------------------|---------------------|
| 100/min. | 100/min. | 100/min. | 100/min. | 100/min. | 100/min. |
| 3 x 10 ⁶ | 3 x 10 ⁶ | 3 x 10 ⁶ | 3 x 10 ⁶ | 3 x 10 ⁶ | 3 x 10 ⁶ |
| -30 °C/+80 °C | -30 °C/+80 °C | -30 °C/+80 °C | -30 °C/+80 °C | -30 °C/+80 °C | -30 °C/+80 °C |
| -22 °F/+176 °F | -22 °F/+176 °F | -22 °F/+176 °F | -22 °F/+176 °F | -22 °F/+176 °F | -22 °F/+176 °F |

Approvals (applied for)

Weight

Type of storage/time of delivery as agreed

| | | | | | |
|---------|---------|---------|---------|---------|---------|
| UL, CSA | UL, CSA | UL, CSA | UL, CSA | UL, CSA | UL, CSA |
| BG | BG | BG | BG | BG | BG |
| 0.02 kg | 0.02 kg | 0.02 kg | 0.03 kg | 0.03 kg | 0.03 kg |
| ●/- | ●/- | ●/- | ●/- | ●/- | ●/- |

Further switching functions

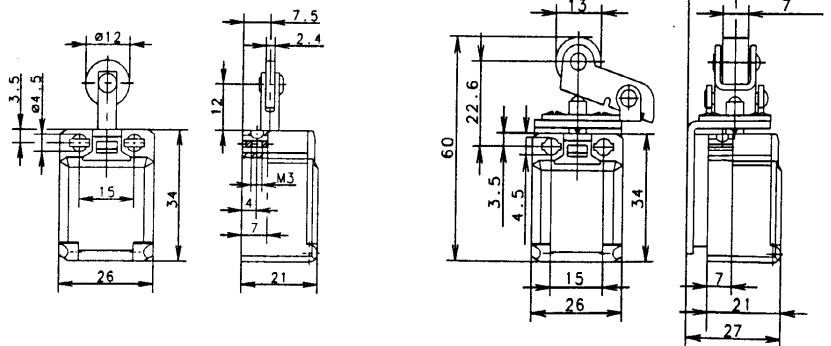
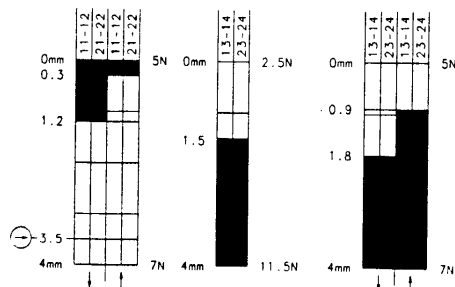
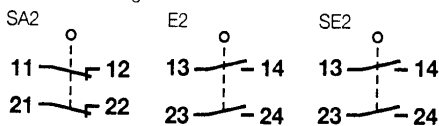

Dimensions

All dimensions in mm (inch)

X-ON Electronics

Largest Supplier of Electrical and Electronic Components

Click to view similar products for [Limit Switches](#) category:

Click to view products by [Bernstein](#) manufacturer:

Other Similar products are found below :

[6LS2-4PG](#) [5ML1-E1](#) [5ML31](#) [LZG1](#) [LZL1-6C](#) [622EN114-R](#) [622EN18-6](#) [622EN224-6B](#) [622EN230](#) [622EN237-R](#) [622EN69-3](#) [622EN85-RB](#)
[MA-10019](#) [6PA109](#) [7LS51](#) [83547001](#) [83725002](#) [83830001](#) [83840001](#) [83840701](#) [83841001](#) [83870104](#) [83881140](#) [8AS42](#) [8LS10](#) [8LS125-](#)
[4PG](#) [8LS152-4PGN20](#) [914CE16-3A](#) [914CE16-AQ](#) [914CE3-3L1](#) [915PA10](#) [91MCE16-P2O](#) [924CE16-Y3](#) [924CE1-S6](#) [924CE1-T25A](#)
[924CE1-T3](#) [924CE1-T9A](#) [924CE2-T9](#) [924CE31-Y20-X5](#) [924CE31-Y3L1](#) [GL-10054](#) [GL-85710](#) [GL-85714](#) [GLAB26J2B](#) [GLDB03C-6](#)
[GLZ324](#) [PS21R-NT11N7-YK0](#) [D4A-1106N](#) [D4A1201N](#) [D4A-3E02N](#)