



SOCKETS FOR C3 RELAYS

- Built in retaining clip
- Removable label marking facility
- Coding ring compatible
- One or two level terminals
- DIN rail, solder tag or PCB mount



S3-B One level. Integrated clip and marking label

Accepts the exclusive Releco coding ring for coding both the relay and base. DIN rail or panel mountable. Removable label. EN/DIN and sequential numbering. According to EN60947

Wiring diagram

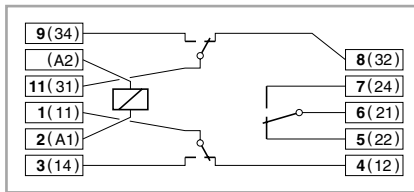

Specifications

Nominal load 10A/250V
 Dielectric strength (adjacent screws) 2,5 KV
 Dielectric strength (screws/rail) 2,5 KV
 Max. screw torque 1,2 Nm
 Screw dimensions M3, Pozi
 Wire in-lets capacity:
 Solid wire 4 mm² or 2 x 2,25 mm²
 Multi-core 22 - 14 AWG

S3-S Two level. Integrated clip and marking label

Accepts the exclusive Releco coding ring for coding both the relay and base. DIN rail or panel mountable. Removable label. EN/DIN and sequential numbering. According to EN60947

Wiring diagram

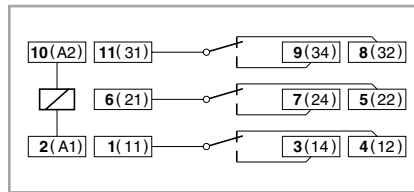

Specifications

Nominal load 10A/250V
 Dielectric strength (adjacent screws) 2,5 KV
 Dielectric strength (screws/rail) 2,5 KV
 Max. screw torque 1,2 Nm
 Screw dimensions M3, Pozi
 Wire in-lets capacity:
 Solid wire 4 mm² or 2 x 2,25 mm²
 Multi-core 22 - 14 AWG

S3-L S3-PO 8 pin, solder and printed circuit tags

S3-L Flange panel mountable.

S3-PO Printed circuit tags with flange.

Printed circuit lay-out

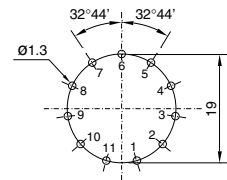

Specifications

Nominal load 10 A/250 V
 Dielectric strength (adjacent pin) 2,5 KV
 Hard brass, tin-plated terminals

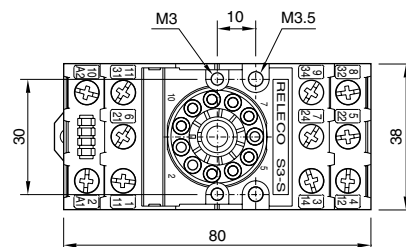
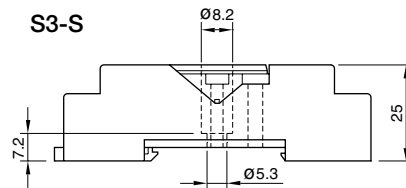
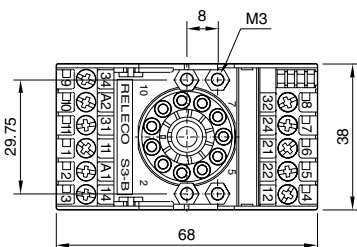
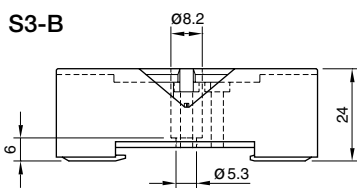
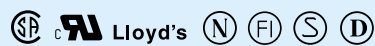

S3-L S3-PO

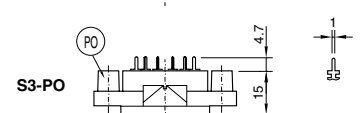
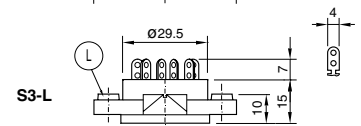
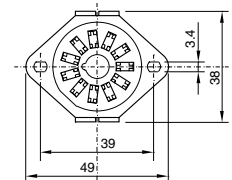

S3-BC Coding Ring

Can be used to code a specific relay to fit a specific socket up to 11 combinations. Supplied in a pack of 5 pieces.

X-ON Electronics

Largest Supplier of Electrical and Electronic Components

Click to view similar products for [releco](#) manufacturer:

Other Similar products are found below :

[S-12](#) [S2B + S2BC](#) [C10A10X230A](#) [C3-A30X24D](#) [C12A21BX24AD](#) [C2-A20X230A](#) [C7-A20X24D](#) [C4-A40X230A](#) [S4-B+S3-C](#)
[C10A10X24D](#) [S9-M](#) [C4-A40X24D](#) [C9-A41X115A](#)