

3900 Splashproof Metal Lever Switches 16A 250Vac



16(4)A 250Vac T85 (3900 & 3950)
 10(4)A 250Vac T85 (All other circuits)
 UL CSA 20A 125/277Vac (ON-OFF Circuits)
 UL CSA 16A 125/277Vac (Other Circuits)
 UL CSA 7A 72Vdc, 14A 36Vdc
 UL 250Vac 1hp, 125Vac 1/2hp
 UL 85°C, file E45221, CSA file LR10990

Inrush rating - Contact factory for details

Approvals and ratings vary with function
 3mm contact gap except where marked μ
 Integral O-ring neck seal
 Technical data on pages 4 & 5

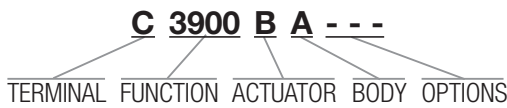

TERMINAL	FUNCTION	ACTUATOR
C 6.3 x 0.8	Single pole 3900 ON - OFF 3901 ON - OFF (momentary ON) 3902 ON - OFF (momentary OFF) 3910 ON - ON 3911 ON - ON (momentary 1 side) 3920 ON - OFF - ON μ 3921 ON - OFF - ON μ (momentary 1 side) 3922 ON - OFF - ON μ (momentary 2 sides)	Double pole 3950 3951 3952 3960 3961 3970 3971 3972
S Screw & clamp available for On - Off switches only		B 17.5 Finish is nickel plate
T 03.1 Solder		



C3900BA ---



C3920BA ---



Guard R17-10
Anti-rotation tab can be specified
for guard fitted in On or Off position



C3950BB ---



C3972BB ---

BODY

A
Without terminal barrier
Single pole

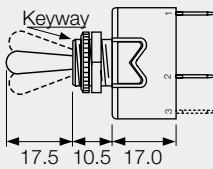

B
With terminal barrier
Double pole only

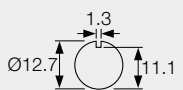
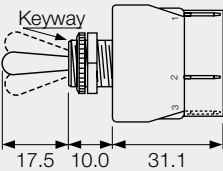

Panel hole (all types)

OPTIONS

Neck Seal M539

Actuator is visible



Cover M1080



Covers have internal nylon nuts

Fixing nuts

Nickel plated brass are supplied



Hex Back nut



Knurled Front nut

Panel thickness 4.0 with backnut

DIMENSIONS (mm) * Indicates ON position (for On - Off switches)

Single Pole

(C terminals shown)

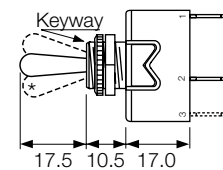
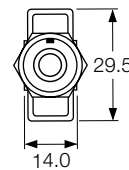

Optional
P232 plate
SP or DP

Double Pole

(C terminals shown)

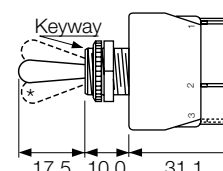
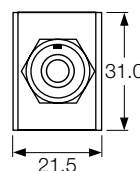

X-ON Electronics

Largest Supplier of Electrical and Electronic Components

Click to view similar products for [Toggle Switches](#) category:

Click to view products by [Arcoelectric](#) manufacturer:

Other Similar products are found below :

[A19HV](#) [8A1-C-222](#) [60012L](#) [6006L](#) [6663](#) [7101MD9V30GE](#) [7101SPDV30BE](#) [7103SDV30BE](#) [7105D](#) [7108P3YAV2BE](#) [71YY50282](#)
[7201MD9AVBE](#) [7301K38](#) [7306K36](#) [7310K36](#) [7314K36](#) [7506K4](#) [7592K6](#) [7691K14](#) [7700K1](#) [8396K108](#) [8824K14](#) [8828K13](#) [G2VX](#) [G3VX](#)
[PS83-121G](#) [A101MD9AB04](#) [A101SD9AB04](#) [A101SDCQ04](#) [A103SD9AQ04](#) [A107TZB04](#) [A123P32YZQ](#) [A123S1YZG](#) [A127S1YCQ](#) [1-](#)
[1825192-0](#) [A131S1YZQ](#) [A201SCWZB04](#) [A207SYCB04](#) [A208J61ZQ0004](#) [A221K12KAG](#) [A221S1YZQ](#) [A221T1TCQ](#) [A232K12KZQ](#)
[A232M1YCQ](#) [A323S1CWZQ](#) [A423S1CWZG-M8](#) [A423S1YZQ](#) [12149A-3V](#) [12156AX408](#) [12147AGKX679](#)