

FIO 427330

CUSTOMER  
 MH CONNECTORS LTD  
 P/NO. DIP-IEC6L-BK

TOOL:  
 CAST ALUMINIUM

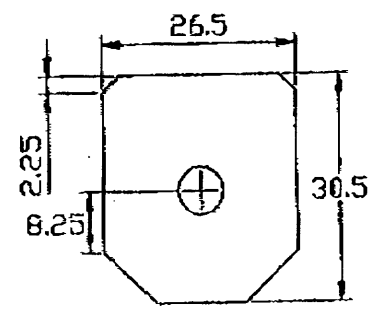
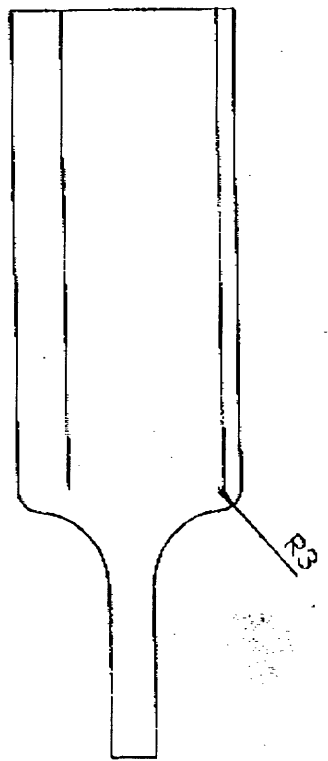
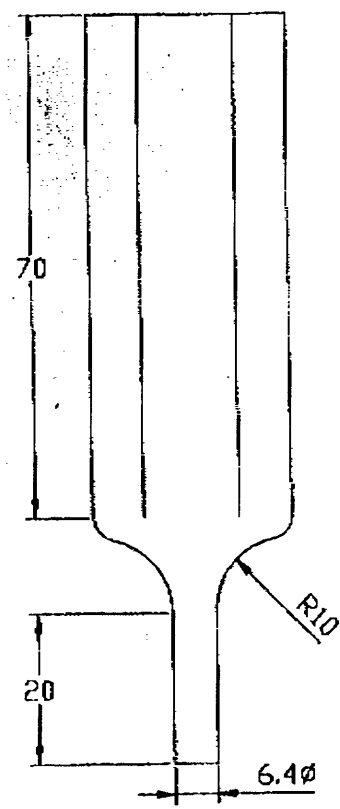
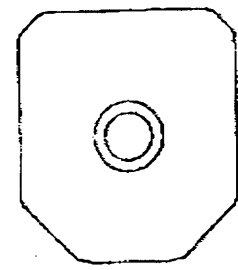

WALL THICKNESS  
 1.4mm AT DIP LINE

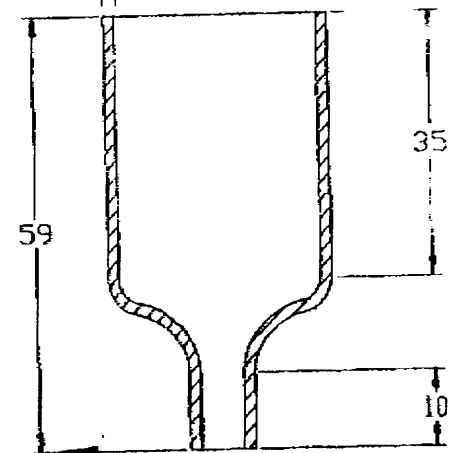

RECEIVED  
 27 JUL 1998  
 SHEET 1

CPL  
 3

General tolerance unless otherwise stated

<p>The contents of this drawing must not be used for any purpose without prior written permission from the company.</p>	<p>TITLE          BOOT          60 SHORE FR          BLACK</p>	<p>TOOL</p>	<p>MOULDING</p>	<p>PROD ISS 2 DC11/11/9</p>
		<p>Linear <math>\pm 0.25</math>          Diameter <math>\pm 0.2</math>          Concentricity <math>\pm 0.2</math>          Angular <math>\pm 0.5</math> Degrees          REMOVE ALL BURRS &amp; SHARP CORNERS TO:          MIN 1.0 45 DEGREES          MIN 2.0 RADIUS</p>	<p>WALL THICKNESS - 0.5 + 1.0          AT DIP LINE          DIPPED LENGTH <math>\pm 1.5</math>          TRIMMED LENGTH - 0.5 + 1.5</p>	<p>DESIGNATION          APPROVED</p>

## **X-ON Electronics**

Largest Supplier of Electrical and Electronic Components

*Click to view similar products for [mckee hagborg](#) manufacturer:*

Other Similar products are found below :

[DIP-IMI3A-BK](#) [DIP-IEC6L-BK](#)