

# Expansion-Sert™

Unheaded (UHBRXP) Headed (HDBRXP) Reverse Headed (RVBRXP)

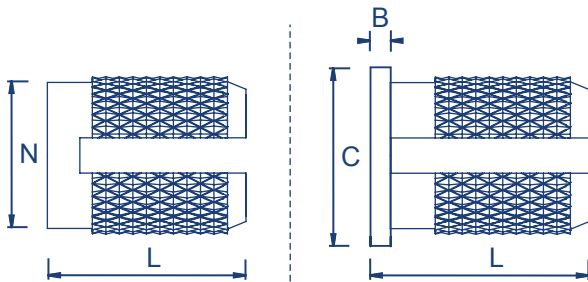

## Brass/Self Colour



## Metric Dimensions

Thread size	Metric	M2*	M2.5*	M3	M3.5	M4	M5	M6	M8*
L mm		3.9	4.7	4.7	6.3	7.9	9.4	12.6	12.6
B mm		0.43	0.51	0.51	0.66	0.82	0.99	1.25	1.25
C mm		4.8	5.5	5.5	6.4	7.1	7.9	9.5	11.1
N max mm		3.2	4.0	4.0	4.7	5.5	6.3	7.9	9.5
Recommended Hole Size mm (-0.0/+0.1)		3.2	4.0	4.0	4.8	5.6	6.4	8.0	9.6
Minimum Wall Thickness mm		2.4	3.2	3.2	3.6	4.0	4.8	6.0	7.0

### \*Non preferred - Please enquire for availability

Non standard lengths and stud versions available on request  
Unified price and delivery available upon request

## Expansion-Sert™ Information for designers

The Expansion-Sert™ is a press-in insert, designed for post mould installation into thermosets. The knurl pattern makes this insert ideal for hard thermosets.

### Advantages:

- Simple, press-in installation
- Provides self-locking action on mating screw
- Good pull out and torque resistance

### Installation Data

The Expansion-Sert™ should be installed with a press that can provide a steady squeezing action to prevent damage to the mating boss. It is important that the mating screw fully penetrates the insert to achieve full expansion and optimum pull-out resistance.

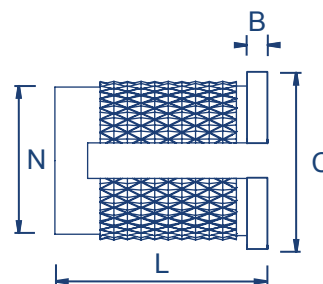

Reverse Headed Expansion-Sert™ - RVBRXP

## Prefix & Suffix Ordering

*\*For thread size, please refer to the first characters prior to the “-“ on the part number (i.e. M2, M2.5, etc.)*

*\*SF part number suffix relates to Self Finish*

## Prefix & Suffix Ordering

*\*For thread size, please refer to the first characters prior to the “-“ on the part number (i.e. M2, M2.5, etc.)*

*\*SF part number suffix relates to Self Finish*

## Prefix & Suffix Ordering

*\*For thread size, please refer to the first characters prior to the “-“ on the part number (i.e. M2, M2.5, etc.)*

*\*SF part number suffix relates to Self Finish*

## X-ON Electronics

Largest Supplier of Electrical and Electronic Components

*Click to view similar products for [tr fastenings manufacturer](#):*

Other Similar products are found below :

[3.030PRST30TC1D](#) [5.020PRST30TC1D](#) [N80.750 PRA2ABS100-](#) [M840 KHHTMCS50-](#) [M830 SOHTCSZ50-](#) [M660 SOHTCSS100-](#) [M620 SOHTCSS100-](#) [M612 KHHTMCZ50-](#) [M610 HHA2SCS100-](#) [M620 KHA2MCS50-](#) [M540 PSSTMCZ100-](#) [M516 PSSTMCZ100-](#) [M525 SOHTCSZ100-](#) [M520 PSSTMCZ100-](#) [M510 KHHTMCZ50-](#) [M4- FABRWAN100-](#) [M440 SOA2CSS50-](#) [M430 SOHTCSZ100-](#) [M3- DNST-Z100-](#) [M26 HSHTPCS25-](#) [M1025 SOHTCSZ50-](#) [TRRLCBSR-7-01](#) [M46PTSTMCZ100-](#) [M412PSSTM CB100-](#) [M6 40 HH88BL Z100](#) [M4 25 M4A2MC S50 BUT T20](#) [M6 16 M4A2MC S50 BUT T30](#) [H0.250 25 M4STPB SF T25](#) [H0.250 M7STPB SF HEX 4.0 W/M8/REDE/OE/ST/KG](#) [W/M6/REDE/OE/ST/PG](#) [W/M5/FLG/CE/ST/KG](#) [N61.250 PRA2ABS100-](#) [M8 8 HSHTKC SF -](#) [N81.250 PRA2ABS100-](#) [TRFAKIT0009](#) [M830 SOHTCSS100-](#) [M820 SOHTCSS100-](#) [M6- N5A4-S50-](#) [M680 SOHTCSS100-](#) [M610 HHHTSCZ100-](#) [M6- DNST-Z100-](#) [M620 PRSTM CB100-](#) [M550 PSSTMCZ100-](#) [M516 PRA2MCS100-](#) [M512 BHHTMCS100-](#) [M530 SOHTCSZ100-](#) [M520 HHHTSCZ100-](#) [M4- DNST-Z100-](#) [M425 PSSTMCZ100-](#)