

3M™ Specialty Terminals

60-SN-A, 61-SN-A, 62-SN-A, 63-SN-A

Butt Connector, Nylon Insulated,
Seamless

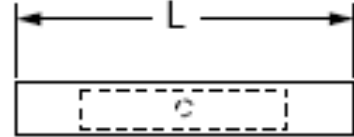

Data Sheet

May 2008

| Product Number | AWG (mm ²) Wire Range O.D. | L | Thickness | Barrel Length | Barrel I.D. | Maximum Insulation Diameter |
|----------------|--|------|-----------|---------------|-------------|-----------------------------|
| *60-SN-A | 26 – 24 | 0.79 | .025 | .20 | .050 | .08 |
| 61-SN-A | 22 – 18 | 1.08 | .034 | .26 | .065 | .12 |
| 62-SN-A | 16 – 14 | 1.08 | .034 | .26 | .090 | .15 |
| 63-SN-A | 12 -1 0 | 1.08 | .041 | .33 | .135 | .21 |

*Not UL Listed

Specifications

| | |
|--------------------------------|---|
| Wire Size: | See Table Above |
| Barrel Seam: | Seamless |
| Insulator Max. Voltage Rating: | 600 V Building Wire or 1000 Volts Signs or Fixtures (Luminaires) |
| Maximum Operating Temp: | 221°F (105°C) |
| Maximum Current: | Same as Wire |
| Insulator Material: | Nylon |
| Terminal Material: | Copper |
| Terminal Planting: | Tin |

Agency Approval
Self Certification

UL Listed 20U0 wire connector.



3M

Installation Information

WARNING

Turn power off before installing or removing terminal. All electrical work should be done according to appropriate electrical codes.

UL Listed for use on stranded copper (AWG) wire only.

Strip Length:
26-14 AWG – 5/16 in. Max.
12-10 AWG - 3/8 in. Max

Make the crimp in the proper station of a recommended 3M™ Scotchlok™ Crimp Tool: TR-490 (ratchet style) hand tools.

For the 60-SN-A, use the 3M™ Scotchlok™ Crimp Tool TH-450.



 Barrel Crimp (Required)

Engineering Specification

The connector line shall offer barrel variations in wire (AWG) size (26-24, 22-18, 16-14, 12-10) and construction (non-insulated brazed seam, vinyl insulated butted seam, nylon insulated seamless, etc.) The connector line shall have regulatory agency coverage (UL Listing).

The 3M™ Nylon Insulated Seamless Butt Connector shall be tin-plated, copper, having a double-length, round seamless barrel, with a center stop and a close fitting nylon tube covering, color coded and sized for a specified (AWG) wire range (26-24, 22-18, 16-14 and 12-10).

Insulated connectors shall be UL Listed for 600 volts maximum for building wire, 1000 volts maximum for signs or fixtures, and temperature rated 221°F (105°C) maximum.

Important Notice

All statements, technical information, and recommendations related to 3M's products are based on information believed to be reliable, but the accuracy or completeness is not guaranteed. Before using this product, you must evaluate it and determine if it is suitable for your intended application. You assume all risks and liability associated with such use. Any statements related to the product which are not contained in 3M's current publications, or any contrary statements contained on your purchase order shall have no force or effect unless expressly agreed upon, in writing, by an authorized officer of 3M.

Warranty; Limited Remedy; Limited Liability:

This product will be free from defects in material and manufacture from the time of purchase. **3M MAKES NO OTHER WARRANTIES INCLUDING, BUT NOT LIMITED TO, ANY IMPLIED WARRANTY OF MERCHANTABILITY OR FITNESS FOR A PARTICULAR PURPOSE.** If this product is defective within the warranty period stated above, your exclusive remedy shall be, at 3M's option, to replace or repair the 3M product or refund the purchase price of the 3M product. **Except where prohibited by law, 3M will not be liable for any indirect, special, incidental or consequential loss or damage arising from this 3M product, regardless of the legal theory asserted.**

3M and Scotchlok are trademarks of 3M Company.



Electrical Markets Division
6801 River Place Blvd.
Austin, TX 78726-9000
800 245 3573
FAX 800 245 0329
www.3M.com/electrical

Please recycle.
© 3M 2008 All rights reserved.
78-8126-9699-1_C

X-ON Electronics

Largest Supplier of Electrical and Electronic Components

Click to view similar products for [3m manufacturer](#):

Other Similar products are found below :

[SC401U](#) [98-0003-3071-6](#) [80-0012-6467-2](#) [00-054007-70220-7](#) [00-054007-34717-0](#) [5952-3/4"x15yds](#) [021200-40230](#) [6840-2X50-GRAY](#)
[6A11-A0121-007.0-0](#) [701-W](#) [7993MP-2CIRCLE-100](#) [FDV14-187C](#) [FE-5100-5126-4](#) [FE-5100-5273-4](#) [FE-5100-5492-0](#) [8124/14](#) [812510-100](#)
[8125/17](#) [813216](#) [8204-3LFM](#) [8425-8](#) [MNG14BCX](#) [FP301-1-6"-Clear](#) [FV14-6C](#) [920102-01-25-R](#) [927739-40](#) [929835-01-28-RK](#)
[929974-01-40-R](#) [951240-2520-AR-PR](#) [960X/980X](#) [98-0003-3075-7](#) [HF365/16SF](#) [HF36564-100](#) [HF625/26-30](#) [1/2-5-4492W](#) [1/2-5-5430](#) [1/2-](#)
[5-850S](#) [1/2-5-3431](#) [12X12-6-4056B](#) [12X12-6-433](#) [12X12-6-4930](#) [1311](#) [13-500-NB](#) [14526-EZ5B-300-02C](#) [1-4-4658F](#) [14520-EZAB-300-](#)
[0EC](#) [DSTK9013-3420](#) [DSTK9015-3402](#) [14T26-SZLB-200-0LC](#) [14T50-SZWB-100-0NC](#)