

DLS SERIES INDUSTRIAL

- Background suppression by optical focusing
- Detects objects of any colour, material or shape against similar background
- Powerful beam for good operation even in dirty object, dirty lens conditions
- Relay or solid state output options
- Adjustable range: 0.2m to 1m - DL-S100, 0.2m to 2m - DL-S200, 150mm to 600mm - DL-7050
- IP66 Sealed



TECHNICAL DATA

Type	DLS100P	DLS200P	DL7050	DLS100TC	DLS200TC
Detection	Convergent reflection				
Adjustable Range	0.2 - 1m	0.2 - 2m	150mm - 600mm	0.2 - 1m	0.2 - 2m
Power Supply	24V - 240V AC/DC $\pm 10\%$ 50/60HZ			12 - 24V DC $\pm 10\%$, 10% Max ripple	
Current Consumption	30mA (max) AC, 4W (max) DC			50mA Max	
Output Rating	Relay (3A, 250VAC 750VA) (3A, 30VDC 90W)			NPN/PNP Open collector (100mA, 30VDC Max)	
Operating Mode	Light on - Dark on selectable				
Response Time	20ms (Max)			2ms light on 5ms light off	
Light Source	Infrared LED (880nm)				
Sensing Cell	Half dividing photodiode				
LED IND.	Output=red LED Stability=green LED				
Range	Adjustable Mechanically				
Protection	-			Short Circuit	
Housing	Polycarbonate/Acrylic sealed to IP66				
Connection	Screw Terminals				
Ambient Light	10,000 Lux (Max)				
Operating Temp	-25°C To +55°C				

DIMENSIONS

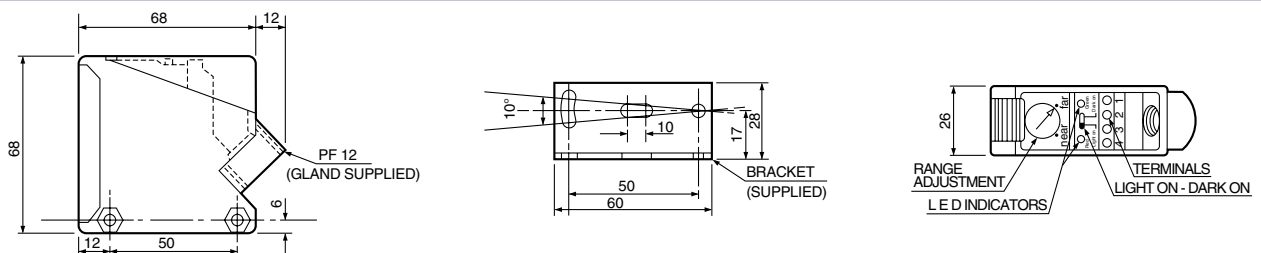

ELECTRICAL CONNECTIONS

Relay Output Types

- DL - S100P
- DL - S200P
- DL-7050

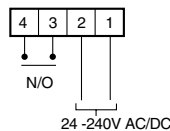

PNP/NPN Output Types

- DL - S100TC
- DL - S200TC

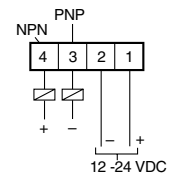

NOTE: Do not use a mirror or reflector as a background

ORDERING GUIDE

Type Number	Description	Range	Output	Type Number	Description	Range	Output
DLS100P	Convergent Reflection	0.2 - 1M	Relay	DLS100TC	Convergent Reflection	0.2 - 1M	PNP/NPN
DLS200P	-	0.2 - 2M	Relay	DLS200TC	-	0.2 - 2M	PNP/NPN
DL7050	-	150 - 600mm	Relay	BG11553X	Connector adaptor M12*		

*For Connector types add -J to the part number. e.g. DLS100P-J. Refer to page 194 for connection details.

X-ON Electronics

Largest Supplier of Electrical and Electronic Components

Click to view similar products for [takex](#) manufacturer:

Other Similar products are found below :

[DL-S200P](#)