



*Products for tomorrow*

Headquarter Europe  
MEDER electronic AG  
Friedrich-List Strasse 6  
D-78234 Engen-Welschingen  
Tel.: +49(0)7733-9487-0  
Fax: +49(0)7733-9487-32  
eMail: [info@meder.com](mailto:info@meder.com)  
Internet: [www.meder.com](http://www.meder.com)

Headquarter USA  
MEDER electronic Inc.  
766 Falmouth Rd  
Mashpee, MA 02649  
Phone: +1/ 508-539-0002  
Fax: +1/ 508-539-4088  
eMail: [salesusa@meder.com](mailto:salesusa@meder.com)

**Magnet:** NdFeB 8,0 x 15,0  
250 / 175h  
**Part Number:** 4003004031

**Dimensions (mm)**

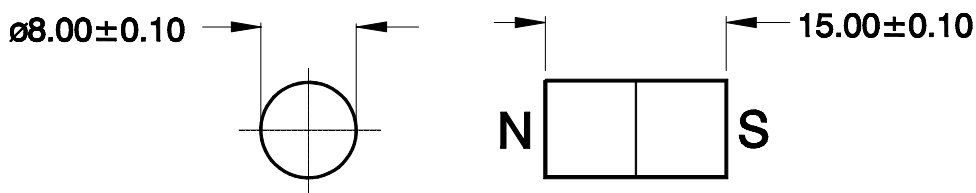

**NdFeB round bar magnet magnetisation axial**

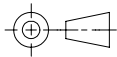

Magnetic values acc. to DIN 17410		Min.	Typ.	Max.	unit
Energy product	(B x H) max.	250	295	-	$\text{kJ/m}^3$
Remanence	$B_r$	1180	1240	-	mT
revers. temp. coeff. of $B_r$		-	-0,1	-	%/K
Coercivity	$H_{cB}$	860	920	-	kA/m
Coercivity	$H_{cJ}$	1750	1900	-	kA/m
revers. temp. toeff. of $H_{cJ}$		-	-0,6	-	%/K
Density		-	7,6	-	$\text{g/cm}^3$
max. operating temperature		-	-	160	$^{\circ}\text{C}$

**Remark :** all details correspond to manufacturers information

Magnetic Moment	M	8,33	8,96	9,59	$\text{X}10^{-5}$ Vs·cm
-----------------	---	------	------	------	----------------------------

**DEFINITION:**

$M = \Phi \cdot K$

$\Phi$  = Magnetic Flux

K = Coil Constant

## X-ON Electronics

Largest Supplier of Electrical and Electronic Components

*Click to view similar products for [standexmeder](#) manufacturer:*

Other Similar products are found below :

[MK18-B-500W](#) [DIP05-1A72-12L](#) [CRF05-1AS](#) [HE06-1B83-150](#) [HE24-1A83](#) [SHV12-1A85-78L3K](#) [SIL05-1A72-71QHR](#) [NDFEB 8X15MM](#)  
[NDFEB N35 4X2MM](#) [BE12-2A85-BV420](#) [KT12-1A-BV88589](#) [MK04-1A66B-500W](#) [DIP05-1A72-13L](#) [HM24-1A69-20-6](#) [HM12-1A83-06-](#)  
[UL](#) [MS05-1A87-75DHR](#) [H12-1B83](#) [KT12-1A-40L-THT](#) [SIL05-1A31-71L](#) [MK06-4-C](#) [LI05-1A85](#) [NDFEB 10X5X1.9MM](#) [LS01-1A66-PP-](#)  
[500W](#) [M11/M8](#) [LS02-1A66-PP-500W](#) [HM24-1A69-300](#) [LS02-1A66-PA-500W](#) [KT05-1A-40L-THT](#) [MK21M-1A66C-500W](#) [DIP24-1C90-](#)  
[51D](#) [SIL24-1A75-71L](#) [DIP12-1A72-12L](#) [ORD211-1015](#) [DIP12-2A72-21L](#) [H24-1A83](#) [MK17-C-3](#) [SHV12-1A85-78L4K](#) [ALNICO500;](#)  
[10X40MM](#) [HE24-1A83-02](#) [MK02/0-1A66-1000W](#) [DIL05-2C90-63L](#) [DIP24-1A72-12L](#) [HM24-1A69-06](#) [HE06-1A16](#) [DIP24-1A31-16D](#)  
[MK03-1A66E-500W](#) [LS01-1A66-PA-500W](#) [ORD228VL-2030](#) [DIP05-1C90-51L](#) [ALNICO500 5X22MM](#)