

# Data Sheet

## RP023xxHBWC

Page 1/4

P/N

311661xx

xx=number of poles

2013/12/05

### Illustration

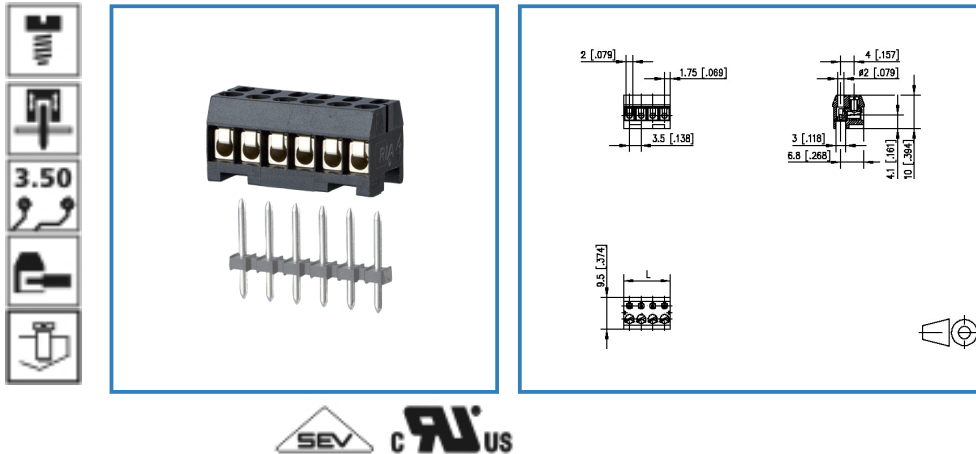

see enlarged drawing at the end of the document

### Product specification

- screw type terminal block, pluggable
- centerline 3.50 mm, direction of connection 90°
- wire protector, fittable without loss of poles
- color black
- Wire entry perpendicular to plug direction
- Connection data

**cRUUS** V / A / AWG 125 / 8 / 28 - 16

**SEV** 6 A / 200 V / 2.5 kV / 3 / IEC 61984 / 0.08 - 1 mm<sup>2</sup>



# Data Sheet

## RP023xxHBWC

Page 2/4

P/N

311661xx

xx=number of poles



2013/12/05

### Technical Data

#### General Data

Tightening torque SEV	0.15 Nm		
Tightening torque UL	3 lb-in		
min. number of poles	2		
max. number of poles	24		
Insulating material class	CTI 600		
clearance/creepage dist.	2 mm		
protection category	IP 00		
Overvoltage category	III	III	II
Pollution degree	3	2	2
Rated voltage	160 V	400 V	400 V
Rated test voltage	2.5 kV	2.5 kV	2.5 kV

#### Connection data

 V / A / AWG	125 / 8 / 28 - 16
	6 A / 200 V / 2.5 kV / 3 / IEC 61984 / 0.08 - 1 mm <sup>2</sup>

#### Material

insulating material	PA66
flammability class	V0
terminal body material	CuZn
terminal body surface	Ni
screw surface	Zn Cr(VI)-frei/free
wire protector material	CuNiZn
screw thread	M2

#### Climatic properties

upper limit temperature	105 °C
lower limit temperature	-40 °C

#### General

Tolerance	ISO 2768 -mH
-----------	--------------

# Data Sheet

## RP023xxHBWC

Page 3/4

P/N

311661xx

xx=number of poles

2013/12/05

### Matching Part

P/N	Product name
312241	PR033xxVBHC Typ 224
312251 (on request)	PT153xxHBEC Typ 225
312261 (on request)	PT153xxVBEC Typ 226
313331 (on request)	PT023xxHBHC
314241	PM013xxVBHC Typ 424

### Accessories

P/N	Product name
720158-01-0 (on request)	F_Befest_165_brg_kurz 1mm
720158-01-2	720158
720158-02-2	720158
720159-01-0 (on request)	F_Kodier_Typ165_brg_kurz
720159-01-2	720159
720159-02-0 (on request)	F_Kodier_Typ165_brg_lang
720159-02-2	720159



# Data Sheet

## RP023xxHBWC

Page 4/4

P/N

311661xx

xx=number of poles

2013/12/05

### Illustration

Drawing

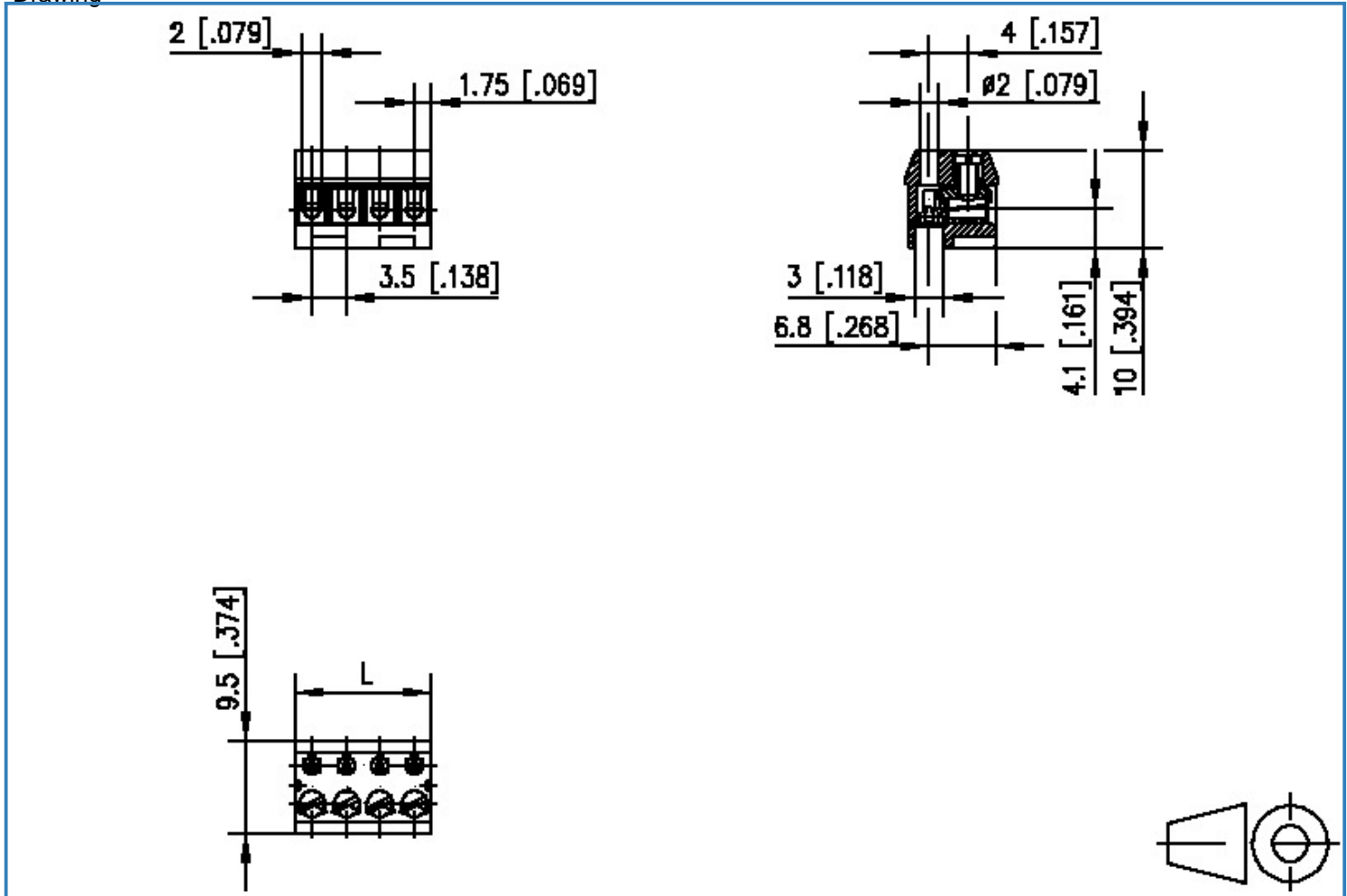

$L = (\text{pole size} - 1) \times \text{centerline} + 3.5 [0.138]$



## X-ON Electronics

Largest Supplier of Electrical and Electronic Components

*Click to view similar products for [Metz manufacturer](#):*

Other Similar products are found below :

[142M4D95050](#) [ASP0631006](#) [4898-454G](#) [4895-454G](#) [4887-454G](#) [4897-454G](#) [ASP0460622](#) [142M2X25005](#) [ASP0440222](#) [1108861321](#)  
[1108311319](#) [1108501319](#) [11089313](#) [834HTC-900ML](#) [130920-E](#) [150240C30610E](#) [110304412004](#) [1108831326](#) [150240C30310S](#) [135015-](#)  
[SSC-E](#) [1528SBGT19E](#) [1401110012KE](#) [142M2X15010](#) [11085813](#) [810-500](#) [810-50](#) [31336104](#) [ASP0430922](#) [SP06502VBNF](#) [31217103](#)  
[142M1D19020](#) [SR99S01VBNN0001](#) [31213102](#) [31251104](#) [AST0820406](#) [1108811319](#) [142M2XB5050](#) [834B-375ML](#) [841ER-1.17L](#)  
[31009105](#) [31020205](#) [31024102](#) [31027103](#) [31383106](#) [130922-03-E](#) [130924-E](#) [11027605](#) [1108841319](#) [1108341319](#) [15024AD206-E](#)