















# Multi Purpose Die Cast

## Features:

- Rugged Aluminium.
- 4 sides PCB guides.
- Stand offs.
- Zink plated screws for tapped holes.
- Neoprene rubber gasket.
- Easy to machine.
- BS colour choice.

## 5000 Series

Version Code				Dimensions (mm)			PDF	DWG
Nylon Coated	Hammer Tone	Black	White	D/L	W	H		
5001/11-NC	5001/11-PAT	5001/11-BK	5001/11-WH	50	50	31		
5002/12-NC	5002/12-PAT	5002/12-BK	5002/12-WH	101	50	24.5		
5003/13-NC	5003/13-PAT	5003/13-BK	5003/13-WH	112	62	30.5		
5004/14-NC	5004/14-PAT	5004/14-BK	5004/14-WH	120	65.5	39.5		
5007/17-NC	5007/17-PAT	5007/17-BK	5007/17-WH	121	95	61		
5005/15-NC	5005/15-PAT	5005/15-BK	5005/15-WH	152	82	50		
5006/16-NAT	5006/16-PAT	5006/16-BK	5006/16-WH	191.5	111.5	60.5		

OVERALL ASSEMBLY DIMENSIONS:

EXTERNAL - 152 x 82 x 49.75

INTERNAL - 149.4 x 78.4 x 45.5

M3 CSK

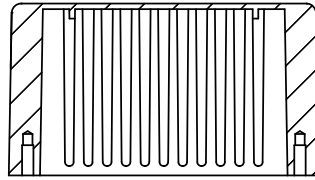

SECTION B-B

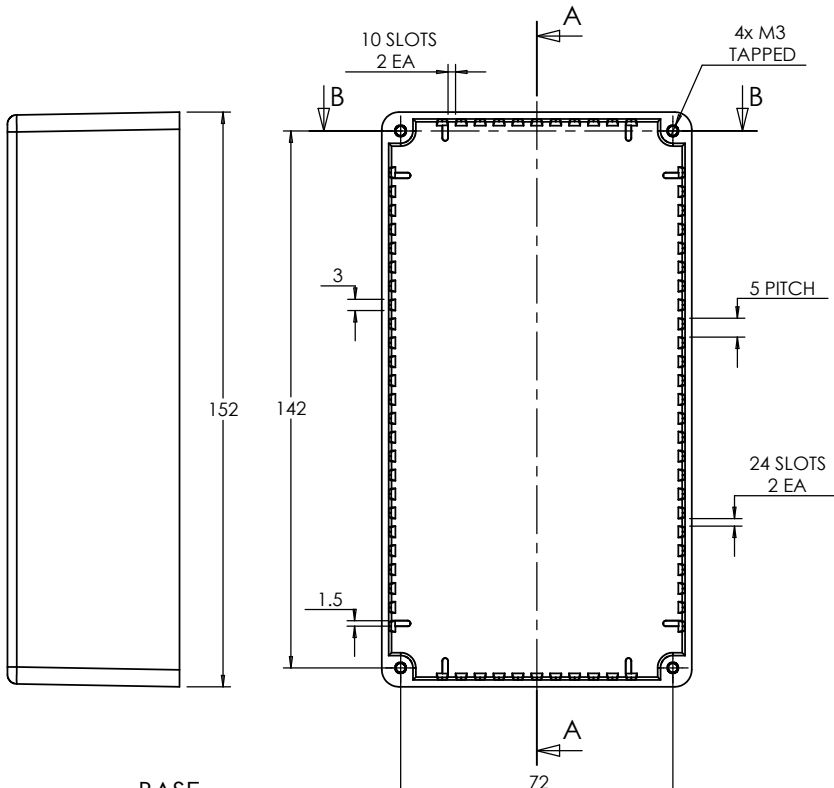

BASE

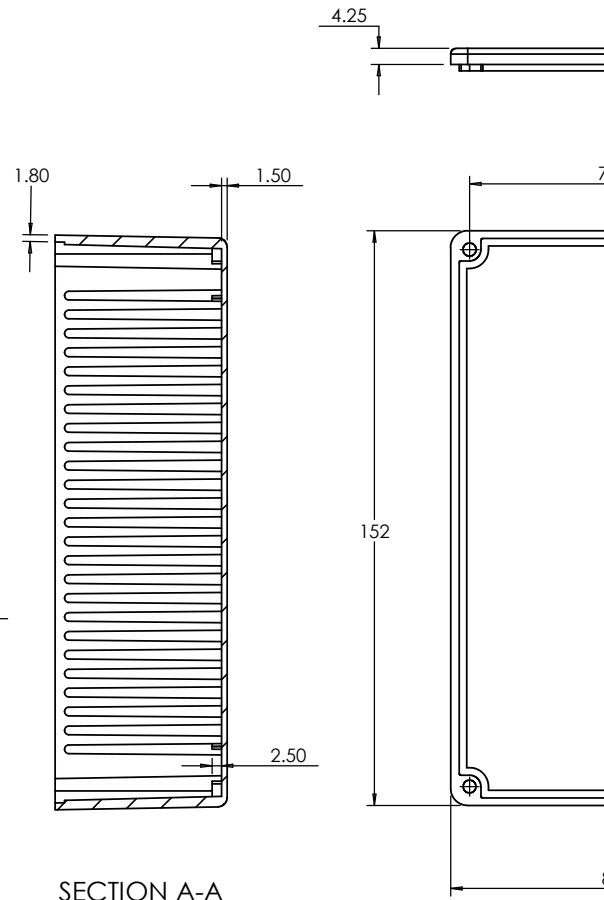

SECTION A-A

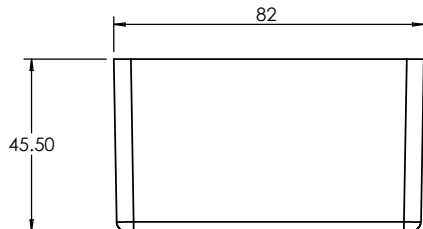

JAMES CARTER RD, MILDENHALL, SUFFOLK, IP28 7DE  
 TEL: 01638 716101 FAX: 01638 716554  
 EMAIL: SALES@BOSS-ENCLOSURES.CO.UK  
 WEB: www.BOSS-ENCLOSURES.CO.UK

UNLESS OTHERWISE SPECIFIED DIMENSIONS ARE IN MILLIMETERS

FINISH: **SMOOTH**

MATERIAL: **DIE-CAST ALUMINUM**

DRAWN	S.HARDINGE	SIGNED	SJH	DATE	07/12/05
CHK'D	-	-	-	-	-

PROJECTION:

## X-ON Electronics

Largest Supplier of Electrical and Electronic Components

*Click to view similar products for [camden manufacturer](#):*

Other Similar products are found below :

[412689X](#) [CTBP92HE/10](#) [CTBP92VE/12R](#) [CTBP9350/12](#) [IND515205-240-T/GRN](#) [IND515205-240-T/RD](#) [IND5032405-240-T/GRN](#)  
[CE10.00.EI](#) [C192SHAND](#) [RTM5006/16-PAT](#) [CNMB/6ST/2](#) [CNMB/4ST/2](#) [CSACST004](#) [CTBP9200/9](#) [CIME/M/BE2250SS](#) [CHH64E1BL](#)  
[CIM/15W-DMFS](#) [CHHBAT2GY](#) [CFTBN/2](#) [CCB2S1/04](#) [CHDX6-221C](#) [CHDX6-222C](#) [CHDX8-224](#) [CHDASMP29](#) [CHDASMP34](#)  
[CHDX810DD](#) [CHDX811DD](#) [CCTTM40LR](#) [CTBP92VJ/5S](#) [CTBP92VJ/8R](#) [CTSN431/12/M](#) [CTSN433/12/M](#) [CUABOX006](#) [IND513113-](#)  
[LED-RD](#) [CE10.00.FM](#) [CBRPH-BLK](#) [BIM2003/13-WH/WH](#) [RX2008/S-5-WH](#) [CBARD-CAR](#) [CRDCG0007](#) [CNMB/4/KIT](#) [CTB5050/5](#)  
[CTBP92HE/11](#) [CTBP9358/10AO](#) [CHH66C2GY](#) [CHH456PBK](#) [CHH451ABK](#) [CIM/9W-DMFS](#) [CIM/25W-DMFS](#) [RTM5004/14-NC-BLK](#)