

PRODUCT NUMBER
98099-101

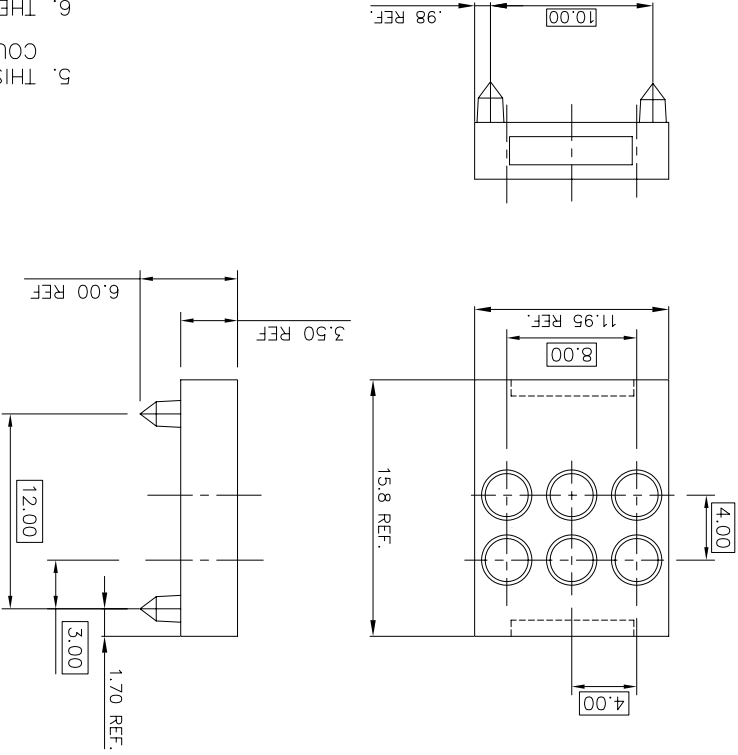

- NOTES:
1. MATERIAL: LCP, 30% GLASS FILLED
COLOR: NATURAL
FLAME RETARDANT ACC. UL 94-V0
 2. THESE HOLES NEEDED WHEN USED IN A CENTER PLANE APPLICATION WITH A HYBRID ON EACH SIDE OF THE CENTER PLANE.
 3. THE -101 HOUSING IS TO BE USED WITH MINI-COAX PLUG/PLUG INSERTS, 70296-002.
 4. ADD LF SUFFIX AT THE END OF PART NUMBER FOR LEAD FREE OPTION.

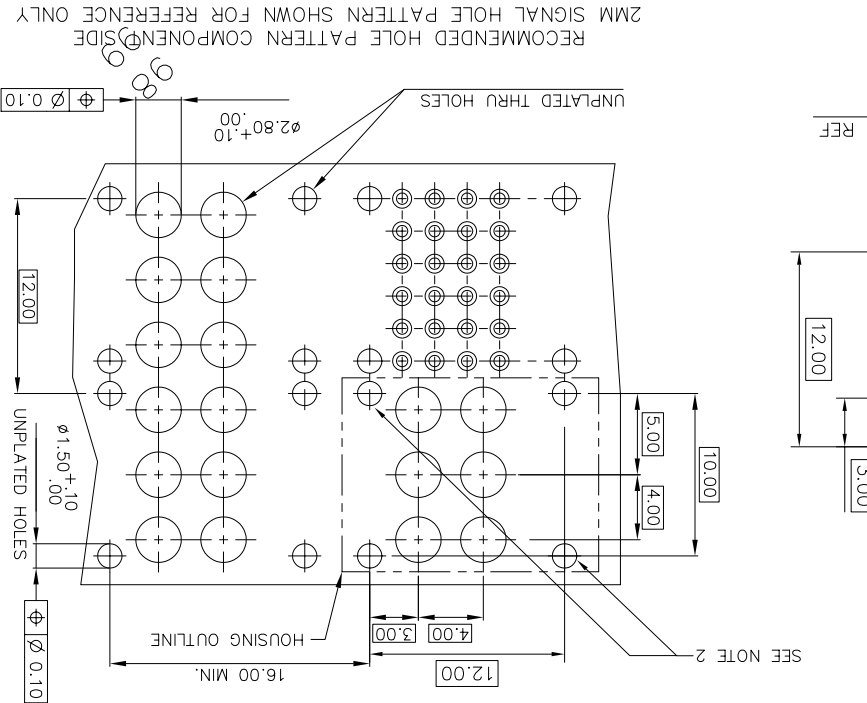

5. THIS PRODUCT MEETS EUROPEAN UNION DIRECTIVES AND OTHER COUNTRY REGULATION AS DESCRIBED IN GS-22-008.
6. THE HOUSING WILL WITHSTAND EXPOSURE TO 260°C PEAK TEMPERATURE FOR 15 SECONDS IN A WAVE SOLDER APPLICATION WITH A 1.5mm MINIMUM THICK CIRCUIT BOARD OR FOR 10-20 SECONDS IN A CONVECTION, INFRARED OR VAPOR PHASE REFLOW OVEN. SEE APPLICATION NOTES/PROCEDURES IF THEY ARE AVAILABLE.

matl. code		surface		tolerance		projection		product family	
14		14		14		14		METRAL (tm)	
itr	ecn no	dr	date	tolerances unless otherwise specified		title		4. R., W/O WALLS, 12 mm	
A	V90642	MDF	5/18/99	.0±.3		MM		MINI-HYBRID HDR. KEYING MOD.	
B	M06-0093	MHT	2/24/06	.00±.13		MM		4. R., W/O WALLS, 12 mm	
C	M06-0165	MHT	5/02/06	0°F.2		MM		4. R., W/O WALLS, 12 mm	
dr	M.FETROW		3/11/99	.000±.051		MM		4. R., W/O WALLS, 12 mm	
engr	R.DOUTRICH		3/11/99	.000±.051		MM		4. R., W/O WALLS, 12 mm	
chr	R.DOUTRICH		3/11/99	.000±.051		MM		4. R., W/O WALLS, 12 mm	
appd	R.DOUTRICH		3/11/99	.000±.051		MM		4. R., W/O WALLS, 12 mm	
sheet	revision	C		.000±.051		MM		4. R., W/O WALLS, 12 mm	
index	sheet	1		.000±.051		MM		4. R., W/O WALLS, 12 mm	
type		CUSTOMER		.000±.051		MM		4. R., W/O WALLS, 12 mm	
dwg no		98099		.000±.051		MM		4. R., W/O WALLS, 12 mm	
sheet 1 of 1 size		A3		.000±.051		MM		4. R., W/O WALLS, 12 mm	

X-ON Electronics

Largest Supplier of Electrical and Electronic Components

Click to view similar products for [Headers & Wire Housings](#) category:

Click to view products by [FCT Electronics](#) manufacturer:

Other Similar products are found below :

[95000-104TRLF](#) [10135584-644402LF](#) [DF62W-EP2022PCA](#) [95000-106TRLF](#) [DF62W-2022SCA](#) [DF62W-EP2022PC](#) [2203348](#) [DF62W-2022SC](#) [1084018](#) [1029039](#) [1084017](#) [802-10-012-10-002000](#) [1112640](#) [1112639](#) [891-007-9SS-BST1T](#) [000-34000](#) [0008550134](#) [0009482033](#) [0009507031](#) [57102-F02-18ULF](#) [57102-S06-03LF](#) [57202-S52-04LF](#) [PCN6-15S-2.5E](#) [0039019024](#) [58102-G61-06LF](#) [582553-1](#) [0009485154](#) [0009508121](#) [0022285053](#) [0050291907](#) [018731A](#) [LY20-4P-DT1-P1E-BR](#) [02.125.8002.8](#) [60101931](#) [60598-1 \(Cut Strip\)](#) [M1625-3R/100](#) [61062-3](#) [61082-181009](#) [CSU011177004](#) [636-1427](#) [638009-1](#) [641938-9](#) [641991-4](#) [644168-1](#) [644827-2](#) [647662-1](#) [65039-019ELF](#) [65692-001LF](#) [65781-018](#) [65781-047](#)