

Classic Collet Knobs and Accessories

- modular collet knob system for various shaft diameters
- excellent surface finish (matt/glossy)
- special colors on request



Overview Standard Knobs

Knob ø \ Shaft ø	Knob ø							
	9 mm	10 mm	14,5 mm	21 mm	28 mm	36 mm	45 mm	
2 mm	•	•						
3 mm	•	•	•					
4 mm		•	•	•				
6 mm			•	•	•	•	•	
1/8"	•	•	•					
1/4"			•	•	•	•	•	
Wing knob		•	•	•	•			
Crank knob							•	
other shaft diameters see page 141								
	page 35	page 36-37	page 38-39	page 40-41	page 42-43	page 44	page 45	

Knob program additions on page 46, soft touch and new look knobs on page 47 -48

Knob ø 9mm

Knob

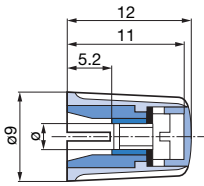

Marking	ø	grey		black	
		matt	glossy	matt	glossy
	2	020-1015	020-1010	020-1025	020-1020
	3	020-1115	020-1110	020-1125	020-1120
	1/8"	020-1215	020-1210	020-1225	020-1220
	2	021-1015	021-1010	021-1025	021-1020
	3	021-1115	021-1110	021-1125	021-1120
	1/8"	021-1215	021-1210	021-1225	021-1220

packing unit: 100 pieces

Cap

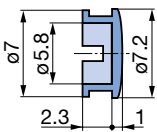

Marking	Surface	grey	black	red	blue	yellow	green
	matt	040-1015	040-1025	040-1035	040-1045	040-1055	040-1065
	glossy	040-1010	040-1020	040-1030	040-1040	040-1050	040-1060
	matt	040-1615	040-1625	040-1635	040-1645	040-1655	040-1665
	glossy	040-1610	040-1620	040-1630	040-1640	040-1650	040-1660

packing unit: 100 pieces

Pointer

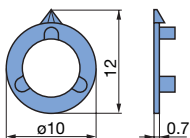

Surface	grey	black	red	blue	yellow	green
matt	041-1015	041-1025	041-1035	041-1045	041-1055	041-1065
glossy	041-1010	041-1020	041-1030	041-1040	041-1050	041-1060

packing unit: 100 pieces

Pointer dial

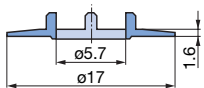

Marking	Surface	grey	black	red
	matt	042-1915	042-1925	042-1935
	glossy	042-1910	042-1920	042-1930

packing unit: 100 pieces

Stator

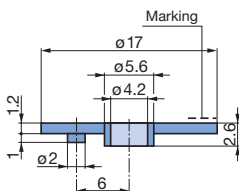

Marking	with line grey: glossy	30° black: glossy
	043-2111	043-2221

packing unit: 100 pieces

Figure dial (same dimension as pointer dial)

Marking										
ø 17 mm	042-1000	042-1100	042-1200	042-1300	042-1400	042-1500	042-1600	042-1700	042-1800	042-1802

packing unit: 100 pieces

Knob \varnothing 10 mm

Knob

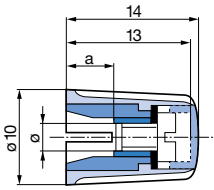

Marking	a	\varnothing	grey		black	
			matt	glossy	matt	glossy
without line 	4,5	2	020-2015	020-2010	020-2025	020-2020
	5,2	3	020-2115	020-2110	020-2125	020-2120
	5,2	1/8"	020-2215	020-2210	020-2225	020-2220
	5,2	4	020-2315	020-2310	020-2325	020-2320
with line 	4,5	4	021-2015	021-2010	021-2025	021-2020
	5,2	3	021-2115	021-2110	021-2125	021-2120
	5,2	1/8"	021-2215	021-2210	021-2225	021-2220
	5,2	4	021-2315	021-2310	021-2325	021-2320

packing unit: 100 pieces

Wing knob

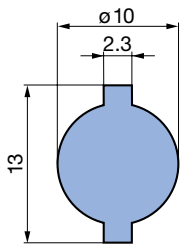

Marking	a	\varnothing	grey		black	
			matt	glossy	matt	glossy
without line 	4,5	2	022-2015	022-2010	022-2025	022-2020
	5,2	3	022-2115	022-2110	022-2125	022-2120
	5,2	1/8"	022-2215	022-2210	022-2225	022-2220
	5,2	4	022-2315	022-2310	022-2325	022-2320
with line 	4,5	2	023-2015	023-2010	023-2025	023-2020
	5,2	3	023-2115	023-2110	023-2125	023-2120
	5,2	1/8"	023-2215	023-2210	023-2225	023-2220
	5,2	4	023-2315	023-2310	023-2325	023-2320

packing unit: 100 pieces

Cap

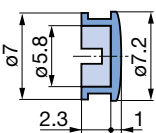

Marking	Surface	grey	black	red	blue	yellow	green
without line 	matt	040-1015	040-1025	040-1035	040-1045	040-1055	040-1065
	glossy	040-1010	040-1020	040-1030	040-1040	040-1050	040-1060
with line 	matt	040-1615	040-1625	040-1635	040-1645	040-1655	040-1665
	glossy	040-1610	040-1620	040-1630	040-1640	040-1650	040-1660

packing unit: 100 pieces

Pointer

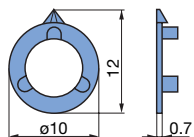

Surface	grey	black	red	blue	yellow	green
matt	041-2015	041-2025	041-2035	041-2045	041-2055	041-2065
glossy	041-2010	041-2020	041-2030	041-2040	041-2050	041-2060

packing unit: 100 pieces

Pointer dial

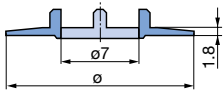

Marking	Surface	ø	grey	black	red
	matt	17	-	042-2928	-
	glossy	17	-	042-2923	-
	matt	20	042-2915	042-2925	042-2935
	glossy	20	042-2910	042-2920	042-2930

packing unit: 100 pieces

Nut cover

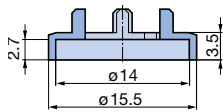

Marking	Surface	grey	black
	matt	044-2015	044-2025
	glossy	044-2010	044-2020
	matt	044-2115	044-2125
	glossy	044-2110	044-2120

packing unit: 100 pieces

Stator

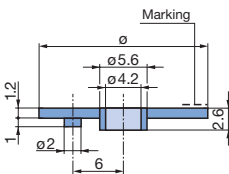

Marking	ø	with line grey: glossy	30° black: glossy
	17	043-2111	043-2221
	20	043-2110	043-2220

packing unit: 100 pieces

Figure dial (same dimension as pointer dial)

Marking	-	30	30	36	36	60	60	22,5	-	-
	-	0-11	1-12	0-9	1-10	0-5	1-6	0-F	-	-
ø 17 mm	042-2001	042-2101	042-2201	042-2301	042-2401	-	-	042-2701	042-2801	-
ø 20 mm	042-2000	042-2100	042-2200	042-2300	042-2400	042-2500	042-2600	042-2700	042-2800	042-2802

packing unit: 100 pieces

Knob ø 14,5 mm

Knob

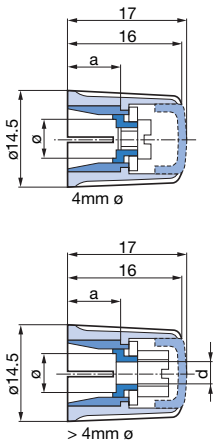

Marking	a	d	ø	grey		black	
				matt	glossy	matt	glossy
without line	5,2	-	3	020-3115	020-3110	020-3125	020-3120
	5,2	-	1/8"	020-3215	020-3210	020-3225	020-3220
	5,2	-	4	020-3315	020-3310	020-3325	020-3320
	7,0	3,2	6	020-3415	020-3410	020-3425	020-3420
	7,0	3,2	1/4"	020-3515	020-3510	020-3525	020-3520
with line	5,2	-	3	021-3115	021-3110	021-3125	021-3120
	5,2	-	1/8"	021-3215	021-3210	021-3225	021-3220
	5,2	-	4	021-3315	021-3310	021-3325	021-3320
	7,0	3,2	6	021-3415	021-3410	021-3425	021-3420
	7,0	3,2	1/4"	021-3515	021-3510	021-3525	021-3520

packing unit: 100 pieces

Wing knob

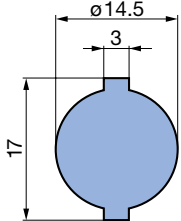

Marking	a	d	ø	grey		black	
				matt	glossy	matt	glossy
without line	5,2	-	3	022-3115	022-3110	022-3125	022-3120
	5,2	-	1/8"	022-3215	022-3210	022-3225	022-3220
	5,2	-	4	022-3315	022-3310	022-3325	022-3320
	7,0	3,2	6	022-3415	022-3410	022-3425	022-3420
	7,0	3,2	1/4"	022-3515	022-3510	022-3525	022-3520
with line	5,2	-	3	023-3115	023-3110	023-3125	023-3120
	5,2	-	1/8"	023-3215	023-3210	023-3225	023-3220
	5,2	-	4	023-3315	023-3310	023-3325	023-3320
	7,0	3,2	6	023-3415	023-3410	023-3425	023-3420
	7,0	3,2	1/4"	023-3515	023-3510	023-3525	023-3520

packing unit: 100 pieces

Cap

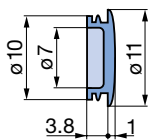

Marking	Surface	grey	black	red	blue	yellow	green
without line	matt	040-3015	040-3025	040-3035	040-3045	040-3055	040-3065
	glossy	040-3010	040-3020	040-3030	040-3040	040-3050	040-3060
with line	matt	040-3615	040-3625	040-3635	040-3645	040-3655	040-3665
	glossy	040-3610	040-3620	040-3630	040-3640	040-3650	040-3660

packing unit: 100 pieces

Pointer

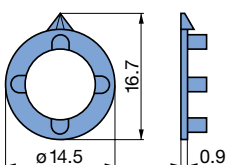

Surface	grey	black	red	blue	yellow	green
matt	041-3015	041-3025	041-3035	041-3045	041-3055	041-3065
glossy	041-3010	041-3020	041-3030	041-3040	041-3050	041-3060

packing unit: 100 pieces

Pointer dial

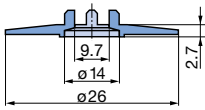

Marking	Surface	grey	black	red
	matt	042-3915	042-3925	042-3935
	glossy	042-3910	042-3920	042-3930

packing unit: 100 pieces

Nut cover

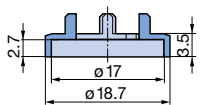

Marking	Surface	grey	black	red
	without line	044-3015	044-3025	044-3035
	glossy	044-3010	044-3020	044-3030
	without line	044-3115	044-3125	044-3135
	glossy	044-3110	044-3120	044-3130
	without line	044-3215	044-3225	044-3235
	glossy	044-3210	044-3220	044-3230

packing unit: 100 pieces

Stator

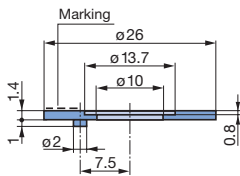

Marking	with line, grey: glossy	30° black: glossy
	043-3110	043-3220

packing unit: 100 pieces

Figure dial (same dimension as pointer dial)

Marking	-	30	30	36	36	60	60	22.5	-	-
	-	0-11	1-12	0-9	1-10	0-5	1-6	0-F	-	-
ø 26 mm	042-3000	042-3100	042-3200	042-3300	042-3400	042-3500	042-3600	042-3700	042-3800	042-3802
ø 44 mm	042-3010	-	-	-	-	-	-	-	-	-

packing unit: 100 pieces

Knob ø 21 mm

Knob

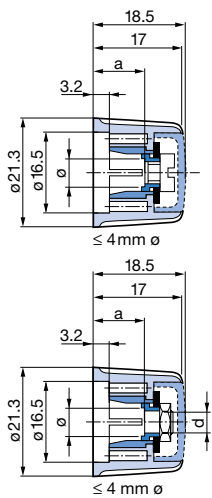

Marking	a	d	ø	grey		black	
				matt	glossy	matt	glossy
	8,3	-	4	020-4315	020-4310	020-4325	020-4320
	10	4,05	6	020-4415	020-4410	020-4425	020-4420
	10	3,2	1/4"	020-4515	020-4510	020-4525	020-4520
	8,3	-	4	021-4315	021-4310	021-4325	021-4320
	10	4,05	6	021-4415	021-4410	021-4425	021-4420
	10	3,2	1/4"	021-4515	021-4510	021-4525	021-4520

packing unit: 100 pieces

Wing knob

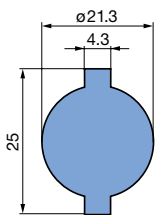

Marking	a	d	ø	grey		black	
				matt	glossy	matt	glossy
	8,3	-	4	022-4315	022-4310	022-4325	022-4320
	10	4,05	6	022-4415	022-4410	022-4425	022-4420
	10	3,2	1/4"	022-4515	022-4510	022-4525	022-4520
	8,3	-	4	023-4315	023-4310	023-4325	023-4320
	10	4,05	6	023-4415	023-4410	023-4425	023-4420
	10	3,2	1/4"	023-4515	023-4510	023-4525	023-4520

packing unit: 100 pieces

Cap

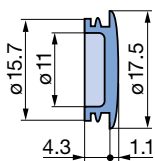

Marking	Surface	grey	black	red	blue	yellow	green
	matt	040-4015	040-4025	040-4035	040-4045	040-4055	040-4065
	glossy	040-4010	040-4020	040-4030	040-4040	040-4050	040-4060
	matt	040-4615	040-4625	040-4635	040-4645	040-4655	040-4665
	glossy	040-4610	040-4620	040-4630	040-4640	040-4650	040-4660

packing unit: 100 pieces

Pointer

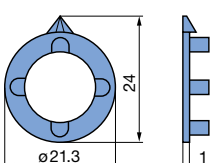



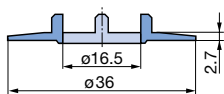

Surface	grey	black	red	blue	yellow	green
matt	041-4015	041-4025	041-4035	041-4045	041-4055	041-4065
glossy	041-4010	041-4020	041-4030	041-4040	041-4050	041-4060

packing unit: 100 pieces

Pointer dial



Marking	Surface	grey 	black 	red 
	matt	042-4915	042-4925	042-4935
	glossy	042-4910	042-4920	042-4930

packing unit: 100 pieces

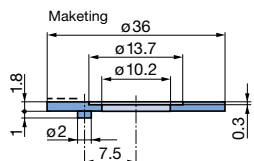











Stator

Marking	with line, grey: glossy	30° black: glossy	15° black: glossy
	043-4110	043-4220	043-4230

packing unit: 100 pieces

Figure dial (same dimension as pointer dial)

Marking										
	-	30°	30°	36°	36°	27,7°	15°	15°	-	-
	-	0-11	1-12	0-9	1-10	1-13	0-23	1-24	-	-
ø 36 mm	042-4000	042-4100	042-4200	042-4300	042-4400	042-4700	042-4900	042-4901	042-4800	042-4802
ø 44 mm	042-4010	-	-	-	-	-	-	-	-	-
ø 53 mm	042-4020	-	-	-	-	-	-	-	-	-

packing unit: 100 pieces

Knob \varnothing 28 mm

Knob

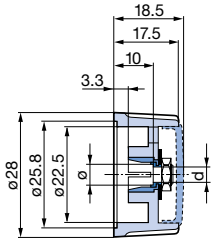

Marking	d	\varnothing	grey		black	
			matt	glossy	matt	glossy
without line	4,05	6	020-5415	020-5410	020-5425	020-5420
	3,2	1/4"	020-5515	020-5510	020-5525	020-5520
with line	4,05	6	021-5415	021-5410	021-5425	021-5420
	3,2	1/4"	021-5515	021-5510	021-5525	021-5520

packing unit: 100 pieces

Wing knob

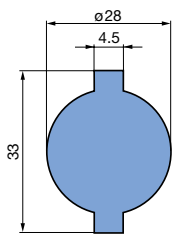

Marking	d	\varnothing	grey		black	
			matt	glossy	matt	glossy
without line	4,05	6	022-5415	022-5410	022-5425	022-5420
	3,2	1/4"	022-5515	022-5510	022-5525	022-5520
with line	4,05	6	023-5415	023-5410	023-5425	023-5420
	3,2	1/4"	023-5515	023-5510	023-5525	023-5520

packing unit: 100 pieces

Cap

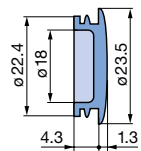

Marking	Surface	grey	black	red	blue	yellow	green
without line	2	040-5015	040-5025	040-5035	040-5045	040-5055	040-5065
	3	040-5010	040-5020	040-5030	040-5040	040-5050	040-5060
with line	1/8"	040-5615	040-5625	040-5635	040-5645	040-5655	040-5665
	2	040-5610	040-5620	040-5630	040-5640	040-5650	040-5660

packing unit: 100 pieces

Pointer

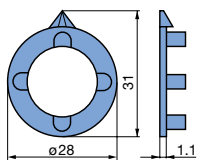



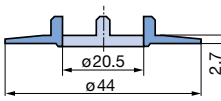

Surface	grey	black	red	blue	yellow	green
matt	041-5015	041-5025	041-5035	041-5045	041-5055	041-5065
glossy	041-5010	041-5020	041-5030	041-5040	041-5050	041-5060

packing unit: 100 pieces

Pointer dial





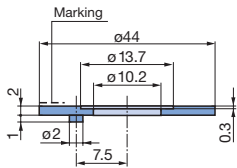

Marking	Surface	grey 	black 	red 
	matt	042-5915	042-5925	042-5935
	glossy	042-5910	042-5920	042-5930

packing unit: 100 pieces









Stator

Marking	with line, grey: glossy 	30° black: glossy 	15° black: glossy 
	043-5110	043-5220	043-5230

packing unit: 100 pieces

Figure dial (same dimension as pointer dial)

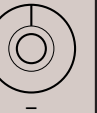
Marking	-	30°	30°	27,7	15°	15°	-	-
								
	-	0-11	1-12	1-13	0-23	1-24	-	-
ø 44 mm	042-5000	042-5100	042-5200	042-5700	042-5900	042-5901	042-5800	042-5802
ø 53 mm	042-5020							
ø 63 mm	042-5030							

packing unit: 100 pieces

Knob \varnothing 36 mm

Knob

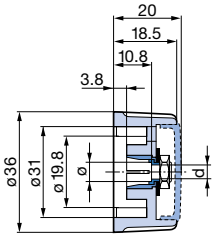

Marking	d	\varnothing	grey		black	
			matt	glossy	matt	glossy
	4,05	6	020-6415	020-6410	020-6425	020-6420
	3,2	1/4"	020-6515	020-6510	020-6525	020-6520
	4,05	6	021-6415	021-6410	021-6425	021-6420
	3,2	1/4"	021-6515	021-6510	021-6525	021-6520

packing unit: 50 pieces

Cap

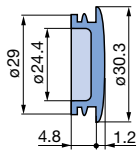

Marking	Surface	grey	black	red
	matt	040-6015	040-6025	040-6035
	glossy	040-6010	040-6020	040-6030
	matt	040-6615	040-6625	040-6635
	glossy	040-6610	040-6620	040-6630

packing unit: 100 pieces

Pointer

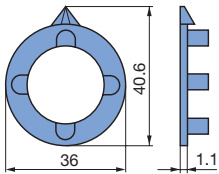

Surface	grey	black	red
matt	041-6015	041-6025	041-6035
glossy	041-6010	041-6020	041-6030

packing unit: 100 pieces

Pointer dial

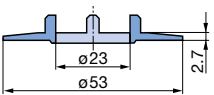

Marking	Surface	grey	black	red
	matt	042-6915	042-6925	042-6935
	glossy	042-6910	042-6920	042-6930

packing unit: 100 pieces

Stator

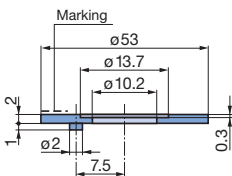

Marking	with line, grey: glossy	30° black: glossy
	043-6110	043-6220

packing unit: 100 pieces

Figure dial (same dimension as pointer dial)

Marking						
	-	30°	30°	27,7°	-	-
	-	0-11	1-12	1-13	-	-
\varnothing 53 mm	042-6000	042-6100	042-6200	042-6700	042-6800	042-6802
\varnothing 63 mm	042-6030	-	-	-	-	-

packing unit: 100 pieces

Knob \varnothing 45 mm

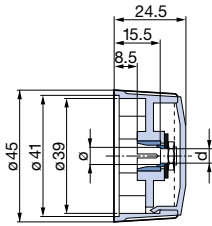

Knob

Marking	d	\varnothing	grey: glossy	black: glossy
without line	4,05	6	020-7410	020-7420
	3,2	1/4"	020-7510	020-7520
with line	4,05	6	021-7410	021-7420
	3,2	1/4"	021-7510	021-7520

packing unit: 50 pieces

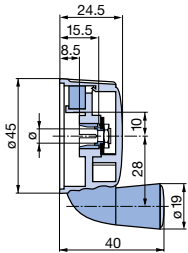

Crank Knob

Marking	d	\varnothing	grey: glossy	black: glossy
without line	4,05	6	020-8410	020-8420

packing unit: 40 pieces

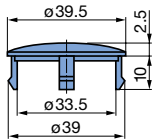

Cap

Marking	Surface	grey	black	red
without line	glossy	040-8010	040-8020	040-8030

packing unit: 100 pieces

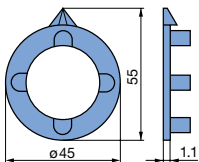

Pointer

Surface	grey	black	red
glossy	041-7110	041-7120	041-7130

packing unit: 100 pieces

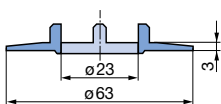

Pointer dial

Marking	Surface	grey	black
	glossy	042-7910	042-7920

packing unit: 100 pieces

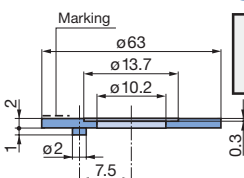

Stator

Marking	with line, grey: glossy	30° black: glossy
	043-7110	043-7220

packing unit: 100 pieces

Figure dial (same dimension as pointer dial)

Marking		30°	30°	27,7°		
\varnothing 63 mm	042-7000	042-7100	042-7200	042-7700	042-7800	042-7802

packing unit: 100 pieces

Knob Program Additions

Locking set: Locks arrow dial or figure dial \varnothing 20-63 mm on front panel (protection against unintentional turning)

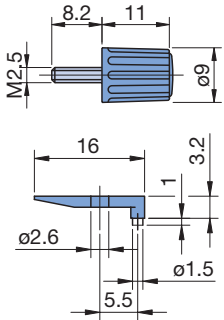

Locking set, consisting of:	grey	black	clear transp.	clear transp. with line
Screw with knob	026-2010	026-2020		
Locking piece			026-2100	026-2200

Anti-slip bracket. D-shape prevents slippage on shaft and incorrect knob mounting. For knobs \varnothing 21, 28, 36 mm

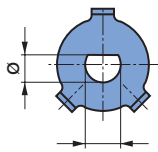

Anti-slip bracket Corresponding shaft with flat	\varnothing	a	L	Order number
	4 mm	3,50 mm	7 mm	048-2000
	6 mm	4,60 mm	9 mm	048-2300
	6 mm	5,00 mm	9 mm	048-2100
	1/4"	5,08 mm	9 mm	048-2200

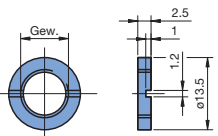

Starting with the knobs \varnothing 14,5 mm, stators can be mounted directly underneath the slotted nut of the central mounting bushing of the switch.

Thread	M6 x 0.75	M7 x 0.75	M8 x 0.75	M10 x 0.75	3/8" - 32
Slotted nut	046-1000	046-1500	046-2000	046-3000	046-4000

Stators for knobs \varnothing 14,5 mm or larger can be mounted directly to the bushing on the front panel in cases where the switch does not have a central mounting.

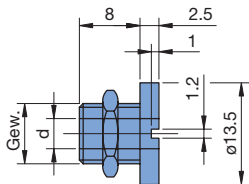

Threaded bushing with through-hole \varnothing 6 mm	047-3000

Tool for tightening of our slotted nuts and threaded bushings.

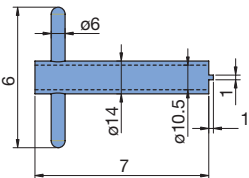

Tool	048-100

Knobs

soft touch and push-on

- Collet Knobs with "soft touch feel"
- Push-on Knobs with "soft touch" and hard feel



Push on Knobs (black) - two color in soft and hard touch



Soft (black), 16mm diameter, type K65		
Degree pointer to flat	Line color, white	Line color, blue
0 degree	K65-DRNP12000-03	K65-DRNP12000-05
90 degree	K65-DRNP12090-03	K65-DRNP12090-05
180 degree	K65-DRNP12180-03	K65-DRNP12180-05
270 degree	K65-DRNP12270-03	K65-DRNP12270-05

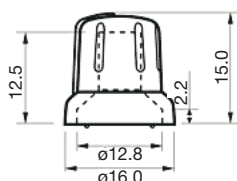

- Line color red, yellow, green on request
- Material: 1st shot: talc filled Polypropylene, 2nd shot: thermoplastic Elastomer
- Operating temperature: -30°C to +50°C

Line positioning for flattet shafts

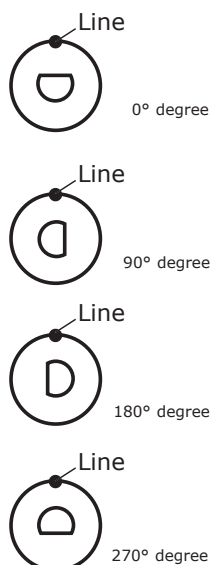

Hard (black), 16mm diameter, type K66		
Degree pointer to flat	Line color, white	Line color, blue
0 degree	K66-DRNP12000-03	K66-DRNP12000-05
90 degree	K66-DRNP12090-03	K66-DRNP12090-05
180 degree	K66-DRNP12180-03	K66-DRNP12180-05
270 degree	K66-DRNP12270-03	K66-DRNP12270-05

- Line color red, yellow, green on request
- Material: talc filled Polypropylene
- Operating temperature: -30°C to +50°C

Two shot soft touch collet knobs (all black)



15 mm diameter type K60		
Shaft diameter	without line	with white line
4mm	K60-S150-004	K60-S151-004
6mm	K60-S150-006	K60-S151-006
1/4 "	K60-S150-250	K60-S151-250

- Base Ø: 15.5 mm
- Height (inc. cap): 14.3 mm
- Shaft Depth: 7.0 mm

Fixing tools (for collet knobs 15 mm) type K51	
only for 15 mm diameter	K51-1000-00

21 mm diameter type K60		
Shaft diameter	without line	with white line
4mm	K60-S210-004	K60-S211-004
6mm	K60-S210-006	K60-S211-006
1/4 "	K60-S210-250	K60-S211-250

packing unit: 100 pieces

- Base Ø: 21.5 mm
- Height (inc. cap): 17.7 mm
- Shaft Depth: 10.0 mm
- Material: 1st shot: talc filled Polypropylene, 2nd shot: thermoplastic Elastomer
- Operating temperature: -30°C to +50°C



FLAT SIZE

6mm shaft Ø
4.5mm flat size

Specify orientation
of pointer to flat

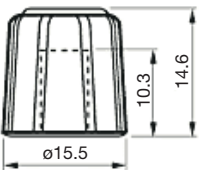

Push on knobs

15 mm diameter without line, with D-shaft type K55		
Shaft diameter / Flat size	with compression ring	without compression ring
6 mm / 4.5 mm	K55-DC150-006	K55-DR150-006

- Material: Nylon 6
- Operating temperature: -30°C to +50°C

Caps

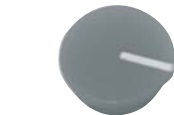

Type K51			
Knob diameter	without line	with white line	with white spot
15mm black	K51-C150-01	K51-C151-01	K51-C152-01
15mm grey	K51-C150-02	K51-C151-02	K51-C152-02
21mm black	K51-C210-01	K51-C211-01	K51-C212-01
21mm grey	K51-C210-02	K51-C211-02	K51-C212-02

- red, blue, yellow or green color, on request
- Material: Nylon 6
- Operating temperature: -30°C to +50°C

X-ON Electronics

Largest Supplier of Electrical and Electronic Components

Click to view similar products for [Thick Film Resistors - SMD category](#):

Click to view products by [Elma manufacturer](#):

Other Similar products are found below :

[CRCW04028R20JNEE](#) [CRCW06036K80FKEE](#) [CRG1206F1K58](#) [CRL0603-FW-R700ELF](#) [M55342K06B6E19RWL](#) [RC1005F1072CS](#)
[RC1005F471CS](#) [RC1005F4751CS](#) [RCWP72251K47FKWB](#) [RLR05C7501GPB14](#) [RLR07C5111FSBSL](#) [ERJ-1GMF1R00C](#) [ERJ-1GMF1R20C](#) [ERJ-1GMF2R55C](#) [ERJ-1GMF8R66C](#) [25121WF1003T4E](#) [25.501.3653.0](#) [290-1.0M-RC](#) [292-1.0M-RC](#) [292-2.2K-RC](#) [292-4.7K-RC](#) [25121WF4700T4E](#) [292-470K-RC](#) [302-1.0M-RC](#) [CPG1206F10KC](#) [CRCW02011R00FXED](#) [CRCW060315K0FKEE](#)
[CRCW060320K5FKEE](#) [CRG0201F10K](#) [RCG0402150RFKED](#) [RCG04023K92FKED](#) [RCP2512B100RGWB](#) [RCWP110010R0FKS3](#)
[RCWP11002K00FKS3](#) [RCWP12061K00FKS2](#) [3520510RJT](#) [352075KJT](#) [M55342K11B9E53RUL](#) [RMC16-102JT](#) [RMC1JPTE](#) [TR0603MR-075K1L](#) [5-2176094-4](#) [35202K7JT](#) [WF06Q1000FTL](#) [ERJ-S03J1R0V](#) [ERJ-S14J4R7U](#) [CHP2512L4R30GNT](#) [CPCC10270R0JE32](#)
[RCWP11001K00FKS3](#) [RCWP110035R7FKS3](#)