

1700 & 1750 Toggle Switches 16A 250Vac Single and Double Pole



- ▶ Nylon toggle switches
- ▶ Ratings up to 20A, 250V ac
- ▶ Single and double pole
- ▶ Wide choice of terminals
- ▶ Choice of circuit options including 3 position
- ▶ Flat & round actuator options

Approvals and specifications



16(4)A 250Vac T85



- UL 20A 250Vac Non Ind (Single pole)
- UL 16A 250Vac Non Ind (Double pole)
- UL CSA (2 pos types) 250Vac 1hp, 125Vac 1/2hp
- UL CSA (3 pos types) 250Vac 1/2hp, 125Vac 1/4hp
- CSA 16A 250Vac Non Ind
- UL 85°C, file E45221, CSA file LR10990
- UL and CSA N/A on momentary types

Selective "A, B, C" and "OFF, A, A+B" circuits at 5 amp also available.
3mm contact gap except where marked μ .
Technical data on pages 4 & 5.

toggle switches

C 1750 H O - - -

TERMINAL FUNCTION ACTUATOR BODY OPTIONS

TERMINAL	FUNCTION		ACTUATOR
C 6.3 x 0.8	Single pole 1700 ON - OFF	Double pole 1750 ON - OFF	H 16.4
H 4.8 x 0.8	1710 μ ON - ON	1760 μ ON - ON	R 13.8 The switch is on between centre terminals (2 & 5) and the terminals over which the lever is positioned.
K 2.8 x 0.8	1720 μ ON - OFF - ON	1770 μ ON - OFF - ON	
T Solder	1721 μ ON - OFF - ON (momentary 1 side)		
X PCB 0.8 Sq	1722 μ ON - OFF - ON (momentary 2 sides)		



C1700R --



C1700H --



C1760R --



C1750H --

BODY

0
Single pole

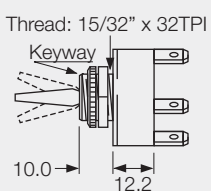

0
Double pole

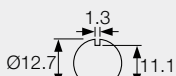
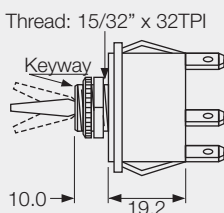

Panel hole (all types)
Panel thickness (Max)
Both nuts - 3.5mm
Less backnut - 6.5mm

OPTIONS

Neck Seal A0539MOAAA

Material - Nitrile
(H & R Actuators)
Actuator visible



Cover A1080MOAAA

Material - EPDM
(R Actuator only)



Cover A0331MOAAA

Material - PVC
(R Actuator only)



Covers have internal nylon nuts

Fixing nuts (Standard is M506 & T92)

T5 Hex brass
M506 Hex nylon

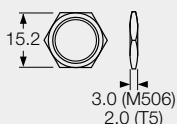

T92 Knurled brass -
slotted

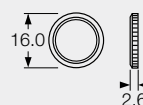

M279 Knurled nylon

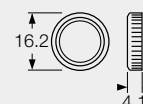

DIMENSIONS (mm)

Single Pole

(C terminals shown)

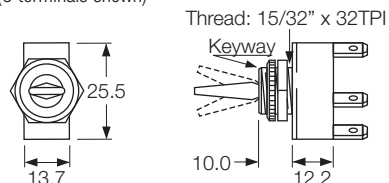

Optional
F00232PAAA
plate SP or DP

Double Pole

(C terminals shown)

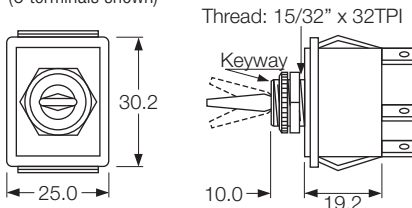

Without barrier

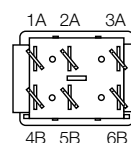

With barrier

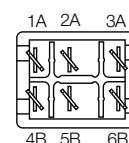

Optional terminal barrier M441.

SPECIFICATION

Series	1750 Metal Lever
Properties	
Contact Rating	16(4)A 250Vac
1750/1760/1770	16A
1784 - 1789	5A
Contact gap	> 3.0mm
Insulation	Class II
Flame Retardancy	Switch Body UL 94V2
Endurance (mech)	> 50,000 ops.
(elec)	> 10,000 ops. (at rated current)
Contact Resistance	
in new condition	< 10 m ohm
Insulation resistance	> 1000 M ohm
Dielectric strength:	
Across open contacts	> 2KV
Between live parts and accessible surfaces	> 4KV
Tracking resistance	KB250
Humidity resistance at	
91-95% relative humidity	48 Hours
Materials	
Current carrying parts:	
Contact points	Silver alloy
Fixed Terminal	Copper alloy, Silver plated with silver contact
Centre Terminal	Copper alloy, Silver plated
Moving contact	Copper alloy, Silver plated with silver contact
Switch body	Nylon 66
Switch lever	Copper alloy, Nickel plated
Top plate and neck	Cast zinc alloy
Fixing nut	Brass, chrome plated

Approvals applied for.

Approved metal lever switches suitable for Class II applications

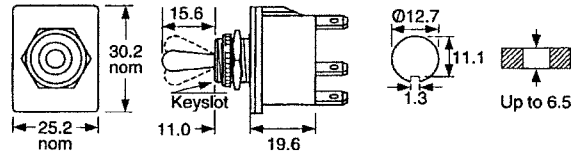

- C1750 OO** 6.3 Tab terminals
- T1750 OO** Solder terminals
- S1750 OO** Screw & Clamp terminals

Switching Function		
Links not supplied		
C1750 OO		
C1760 OO		
C1770 OO		
C178400		
C1785 OO		
C1786 OO		
C1787 OO		
C1788 OO		
C1789 OO		

Water resistant cover **F0331MO** provides panel sealing to IP66.



Arcoelectric

SWITCHES PLC

Arcoelectric Switches plc, Central Avenue, **West Molesey**, Surrey, England. KT8 2RF
Tel: 081-979 3232 Fax: 081-979 2565

X-ON Electronics

Largest Supplier of Electrical and Electronic Components

Click to view similar products for [Toggle Switches](#) category:

Click to view products by [Arcoelectric](#) manufacturer:

Other Similar products are found below :

[A19HV](#) [8A1-C-222](#) [60012L](#) [6006L](#) [6663](#) [7101MD9V30GE](#) [7101SPDV30BE](#) [7103SDV30BE](#) [7105D](#) [7108P3YAV2BE](#) [71YY50282](#)
[7201MD9AVBE](#) [7301K38](#) [7306K36](#) [7310K36](#) [7314K36](#) [7506K4](#) [7592K6](#) [7691K14](#) [7700K1](#) [8396K108](#) [8824K14](#) [8828K13](#) [G2VX](#) [G3VX](#)
[PS83-121G](#) [A101MD9AB04](#) [A101SD9AB04](#) [A101SDCQ04](#) [A103SD9AQ04](#) [A107TZB04](#) [A123P32YZQ](#) [A123S1YZG](#) [A127S1YCQ](#) [1-](#)
[1825192-0](#) [A131S1YZQ](#) [A201SCWZB04](#) [A207SYCB04](#) [A208J61ZQ0004](#) [A221K12KAG](#) [A221S1YZQ](#) [A221T1TCQ](#) [A232K12KZQ](#)
[A232M1YCQ](#) [A323S1CWZQ](#) [A423S1CWZG-M8](#) [A423S1YZQ](#) [12149A-3V](#) [12156AX408](#) [12147AGKX679](#)